

DAVID Y. IGE  
GOVERNOR



STATE OF HAWAII  
DEPARTMENT OF TRANSPORTATION  
869 PUNCHBOWL STREET  
HONOLULU, HAWAII 96813-5097

FORD N. FUCHIGAMI  
DIRECTOR

Deputy Directors  
JADE T. BUTAY  
ROSS M. HIGASHI  
EDWIN H. SNIFFIN  
DARRELL T. YOUNG

IN REPLY REFER TO:

Board of Land and  
Natural Resources  
State of Hawaii  
Honolulu, Hawaii

ISSUANCE OF A REVOCABLE PERMIT FOR AN OFFICE SPACE  
TM DESIGNERS, INC.  
EWA CONCOURSE, HONOLULU INTERNATIONAL AIRPORT  
TAX MAP KEY: (1) 1-1-003: 066 (PORTION)

OAHU

APPLICANT:

TM Designers, Inc. (TMD), whose business address is 300 Rodgers Boulevard, Terminal Box 61, Honolulu International Airport, Honolulu, Hawaii 96819.

LEGAL REFERENCE:

Section 171-55, Hawaii Revised Statutes

LOCATION:

Ewa Concourse (Building No. 360), Ground Level, Space No. 127A at  
Honolulu International Airport, Tax Map Key: 1<sup>st</sup> Division, 1-1-003: 066 (Portion)

AREA:

Building/Space No. 360-127A, containing an area of approximately 2,196 square feet,  
as shown and delineated on the attached map labeled Exhibit "A".

ZONING:

State Land Use District: Urban  
City and County of Honolulu LUO: Industrial (I-2)

LAND TITLE STATUS:

Ceded - Section 5(b) lands of the Hawaii Admission Act  
DHHL 30% entitlement lands pursuant to Hawaii Admission Act YES X NO     

**ITEM M-5**

BLNR – ISSUANCE OF A REVOCABLE PERMIT FOR AN OFFICE SPACE  
TM DESIGNERS, INC.

Page 2

CURRENT USE STATUS:

Land presently encumbered by Governor's Executive Order No. 3201, dated June 8, 1983, setting aside 3,152.177 acres designated as Honolulu International Airport under the control and management of the State of Hawaii, Department of Transportation, Airports Division (DOTA) for Airport Purposes.

CHARACTER OF USE:

TMD will use the space to operate and maintain an office at Honolulu International Airport.

COMMENCEMENT DATE:

To be determined by the Director of Transportation at a later date.

MONTHLY RENTAL:

\$5,358.24

SECURITY DEPOSIT:

Three (3) times the monthly rental in effect

HOLDOVER TENANCY:

\$535.82

DCCA VERIFICATION:

Place of business registration confirmed:	YES <u>X</u>	NO _____
Registered business name confirmed:	YES <u>X</u>	NO _____
Good standing confirmed:	YES <u>X</u>	NO _____

CHAPTER 343, HRS - ENVIRONMENTAL ASSESSMENT:

Pursuant to Section 11-200-8(a), Environmental Impact Statement Rules of the Department of Health, State of Hawaii, this disposition is exempt from requirements regarding preparation of an environmental assessment, negative declaration, or environmental impact statement as required by Chapter 343, Hawaii Revised Statutes, as amended, relating to Environmental Impact Statements, because the proposed action falls within Exemption Class #1, Comprehensive Exemption List for the State of Hawaii, Department of Transportation, dated November 15, 2000, as approved by the Environmental Quality Council. Exemption Class #1 covers operations, repairs, or

BLNR – ISSUANCE OF A REVOCABLE PERMIT FOR AN OFFICE SPACE  
TM DESIGNERS, INC.

Page 3

maintenance of existing structures, facilities, equipment, or topographical features involving negligible or no expansion or change of use beyond that previously existing.

REMARKS:

TMD plans to lease terminal space on a month-to-month revocable permit for an office in support of Hallmark Aviation Services operations at Honolulu International Airport. TMD is currently a tenant in a space located within the Ewa Concourse. TMD has been fully compliant in other leases and permits and not in arrears in other rental payments.

RECOMMENDATION:

That the Board authorize the Department of Transportation to issue a month-to-month revocable permit to TMD, subject to: (1) terms and conditions herein outlined, which are by reference incorporated herein; and (2) such additional terms and conditions as may be prescribed by the Director of Transportation to best serve the interests of the State.

Respectfully submitted,



FORD N. FUCHIGAMI  
Director of Transportation

APPROVED FOR SUBMITTAL:

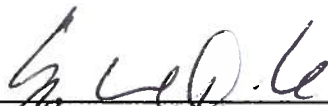
---

SUZANNE D. CASE  
Chairperson and Member

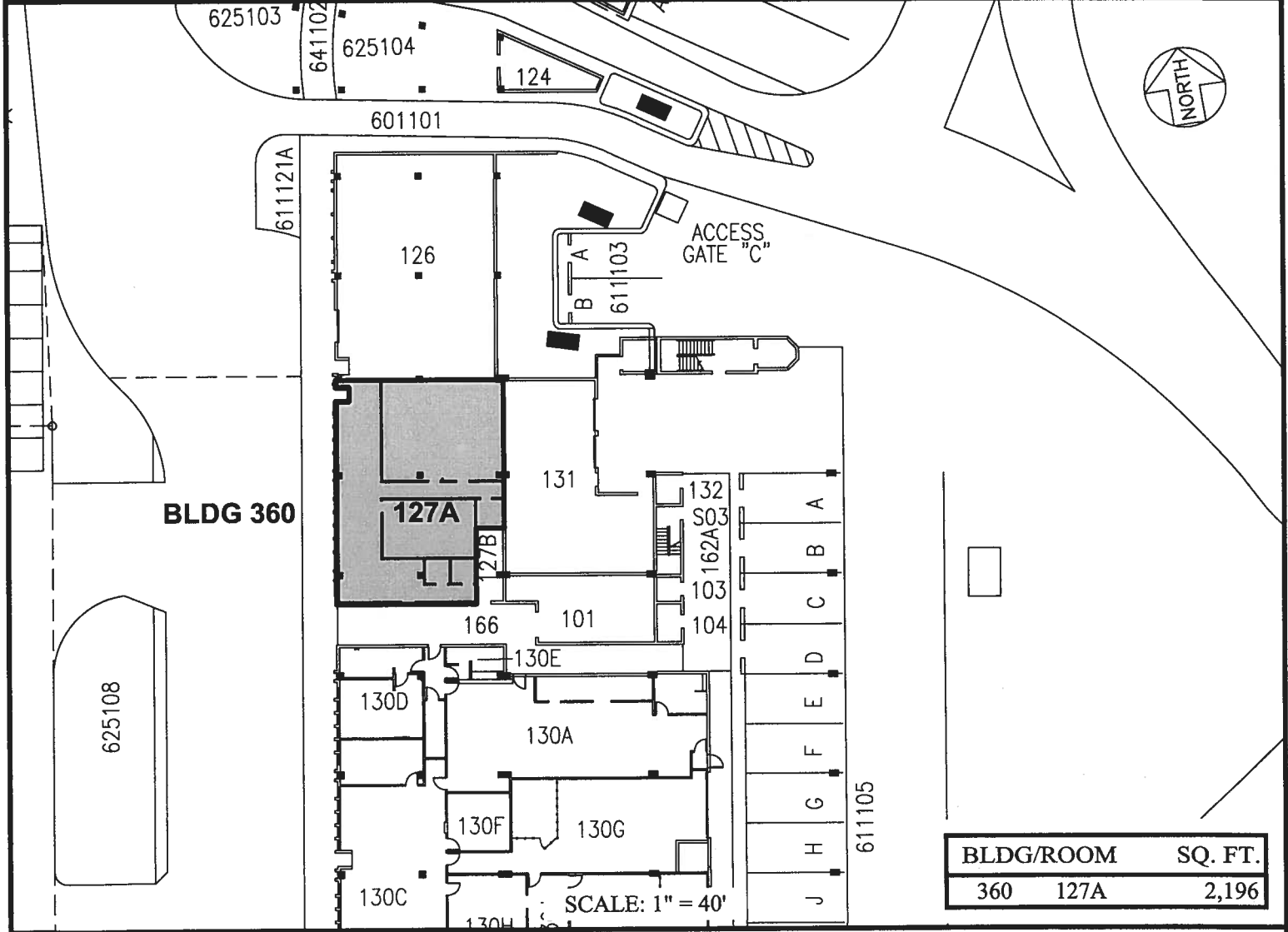
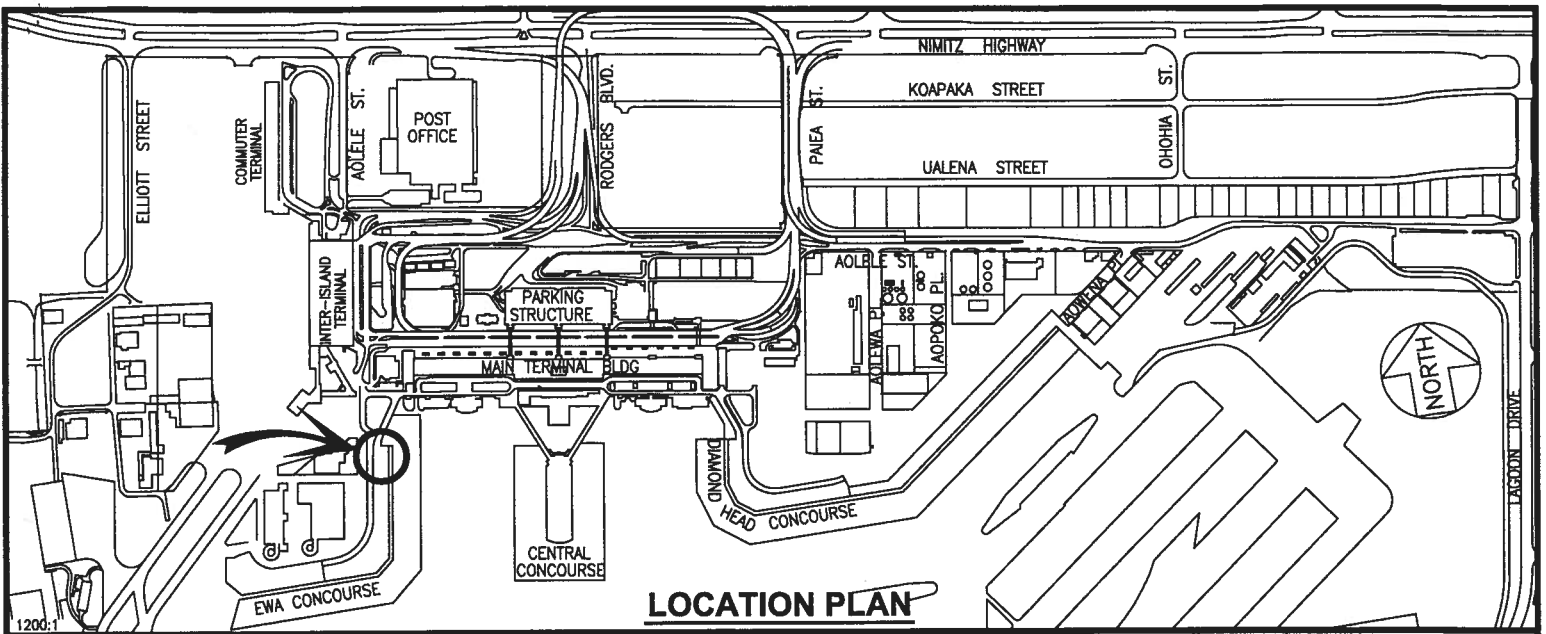

DATE : JULY 2015

EXHIBIT: **A**



Airports Division

**BUILDING 360  
EWA CONCOURSE  
GROUND LEVEL**

**360127A  
PLAT F1**