



STATE OF HAWAII
DEPARTMENT OF TRANSPORTATION
869 PUNCHBOWL STREET
HONOLULU, HAWAII 96813-5097

FORD N. FUCHIGAMI
DIRECTOR

Deputy Directors
JADE T. BUTAY
ROSS M. HIGASHI
EDWIN H. SNIFFEN
DARRELL T. YOUNG

IN REPLY REFER TO:

Board of Land and
Natural Resources
State of Hawaii
Honolulu, Hawaii

ISSUANCE OF A REVOCABLE PERMIT FOR AIR CARGO AND AIRLINE
SERVICING OPERATIONS, ALOHA CONTRACT SERVICES, LLC
KONA INTERNATIONAL AIRPORT AT KEAHOLE
TAX MAP KEY: (3) 7-3-43: PORTION OF 03

HAWAII

REQUEST:

Issuance of a Revocable Permit to Aloha Contract Services, LLC (ACS) at Kona
International Airport at Keahole (KOA)

LEGAL REFERENCE:

Sections 171-11 and 171-55, Hawaii Revised Statutes

APPLICANT:

ACS, whose business address is: 111 Ke'ehi Place, Honolulu, Hawaii, 96819

LOCATION AND TAX MAP KEY:

Portion of KOA, Kona, Island of Hawaii, identified by
Tax Map Key: 3rd Division, 7-3-43: Portion of 03

AREA:

Building/Room No. 104-103, containing an area of approximately 1,000 square feet,
Building/Room No. 104-104, containing an area of approximately 1,000 square feet,
Building/Room No. 316-101, containing an area of approximately 1,095 square feet,
Building/Room No. 321-101, containing an area of approximately 1,942 square feet,
Building/Room No. 318-101A, containing an area of approximately 378 square feet,
Area/Space No. 004-106B, containing an area of approximately 4,101 square feet,
Area/Space No. 004-106C, containing an area of approximately 4,101 square feet,
Area/Space No. 630-107, containing an area of approximately 964 square feet, and
Area/Space No. 001-106, containing an area of approximately 600 square feet, as
shown on the attached Exhibit A-1 to Exhibit A-3.

ITEM M-16

BLNR – ISSUANCE OF A REVOCABLE PERMIT FOR AIR CARGO
AND AIRLINE SERVICING OPERATIONS
ALOHA CONTRACT SERVICES, LLC
Page 2

ZONING:

State Land Use District: Urban
County of Hawaii: Airport

LAND TITLE STATUS:

Section 5(a) lands of the Hawaii Admission Act: Ceded
DHHL 30% entitlement lands pursuant to Hawaii Admission Act YES ___ NO X

CURRENT USE STATUS:

Airport and aeronautical purposes

CHARACTER OF USE:

Air cargo and airline servicing operations

COMMENCEMENT DATE:

Upon complete execution of the revocable permit

MONTHLY RENTAL:

\$13,242.48

SECURITY DEPOSIT:

\$39,727.44

HOLDOVER TENANCY:

\$441.42

DCCA VERIFICATION:

Place of business registration confirmed: YES X NO _____
Registered business name confirmed: YES X NO _____
Good standing confirmed: YES X NO _____

CHAPTER 343, HRS - ENVIRONMENTAL ASSESSMENT:

Pursuant to Section 11-200-8(a), Environmental Impact Statement Rules of the Department of Health, State of Hawaii, this disposition is exempt from requirements regarding preparation of an environmental assessment, negative declaration, or environmental impact statement as required by Chapter 343, Hawaii Revised Statutes, as amended, relating to Environmental Impact Statements, because the proposed action falls within Exemption Class #1, Comprehensive Exemption List for the State of Hawaii, Department of Transportation, dated November 15, 2000, as approved by the Environmental Quality Council. Exemption Class #1 covers operations, repairs, or maintenance of existing structures, facilities, equipment, or topographical features involving negligible or no expansion or change of use beyond that previously existing.

REMARKS:

The Department of Transportation (DOT) has no objections to ACS's request and therefore, in accordance with Sections 171-11 and 171-55, HRS, relating to Public Purposes and Permits, respectively and therefore, the DOT proposes to issue a month-to-month revocable permit to ACS, Bldg/Room Nos. 104-103, 104-104, 316-101, 321-101, 318-101A, and Area/Space Nos. 004-106B, 004-106C, 630-107, 001-106 for its air cargo and airline servicing operations at KOA.

RECOMMENDATION:

That the Board authorize the Department of Transportation to issue a month-to-month revocable permit to ACS, subject to: (1) terms and conditions herein outlined, which are by reference incorporated herein; and (2) such additional terms and conditions as may be prescribed by the Director of Transportation to best serve the interests of the State.

Respectfully submitted,

FORD N. FUCHIGAMI
Director of Transportation

APPROVED FOR SUBMITTAL:

SUZANNE D. CASE
Chairperson and Member

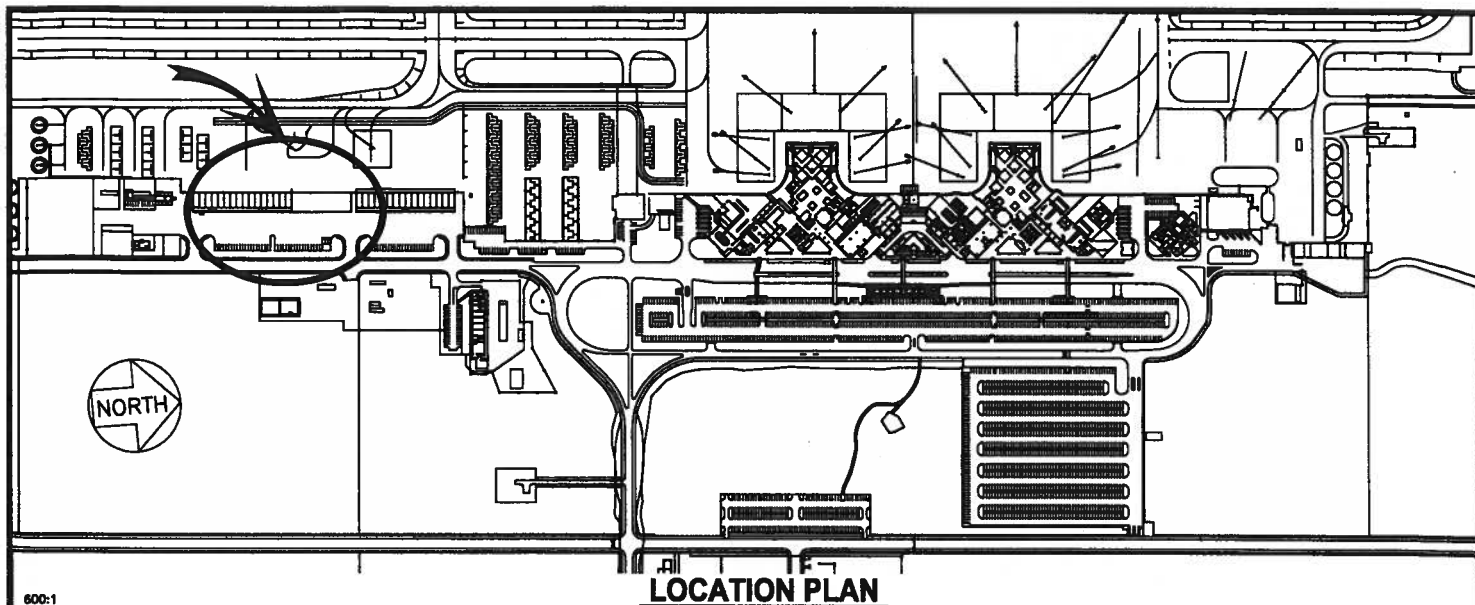

LOCATION PLAN

600:1

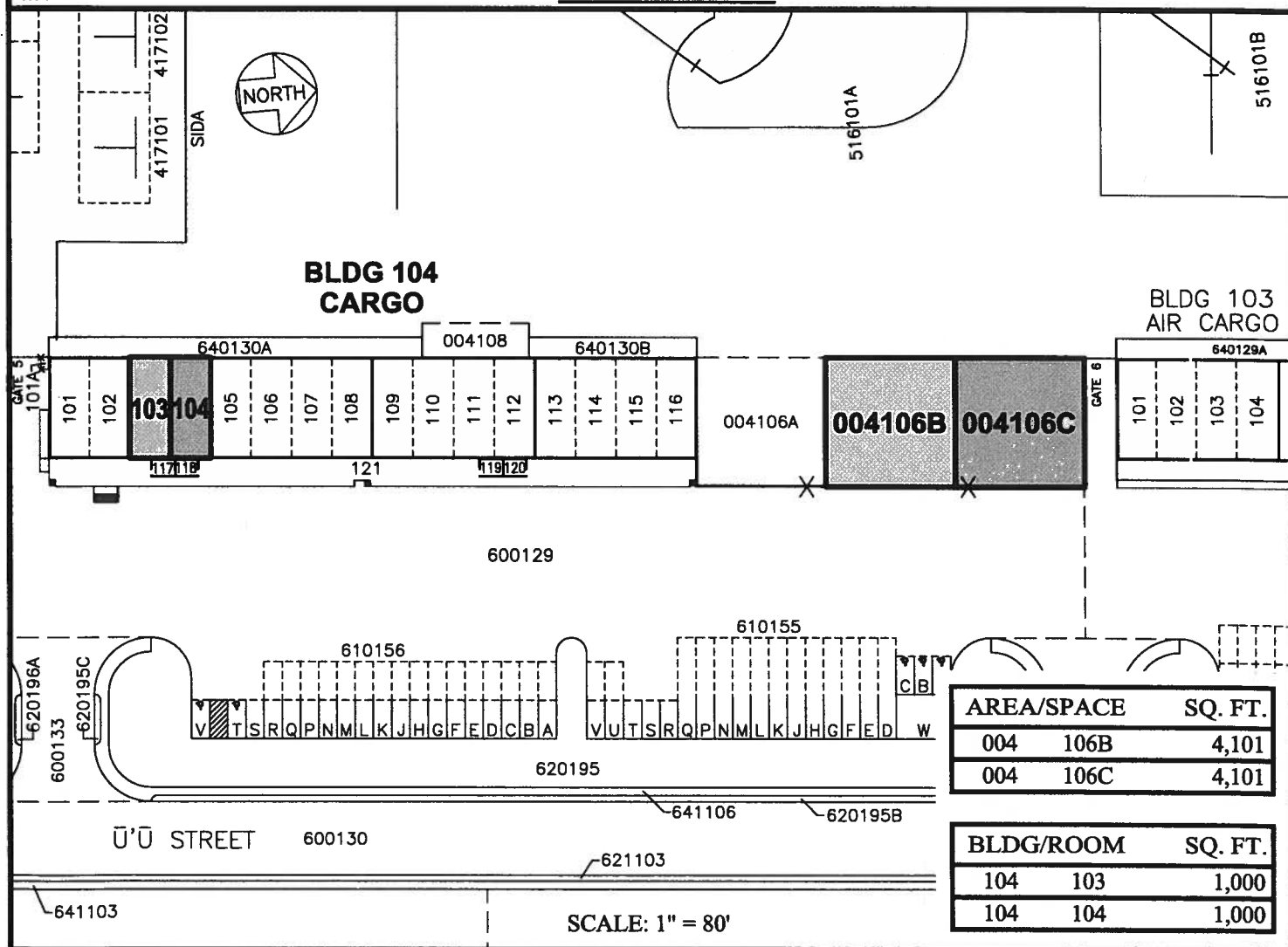

**BLDG 104
CARGO**

**BLDG 103
AIR CARGO**

AREA/SPACE	SQ. FT.
004 106B	4,101
004 106C	4,101

BLDG/ROOM	SQ. FT.
104 103	1,000
104 104	1,000

SCALE: 1" = 80'

DATE : OCTOBER 2015

EXHIBIT: **A-1**



Airports Division

**ALOHA CONTRACT
SERVICES, LLC**

**BUILDING 104
& LOTS
GROUND LEVEL**

**004106B & C
104103
104104
PLATS B1, C1, 39**

N:\AIRPORTS\KOA_Kona\CAD\PM\koa_Aloha Contract Services\RPB429\koa_ACS-Cargo-Equipment prkg-01.dwg

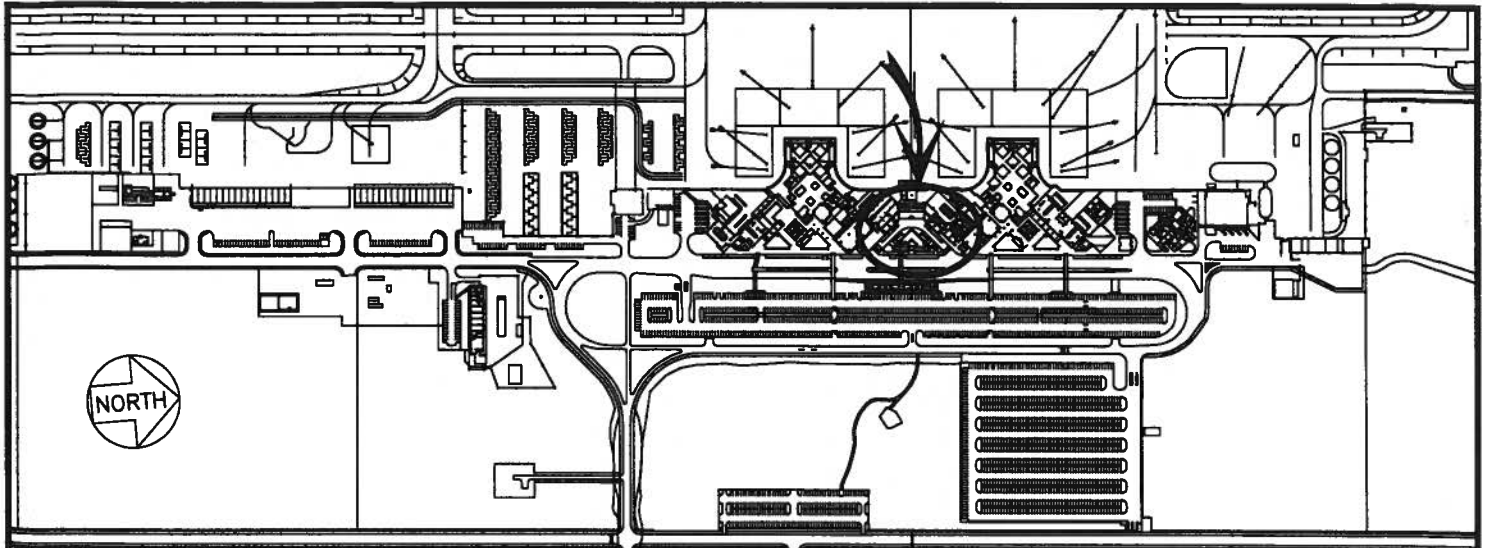

LOCATION PLAN

600:1

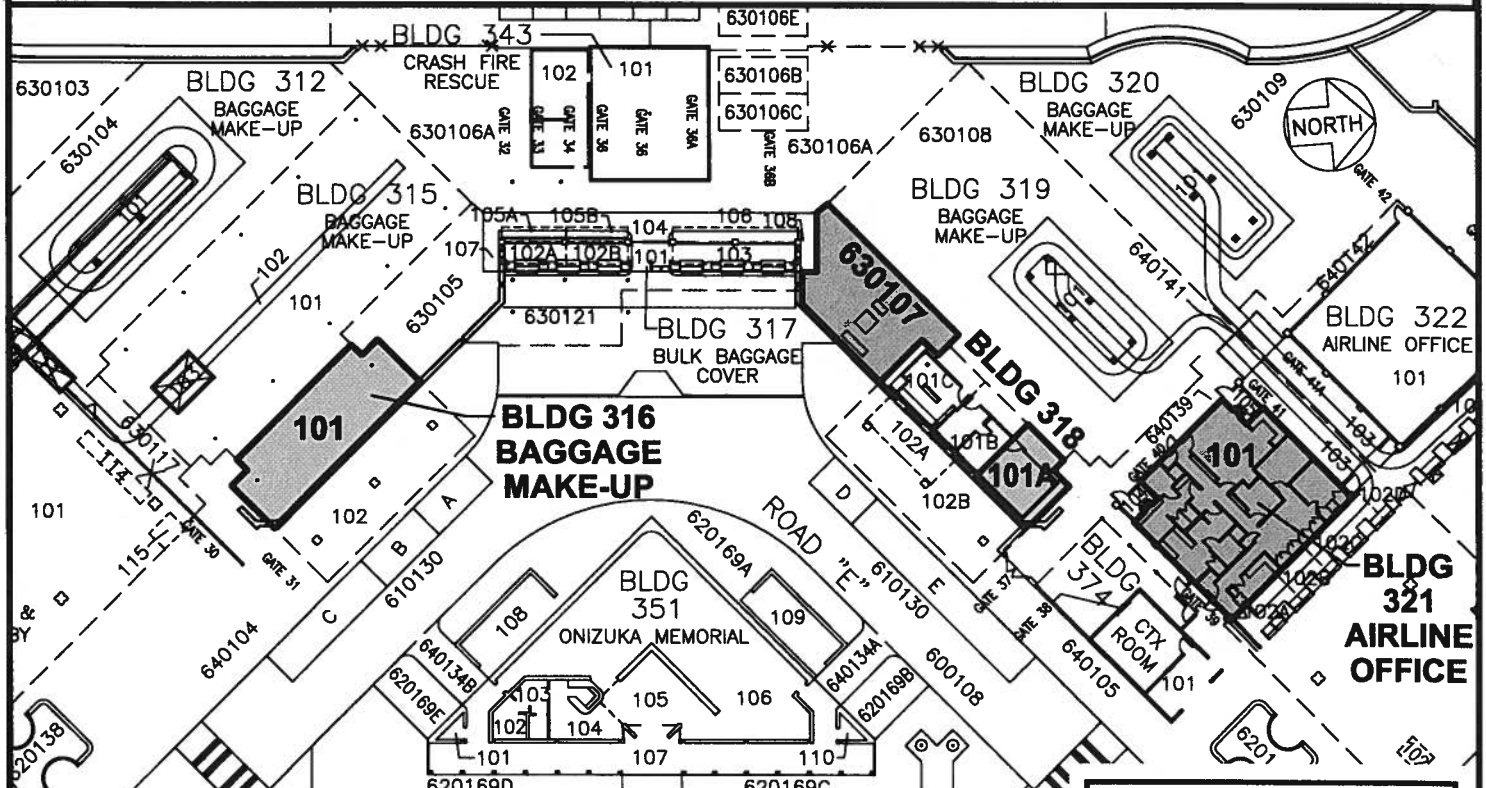

BLDG/ROOM	SQ. FT.
316 101	1,095
318 101A	378
321 101	1,942

AREA/SPACE	SQ. FT.
630 107	964

SCALE: 1" = 50'

DATE : OCTOBER 2015

EXHIBIT: **A-2**



Airports Division

ALOHA CONTRACT SERVICES, LLC

**BUILDINGS 316, 318 & 321
& PAVED AREA
GROUND LEVEL**

316101
318101A
321101
630107
PLATS E1, 58

KONA INTERNATIONAL AIRPORT AT KEAHOLE

N:\AIRPORTS\KOA_Kona\CAD\PM\koa_Aloha Contract Services\RP8429\koa_ACS-Cargo-Equipment prkg-01.dwg

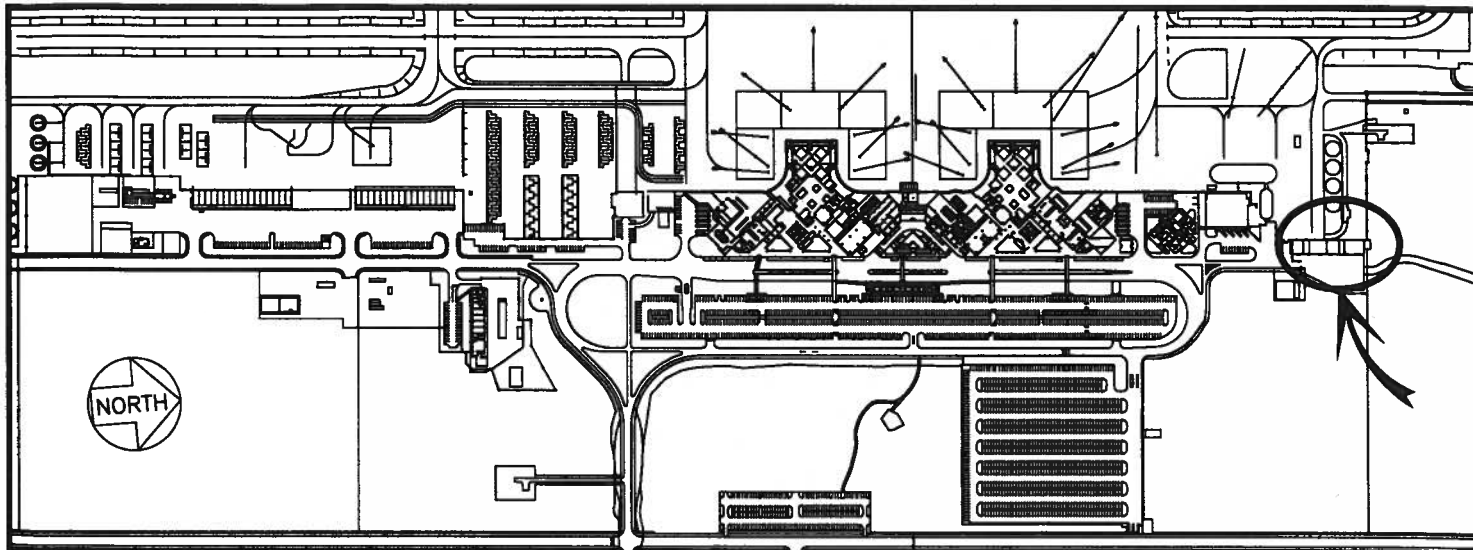

LOCATION PLAN

600:1

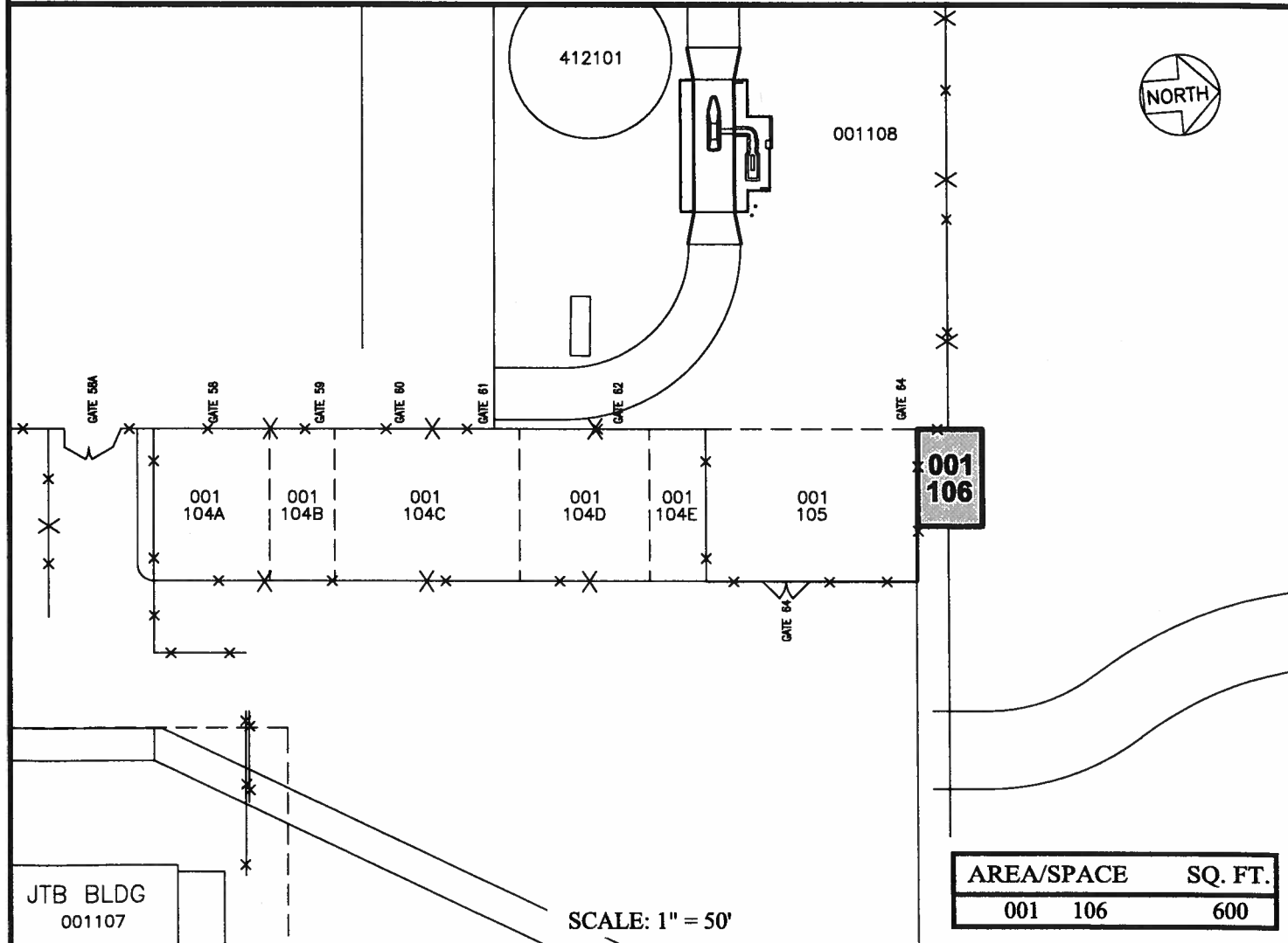

AREA/SPACE	SQ. FT.
001 106	600

DATE : OCTOBER 2015

EXHIBIT: **A-3**



ALOHA CONTRACT SERVICES, LLC

LOT

001106
PLATS F1, 58