



STATE OF HAWAII
DEPARTMENT OF TRANSPORTATION
869 PUNCHBOWL STREET
HONOLULU, HAWAII 96813-5097

FORD N. FUCHIGAMI
DIRECTOR

Deputy Directors
JADE T. BUTAY
ROSS M. HIGASHI
EDWIN H. SNIFFEN
DARRELL T. YOUNG

IN REPLY REFER TO:

Board of Land and
Natural Resources
State of Hawaii
Honolulu, Hawaii

AMENDMENT TO PRIOR BOARD ACTION OF AUGUST 28, 2015, ITEM M-6
ISSUANCE OF A REVOCABLE PERMIT
AVIATION ACADEMY HAWAII, LLC
HONOLULU INTERNATIONAL AIRPORT
TAX MAP KEY: (1) 1-1-72:13 (PORTION OF)

OAHU

On August 28, 2015, under agenda Item M-6, the Land Board authorized the Department of Transportation (DOT) to issue a month-to-month Revocable Permit to Aviation Academy Hawaii, LLC, for the use Building/Room Nos. 210-102B and 210-103, to conduct General Aviation Flight Operations and Aircraft Maintenance at Honolulu International Airport.

PURPOSE:

The DOT requests certain changes to the AREA, MONTHLY RENTAL, and HOLDOVER TENANCY, as written on said submittal previously approved by the Land Board (attached).

The changes should read as follows:

AREA:

Original:

Building/Room No. 210-102B, containing an area of approximately 2,388 square feet; and Building/Room No. 210-103, containing an area of approximately 2,262 square feet, as shown and delineated on the attached map labeled Exhibit "A".

Amended:

Building/Room No. 210-102B, containing an area of approximately 2,388 square feet; and Building/Room No. 210-103, containing an area of approximately 1,719 square feet, as shown and delineated on the attached map labeled Exhibit "A".

ITEM M-7

MONTHLY RENTAL:

Original:

\$3,119.34

Amended:

\$2,874.99

HOLDOVER TENANCY:

Original:

\$103.98

Amended:

\$95.83

REMARKS:

All other terms as outlined in the submittal previously approved by the Land Board remain unchanged.

RECOMMENDATION:

The Land Board amends its prior action of August 28, 2015, under agenda Item M-6, by approving the changes to the Area, Monthly Rental, and Holdover Tenancy, for the issuance of a month-to-month Revocable Permit to Aviation Academy Hawaii, LLC, as herein outlined, which are by reference incorporated herein and subject to such other terms and conditions as may be prescribed by the Director of Transportation to best serve the interests of the State.

Respectfully submitted,



FORD N. FUCHIGAMI
Director of Transportation

APPROVED FOR SUBMITTAL:



SUZANNE D. CASE
Chairperson and Member

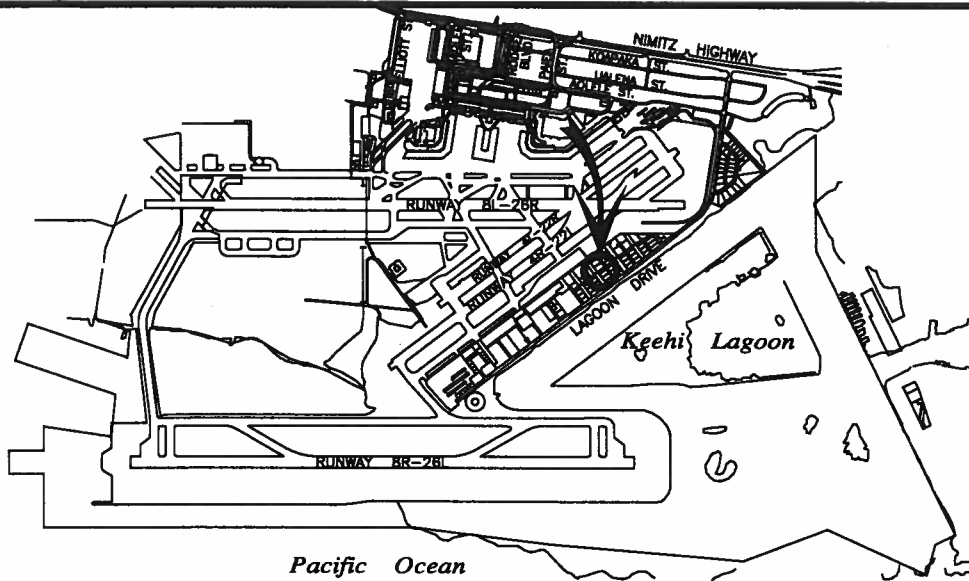

LOCATION PLAN

5000:1

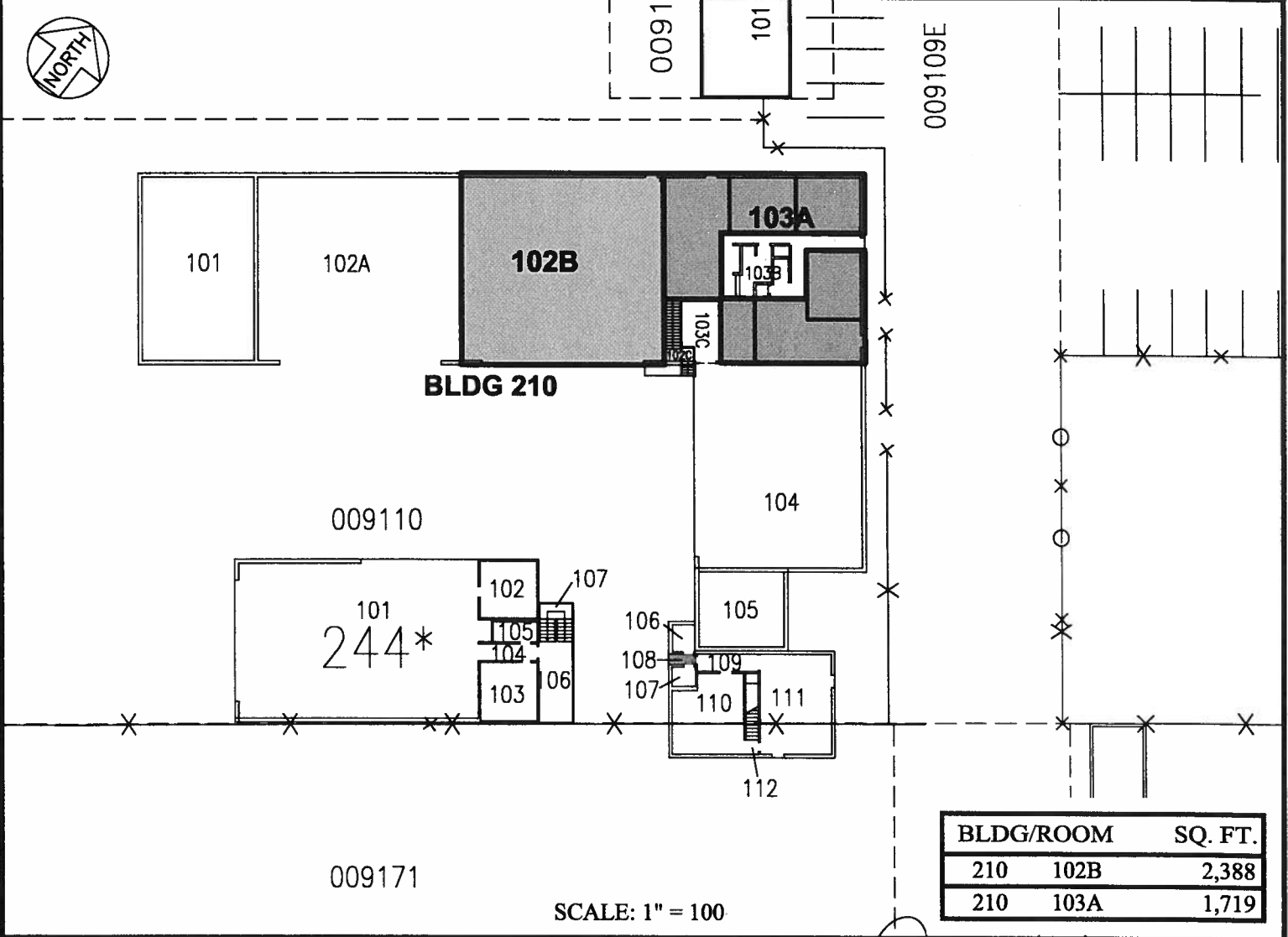

BLDG/ROOM	SQ. FT.
210 102B	2,388
210 103A	1,719

SCALE: 1" = 100

DATE : OCTOBER 2015

EXHIBIT: **A**



Airports Division

AVIATION ACADEMY
HAWAII, LLC.

**BUILDING 210
FIXED-BASED OP FACILITY
SOUTH RAMP**

210102B
210103A

PLAT 24

HONOLULU INTERNATIONAL AIRPORT

DAVID Y. IGE
GOVERNOR



STATE OF HAWAII
DEPARTMENT OF TRANSPORTATION
869 PUNCHBOWL STREET
HONOLULU, HAWAII 96813-5097

FORD. N. FUCHIGAMI
DIRECTOR

Deputy Director
JADE T. BUTAY
ROSS M. HIGASHI
EDWIN H. SNIFFIN
DARRELL T. YOUNG

IN REPLY REFER TO:

AUG 28 2015

Board of Land and
Natural Resources
State of Hawai'i
Honolulu, Hawai'i

ISSUANCE OF A REVOCABLE PERMIT
FOR FLIGHT OPERATIONS AND AIRCRAFT MAINTENANCE
AVIATION ACADEMY HAWAII LLC
HONOLULU INTERNATIONAL AIRPORT
TAX MAP KEY: (1) 1-1-72: 13 (PORTION OF)

O'AHU

LEGAL REFERENCE:

Section 171-55, Hawai'i Revised Statutes

APPLICANT:

AVIATION ACADEMY HAWAII LLC, a Limited Liability Company, authorized to do business in the State of Hawai'i, whose mailing address is P.O. Box 893841, Mililani, Hawai'i 96701.

LOCATION:

120 Kapalulu Place, Honolulu, Hawai'i 96819, identified as Building No. 210 at the Honolulu International Airport, TMK: (1) 1-1-72: 13 (Portion of).

AREA:

Building/Room No. 210-102B, containing an area of approximately 2,388 square feet; and Building/Room No. 210-103, containing an area of approximately 2,262 square feet, as shown and delineated on the attached map labeled Exhibit "A".

ZONING:

State Land Use District: Urban
City and County of Honolulu LUO: Industrial (I-2)

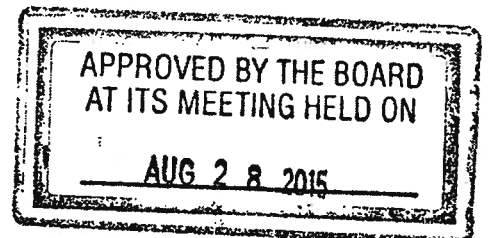

LAND TITLE STATUS:

Public Law 88-233 - lands of the Hawai'i Admission Act - Ceded
DHHL 30% entitlement lands pursuant to the Hawai'i State Constitution: YES_ NO X

ITEM M-6

**BLNR – ISSUANCE OF A REVOCABLE PERMIT
AVIATION ACADEMY HAWAII, LLC.**

Page 2

CURRENT USE STATUS:

Land presently encumbered by Governor's Executive Order No. 3201, dated June 8, 1983, setting aside 3,152.177 acres designated as Honolulu International Airport under the control and management of the State of Hawai'i, Department of Transportation, Airports Division (DOTA) for Airport Purposes.

CHARACTER OF USE:

General Aviation Flight Operations and Aircraft Maintenance.

COMMENCEMENT DATE:

Upon execution of the revocable permit.

MONTHLY RENTAL:

\$3,119.34

SECURITY DEPOSIT:

Three (3) times the monthly rental in effect.

HOLDOVER TENANCY:

\$103.98

DCCA VERIFICATION:

Place of business registration confirmed:	YES <u>X</u>	NO _____
Registered business name confirmed:	YES <u>X</u>	NO _____
Good standing confirmed:	YES <u>X</u>	NO _____

CHAPTER 343, HRS - ENVIRONMENTAL ASSESSMENT:

Pursuant to Section 11-200-8(a), Environmental Impact Statement Rules of the Department of Health, State of Hawai'i, this disposition is exempt from requirements regarding preparation of an environmental assessment, negative declaration, or environmental impact statement as required by Chapter 343, Hawai'i Revised Statutes, as amended, relating to Environmental Impact Statements, because the proposed action falls within Exemption Class #1, Comprehensive Exemption List for the State of Hawai'i, Department of Transportation, dated November 15, 2000, as approved by the Environmental Quality Council. Exemption Class #1 covers operations, repairs, or maintenance of existing structures, facilities, equipment, or topographical features involving negligible or no expansion or change of use beyond that previously existing.

**BLNR – ISSUANCE OF A REVOCABLE PERMIT
AVIATION ACADEMY HAWAII, LLC.**

Page 3

REMARKS:

In accordance with Section 171-5, HRS, relating to Permits, the Department of Transportation proposes to issue a month-to-month revocable permit to Aviation Academy Hawaii LLC, for the use of Building 210-102B and 210-103, to conduct General Aviation Flight Operations and Aircraft Maintenance.

RECOMMENDATION:

That the Board authorizes the Department of Transportation to issue a month-to-month revocable permit to Aviation Academy Hawaii LLC. subject to: (1) terms and conditions herein outlined, which are by reference incorporated herein; and (2) such additional terms and conditions as may be prescribed by the Director of Transportation to best serve the interests of the State.

Respectfully submitted,



FORD N. FUCHIGAMI
Director of Transportation

APPROVED FOR SUBMITTAL:



SUZANNE D. CASE
Chairperson and Member

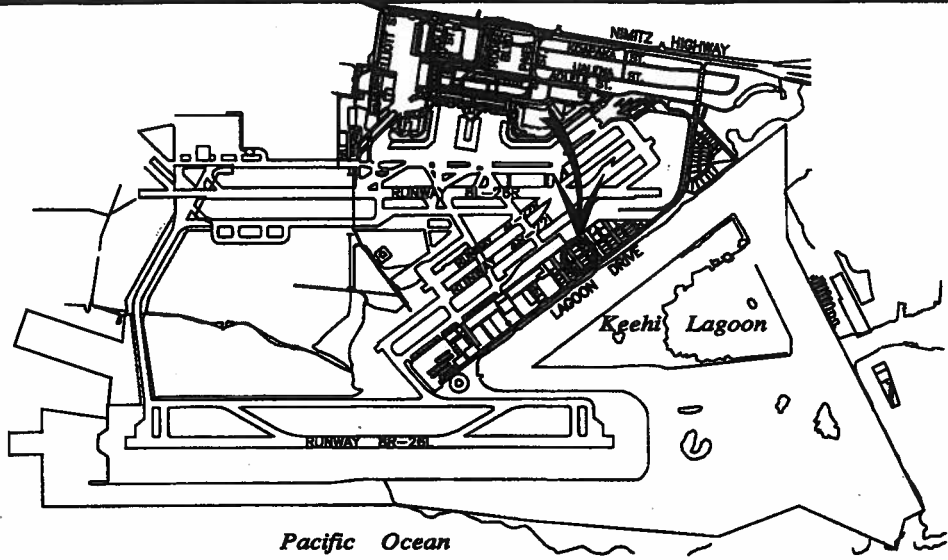

LOCATION PLAN

5000:1

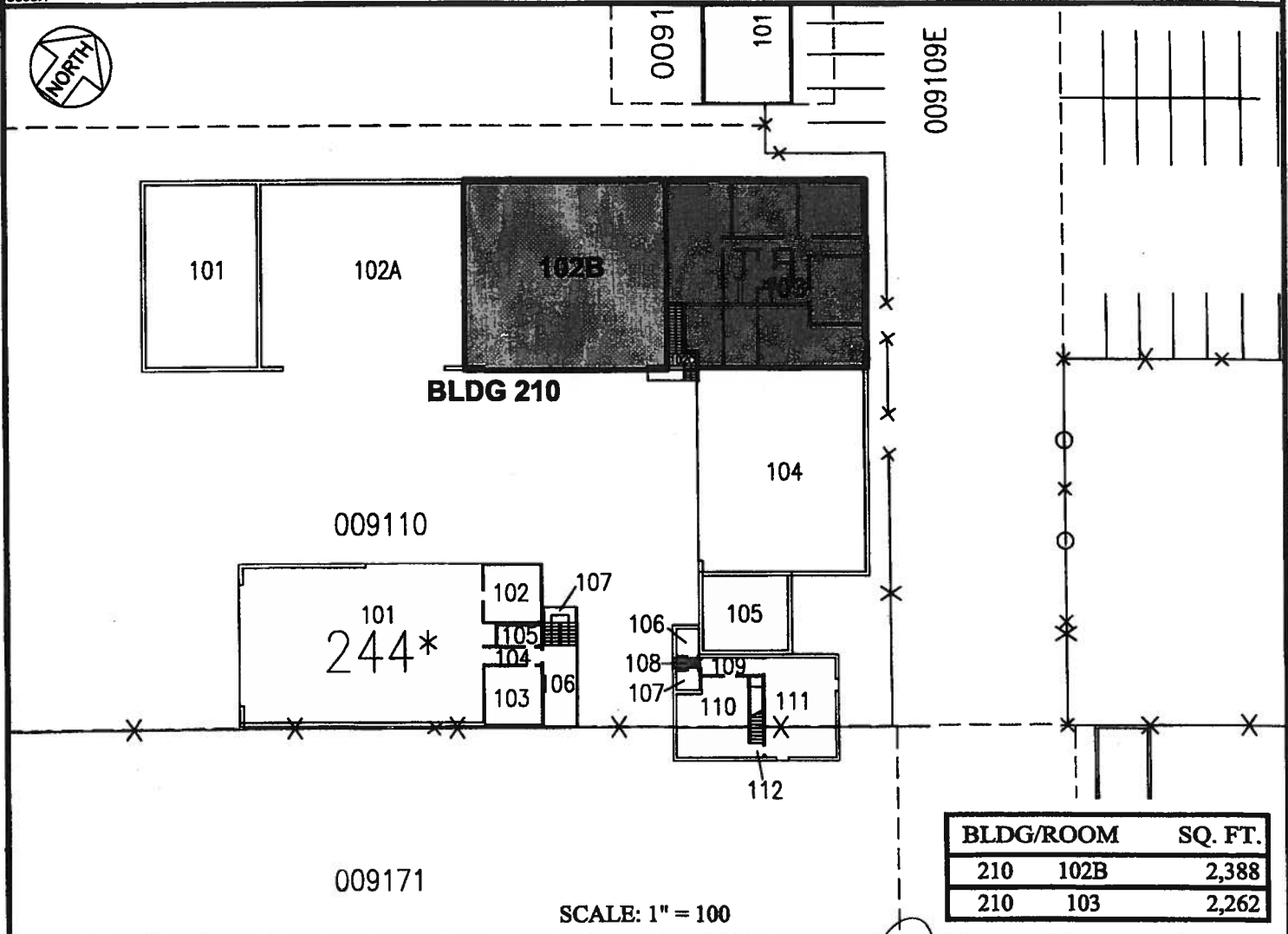

BLDG/ROOM	SQ. FT.
210 102B	2,388
210 103	2,262

SCALE: 1" = 100

DATE : August 2015

EXHIBIT: **A**



Airports Division

AVIATION ACADEMY HAWAII

**BUILDING 210
FIXED-BASED OP FACILITY
SOUTH RAMP**

210102B
210103

PLAT 24

HONOLULU INTERNATIONAL AIRPORT

N:\AIRPORTS\HNL_HONOLULU\CAD\PM\HNL_210103-01.DWG