

DAVID Y. IGE
GOVERNOR



STATE OF HAWAII
DEPARTMENT OF TRANSPORTATION
869 PUNCHBOWL STREET
HONOLULU, HAWAII 96813-5097

FORD N. FUCHIGAMI
DIRECTOR

Deputy Directors
JADE T. BUTAY
ROSS M. HIGASHI
EDWIN H. SNIFFEN
DARRELL T. YOUNG

IN REPLY REFER TO:

Board of Land and
Natural Resources
State of Hawai'i
Honolulu, Hawai'i

ISSUANCE OF A REVOCABLE PERMIT FOR AIRCRAFT STORAGE
SKYDIVE ACADEMY OF HAWAII, CORP.
KAWAIHĀPAI AIRFIELD, WAIALUA, HAWAI'I
TAX MAP KEY: (1) 6-08-14-16 & 17 (PORTION)

OAHU

LEGAL REFERENCE:

Section 171-55, Hawai'i Revised Statutes.

APPLICANT:

Skydive Academy of Hawaii, Corp., whose mailing address is 68-760 Farrington Highway, Waialua, Hawai'i 96791.

LOCATION:

Portion of Kawaihāpai Airfield, Waialua, Island of Oahu, State of Hawai'i, identified by Tax Map Key: 1st Division, 6-08-14-16 & 17 (portion).

AREA:

Area/Space No. 401-101, 401-102, 401-103, and 402-101, containing an area of approximately 1,130, 1,107, 1,107, and 1,130 square feet, respectively, as delineated on the attached map labeled Exhibit A.

ZONING:

State Land Use District: Agriculture
City and County of Honolulu LUO: AG-2

ITEM M-11

**BLNR – ISSUANCE OF A REVOCABLE PERMIT FOR AIRCRAFT STORAGE
SKYDIVE ACADEMY OF HAWAII, CORP.**

Page 2

LAND TITLE STATUS:

Ceded land, which the State of Hawai‘i is currently leasing the land from the United States of America.

CHARACTER OF USE:

Aircraft storage

COMMENCEMENT DATE:

To be determined by the Director of Transportation at a later date.

MONTHLY RENTAL:

\$376.00 – Hangar 401-101
\$376.00 – Hangar 401-102
\$376.00 – Hangar 401-103
\$343.00 – Hangar 402-101

SECURITY DEPOSIT:

Three (3) times the monthly rent in effect.

HOLDOVER TENANCY:

\$49.03

DCCA VERIFICATION:

Place of business registration confirmed:	YES <u>X</u>	NO _____
Registered business name confirmed:	YES <u>X</u>	NO _____
Good standing confirmed:	YES <u>X</u>	NO _____

CHAPTER 343, HRS - ENVIRONMENTAL ASSESSMENT:

The subject land area is covered by the revised and updated Environmental Assessment for the Dillingham Airfield Master Plan and FAR Part 150 Noise Compatibility Program project, referenced as State Contract No. 26985, State Project No. AO2011-01. This Environmental Assessment evaluated the environmental effects of the recommended Dillingham Airfield Master Plan to meet existing and forecast general aviation demands and was prepared for the State of Hawai‘i, Department of Transportation, Airports Division.

BLNR – ISSUANCE OF A REVOCABLE PERMIT FOR AIRCRAFT STORAGE
SKYDIVE ACADEMY OF HAWAII, CORP.

Page 3

REMARKS:

In accordance with Section 171-55, HRS, relating to Permits, the Department of Transportation proposes to issue a month-to-month revocable permit to Skydive Academy of Hawaii, Corp. for aircraft storage, Space Nos. 401-101, 401-102, 401-103, and 402-101, at Kawaihapai Airfield.

RECOMMENDATION:

That the Board authorize the Department of Transportation to issue a month-to-month revocable permit to Skydive Academy of Hawaii, Corp., subject to: (1) terms and conditions herein outlined, which are by reference incorporated herein; and (2) such additional terms and conditions as may be prescribed by the Director of Transportation to best serve the interests of the State.

Respectfully submitted,



FORD N. FUCHIGAMI
Director of Transportation

APPROVED FOR SUBMITTAL:



SUZANNE D. CASE
Chairperson and Member

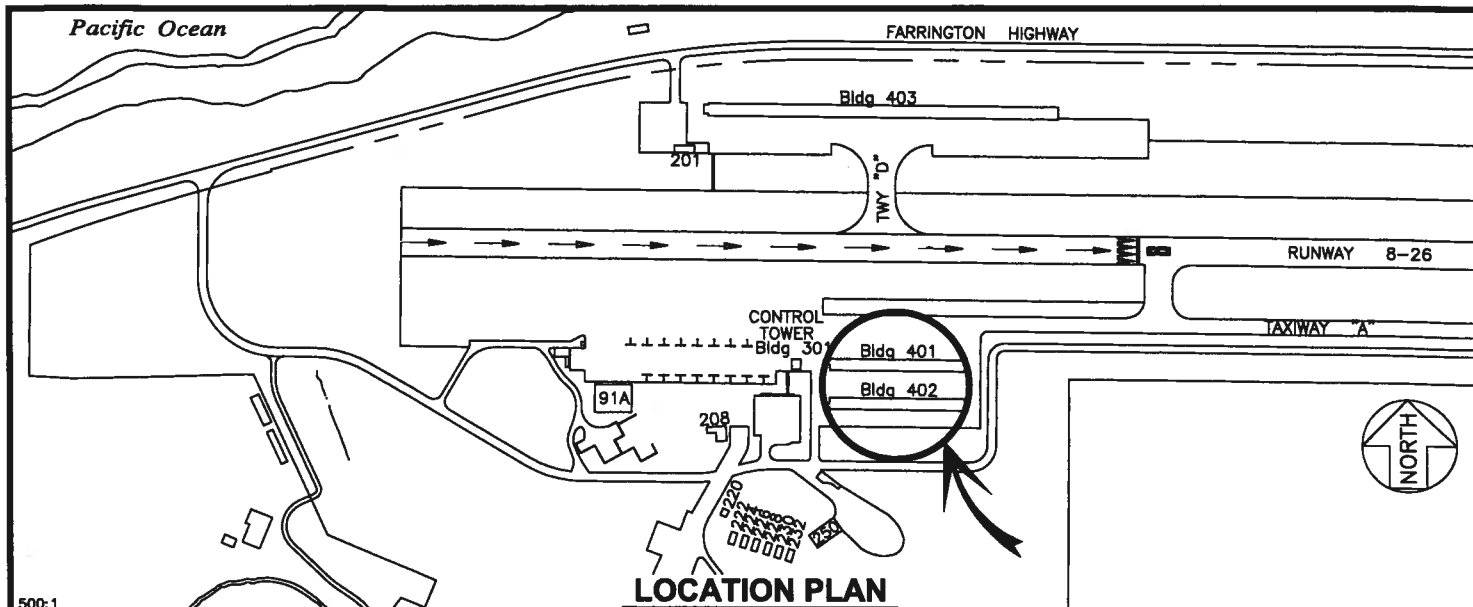

500:1

LOCATION PLAN

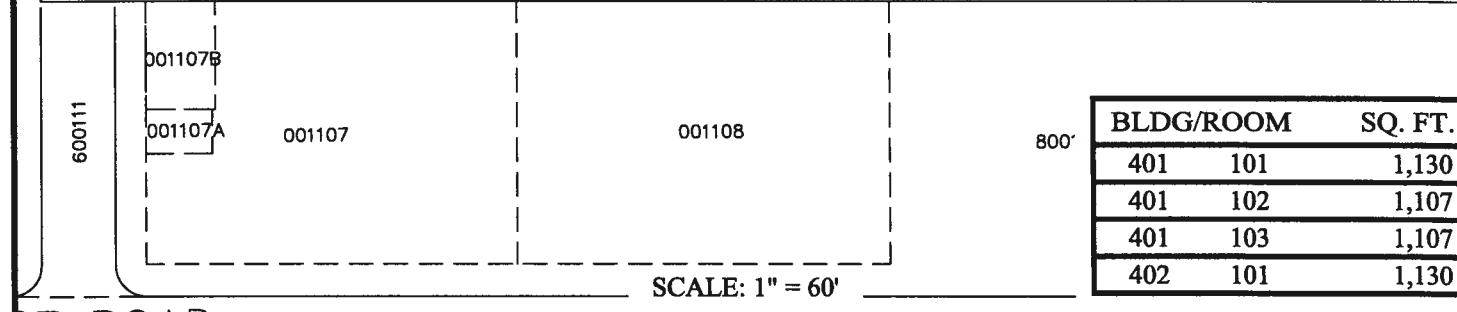
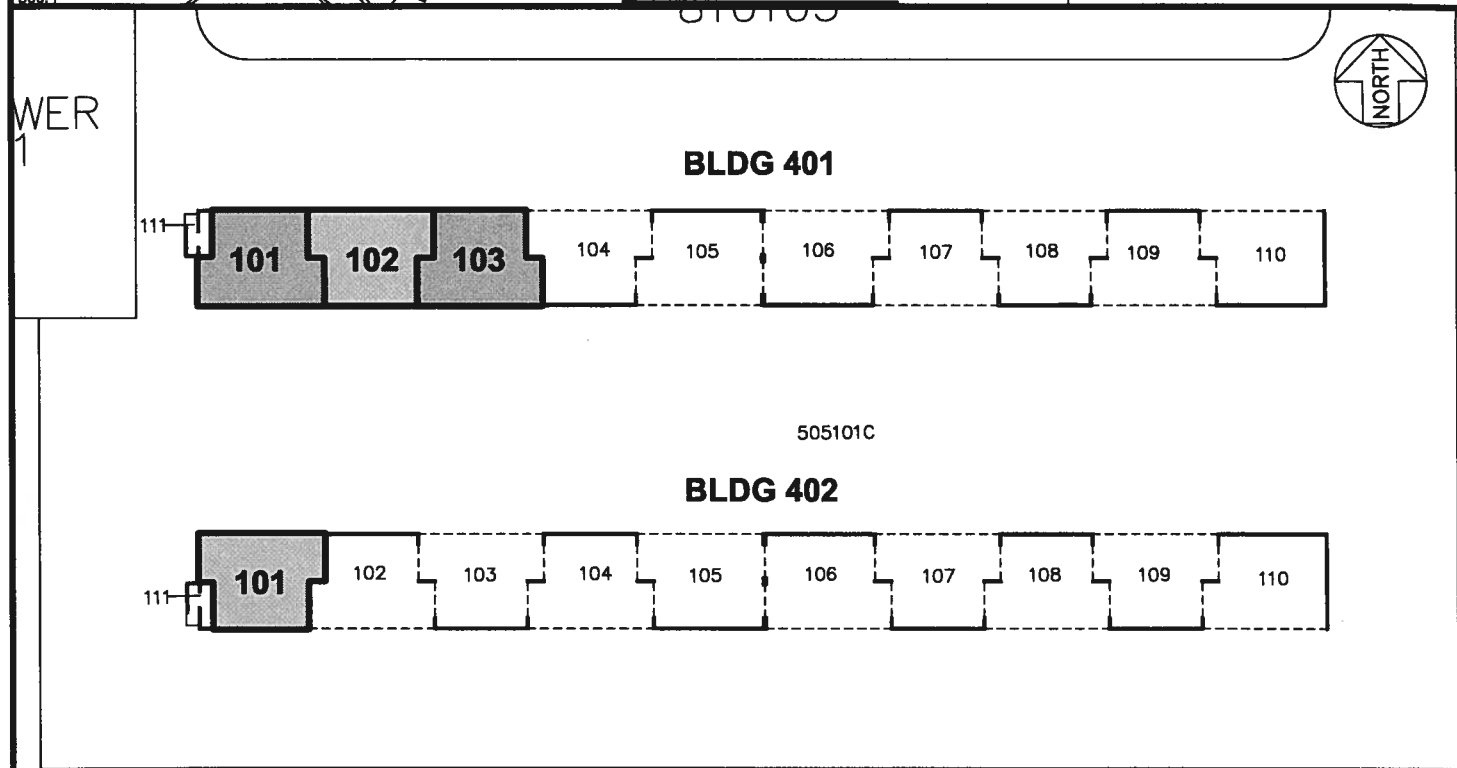

BLDG/ROOM	SQ. FT.
401 101	1,130
401 102	1,107
401 103	1,107
402 101	1,130

SCALE: 1" = 60'

RP--8437	DATE : OCTOBER 2015	EXHIBIT: A
	SKYDIVE ACADEMY OF HAWAII, CORP.	401101-103 402101
	BUILDING 401 & 402 T-HANGARS GROUND LEVEL	PLAT B1

DILLINGHAM AIRFIELD

N:\AIRPORTS\HCH_Dillingham\CAD\PM\hwh_401101-01.dwg