

DAVID Y. IGE
GOVERNOR



STATE OF HAWAII
DEPARTMENT OF TRANSPORTATION
869 PUNCHBOWL STREET
HONOLULU, HAWAII 96813-5097

FORD N. FUCHIGAMI
DIRECTOR

Deputy Directors
JADE T. BUTAY
ROSS M. HIGASHI
EDWIN H. SNIFFEN
DARRELL T. YOUNG

IN REPLY REFER TO:

Board of Land and
Natural Resources
State of Hawaii
Honolulu, Hawaii

ISSUANCE OF A REVOCABLE PERMIT FOR A T-HANGAR
AIR VENTURES HAWAII, LLC AND NORTON R. SMITH
LIHUE AIRPORT
TAX MAP KEY: (4) 3-5-01: PORTION OF 8

KAUAI

APPLICANT:

Air Ventures Hawaii, LLC and Norton R. Smith (AVH) whose business address is
P.O. Box 3350, Lihue, Hawaii 96766.

LEGAL REFERENCE:

Section 171-11 and 171-55, Hawaii Revised Statutes

LOCATION AND TAX MAP KEY:

Portion of Lihue Airport, Lihue, Island of Kauai, identified by
Tax Map Key: 4th Division, 3-5-01: Portion of 8

AREA:

Area/Space No. 410-106, containing an area of approximately 1,624 square feet,
as shown on the attached Exhibit "A".

ZONING:

State Land Use: Urban
County: Industrial (IG-STP)

LAND TITLE STATUS:

Section 5(a), Hawaii Admissions Act: Non-Ceded
DHHL, 30% entitlement lands Yes _____ No X

BLNR – ISSUANCE OF A REVOCABLE PERMIT FOR A T-HANGAR
AIR VENTURES HAWAII, LLC AND NORTON R. SMITH
Page 2

CURRENT USE STATUS:

Airport and aeronautical purposes

CHARACTER OF USE:

T-Hangar

COMMENCEMENT DATE:

Upon complete execution of the revocable permit

MONTHLY RENTAL:

\$896.20

SECURITY DEPOSIT:

\$2,688.60

REMARKS:

The issuance of a Revocable Permit to AVH at Lihue Airport complies with Chapter 343, Exemption Class 1.D.10 as a continuing aeronautical use, and is in accordance with Section 171-55 HRS, relating to Permits.

RECOMMENDATION:

That the Board authorize the Department of Transportation to issue a month-to-month Revocable Permit to AVH, subject to: (1) terms and conditions herein outlined, which are by reference incorporated herein; and (2) such additional terms and conditions as may be prescribed by the Director of Transportation to best serve the interests of the State.

Respectfully submitted,



FORD N. FUCHIGAMI
Director of Transportation

APPROVED FOR SUBMITTAL:



SUZANNE D. CASE
Chairperson and Member

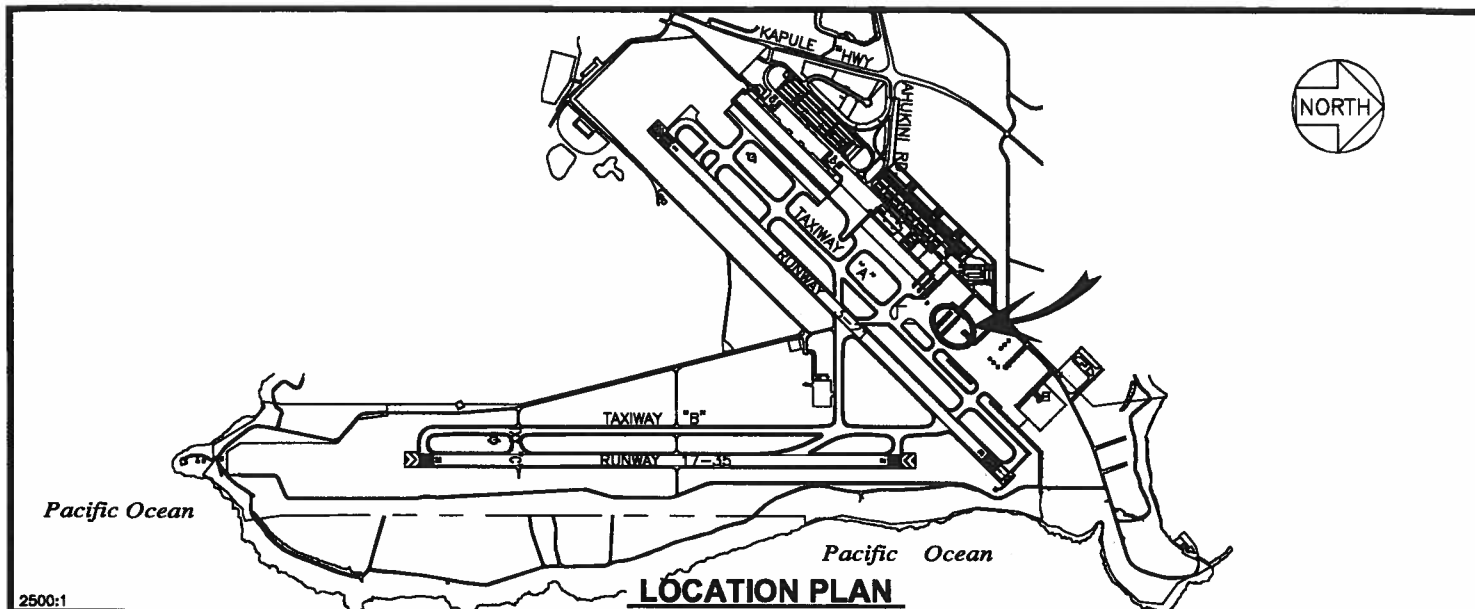

2500:1

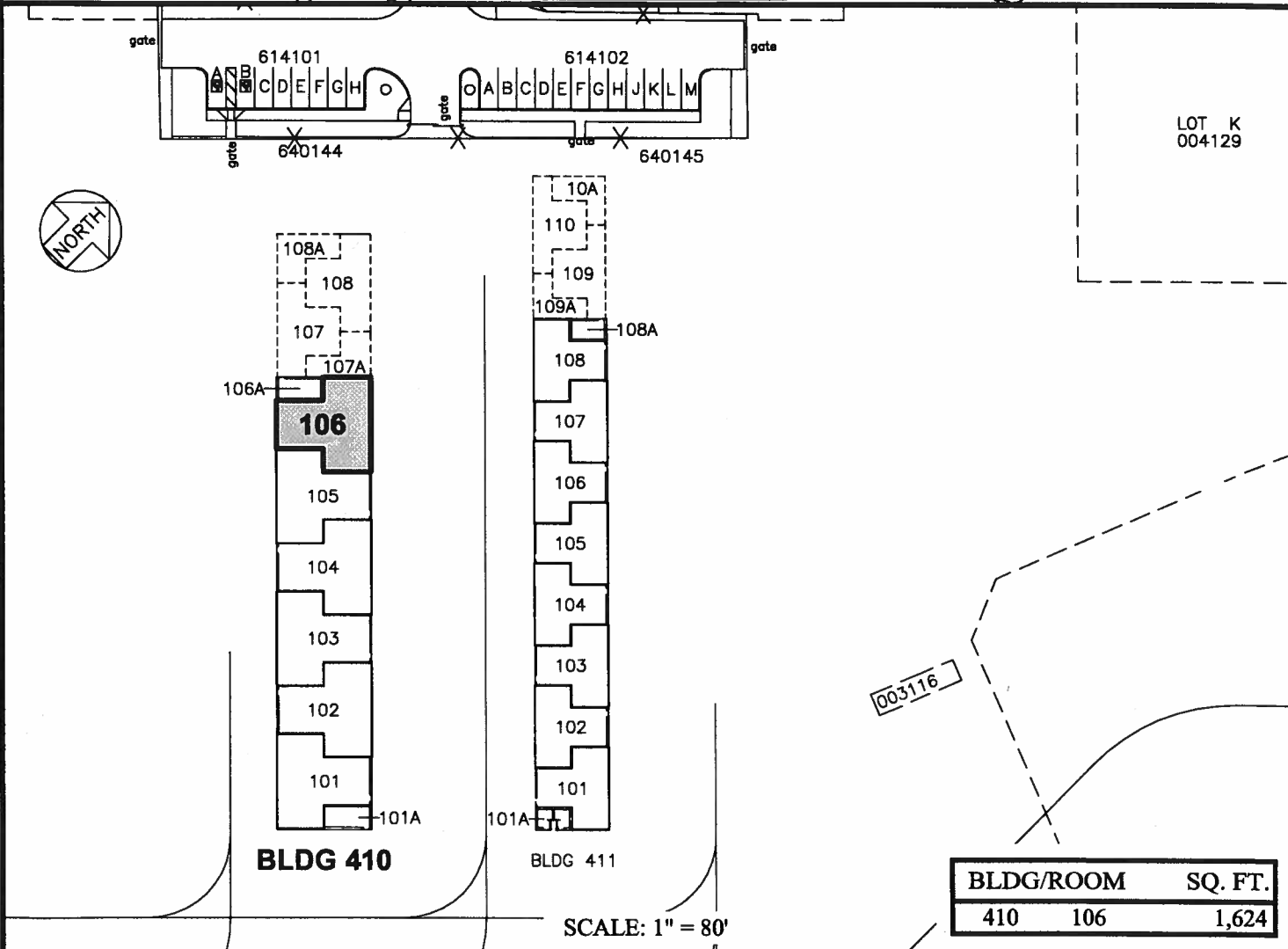

RP-8443	DATE : OCTOBER 2015	EXHIBIT: A
 Airports Division	AIR VENTURES HAWAII, LLC. NORTON R. SMITH	BUILDING 410 T-HANGAR GROUND LEVEL
		410106 PLATS E1, 35

LIHUE AIRPORT