



STATE OF HAWAII
DEPARTMENT OF TRANSPORTATION
869 PUNCHBOWL STREET
HONOLULU, HAWAII 96813-5097

FORD N. FUCHIGAMI
DIRECTOR

Deputy Directors
JADE T. BUTAY
ROSS M. HIGASHI
EDWIN H. SNIFFEN
DARRELL T. YOUNG

IN REPLY REFER TO:

Board of Land and
Natural Resources
State of Hawai'i
Honolulu, Hawai'i

CONSENT TO ASSIGNMENT OF STATE LEASE NO. DOT-A-81-0014
GARY OWEN GALIHER AND DIANE TSUGIE ONO TO GARY OWEN GALIHER
HONOLULU INTERNATIONAL AIRPORT O'AHU
TAX MAP KEY: (1) 1-1-72: 23

REQUEST:

Consent to Assignment of State Lease No. DOT-A-81-0014 from Gary Owen Galiher and Diane Tsugie Ono, as Lessee/Assignor, to Gary Owen Galiher, as Assignee at Honolulu International Airport.

LEGAL REFERENCE:

Subsection 171-36(a) (5), Hawai'i Revised Statutes, as amended

APPLICANTS:

LESSEE/ASSIGNOR: Gary Owen Galiher and Diane Tsugie Ono, whose mailing address is 610 Ward Avenue, Honolulu, Hawai'i 96814.

ASSIGNEE: Gary Owen Galiher, whose mailing address is 610 Ward Avenue, Honolulu, Hawai'i 96814.

LEASE AREA:

Area/Space No. 009-116, containing a land area of approximately 25,877 square feet, as shown and delineated on the attached map labeled Exhibit A.

LOCATION AND TAX MAP KEY:

Portion of Honolulu International Airport, Honolulu, Island of Oahu, identified by Tax Map Key: 1st Division, 1-1-72: 23

ITEM M-5

BLNR -- Consent to Assignment
State Lease No. DOT-A-81-0014
Gary Owen Galiher and Diane Tsugie Ono to Gary Owen Galiher
Page 2

ZONING:

State Land Use District: Urban District
City and County of Honolulu: Industrial (I-2)

LAND TITLE STATUS:

Section 5(b) – lands (ceded) of the Hawai‘i Admission Act
DHHL 30% entitlement lands pursuant to the Hawai‘i State Constitution: YES __ NO X

CURRENT USE STATUS:

Land presently encumbered by Governor’s Executive Order No. 3201, setting aside a portion of Honolulu International Airport under the control and management of the Department of Transportation, Airports Division, State of Hawai‘i, for Airport purposes.

CHARACTER OF USE:

Hangar Facility

TERM OF LEASE:

Thirty-Five (35) Years, March 1, 1981 through February 28, 2016.

CONSIDERATION:

One and No/100 Dollars (\$1.00)

RECOMMENDED PREMIUM:

None

REMARKS:

The State of Hawai‘i, Department of Transportation, Airports Division has no objections to the Assignment of State Lease No. DOT-A-81-0014 between the Lessee/Assignor and the Assignee.

BLNR – Consent to Assignment
State Lease No. DOT-A-81-0014
Gary Owen Galiher and Diane Tsugie Ono to Gary Owen Galiher
Page 3

RECOMMENDATION:

That the Board approves of and gives its approval to the Consent to Assignment of Lease No. DOT-A-81-0014, subject to: (1) the terms and conditions herein outlined, which are by reference incorporated herein; (2) such other terms and conditions as may be prescribed by the Director of Transportation to best serve the interests of the State; and (3) review and approval of the Department of the Attorney General, as to the form and content of the Consent to the Assignment of Lease No. DOT-A-81-0014.

Respectfully submitted,



FORD N. FUCHIGAMI
Director of Transportation

APPROVED FOR SUBMITTAL:



SUZANNE D. CASE
Chairperson and Member

EXHIBIT "A"

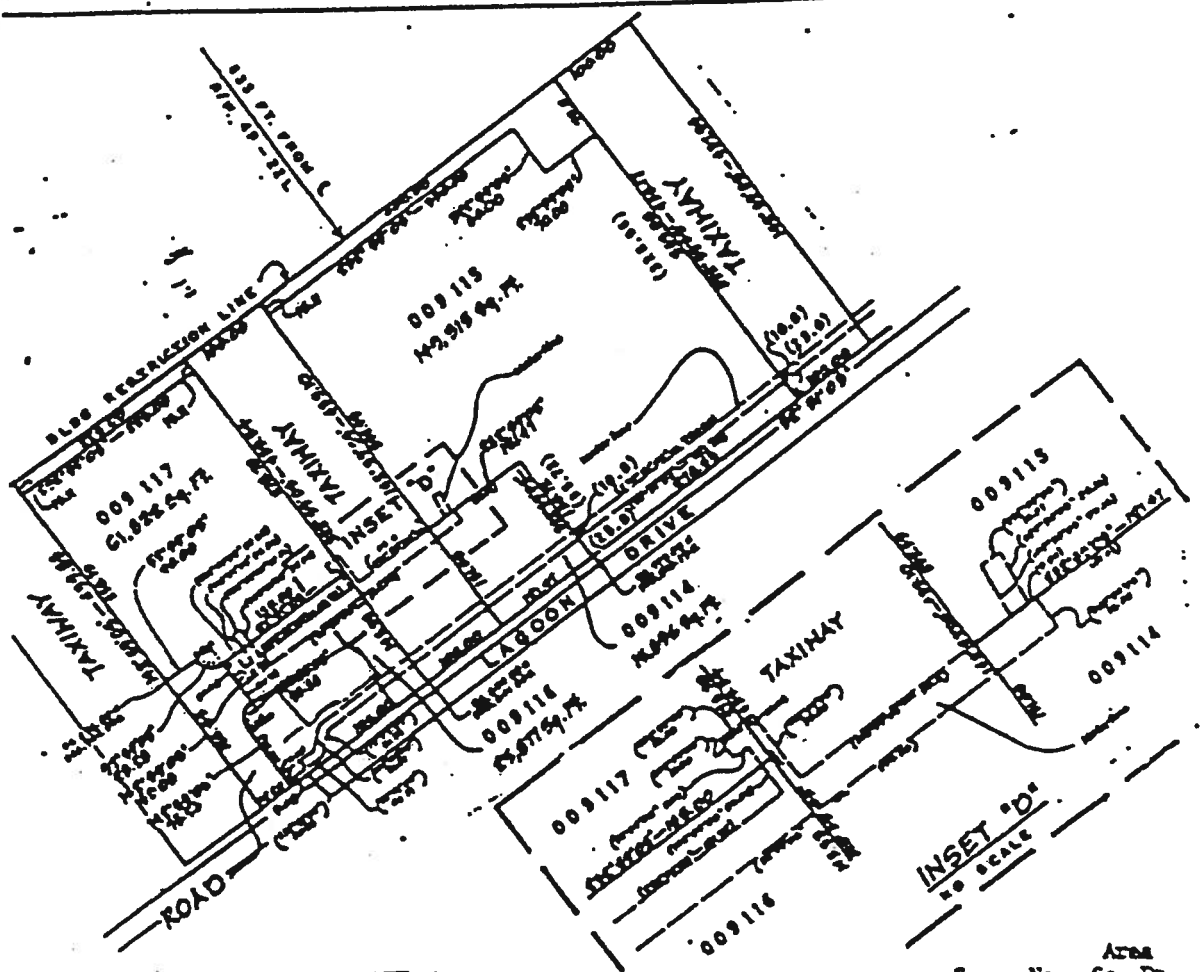
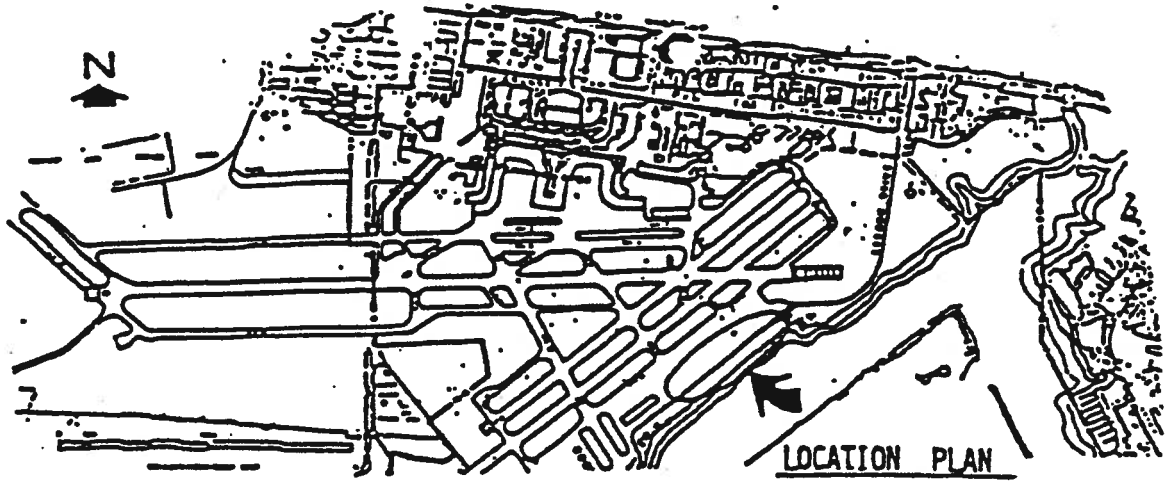

- NOTES:**
1. MAXIMUM HEIGHT OF BUILDINGS 40 FT. NEAR SEA LEVEL EXCEPT BUILDINGS IN LOTS 009103 TO 009104 INCLUSIVE SHALL BE 36 FT. NEAR SEA LEVEL.
 2. ALIQUOTS & COORDINATES REFERRED TO HAWAII STATE PLAN COORDINATE SYSTEM SERIES 3.

Space No.	Area Sq. Ft.
009-116	25,577

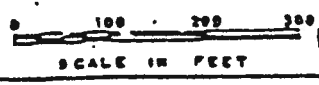

Lease No. DOT-A-81-14

EXHIBIT: A



**SOUTH RAMP:
FIXED-BASED OPERATORS
SUBDIVISION**

PLAT.

Honolulu International Airport