



STATE OF HAWAII
DEPARTMENT OF TRANSPORTATION
869 PUNCHBOWL STREET
HONOLULU, HAWAII 96813-5097

FORD N. FUCHIGAMI
DIRECTOR

Deputy Directors
JADE T. BUTAY
ROSS M. HIGASHI
EDWIN H. SNIFFEN
DARRELL T. YOUNG

IN REPLY REFER TO:

Board of Land and
Natural Resources
State of Hawaii
Honolulu, Hawaii

ISSUANCE OF A REVOCABLE PERMIT FOR
COMMERCIAL HELICOPTER OPERATIONS
MAUNA LOA HELICOPTERS TOURS LLC
LIHUE AIRPORT
TAX MAP KEY: (4) 3-5-01: PORTION OF 8

KAUAI

APPLICANT:

Mauna Loa Helicopters Tours LLC (MLH) whose business address is:
73-310 U'u Street, Kailua-Kona, Hawaii 96740

LEGAL REFERENCE:

Sections 171-11 and 171-55, Hawaii Revised Statutes

LOCATION AND TAX MAP KEY:

Portion of Lihue Airport, Lihue, Island of Kauai, identified by
Tax Map Key: 4th Division, 3-5-01: Portion of 8

AREA:

Area/Space No. 011-104H, containing an area of approximately 8,439 square feet, and
Area/Space No. 011-104J, containing an area of approximately 3,000 square feet, as
shown on the attached Exhibit "A".

ZONING:

State Land Use District: Urban
County of Kauai: Industrial (IG-STP)

LAND TITLE STATUS:

Section 5(a) lands of the Hawaii Admission Act: Non-Ceded
DHHL 30% entitlement lands pursuant to Hawaii Admission Act YES ___ NO X

ITEM M-14

BLNR – ISSUANCE OF A REVOCABLE PERMIT FOR COMMERCIAL HELICOPTER OPERATIONS, MAUNA LOA HELICOPTER TOURS LLC
Page 2

CURRENT USE STATUS:

Airport and aeronautical purposes

CHARACTER OF USE:

Commercial helicopter operations

COMMENCEMENT DATE:

Upon complete execution of the revocable permit

MONTHLY RENTAL:

\$2,135.28

SECURITY DEPOSIT:

\$6,405.84

HOLDOVER TENANCY:

\$71.18

DCCA VERIFICATION:

Place of business registration confirmed:	YES <u>X</u>	NO _____
Registered business name confirmed:	YES <u>X</u>	NO _____
Good standing confirmed:	YES <u>X</u>	NO _____

CHAPTER 343, HRS - ENVIRONMENTAL ASSESSMENT:

Pursuant to Section 11-200-8(a), Environmental Impact Statement Rules of the Department of Health, State of Hawaii, this disposition is exempt from requirements regarding preparation of an environmental assessment, negative declaration, or environmental impact statement as required by Chapter 343, Hawaii Revised Statutes, as amended, relating to Environmental Impact Statements, because the proposed action falls within Exemption Class #1, Comprehensive Exemption List for the State of Hawaii, Department of Transportation, dated November 15, 2000, as approved by the Environmental Quality Council. Exemption Class #1 covers operations, repairs, or maintenance of existing structures, facilities, equipment, or topographical features involving negligible or no expansion or change of use beyond that previously existing.

BLNR – ISSUANCE OF A REVOCABLE PERMIT FOR COMMERCIAL HELICOPTER OPERATIONS, MAUNA LOA HELICOPTER TOURS LLC

Page 3

REMARKS:

The Department of Transportation (DOT) has no objections to MLH's request and therefore, in accordance with Sections 171-11 and 171-55, HRS, relating to Public Purposes and Permits, respectively and therefore, the DOT proposes to issue a month-to-month revocable permit to MLH, Area/Space Nos. 011-104H and 011-104J for its commercial helicopter operations at Lihue Airport.

RECOMMENDATION:

That the Board authorize the Department of Transportation to issue a month-to-month revocable permit to MLH, subject to: (1) terms and conditions herein outlined, which are by reference incorporated herein; and (2) such additional terms and conditions as may be prescribed by the Director of Transportation to best serve the interests of the State.

Respectfully submitted,

FORD N. FUCHIGAMI
Director of Transportation

APPROVED FOR SUBMITTAL:

SUZANNE D. CASE
Chairperson and Member

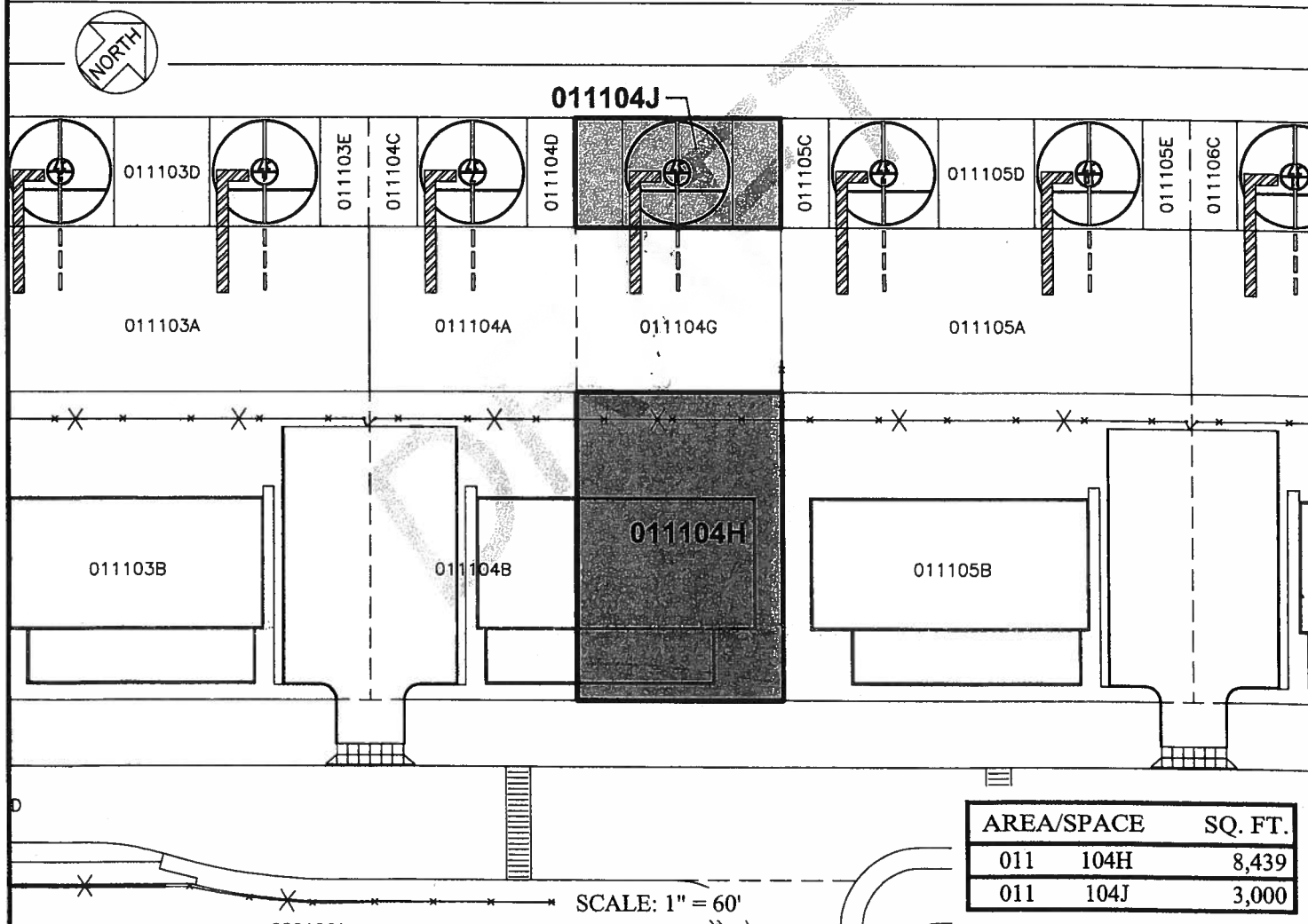
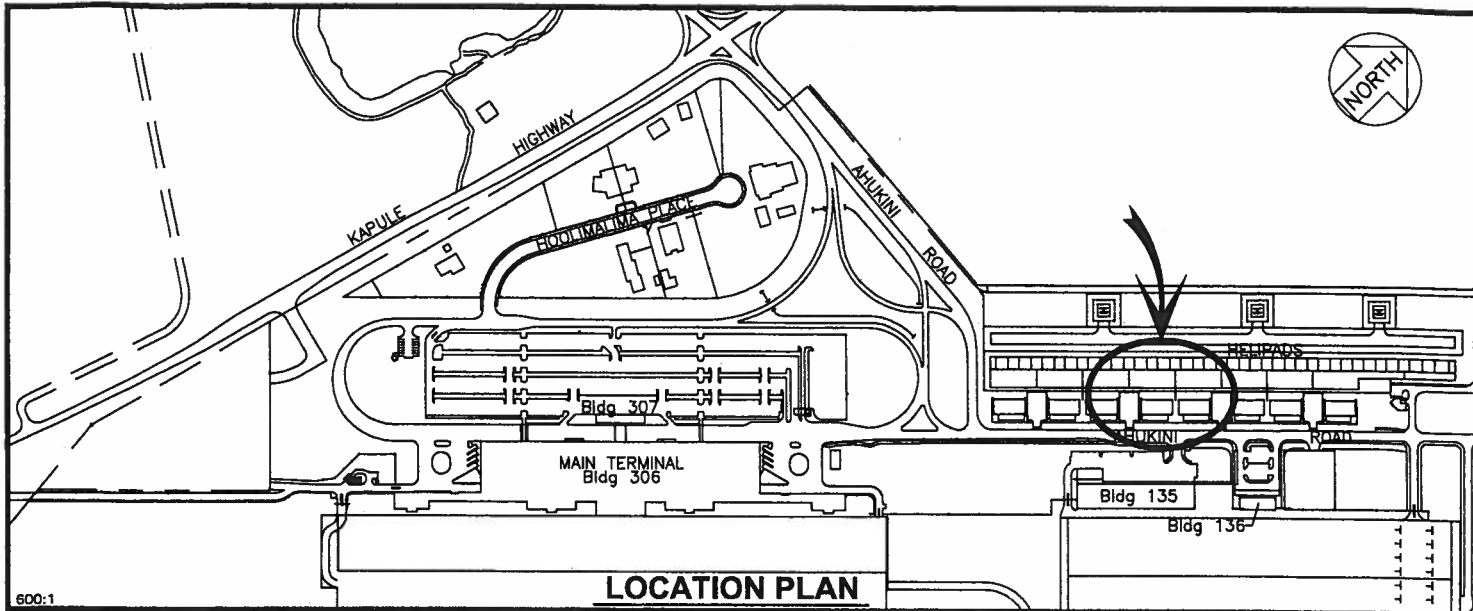

DRAFT

DATE : SEPTEMBER 2015

EXHIBIT: **A**



Airports Division

MAUNA LOA
HELICOPTER TOURS LLC

HELIPORT
LOTS
GROUND LEVEL

011104H
011104J
PLATS A1, 35

LIHUE AIRPORT