

DAVID Y. IGE  
GOVERNOR



STATE OF HAWAII  
DEPARTMENT OF TRANSPORTATION  
869 PUNCHBOWL STREET  
HONOLULU, HAWAII 96813-5097

FORD N. FUCHIGAMI  
DIRECTOR

Deputy Directors  
JADE T. BUTAY  
ROSS M. HIGASHI  
EDWIN H. SNIFFIN  
DARRELL T. YOUNG

IN REPLY REFER TO:

Board of Land and  
Natural Resources  
State of Hawaii  
Honolulu, Hawaii

ISSUANCE OF A REVOCABLE PERMIT FOR AIRLINE OFFICE  
JIN AIR CO., LTD.  
HONOLULU INTERNATIONAL AIRPORT  
TAX MAP KEY: (1) 1-1-003: 051 (PORTION)

OAHU

APPLICANT:

Jin Air Co., Ltd. (Jin Air), whose business address is 300 Rodgers Boulevard, #70  
Honolulu, Hawaii 96819

LEGAL REFERENCE:

Section 171-55, Hawaii Revised Statutes

LOCATION:

Building 342, Waiting Lobby, Second Level, at Honolulu International Airport,  
Tax Map Key: 1<sup>st</sup> Division, 1-1-003: 051 (Portion)

AREA:

Building/Space No. 342-258B, containing an area of approximately  
252 square feet, as shown and delineated on the attached map labeled Exhibit "A".

ZONING:

State Land Use District: Urban  
City and County of Honolulu LUO: Industrial (I-2)

LAND TITLE STATUS:

Non-Ceded - Section 5(a) lands of the Hawaii Admission Act  
DHHL 30% entitlement lands pursuant to Hawaii Admission Act YES  NO

CURRENT USE STATUS:

Land presently encumbered by Governor’s Executive Order No. 3201, dated June 8, 1983, setting aside 3,152.177 acres designated as Honolulu International Airport under the control and management of the State of Hawaii, Department of Transportation, Airports Division for Airport Purposes.

CHARACTER OF USE:

Jin Air will use the space to operate and maintain an airline office as a part of its airline operations at Honolulu International Airport.

COMMENCEMENT DATE:

To be determined by the Director of Transportation at a later date.

MONTHLY RENTAL:

\$1,301.37

SECURITY DEPOSIT:

Three (3) times the monthly rental in effect

HOLDOVER TENANCY:

\$43.38

DCCA VERIFICATION:

Place of business registration confirmed:	YES <u>X</u>	NO _____
Registered business name confirmed:	YES <u>X</u>	NO _____
Good standing confirmed:	YES <u>X</u>	NO _____

CHAPTER 343, HRS - ENVIRONMENTAL ASSESSMENT:

Pursuant to Section 11-200-8(a), Environmental Impact Statement Rules of the Department of Health, State of Hawaii, this disposition is exempt from requirements regarding preparation of an environmental assessment, negative declaration, or environmental impact statement as required by Chapter 343, Hawaii Revised Statutes, as amended, relating to Environmental Impact Statements, because the proposed action falls within Exemption Class #1, Comprehensive Exemption List for the State of Hawaii,

BLNR – ISSUANCE OF A REVOCABLE PERMIT FOR AIRLINE OFFICE  
JIN AIR CO., LTD.  
Page 3

Department of Transportation, dated November 15, 2000, as approved by the Environmental Quality Council. Exemption Class #1 covers operations, repairs, or maintenance of existing structures, facilities, equipment, or topographical features involving negligible or no expansion or change of use beyond that previously existing.

REMARKS:

Jin Air Co., Ltd. plans to lease terminal space on a month-to-month revocable permit for an airline office a part of airline operations at Honolulu International Airport. Jin Air is currently a signatory airline and its airline operations will mainly be within the Overseas Terminal.

RECOMMENDATION:

That the Board authorize the Department of Transportation to issue a month-to-month revocable permit to Jin Air, subject to: (1) terms and conditions herein outlined, which are by reference incorporated herein; and (2) such additional terms and conditions as may be prescribed by the Director of Transportation to best serve the interests of the State.

Respectfully submitted,



FORD N. FUCHIGAMI  
Director of Transportation

APPROVED FOR SUBMITTAL:



SUZANNE D. CASE  
Chairperson and Member

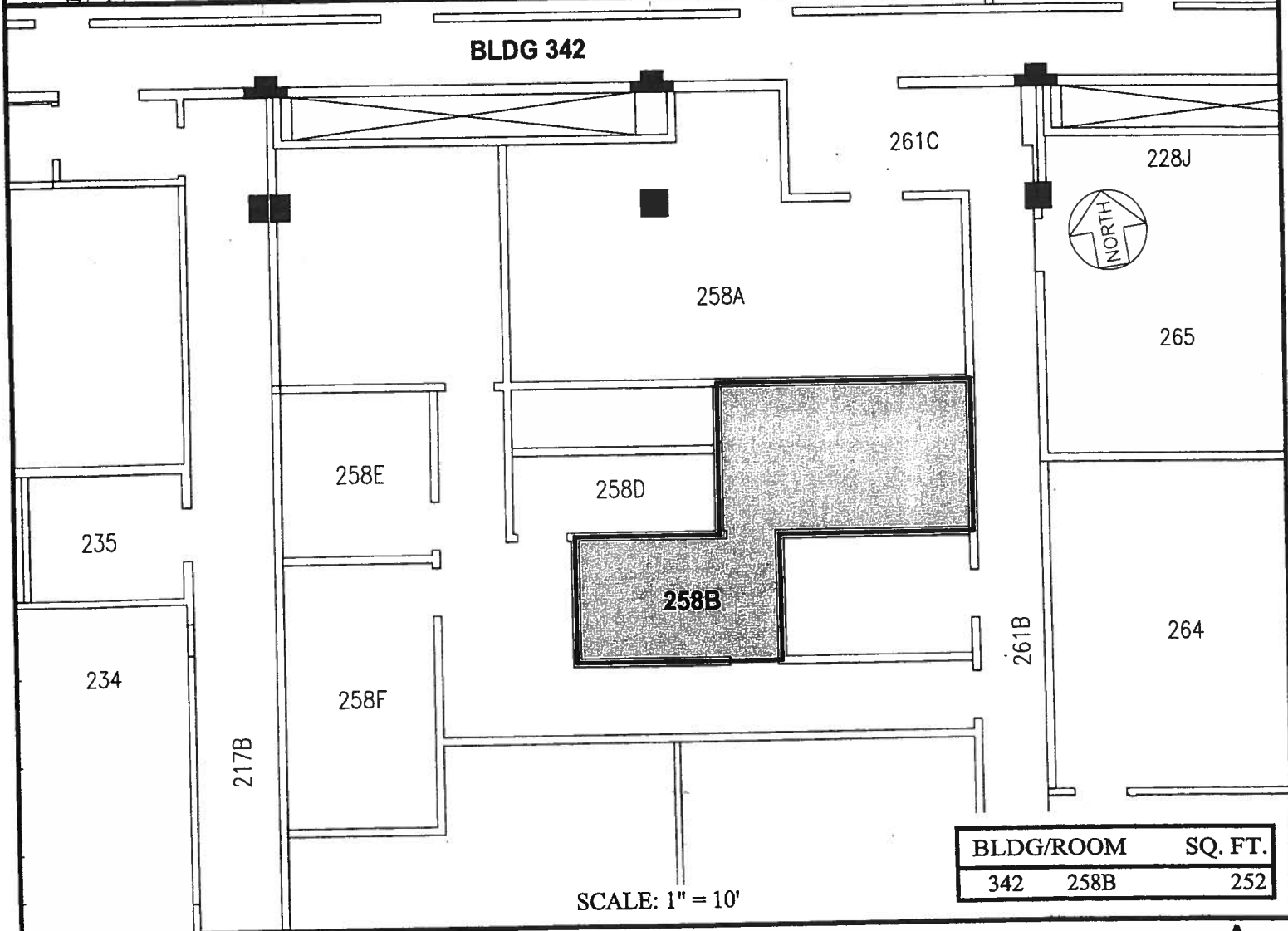
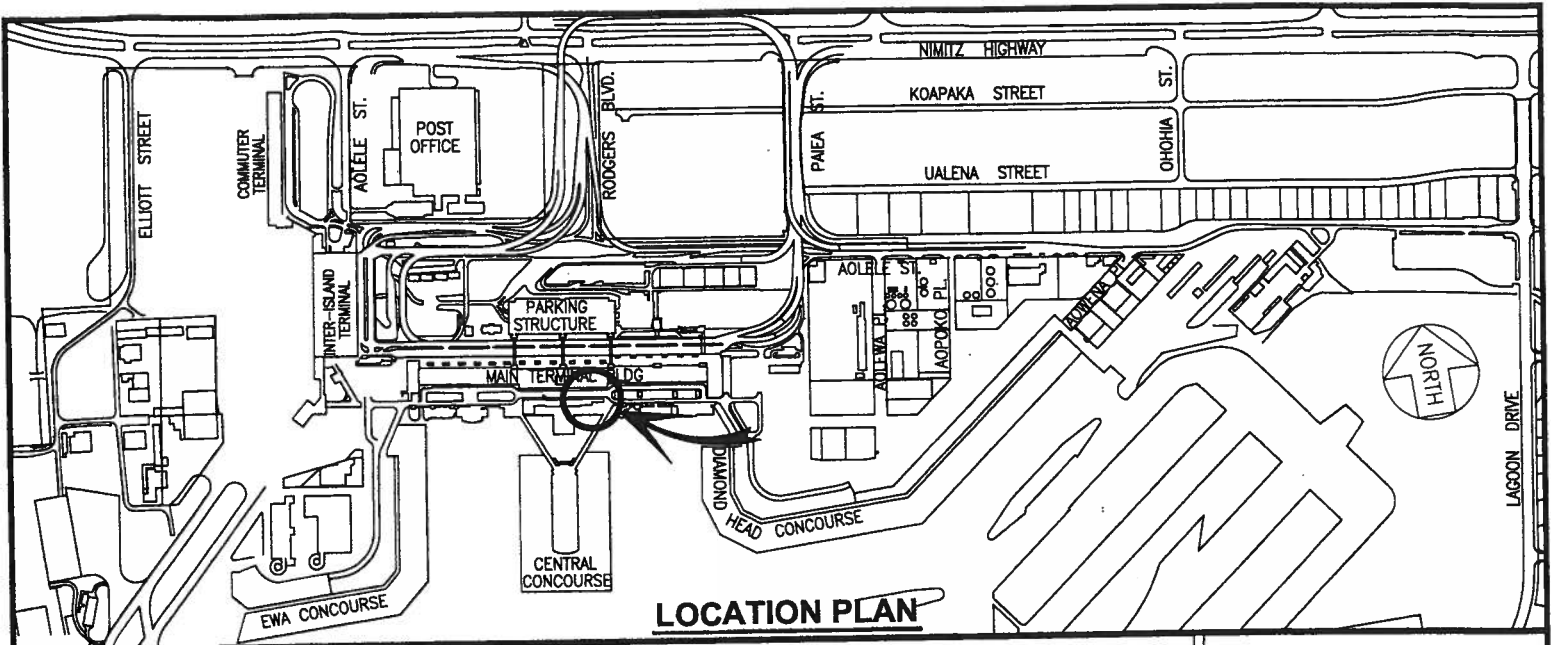

BLDG/ROOM	SQ. FT.
342 258B	252

SCALE: 1" = 10'

DATE : NOVEMBER 2008

EXHIBIT: **A**



**BUILDING 342  
WAITING LOBBY  
SECOND LEVEL**

**342258B  
PLAT A2**

N:\AIRPORTS\HNL\_HONOLULU\CAD\PM\HNL\_342258B-03.DWG

**HONOLULU INTERNATIONAL AIRPORT**