



STATE OF HAWAII
DEPARTMENT OF TRANSPORTATION
869 PUNCHBOWL STREET
HONOLULU, HAWAII 96813-5097

Board of Land and
Natural Resources
State of Hawaii
Honolulu, Hawaii

ISSUANCE OF A REVOCABLE PERMIT FOR
COMMUTER TERMINAL SPACES FOR FIXED BASED OPERATIONS
AIR SERVICE HAWAII, INC.
LIHUE AIRPORT
TAX MAP KEY: (4) 3-5-01: PORTION OF 8

KAUAI

APPLICANT:

Air Service Hawaii, Inc. (ASH), whose business address is 95 Nakolo Place,
Honolulu, Hawaii 96819

LEGAL REFERENCE:

Sections 171-11 and 171-55, Hawaii Revised Statutes

LOCATION AND TAX MAP KEY:

Portion of Lihue Airport (LIH), Lihue, Island of Kauai, identified by
Tax Map Key: 4th Division, 3-5-01: Portion of 8

AREA:

Building/Room No. 136-102A, containing an area of approximately 69 square feet;
Building/Room No. 136-103A, containing an area of approximately 67 square feet;
Building/Room No. 136-102B, containing an area of approximately 154 square feet;
Building/Room No. 136-103B, containing an area of approximately 147 square feet;
Building/Room No. 136-107C, containing an area of approximately 37 square feet; and
Building/Room No. 136-107D, containing an area of approximately 46 square feet;
as shown and delineated on the attached map labeled Exhibit "A".

BLNR – ISSUANCE OF A REVOCABLE PERMIT
FOR FIXED BASE OPERATIONS
AIR SERVICE HAWAII, INC.

Page 2

ZONING:

State Land Use District: Urban
County of Kauai: Industrial (IG-STP)

LAND TITLE STATUS:

Section 5(a) lands of the Hawaii Admission Act: Non-Ceded
DHHL 30% entitlement lands pursuant to Hawaii Admission Act YES ___ NO X

CURRENT USE STATUS:

Airport and aeronautical purposes

CHARACTER OF USE:

Counter, office and storage spaces for fixed base operations

COMMENCEMENT DATE:

Upon complete execution of the revocable permit

MONTHLY RENTAL:

\$1,066.03 (as determined from the DOTA schedule of rates and charges established by appraisal of Airports property statewide)

SECURITY DEPOSIT:

\$3,198.09

HOLDOVER TENANCY:

\$ 35.53

DCCA VERIFICATION:

Place of business registration confirmed:	YES <u>X</u>	NO _____
Registered business name confirmed:	YES <u>X</u>	NO _____
Good standing confirmed:	YES <u>X</u>	NO _____

BLNR – ISSUANCE OF A REVOCABLE PERMIT
FOR FIXED BASE OPERATIONS
AIR SERVICE HAWAII, INC.

Page 3

CHAPTER 343, HRS - ENVIRONMENTAL ASSESSMENT:

Pursuant to Section 11-200-8(a), Environmental Impact Statement Rules of the Department of Health, State of Hawaii, this disposition is exempt from requirements regarding preparation of an environmental assessment, negative declaration, or environmental impact statement as required by Chapter 343, Hawaii Revised Statutes, as amended, relating to Environmental Impact Statements, because the proposed action falls within Exemption Class #1, Comprehensive Exemption List for the State of Hawaii, Department of Transportation, dated November 15, 2000, as approved by the Environmental Quality Council. Exemption Class #1 covers operations, repairs, or maintenance of existing structures, facilities, equipment, or topographical features involving negligible or no expansion or change of use beyond that previously existing.

REMARKS:

The Department of Transportation (DOT) has no objections to ASH's request and therefore, in accordance with Sections 171-11 and 171-55, HRS, relating to Public Purposes and Permits, respectively, and therefore, the DOT proposes to issue a month-to-month revocable permit to ASH, Building No. 136, Room Nos. 102A, 103A, 102B, 103B, 107C and 107D for its fixed base operations at LIH.

RECOMMENDATION:

That the Board authorize the Department of Transportation to issue a month-to-month revocable permit to ASH, subject to: (1) terms and conditions herein outlined, which are by reference incorporated herein; and (2) such additional terms and conditions as may be prescribed by the Director of Transportation to best serve the interests of the State.

Respectfully submitted,



FORD N. FUCHIGAMI
Director of Transportation

APPROVED FOR SUBMITTAL:



SUZANNE D. CASE
Chairperson and Member

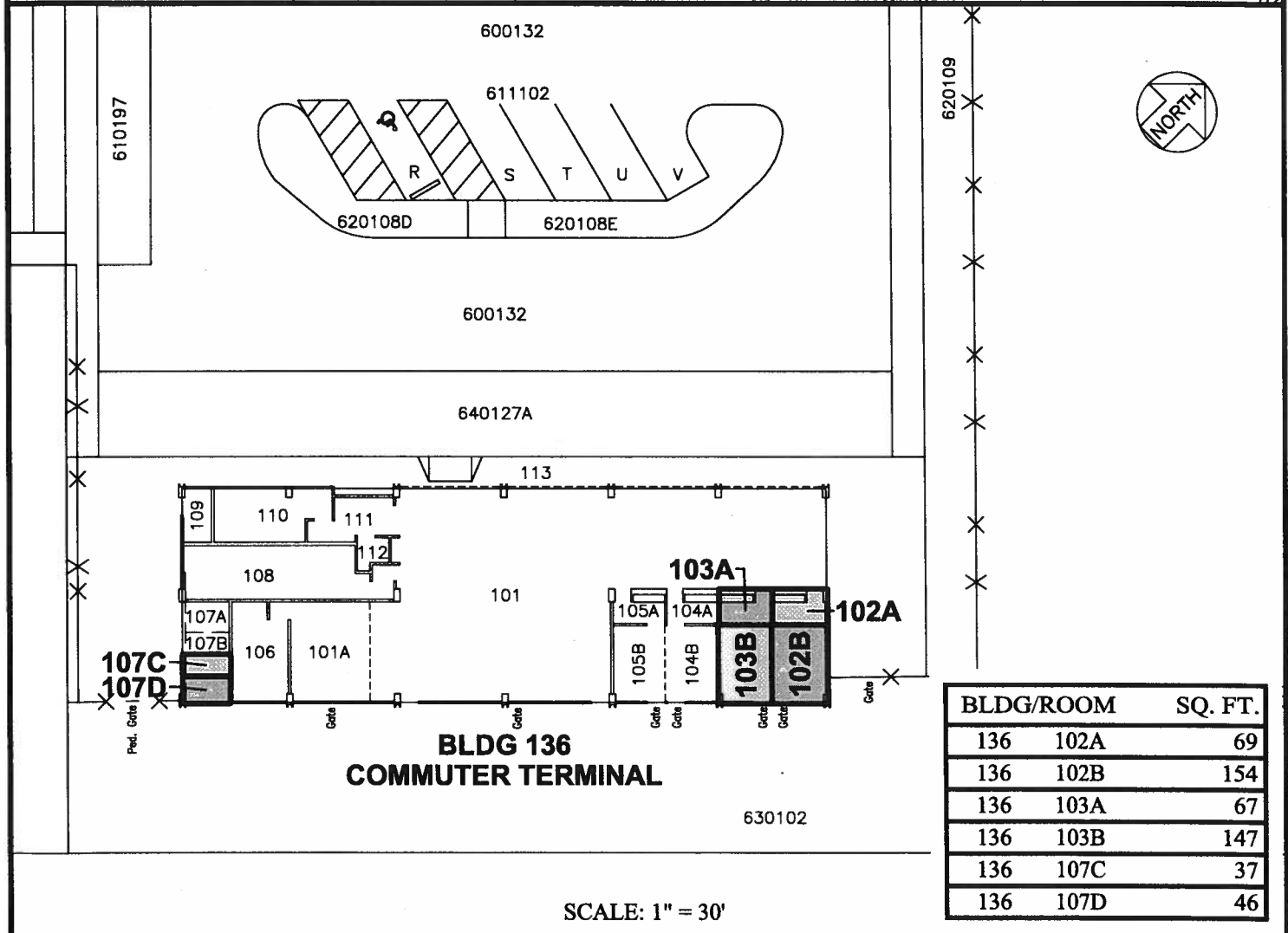
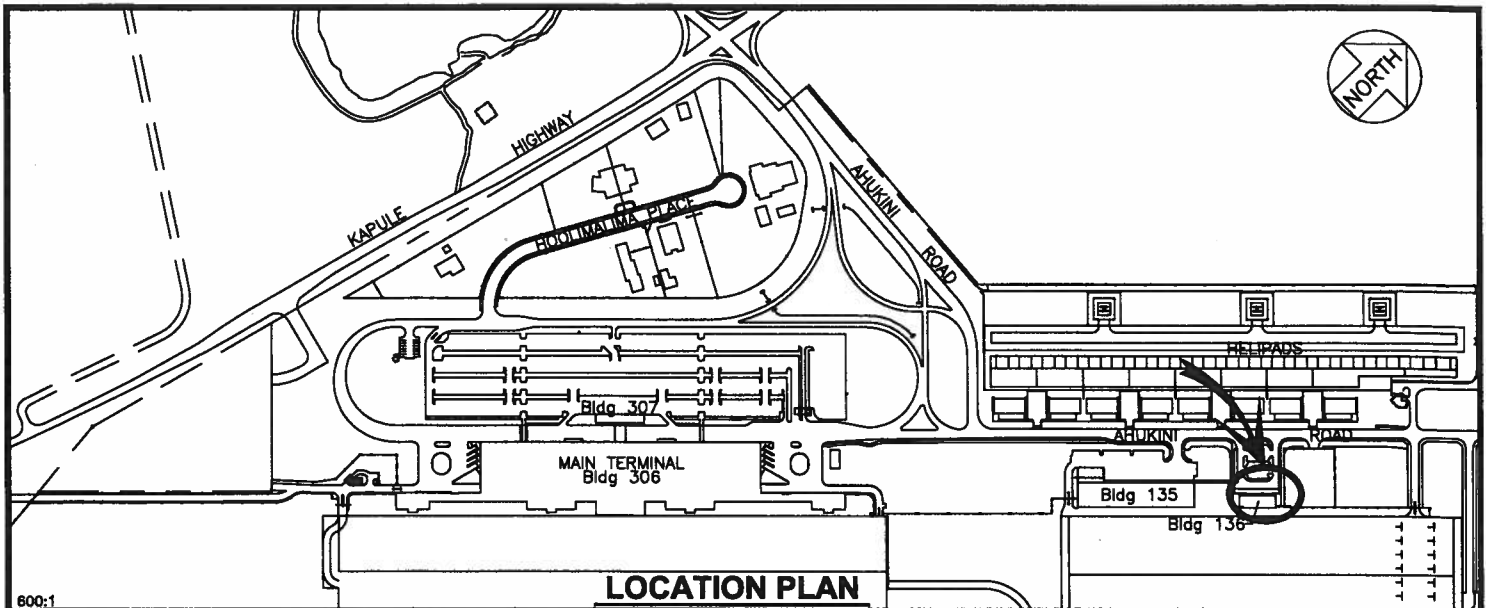

DATE : NOVEMBER 2015

EXHIBIT: **A**



Airports Division

AIR SERVICE HAWAII, INC.

**BUILDING 136
COMMUTER TERMINAL
GROUND LEVEL**

136102A & B
136103A & B
136107C & D
PLATS A1, 35

LIHUE AIRPORT