

DAVID Y. IGE
GOVERNOR



STATE OF HAWAII
DEPARTMENT OF TRANSPORTATION
869 PUNCHBOWL STREET
HONOLULU, HAWAII 96813-5097

FORD N. FUCHIGAMI
DIRECTOR

Deputy Directors
JADE T. BUTAY
ROSS M. HIGASHI
EDWIN H. SNIFFEN
DARRELL T. YOUNG

IN REPLY REFER TO:

Board of Land and
Natural Resources
State of Hawaii
Honolulu, Hawaii

ISSUANCE OF A REVOCABLE PERMIT FOR
A CONSTRUCTION STAGING AREA
RALPH S. INOUYE CO., LTD:
HONOLULU INTERNATIONAL AIRPORT
TAX MAP KEY: (1) 1-1-003: 001 (PORTION)

OAHU

APPLICANT:

Ralph S. Inouye Co., Ltd., whose business address is 500 Alakawa Street, Unit 220E,
Honolulu, Hawaii 96817.

LEGAL REFERENCE:

Section 171-55, Hawaii Revised Statutes

LOCATION:

Main Terminal Area, Ground Level, Space No. 600-117 at Honolulu International
Airport, Tax Map Key: 1st Division, 1-1-003: 001 (Portion)

AREA:

Space No. 600-117, containing an area of approximately 1,450 square feet, as shown and
delineated on the attached map labeled Exhibit "A".

ZONING:

State Land Use District: Urban
City and County of Honolulu LUO: Industrial (I-2)

LAND TITLE STATUS:

Non-ceded - Section 5(a) lands of the Hawaii Admission Act
DHHL 30% entitlement lands pursuant to Hawaii Admission Act YES X NO

ITEM M-1

CURRENT USE STATUS:

Land presently encumbered by Governor’s Executive Order No. 3201, dated June 8, 1983, setting aside 3,152.177 acres designated as Honolulu International Airport under the control and management of the State of Hawaii, Department of Transportation, Airports Division (DOTA) for Airport Purposes.

CHARACTER OF USE:

Ralph S. Inouye Co., Ltd. will use the space as a construction staging area, at no charge, as specifically stated under State Project No. AO1043-28, Overseas Terminal Metal Roof Replacement.

COMMENCEMENT DATE:

To be determined by the Director of Transportation at a later date.

MONTHLY RENTAL:

Not applicable (NA)

SECURITY DEPOSIT:

NA

HOLDOVER TENANCY:

NA

DCCA VERIFICATION:

Place of business registration confirmed:	YES <u>X</u>	NO _____
Registered business name confirmed:	YES <u>X</u>	NO _____
Good standing confirmed:	YES <u>X</u>	NO _____

CHAPTER 343, HRS - ENVIRONMENTAL ASSESSMENT:

Pursuant to Section 11-200-8(a), Environmental Impact Statement Rules of the Department of Health, State of Hawaii, this disposition is exempt from requirements regarding preparation of an environmental assessment, negative declaration, or environmental impact statement as required by Chapter 343, Hawaii Revised Statutes, as amended, relating to Environmental Impact Statements, because the proposed action falls

BLNR – ISSUANCE OF A REVOCABLE PERMIT FOR
A CONSTRUCTION STAGING AREA
RALPH S. INOUE CO., LTD.
Page 3

within Exemption Class #1, Comprehensive Exemption List for the State of Hawaii, Department of Transportation, dated November 15, 2000, as approved by the Environmental Quality Council. Exemption Class #1 covers operations, repairs, or maintenance of existing structures, facilities, equipment, or topographical features involving negligible or no expansion or change of use beyond that previously existing.

REMARKS:

As stated under State Project No. AO1043-28, Overseas Terminal Metal Roof Replacement, 1.04 – Provisions for Field Office/Storage Space allow for the winning Contractor to use space at respective airports at no charge, provided there is space available.

RECOMMENDATION:

That the Board authorize the Department of Transportation to issue a month-to-month revocable permit to Ralph S. Inouye Co., Ltd., subject to: (1) terms and conditions herein outlined, which are by reference incorporated herein; and (2) such additional terms and conditions as may be prescribed by the Director of Transportation to best serve the interests of the State.

Respectfully submitted,



FORD N. FUCHIGAMI
Director of Transportation

APPROVED FOR SUBMITTAL:



SUZANNE D. CASE
Chairperson and Member

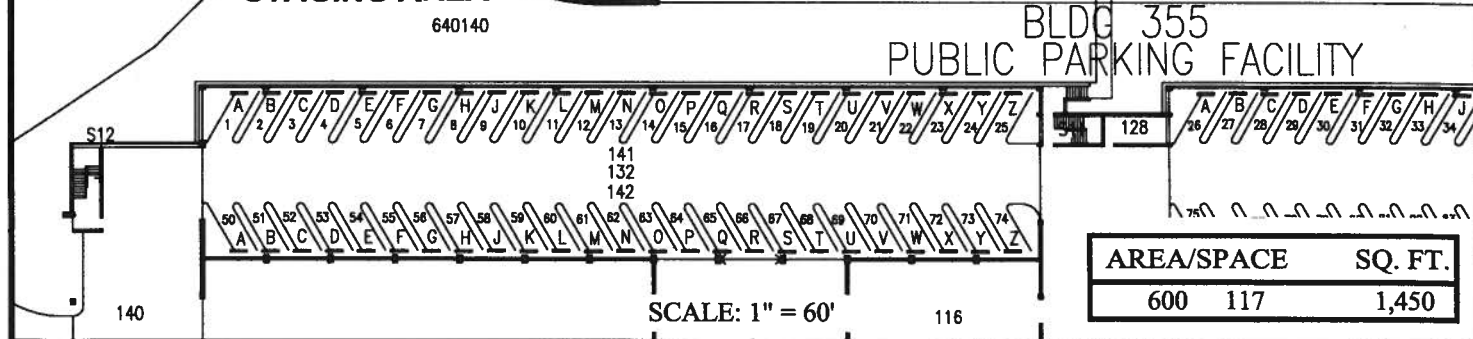
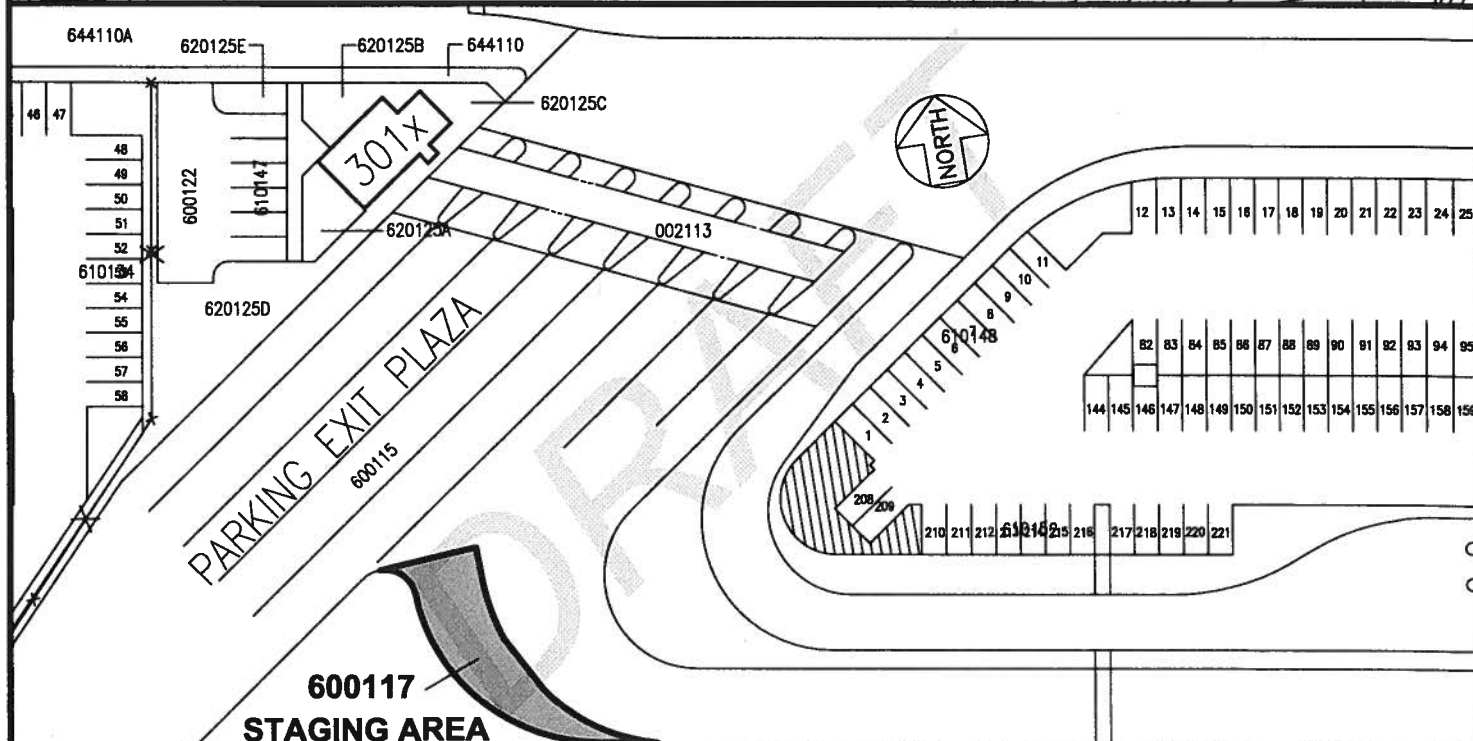
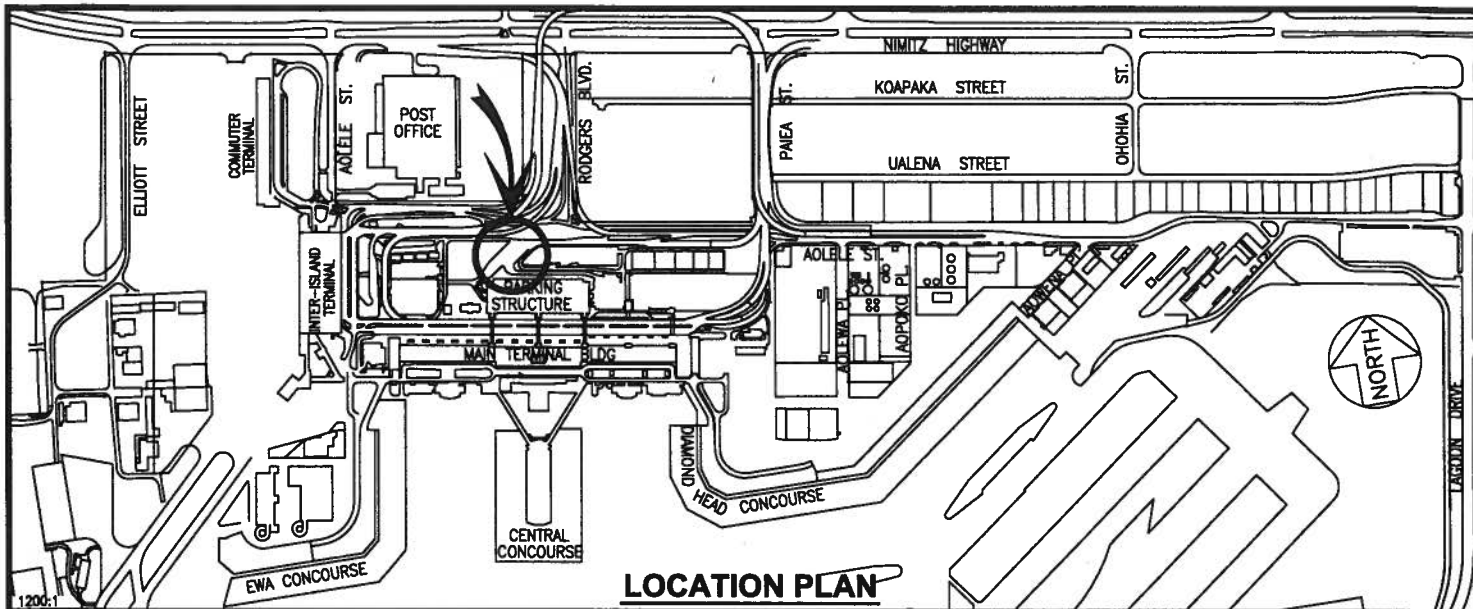

SCALE: 1" = 60'

DATE : JANUARY 2016 EXHIBIT: **A**



RALPH S. INOUE

**ROADS & STREETS
MAIN TERMINAL AREA
GROUND LEVEL**

**600117
PLAT A1**

HONOLULU INTERNATIONAL AIRPORT

N:\AIRPORTS\HNL_HONOLULU\CAD\PM_DRAFT\HNL_600117-01_DRAFT.DWG