

DAVID Y. IGE
GOVERNOR



STATE OF HAWAII
DEPARTMENT OF TRANSPORTATION
869 PUNCHBOWL STREET
HONOLULU, HAWAII 96813-5097

FORD N. FUCHIGAMI
DIRECTOR

Deputy Directors
JADE T. BUTAY
ROSS M. HIGASHI
EDWIN H. SNIFFEN
DARRELL T. YOUNG

IN REPLY REFER TO:

Board of Land and
Natural Resources
State of Hawaii
Honolulu, Hawaii

ISSUANCE OF A REVOCABLE PERMIT FOR A
STORAGE ROOM FOR TOOLS AND PARTS
MAIN TERMINAL BUILDING
VANDERLANDE INDUSTRIES INC.
HILO INTERNATIONAL AIRPORT
TAX MAP KEY: (3) 2-1-12: PORTION OF 90

HAWAII

REQUEST:

Issuance of a Revocable Permit for a storage room in the main terminal for tools and parts for Vanderlande Industries Inc. at Hilo International Airport

LEGAL REFERENCE:

Sections 171-11 and 171-55, Hawaii Revised Statutes

APPLICANT:

Vanderlande Industries Inc. (VII), whose business address is
1975 W Oak Circle, Marietta, Georgia 30062

LOCATION AND TAX MAP KEY:

Portion of Hilo International Airport (ITO), Hilo, Island of Hawaii, identified by
Tax Map Key: 3rd Division, 2-1-12: Portion of 90

AREA:

Bldg/Room No. 306-136 containing a total area of approximately 86 square feet,
as shown and delineated on the attached map labeled Exhibit "A".

ZONING:

State Land Use District: Urban
County of Hawaii: Industrial (ML-20)

ITEM M-14

BLNR – ISSUANCE OF A REVOCABLE PERMIT FOR A STORAGE ROOM
FOR PARTS AND TOOLS
VANDERLANDE INDUSTRIES INC.

Page 2

LAND TITLE STATUS:

Section 5(a) lands of the Hawaii Admission Act: Ceded
DHHL 30% entitlement lands pursuant to Hawaii Admission Act YES ___ NO X

CURRENT USE STATUS:

Airport and aeronautical purposes

CHARACTER OF USE:

Storage room for tools and parts

COMMENCEMENT DATE:

Upon complete execution of the revocable permit

MONTHLY RENTAL:

\$ 30.10 (as determined from the DOTA schedule of rates and charges established by appraisal of Airports property statewide)

SECURITY DEPOSIT:

\$ 90.30

HOLDOVER TENANCY:

\$ 1.00

DCCA VERIFICATION:

Place of business registration confirmed:	YES <u>X</u>	NO _____
Registered business name confirmed:	YES <u>X</u>	NO _____
Good standing confirmed:	YES <u>X</u>	NO _____

CHAPTER 343, HRS - ENVIRONMENTAL ASSESSMENT:

Pursuant to Section 11-200-8(a), Environmental Impact Statement Rules of the Department of Health, State of Hawaii, this disposition is exempt from requirements regarding preparation of an environmental assessment, negative declaration, or

BLNR – ISSUANCE OF A REVOCABLE PERMIT FOR A STORAGE ROOM
FOR PARTS AND TOOLS
VANDERLANDE INDUSTRIES INC.

Page 3

environmental impact statement as required by Chapter 343, Hawaii Revised Statutes, as amended, relating to Environmental Impact Statements, because the proposed action falls within Exemption Class #1, Comprehensive Exemption List for the State of Hawaii, Department of Transportation, dated November 15, 2000, as approved by the Environmental Quality Council. Exemption Class #1 covers operations, repairs, or maintenance of existing structures, facilities, equipment, or topographical features involving negligible or no expansion or change of use beyond that previously existing.

REMARKS:

The Department of Transportation (DOT) has no objections to VII's request and therefore, in accordance with Sections 171-11 and 171-55, HRS, relating to Public Purposes and Permits, respectively, and therefore, the DOT proposes to issue a month-to-month revocable permit to VII for Building/Room No. 306-136 for a storage room located at the main terminal at ITO.

RECOMMENDATION:

That the Board authorize the Department of Transportation to issue a month-to-month revocable permit to VII, subject to: (1) terms and conditions herein outlined, which are by reference incorporated herein; and (2) such additional terms and conditions as may be prescribed by the Director of Transportation to best serve the interests of the State.

Respectfully submitted,



FORD N. FUCHIGAMI
Director of Transportation

APPROVED FOR SUBMITTAL:



SUZANNE D. CASE
Chairperson and member

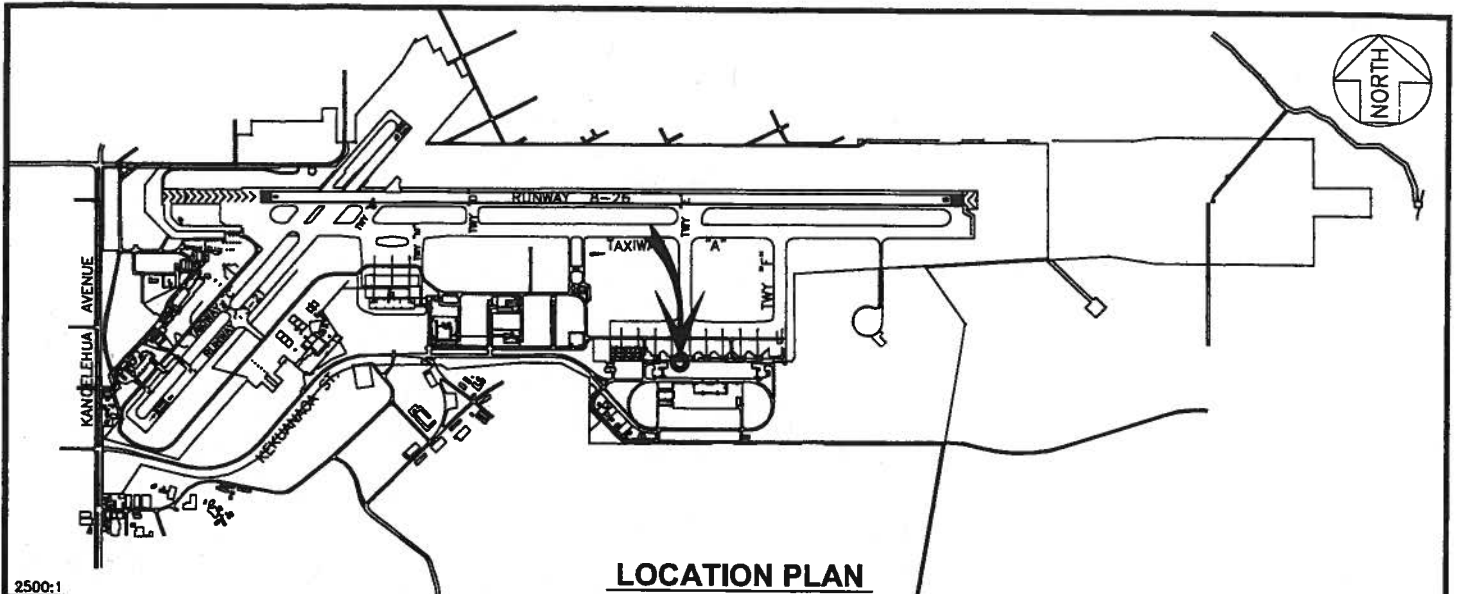

2500:1

LOCATION PLAN

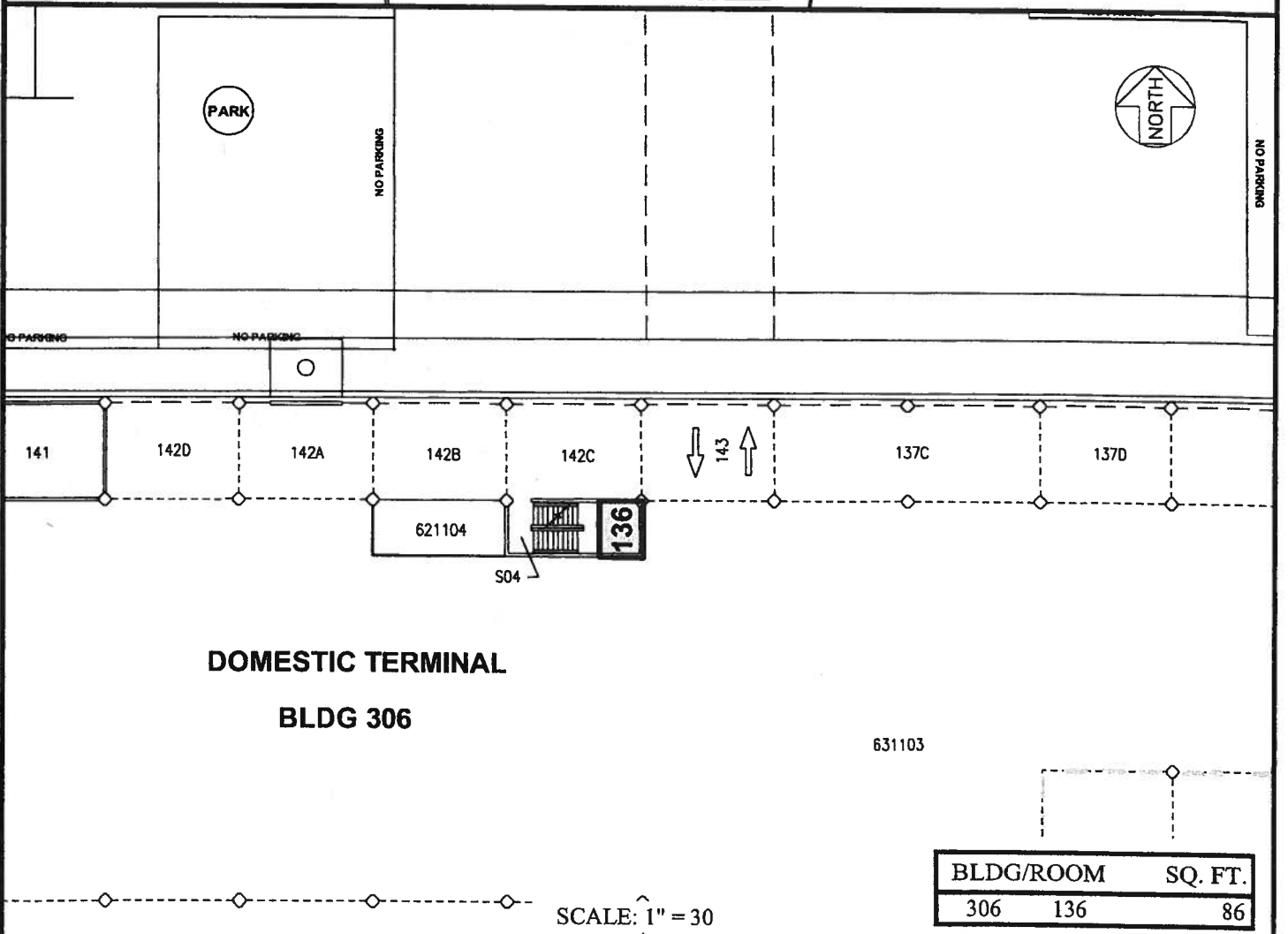

**DOMESTIC TERMINAL
BLDG 306**

SCALE: 1" = 30'

BLDG/ROOM	SQ. FT.
306 136	86

DATE : AUGUST 2015

EXHIBIT: **A**



**BUILDING 306
DOMESTIC TERMINAL
GROUND LEVEL**

**306136
PLATS C1, 42**

HILO INTERNATIONAL AIRPORT

N:\AIRPORTS\ITO_Hilo\CAD\PM\Ito_306136-01.dwg