

DAVID Y. IGE
GOVERNOR



STATE OF HAWAII
DEPARTMENT OF TRANSPORTATION
869 PUNCHBOWL STREET
HONOLULU, HAWAII 96813-5097

FORD N. FUCHIGAMI
DIRECTOR

Deputy Directors
JADE T. BUTAY
ROSS M. HIGASHI
EDWIN H. SNIFFEN
DARRELL T. YOUNG

IN REPLY REFER TO:

Board of Land and
Natural Resources
State of Hawaii
Honolulu, Hawaii

ISSUANCE OF A REVOCABLE PERMIT FOR AN
END ROOM FOR FIXED-BASE OPERATIONS
BRADLEY PACIFIC AVIATION, INC.
KONA INTERNATIONAL AIRPORT AT KEAHOLE
TAX MAP KEY: (3) 7-3-43: PORTION OF 40

HAWAII

REQUEST:

Issuance of a revocable permit to Bradley Pacific Aviation, Inc. (BPA), for end room at Kona International Airport at Keahole (KOA).

LEGAL REFERENCE:

Sections 171-11 and 171-55, Hawaii Revised Statutes

APPLICANT:

Bradley Pacific Aviation, Inc. (BPA) whose business address is 98 Kapalulu Place, Honolulu, Hawaii 96819

LOCATION AND TAX MAP KEY:

Portion of KOA, Kona, Island of Hawaii, identified by Tax Map Key: 4th Division, 7-3-43: Portion of 40

AREA:

Space No. 404-113, containing an area of approximately 501 square feet, as shown on the attached Exhibit "A".

ITEM M-20

BLNR – ISSUANCE OF A REVOCABLE PERMIT FOR AN END ROOM
FOR FIXED-BASE OPERATIONS
BRADLEY PACIFIC AVIATION, INC.

Page 2

ZONING:

State Land Use District: Urban
County of Hawaii: Industrial (ML-20)

LAND TITLE STATUS:

Section 5(a) lands of the Hawaii Admission Act: Ceded
DHHL 30% entitlement lands pursuant to Hawaii Admission Act YES ___ NO X

CURRENT USE STATUS:

Airport and aeronautical purposes

CHARACTER OF USE:

T-Hangar office and storage end room unit

COMMENCEMENT DATE:

Upon complete execution of the revocable permit

MONTHLY RENTAL:

\$ 219.00 (as determined from the DOTA schedule of rates and charges established by appraisal of Airports property statewide)

SECURITY DEPOSIT:

\$ 657.00 (three times the monthly rental)

HOLDOVER TENANCY:

\$ 7.30

DCCA VERIFICATION:

Place of business registration confirmed: YES
Registered business name confirmed: YES
Good standing confirmed: YES

BLNR – ISSUANCE OF A REVOCABLE PERMIT FOR AN END ROOM
FOR FIXED-BASE OPERATIONS
BRADLEY PACIFIC AVIATION, INC.

Page 3

REMARKS:

The issuance of a revocable permit to BPA at KOA complies with Chapter 343, Exemption Class 1.D.10 as a continuing aeronautical use, and is in accordance with Section 171-55 HRS, relating to Permits.

RECOMMENDATION:

That the Board authorize the Department of Transportation to issue a month-to-month revocable permit to BPA, subject to: (1) terms and conditions herein outlined, which are by reference incorporated herein; and (2) such additional terms and conditions as may be prescribed by the Director of Transportation to best serve the interests of the State.

Respectfully submitted,



FORD N. FUCHIGAMI
Director of Transportation

APPROVED FOR SUBMITTAL:



SUZANNE D. CASE
Chairperson and Member

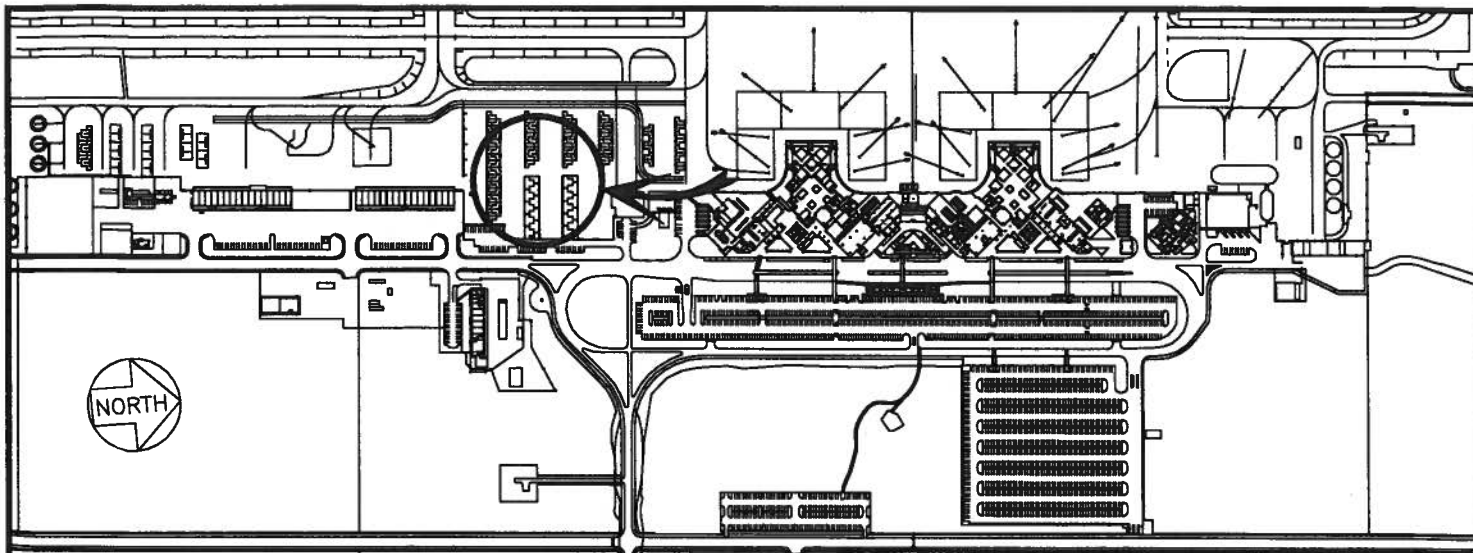

LOCATION PLAN

800:1

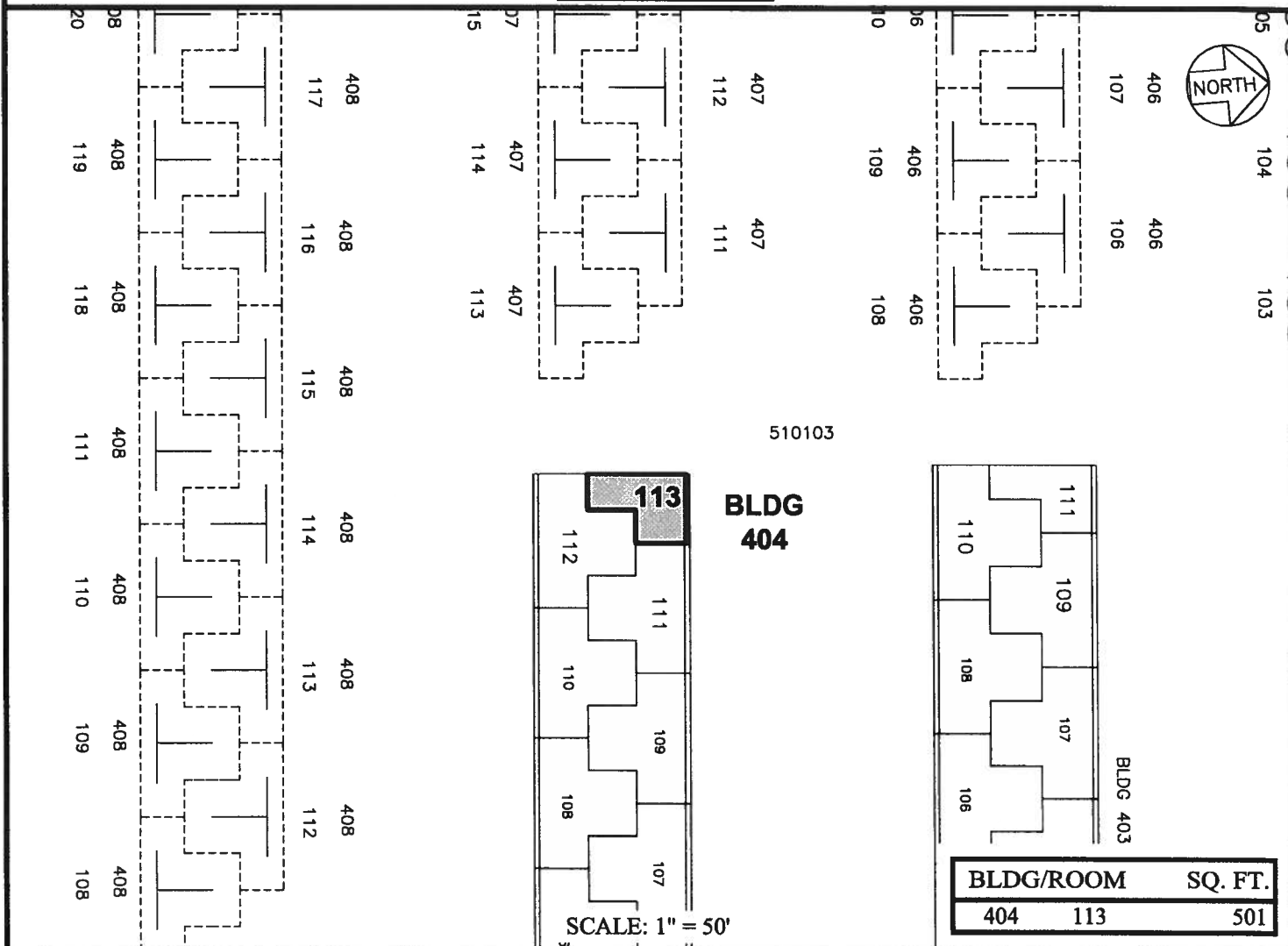

BLDG 404

SCALE: 1" = 50'

BLDG/ROOM	SQ. FT.
404 113	501

RP-8486

DATE : JANUARY 2016

EXHIBIT: **A**



BRADLEY PACIFIC AVIATION, INC.

**BUILDING 404
T-HANGAR
GROUND LEVEL**

**404113
PLATS D1, 39**

N:\AIRPORTS\KOA_Kona\CAD\PM\koa_404103-01.dwg