

DAVID Y. IGE  
GOVERNOR



STATE OF HAWAII  
DEPARTMENT OF TRANSPORTATION  
869 PUNCHBOWL STREET  
HONOLULU, HAWAII 96813-5097

FORD N. FUCHIGAMI  
DIRECTOR

Deputy Directors  
JADE T. BUTAY  
ROSS M. HIGASHI  
EDWIN H. SNIFFEN  
DARRELL T. YOUNG

IN REPLY REFER TO:

Board of Land and  
Natural Resources  
State of Hawaii  
Honolulu, Hawaii

ISSUANCE OF A REVOCABLE PERMIT  
FOR THE PURPOSE OF AIRLINE OPERATIONS  
DELTA AIR LINES, INC.  
HONOLULU INTERNATIONAL AIRPORT  
TAX MAP KEY: (1) 1-1-003: 001 (PORTION)

OAHU

LEGAL REFERENCE:

Section 171-55, Hawaii Revised Statutes

APPLICANT:

Delta Air Lines, Inc. (Delta), whose business address is 300 Rodgers Boulevard #68,  
Honolulu, Hawaii 96819.

LOCATION:

Portion of Honolulu International Airport, Island of Oahu, State of Hawaii, identified by  
Tax Map Key: 1st Division, 1-1-003: 001 (Portion).

AREA:

BLDG/ROOM	SQ.FT.	PURPOSE	EXHIBIT	RENT
341-227	4,989	AIRLINE LOUNGE	A	\$25,764.03
341-134A	114	BAGGAGE MAKE-UP	B-1	\$ 588.71
341-134B	869	BAGGAGE MAKE-UP	B-1	\$ 4,487.66
341-134F	64	BAGGAGE MAKE-UP	B-1	\$ 330.51
341-216A	900	CHECK-IN COUNTER	B-2	\$ 4,647.75
341-216B	3,351	AIRPORT TICKET OFFICE	B-2	\$17,305.12
341-216C	167	STORAGE	B-2	\$ 862.41
341-216E	158	STORAGE	B-2	\$ 815.94
341-217A	751	CHECK-IN COUNTER	B-2	\$ 3,878.29

ITEM M-3

BLNR – ISSUANCE OF A REVOCABLE PERMIT FOR AIRLINE OPERATIONS  
 DELTA AIR LINES, INC.

Page 2

BLDG/ROOM	SQ.FT.	PURPOSE	EXHIBIT	RENT
341-217B	4,365	FA OFFICE	B-2	\$22,541.59
341-217C	126	STORAGE	B-2	\$ 650.68
341-217D	165	STORAGE	B-2	\$ 852.09
341-240C	58	CS HELP DESK	B-2	\$ 299.52
341-278	45	CURBSIDE CHECK-IN	B-2	\$ 232.39
341-259A	7	SELF-SERVICE KIOSKS	B-2	\$ 36.15
341-259B	19	SELF-SERVICE KIOSKS	B-2	\$ 98.12
341-259C	7	SELF-SERVICE KIOSKS	B-2	\$ 36.15
341-259D	23	SELF-SERVICE KIOSKS	B-2	\$ 118.77
341-B37	205	COMMUNICATION ROOM	B-3	\$ 1,058.65
346-107F	45	AIRLINES FIS COUNTER	C	\$ 232.39
350-136A	2,995	OFFICE	D-1	\$15,466.68
350-136C	1,371	MAINTENANCE DEPT	D-1	\$ 7,080.07
350-143A	5,277	OFFICE	D-1	\$27,251.31
350-143B	1,254	OFFICE	D-1	\$ 6,475.86
350-240	195	OFFICE	D-2	\$ 1,007.01
373-117A	1,908	CABIN CLEANERS OFFICE	E	\$ 9,853.23
373-118A	1,099	STORES	E	\$ 5,675.42
373-118D	2,038	STORES	E	\$10,524.57
612-115A-H, 612-115J, 612-115K-N, and 612-115R	2,621	EQUIPMENT PARKING	F	\$13,535.28
613-102A-H, 613-102J-M	4,246	COVERED PARKING	G	\$21,927.05
<b>READ POINTS</b>		<b>RADIO FREQUENCY IDENTIFICATION DEVICES (RFID's)</b>		
1-7			H-1	\$ 175.00
8-12			H-2	\$ 125.00
13-17			H-3	\$ 125.00

ZONING:

State Land Use District: Urban  
 City and County of Honolulu LUO: Industrial (I-2)

LAND TITLE STATUS:

Non-ceded - Section 5(a) lands of the Hawaii Admission Act  
DHHL 30% entitlement lands pursuant to Hawaii Admission Act YES \_\_\_ NO X

CURRENT USE STATUS:

Land presently encumbered by Governor’s Executive Order No. 3201, dated June 8, 1983, setting aside 3,152.177 acres designated as Honolulu International Airport under the control and management of the State of Hawaii, Department of Transportation, Airports Division (DOTA) for Airport Purposes.

CHARACTER OF USE:

Delta will use various terminal spaces, for the use and maintenance of: (1) an airline lounge; (2) baggage service operations (office, storage); (3) lobby operations (check-in counters, kiosks, and offices); (4) maintenance offices (cabin cleaners, stores); (5) equipment and automobile parking; and, (6) RFID’s, hereinafter referred to as airline operations at Honolulu International Airport.

COMMENCEMENT DATE:

Upon execution of the revocable permit

MONTHLY RENTAL:

\$204,058.40 (based upon a rate of \$61.97 per square foot, per annum, as published in the DOTA Signatory Carrier Rates and Charges, Hawaii Airports System, Effective July 1, 2015).

SECURITY DEPOSIT:

Three (3) times the monthly rental in effect.

HOLDOVER TENANCY:

\$6,801.95

DCCA VERIFICATION:

Place of business registration confirmed:	YES <u>X</u>	NO ___
Registered business name confirmed:	YES <u>X</u>	NO ___
Good standing confirmed:	YES <u>X</u>	NO ___

BLNR – ISSUANCE OF A REVOCABLE PERMIT FOR AIRLINE OPERATIONS  
DELTA AIR LINES, INC.

Page 4

CHAPTER 343, HRS - ENVIRONMENTAL ASSESSMENT:

Pursuant to Section 11-200-8(a), Environmental Impact Statement Rules of the Department of Health, State of Hawaii, this disposition is exempt from requirements regarding preparation of an environmental assessment, negative declaration, or environmental impact statement as required by Chapter 343, Hawaii Revised Statutes, as amended, relating to Environmental Impact Statements, because the proposed action falls within Exemption Class #1, Comprehensive Exemption List for the State of Hawaii, Department of Transportation, dated November 15, 2000, as approved by the Environmental Quality Council. Exemption Class #1 covers operations, repairs, or maintenance of existing structures, facilities, equipment, or topographical features involving negligible or no expansion or change of use beyond that previously existing.

REMARKS:

Delta has requested to consolidate all airport terminal spaces under existing revocable permits and parking permits into one month-to-month revocable permit, for their airline operations at Honolulu International Airport. The Department of Transportation (DOT) has no objection to Delta's request.

In accordance with Sections 171-55, relating to Permits, the DOT proposes to issue a month-to-month revocable permit to Delta for their Airline Operations.

RECOMMENDATION:

That the Board authorize the Department of Transportation to issue a month-to-month revocable permit to Delta Air Lines, Inc. subject to: (1) terms and conditions herein outlined, which are by reference incorporated herein; and (2) such additional terms and conditions as may be prescribed by the Director of Transportation to best serve the interests of the State.

Respectfully submitted,



FORD N. FUCHIGAMI  
Director of Transportation

APPROVED FOR SUBMITTAL:

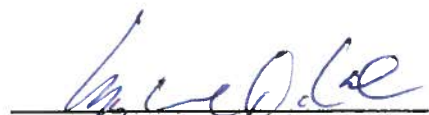

SUZANNE D. CASE  
Chairperson and Member

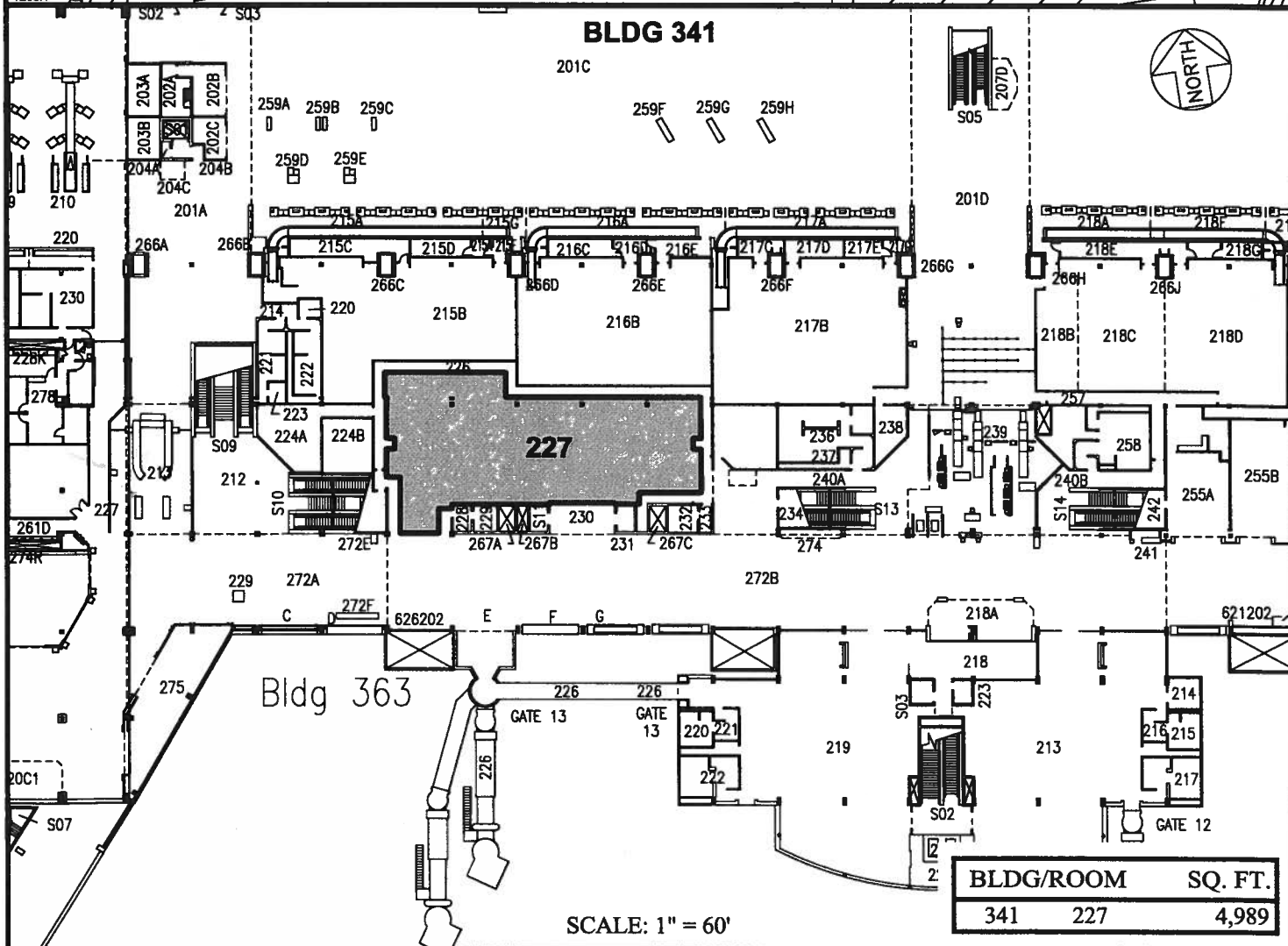
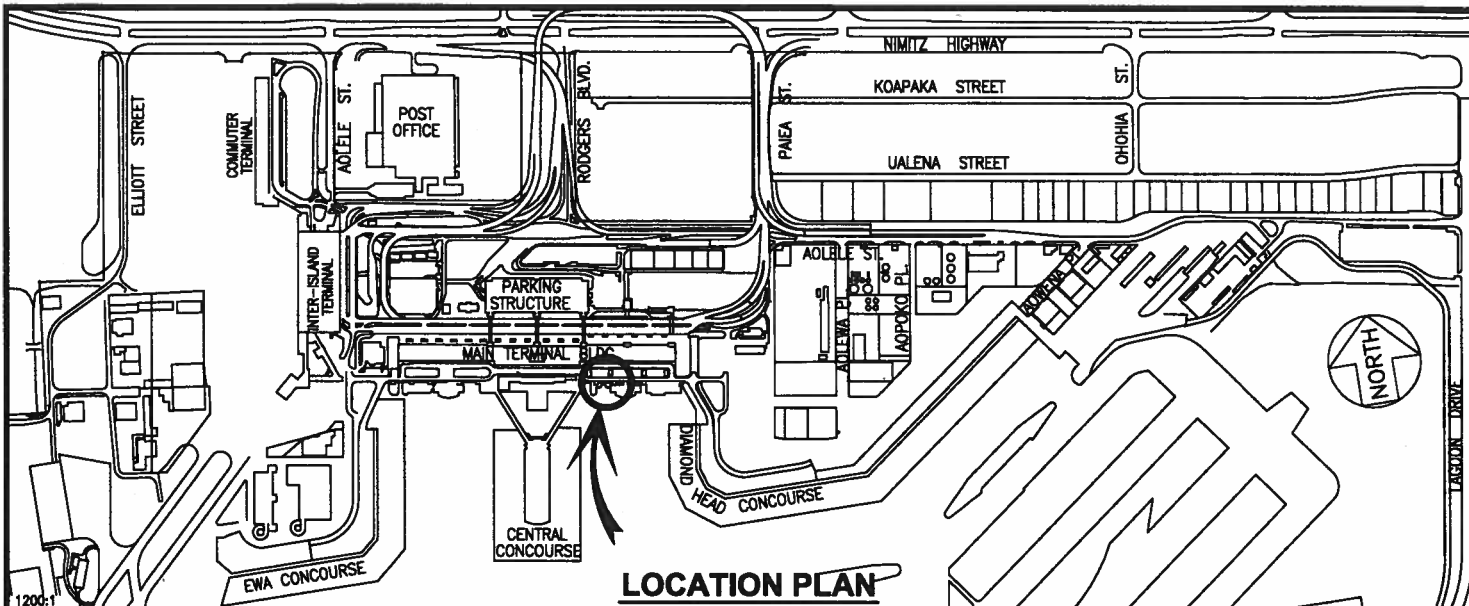

DATE : MARCH 2016

EXHIBIT: **A**



DELTA AIR LINES, INC.

**BUILDING 341  
DIAMOND HEAD EXTN.  
SECOND LEVEL**

341227  
PLAT A2

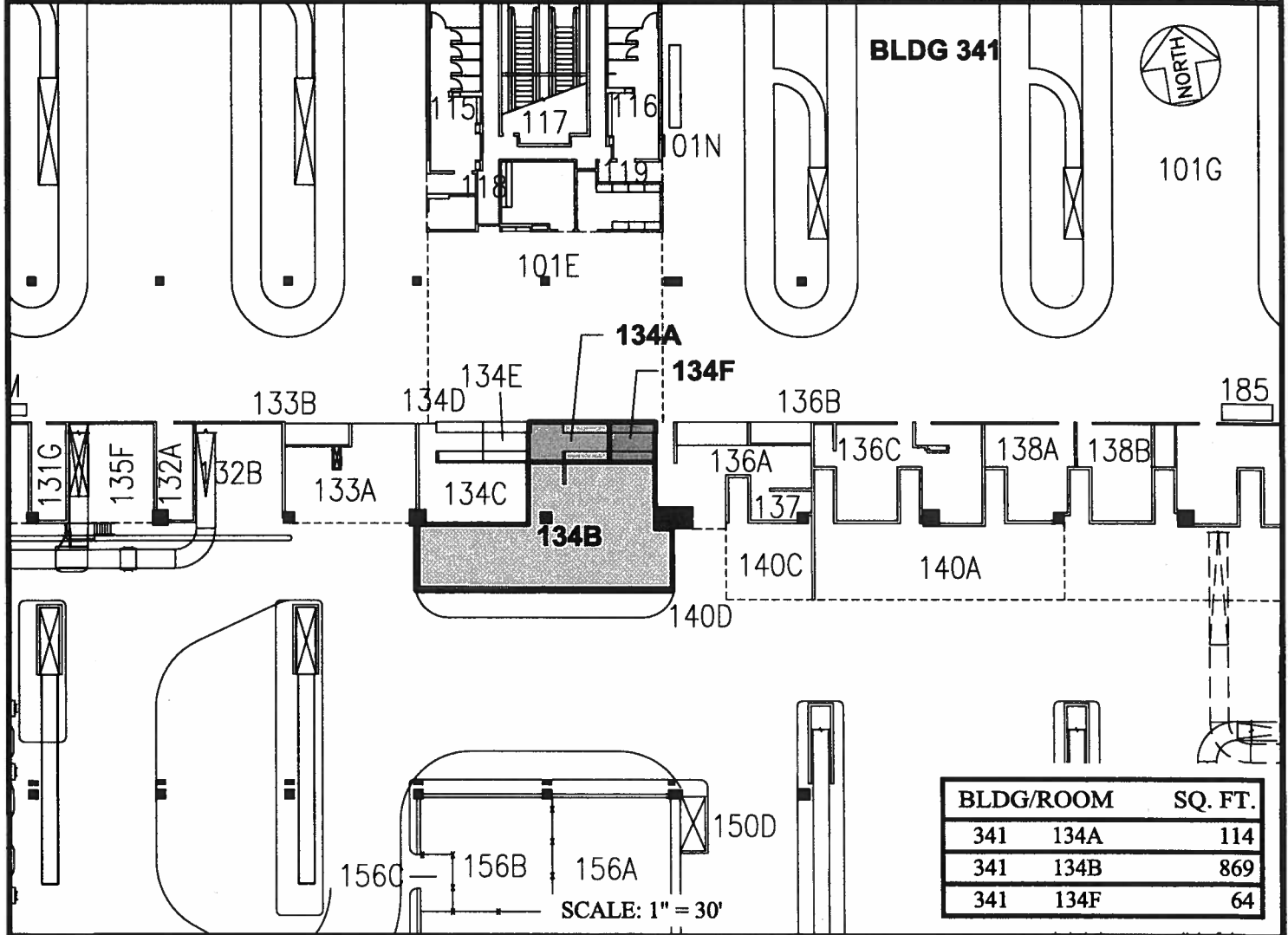
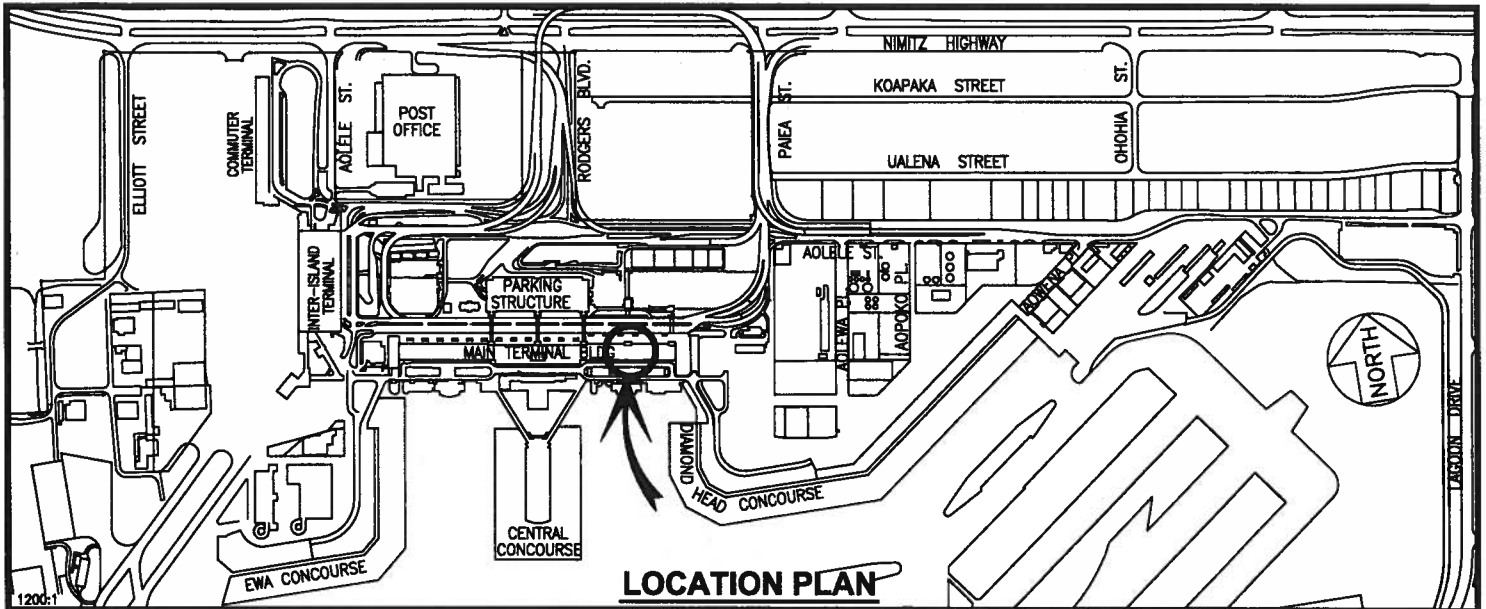

DATE : MARCH 2016

EXHIBIT: **B-1**



Airports Division

DELTA AIR LINES, INC.

**BUILDING 341  
DIAMOND HEAD EXTN.  
GROUND LEVEL**

**341134A  
341134B  
341134F  
PLAT A1**

**HONOLULU INTERNATIONAL AIRPORT**

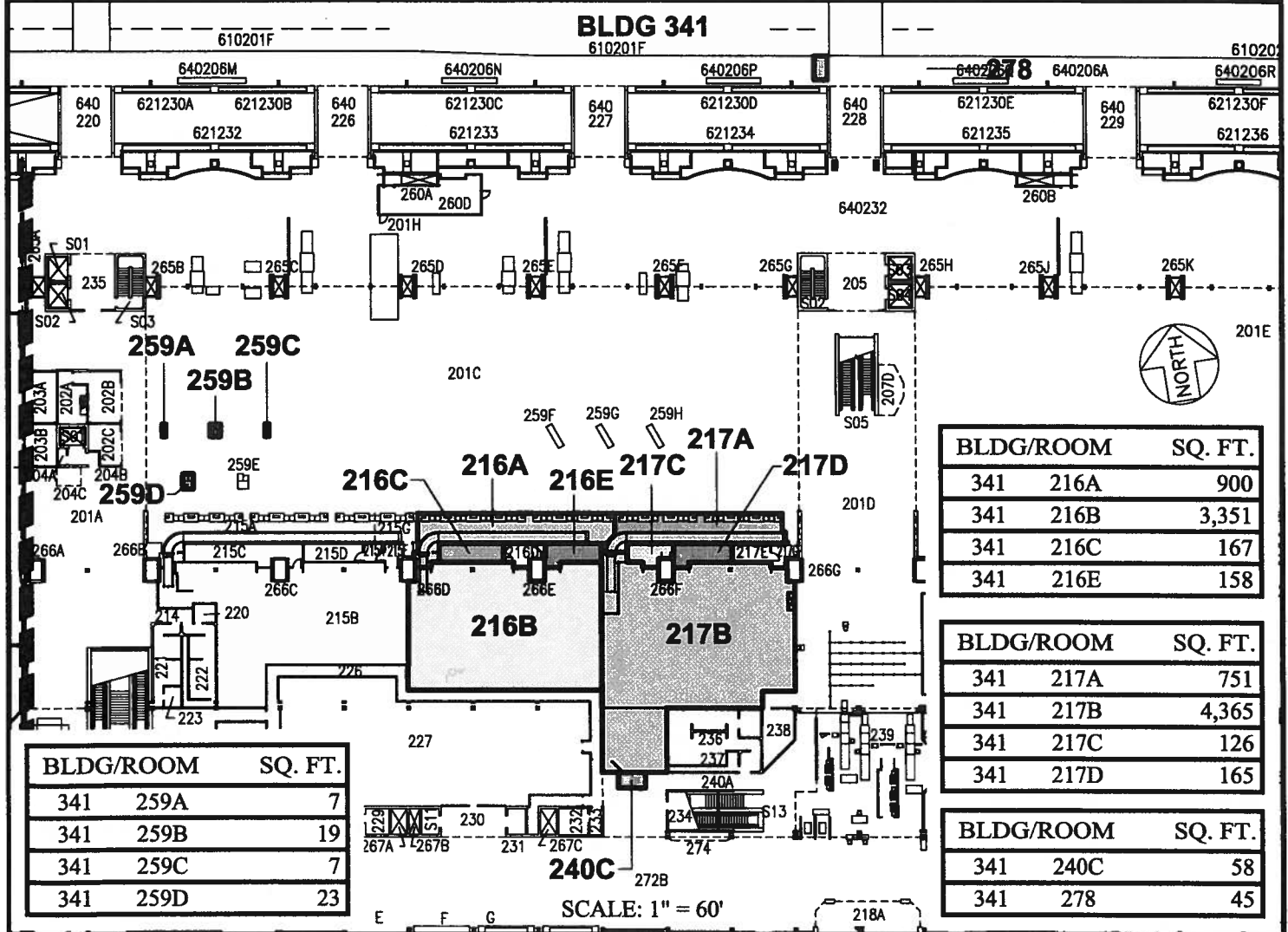
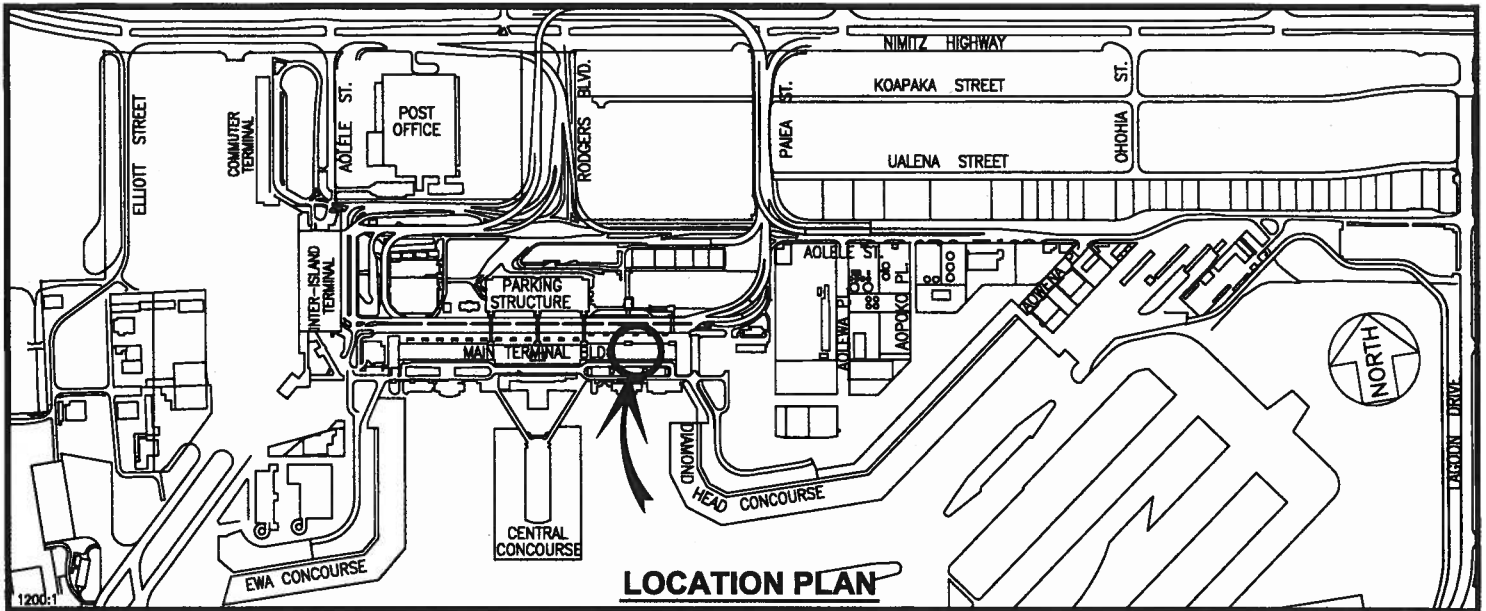

DATE : MARCH 2016

EXHIBIT: B-2



Airports Division

DELTA AIR LINES, INC.

BUILDING 341  
DIAMOND HEAD EXTN.  
SECOND LEVEL

341216A-341278  
PLAT A2

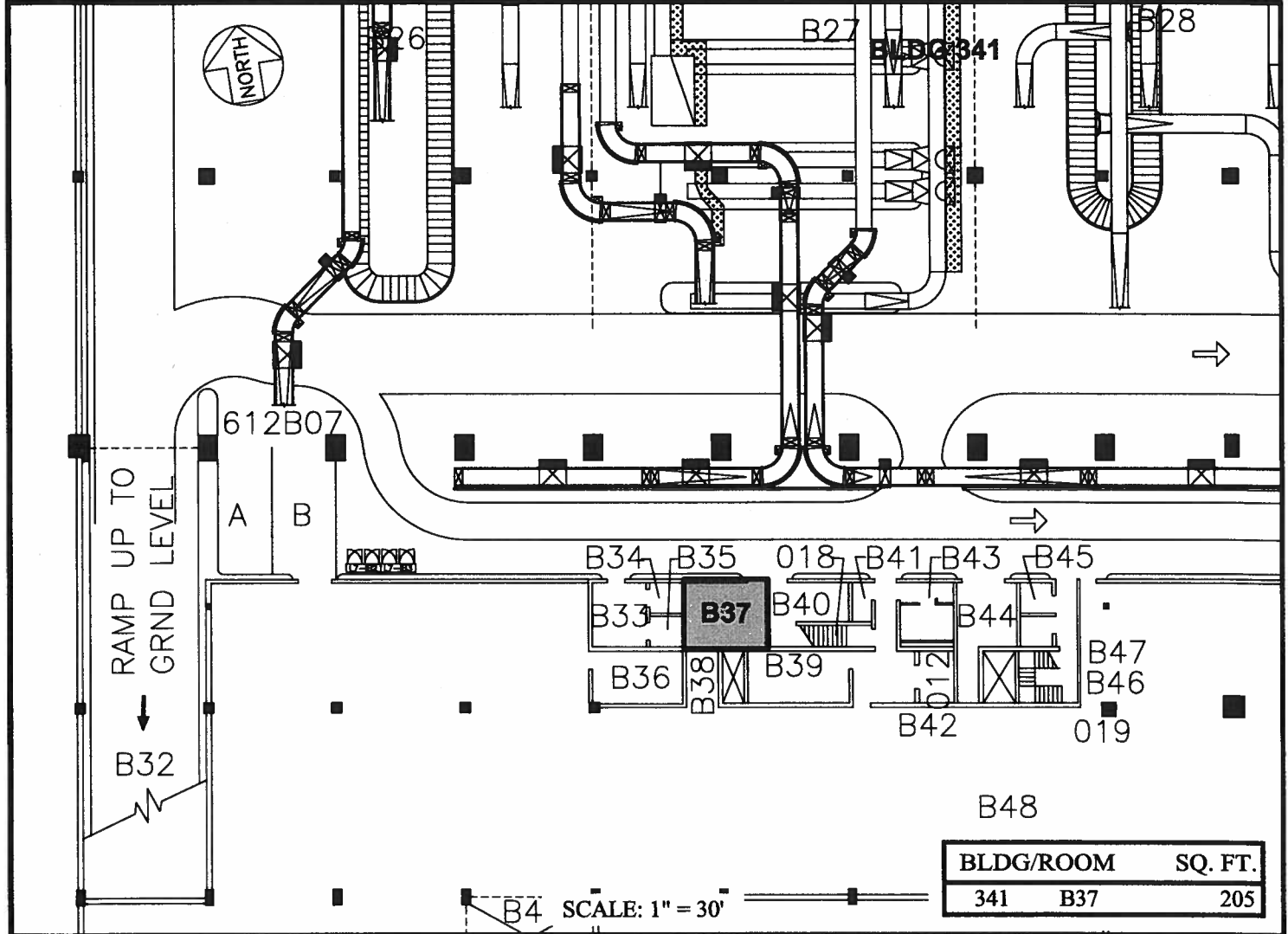
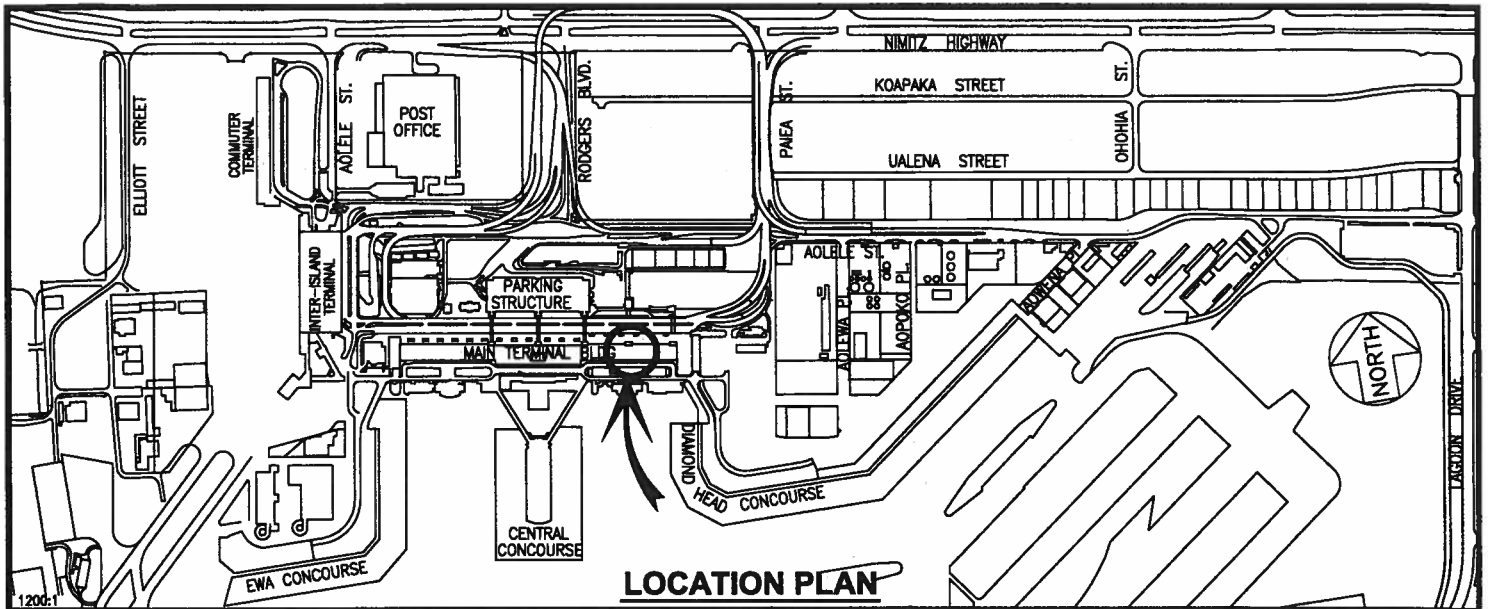

DATE : MARCH 2016

EXHIBIT: **B-3**



Airports Division

DELTA AIR LINES, INC.

BUILDING 341  
DIAMOND HEAD EXTN.  
BASEMENT LEVEL

341B37

PLAT AB



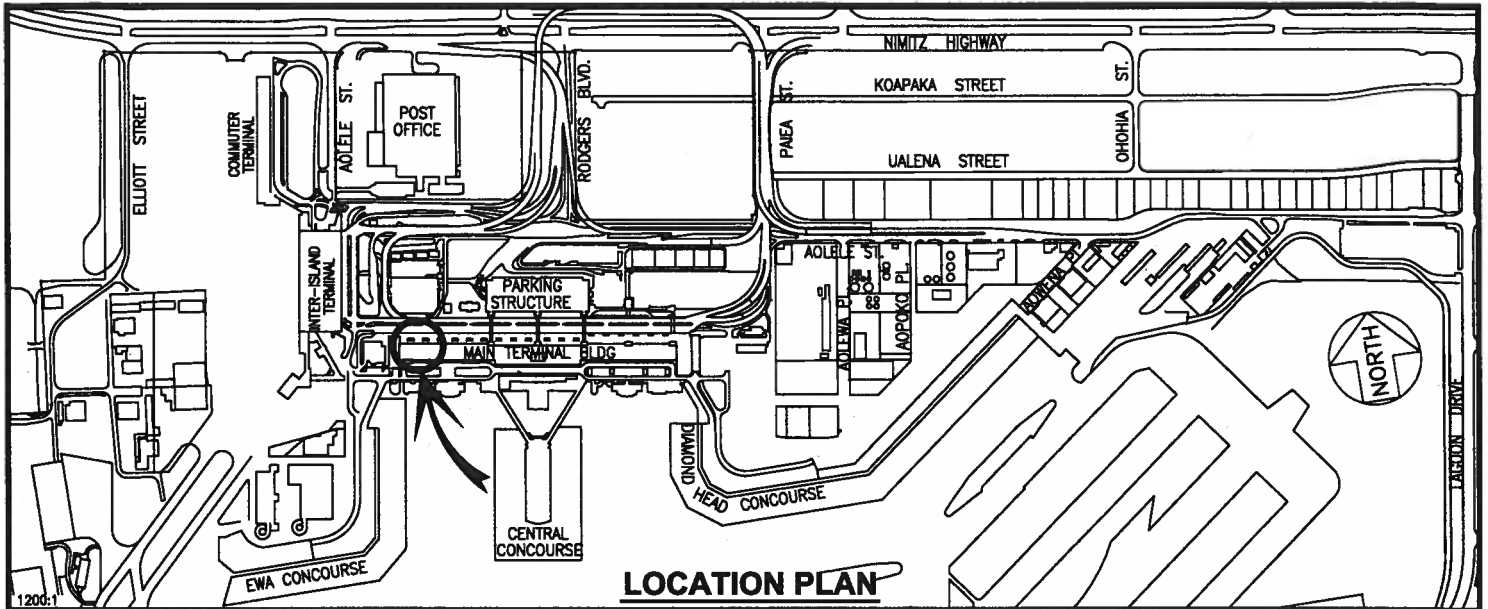

**BLDG 346**

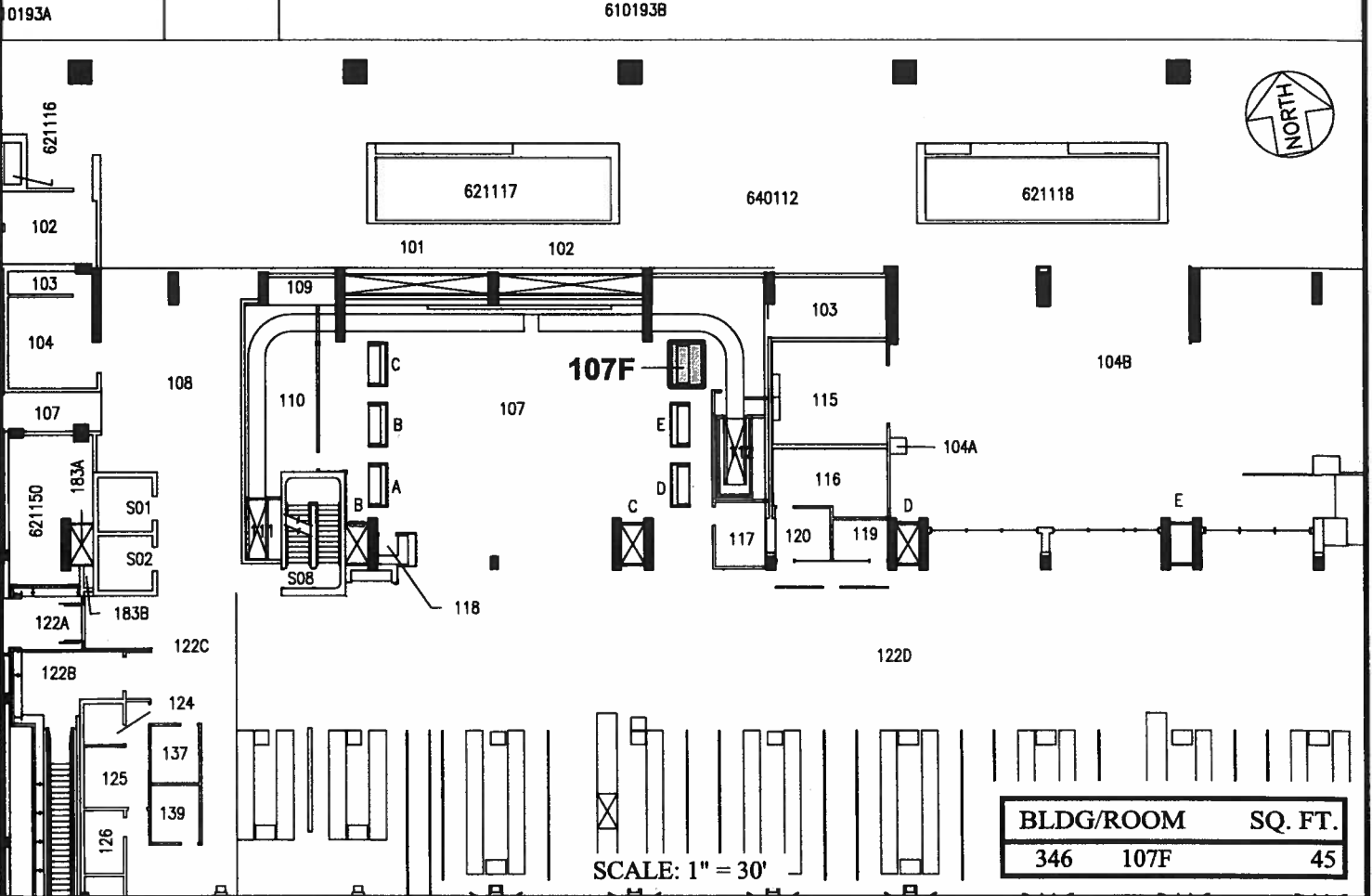

DATE : MARCH 2016

EXHIBIT: C



DELTA AIR LINES, INC.

BUILDING 346  
INT'L ARRIVAL BUILDING  
GROUND LEVEL

346107F  
PLAT A1

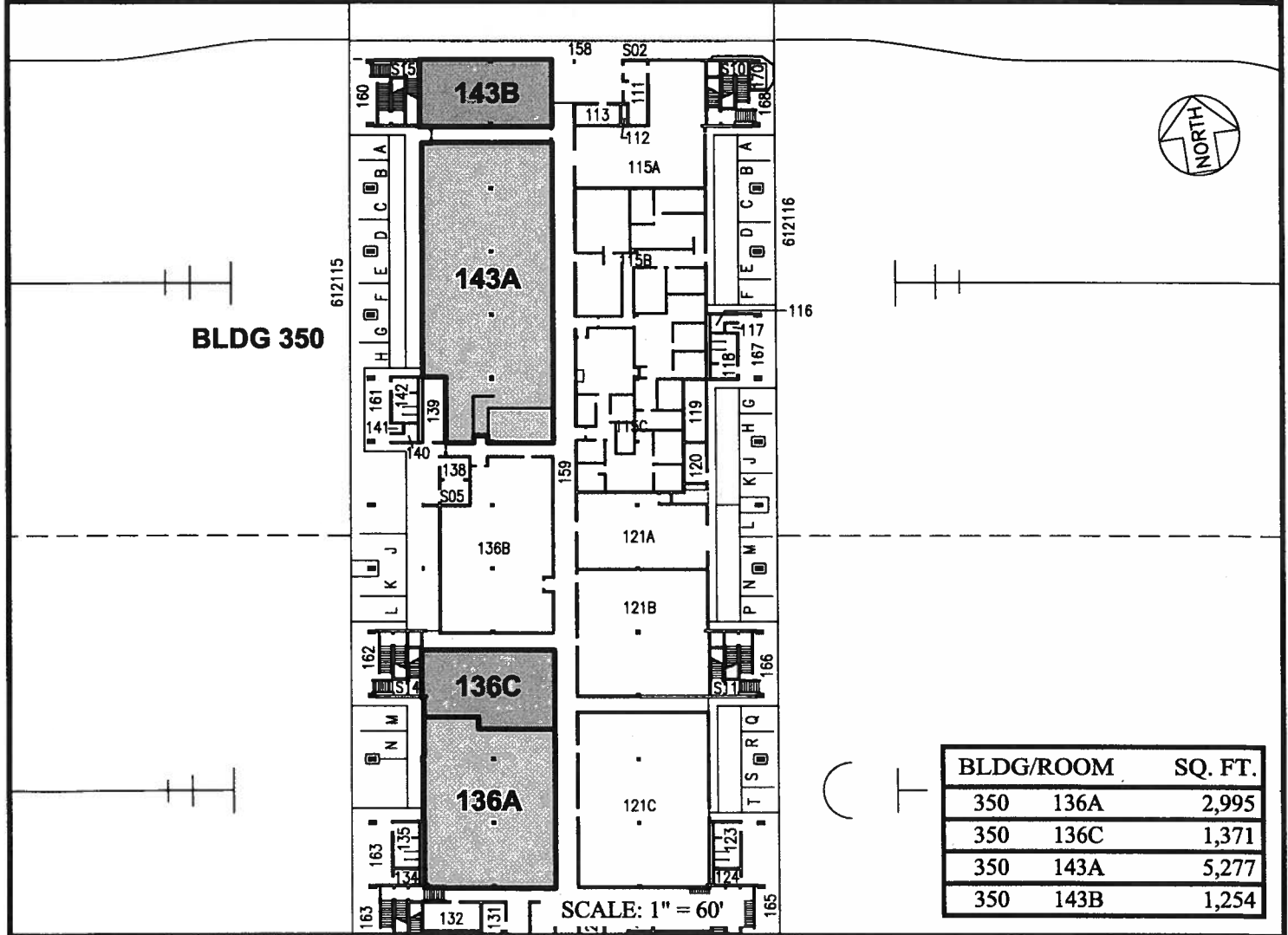
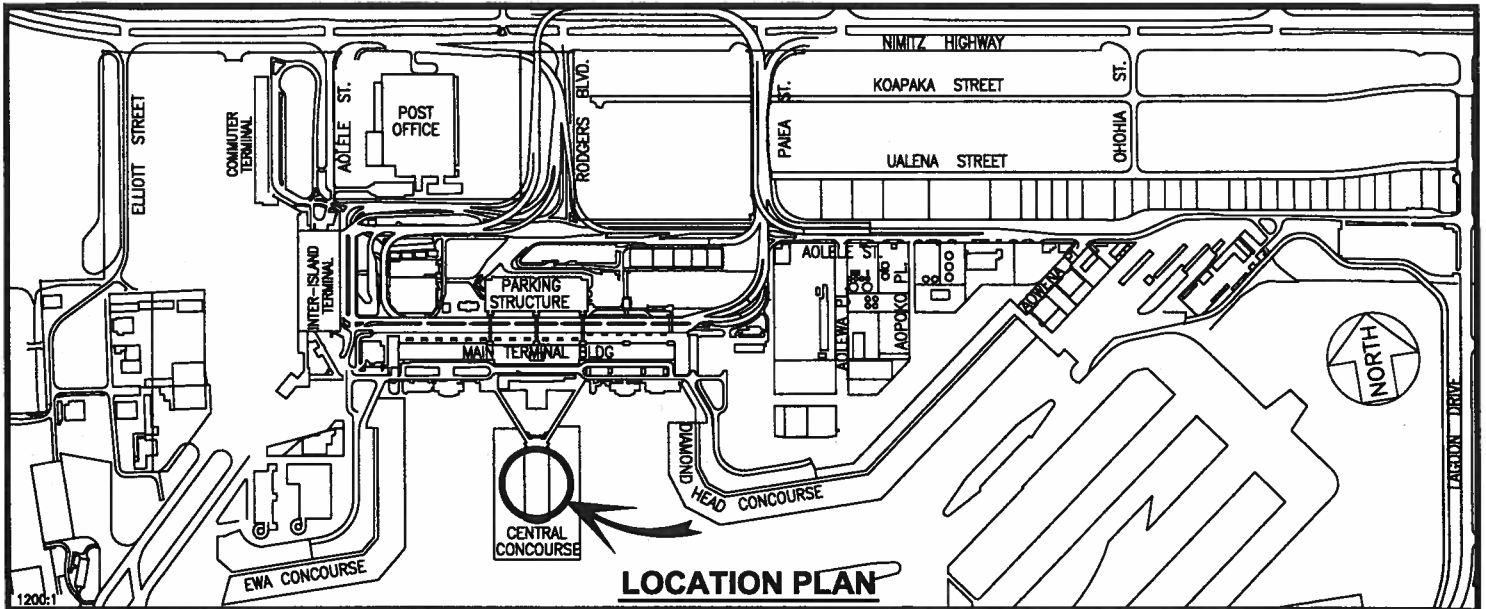

DATE : MARCH 2016

EXHIBIT: **D-1**



Airports Division

DELTA AIR LINES, INC.

**BUILDING 350  
CENTRAL CONCOURSE  
GROUND LEVEL**

350136A,C  
350143A,B

PLAT A1

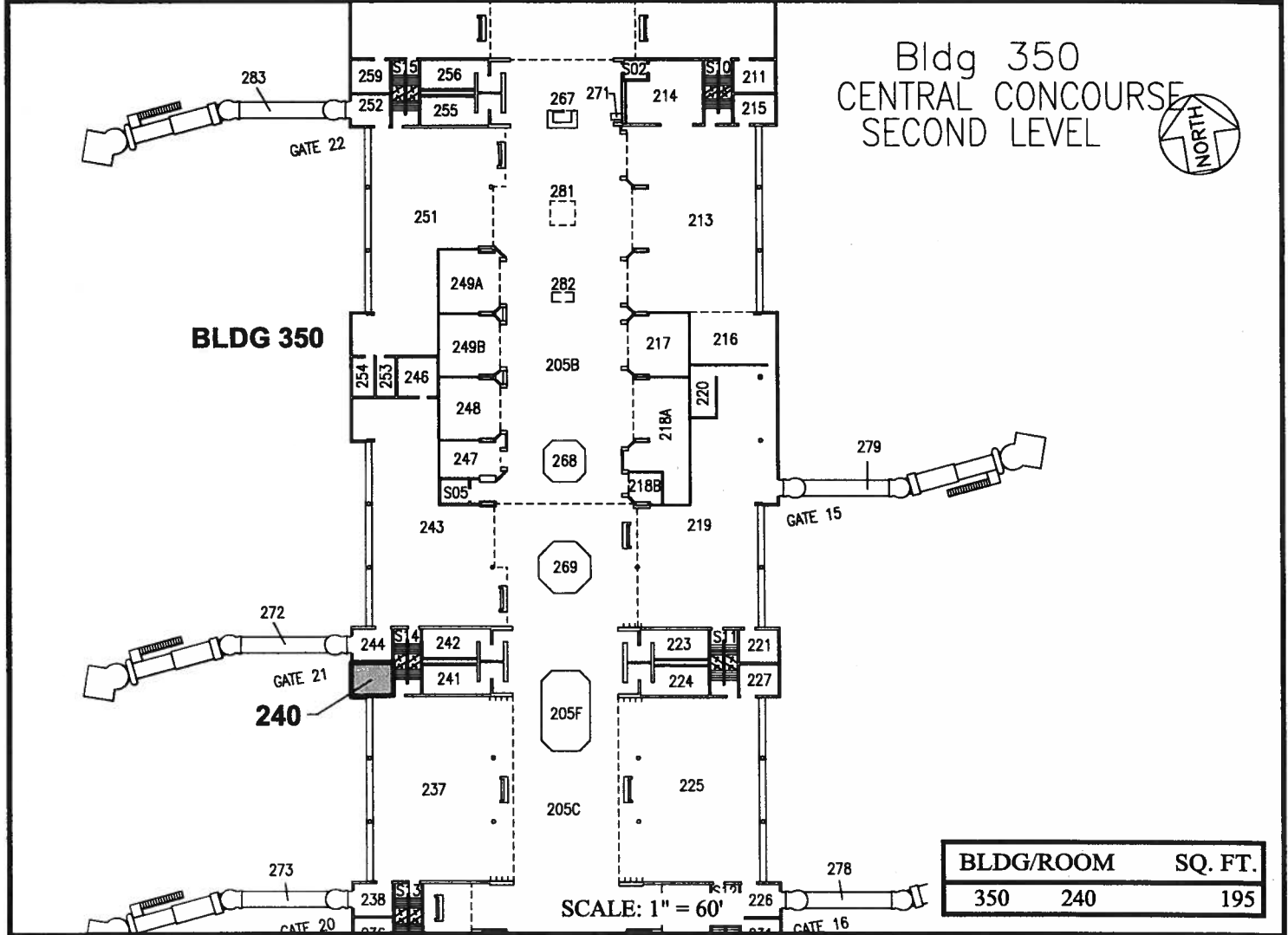
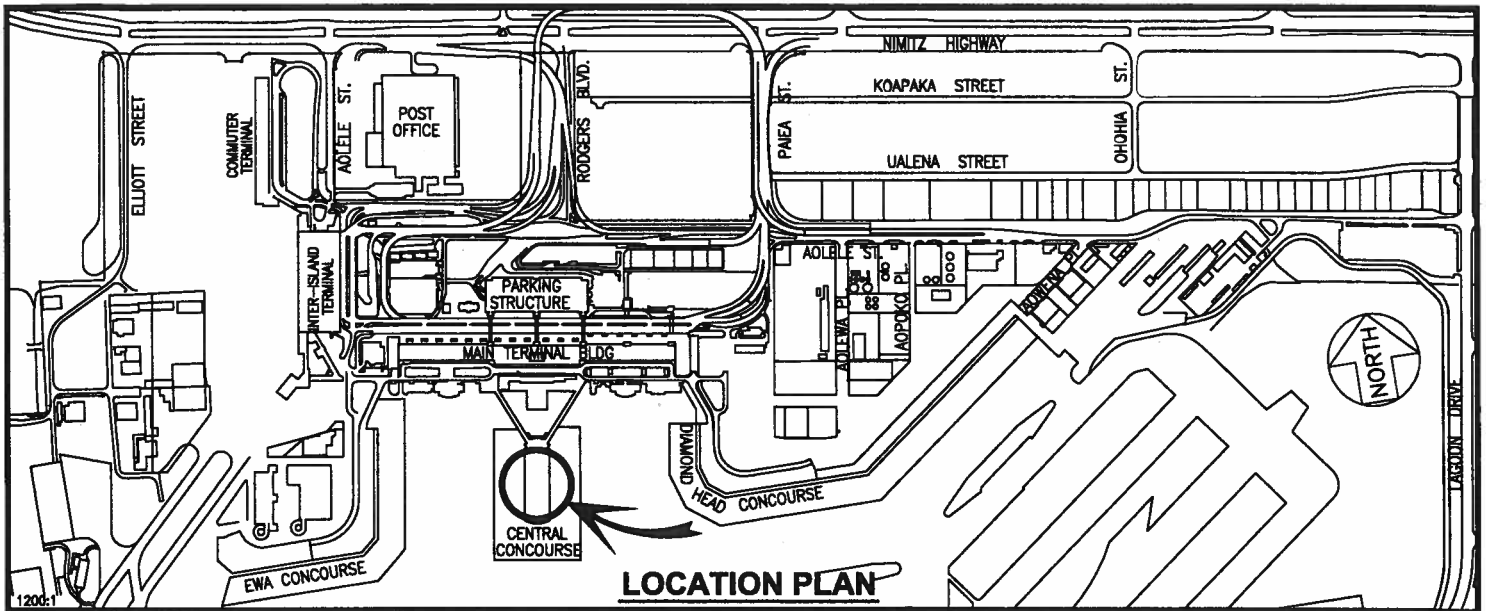

DATE : MARCH 2016

EXHIBIT: **D-2**



Airports Division

DELTA AIR LINES, INC.

**BUILDING 350  
CENTRAL CONCOURSE  
SECOND LEVEL**

350240

PLAT A2

**HONOLULU INTERNATIONAL AIRPORT**

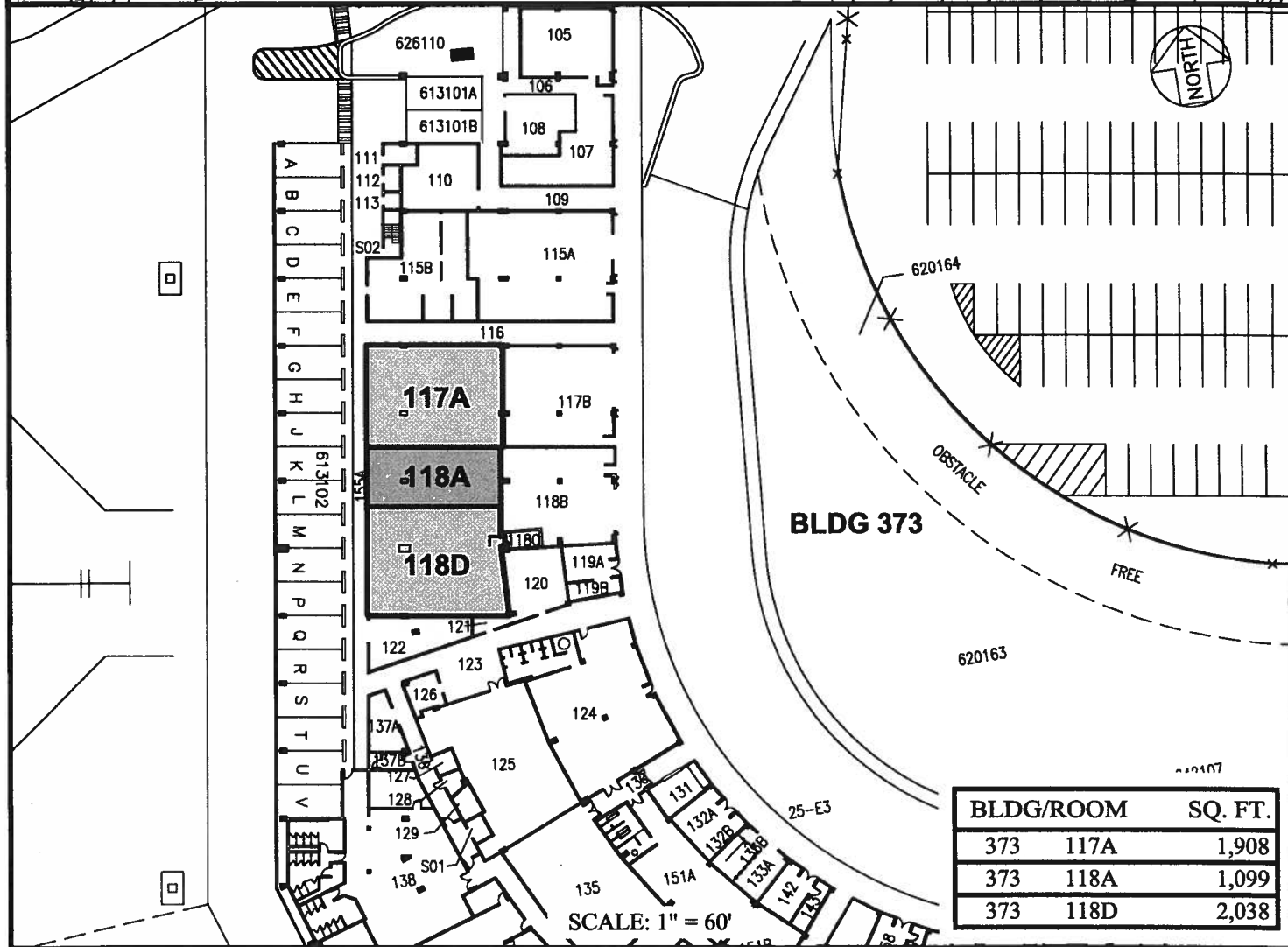
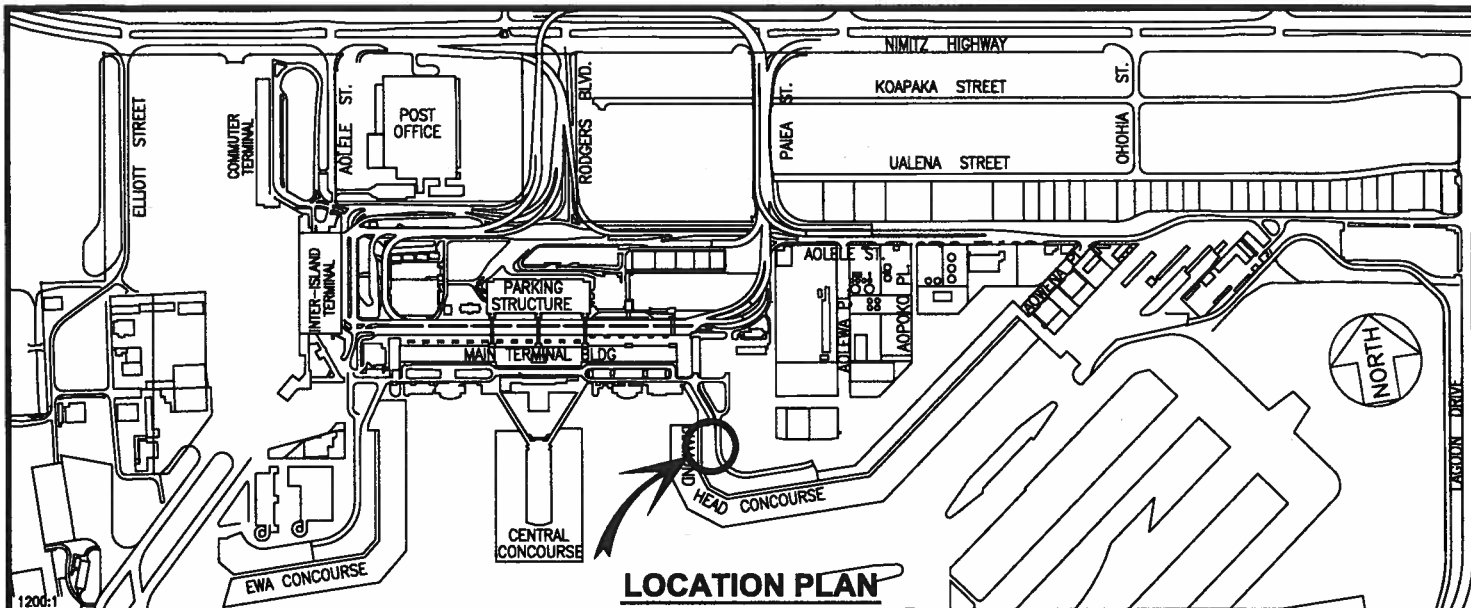

BLDG/ROOM	SQ. FT.
373 117A	1,908
373 118A	1,099
373 118D	2,038

DATE : MARCH 2016 EXHIBIT: E



DELTA AIR LINES, INC.

BUILDING 373  
DIAMOND HEAD CONCOURSE  
GROUND LEVEL

34117A  
34118A,D  
PLAT A1

HONOLULU INTERNATIONAL AIRPORT

N:\AIRPORTS\HNL\_HONOLULU\CAD\PM\HNL\_373118A-01.DWG

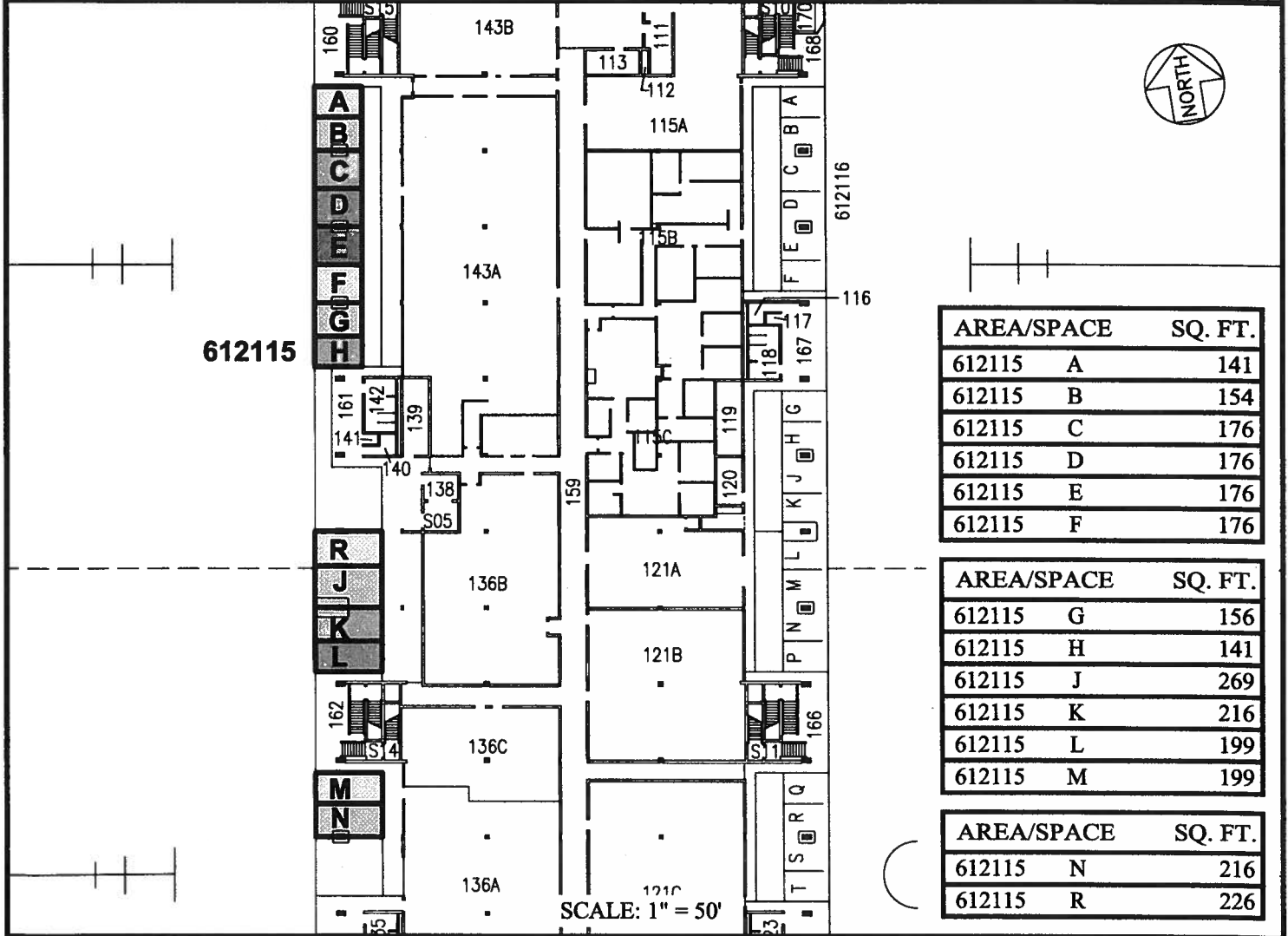
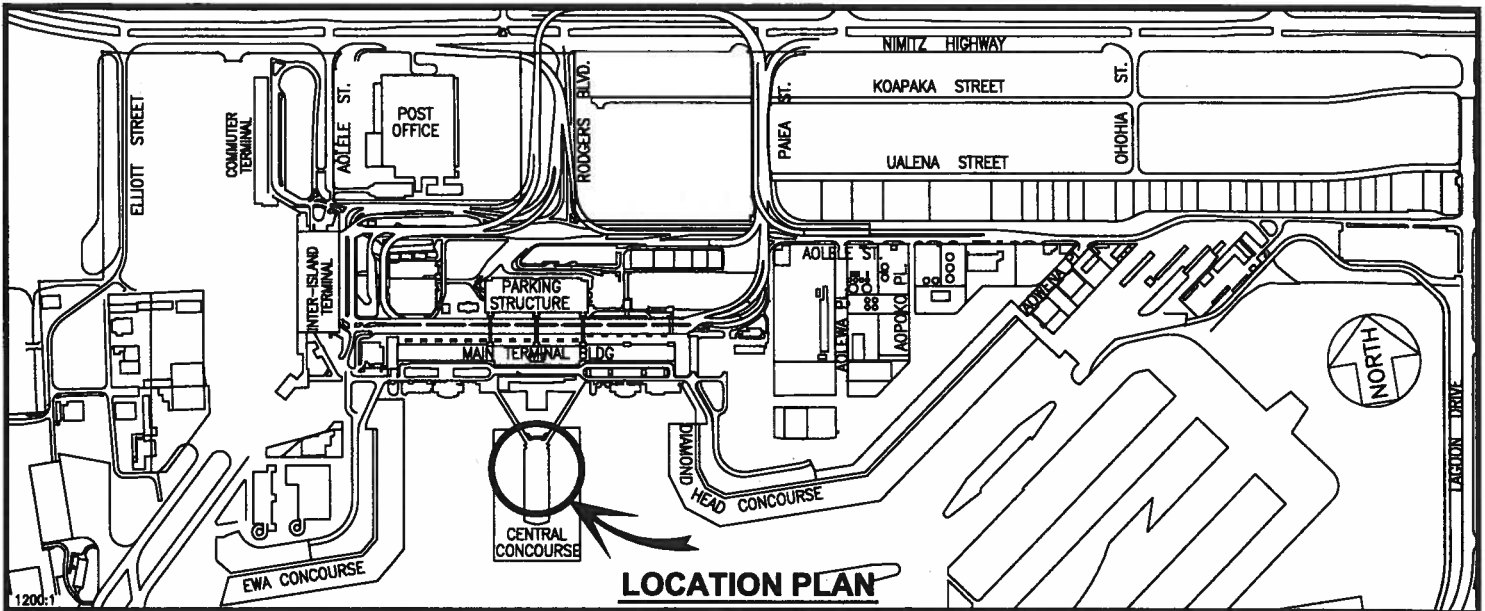

AREA/SPACE	SQ. FT.
612115 A	141
612115 B	154
612115 C	176
612115 D	176
612115 E	176
612115 F	176

AREA/SPACE	SQ. FT.
612115 G	156
612115 H	141
612115 J	269
612115 K	216
612115 L	199
612115 M	199

AREA/SPACE	SQ. FT.
612115 N	216
612115 R	226

DATE : MARCH 2016

EXHIBIT: **F**



DELTA AIR LINES, INC.

PARKING FACILITIES  
OPERATIONAL RAMP AREAS  
GROUND LEVEL

612115A-F  
612115G-M  
612115N,R  
PLAT A1

**HONOLULU INTERNATIONAL AIRPORT**

N:\AIRPORTS\HNL\_HONOLULU\CAD\PM\HNL\_612115A-01.DWG

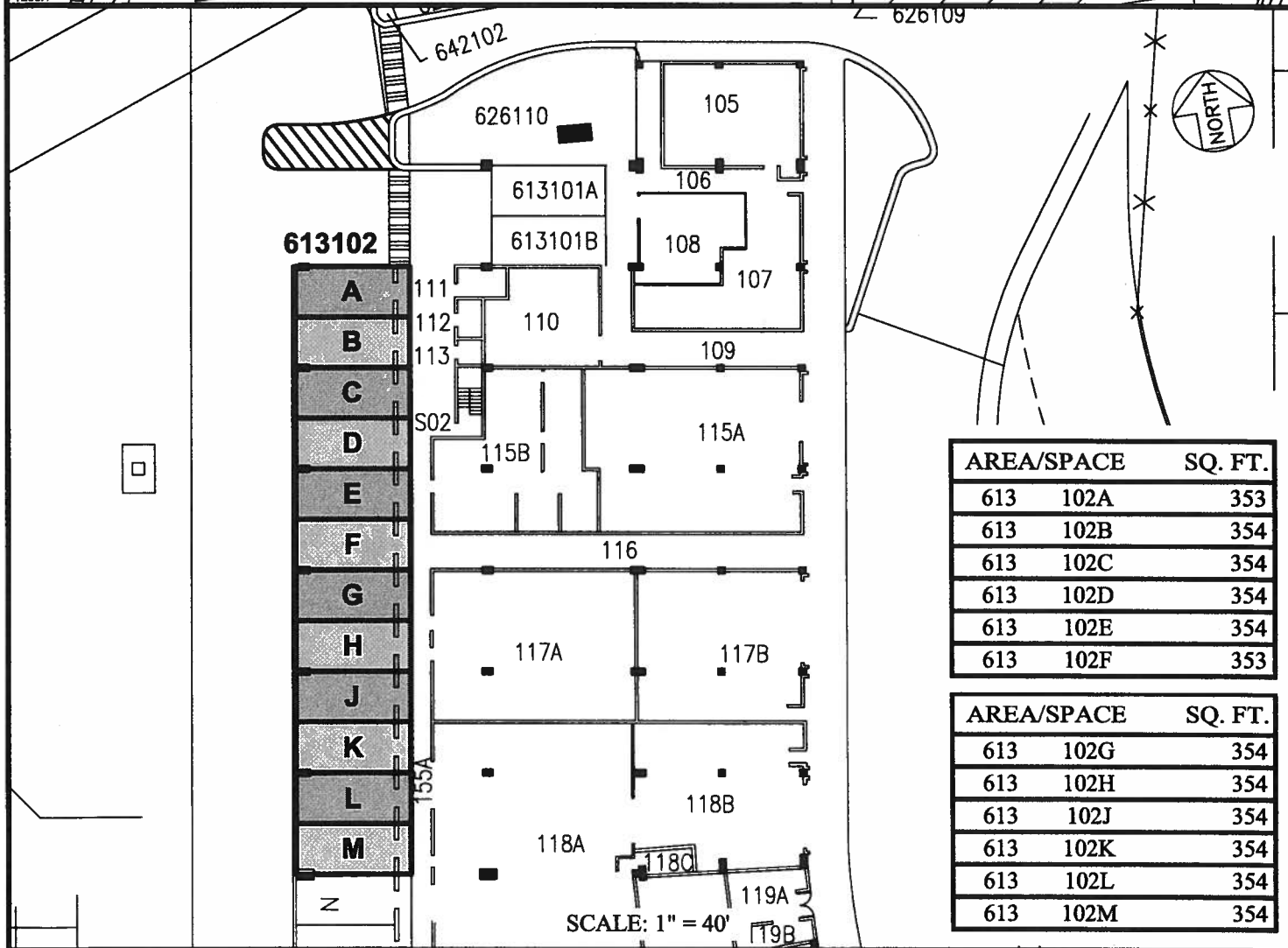
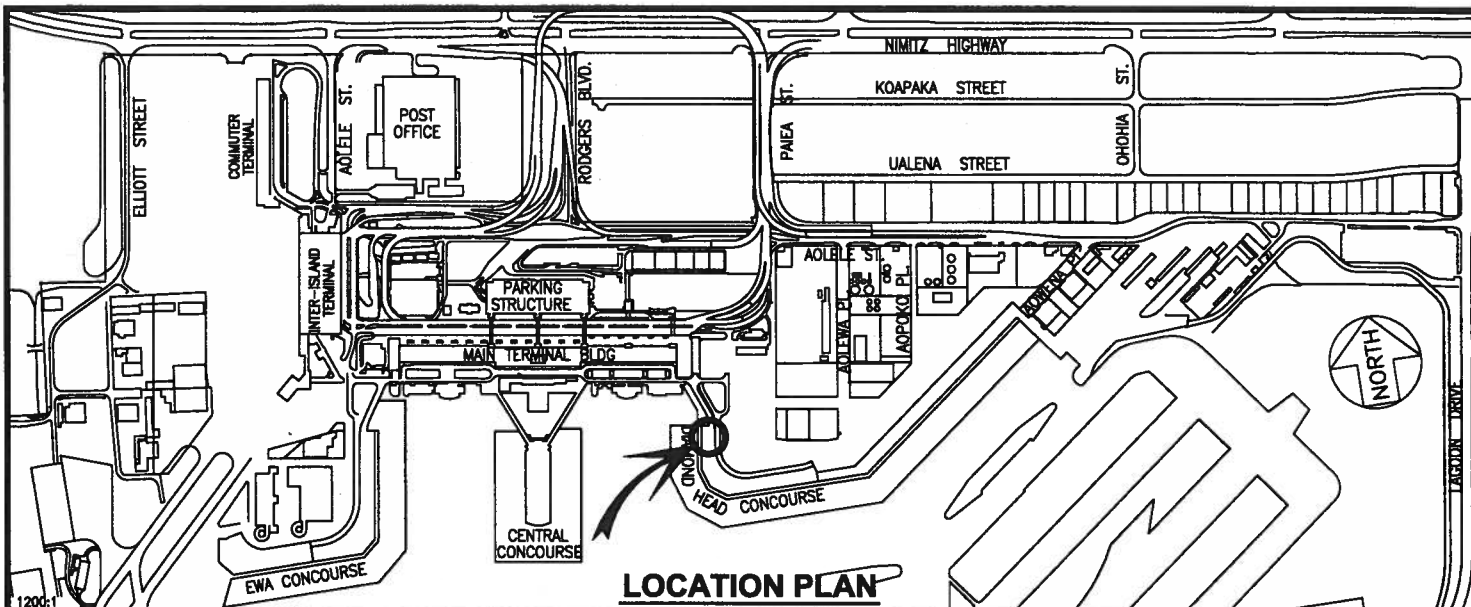

AREA/SPACE	SQ. FT.
613 102A	353
613 102B	354
613 102C	354
613 102D	354
613 102E	354
613 102F	353

AREA/SPACE	SQ. FT.
613 102G	354
613 102H	354
613 102J	354
613 102K	354
613 102L	354
613 102M	354

DATE : MARCH 2016 EXHIBIT: **G**



**DELTA AIR LINES, INC.**

**PARKING FACILITIES  
DIAMOND HEAD CONCOURSE  
GROUND LEVEL**

**613102A-H  
613102J  
613102K-M  
PLAT M1**

N:\AIRPORTS\HNL\_HONOLULU\CAD\PM\HNL\_613102A-01.DWG

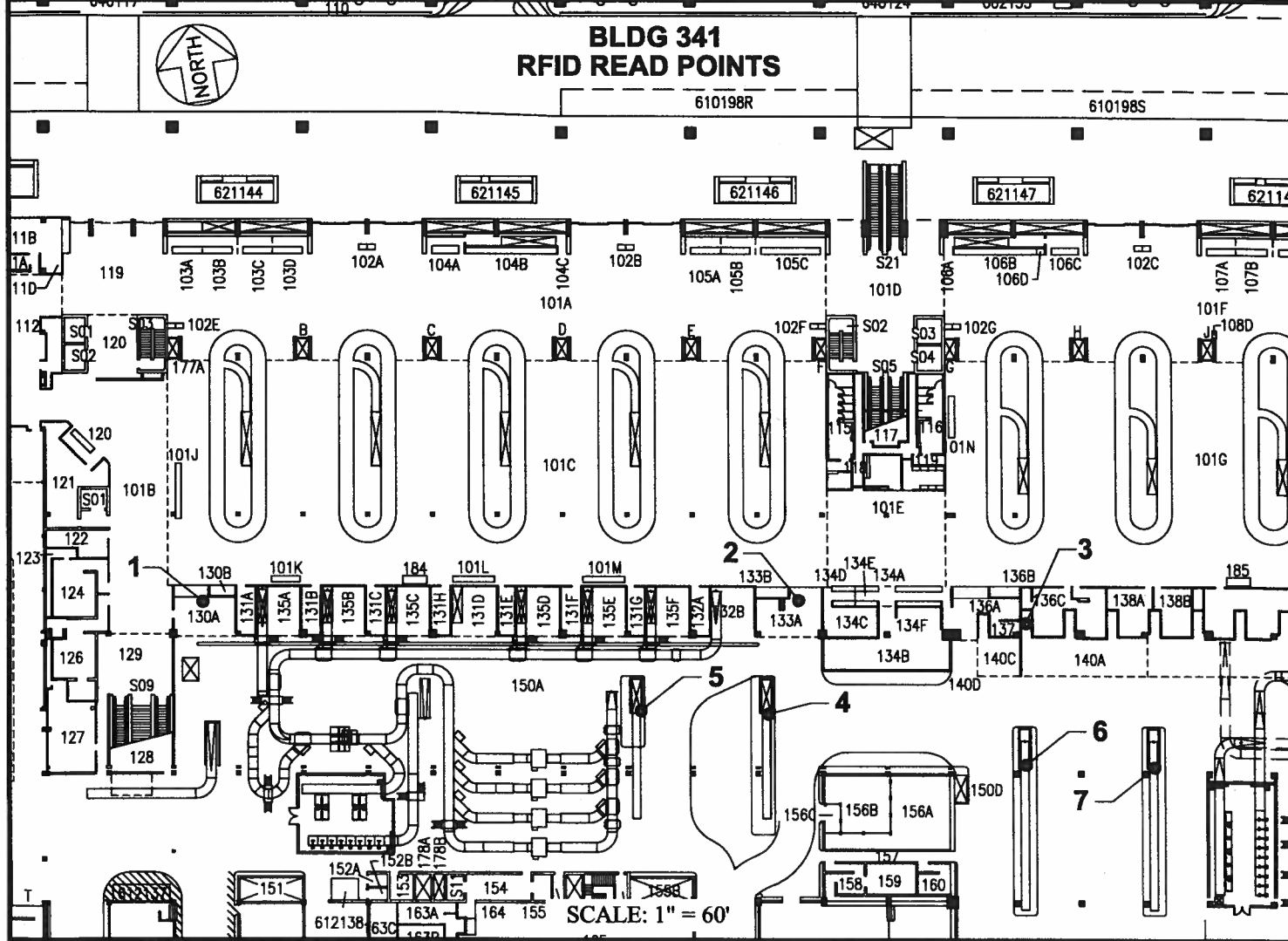
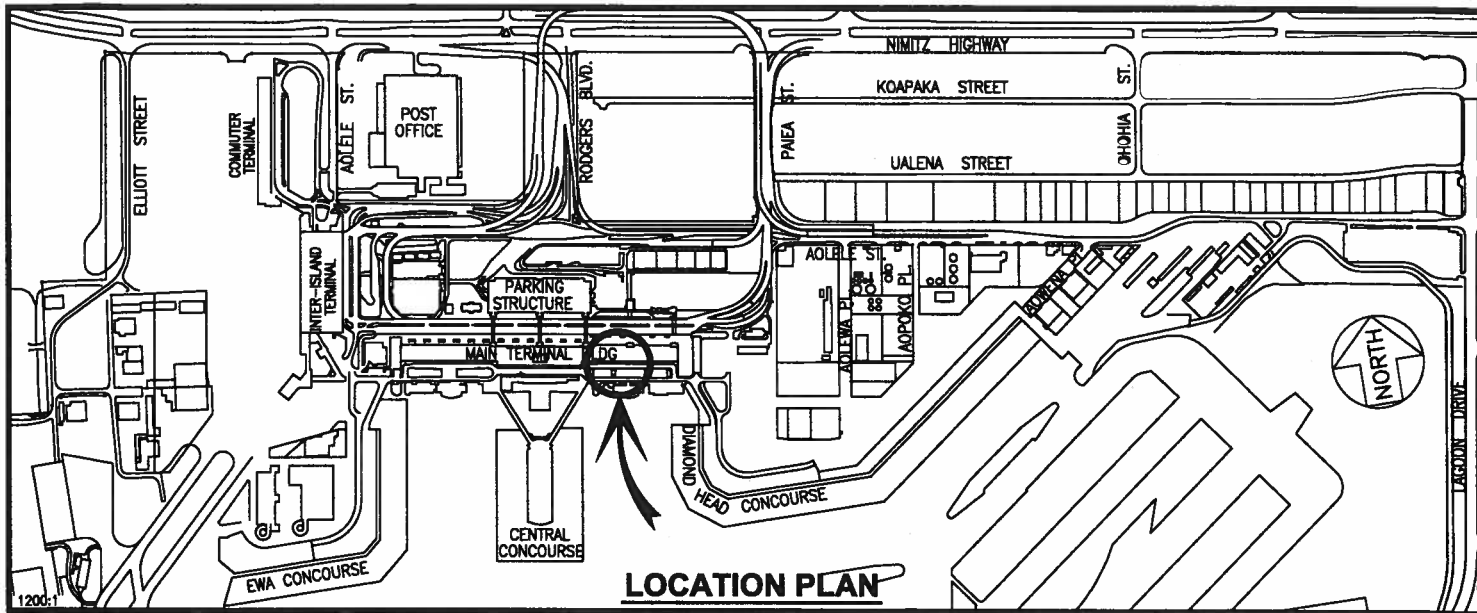

DATE : MARCH 2016

EXHIBIT: H-1



DELTA AIR LINES, INC.

BUILDING 341  
DIAMOND HEAD DOMESTIC  
GROUND LEVEL

READ POINTS  
1-7  
PLAT A1

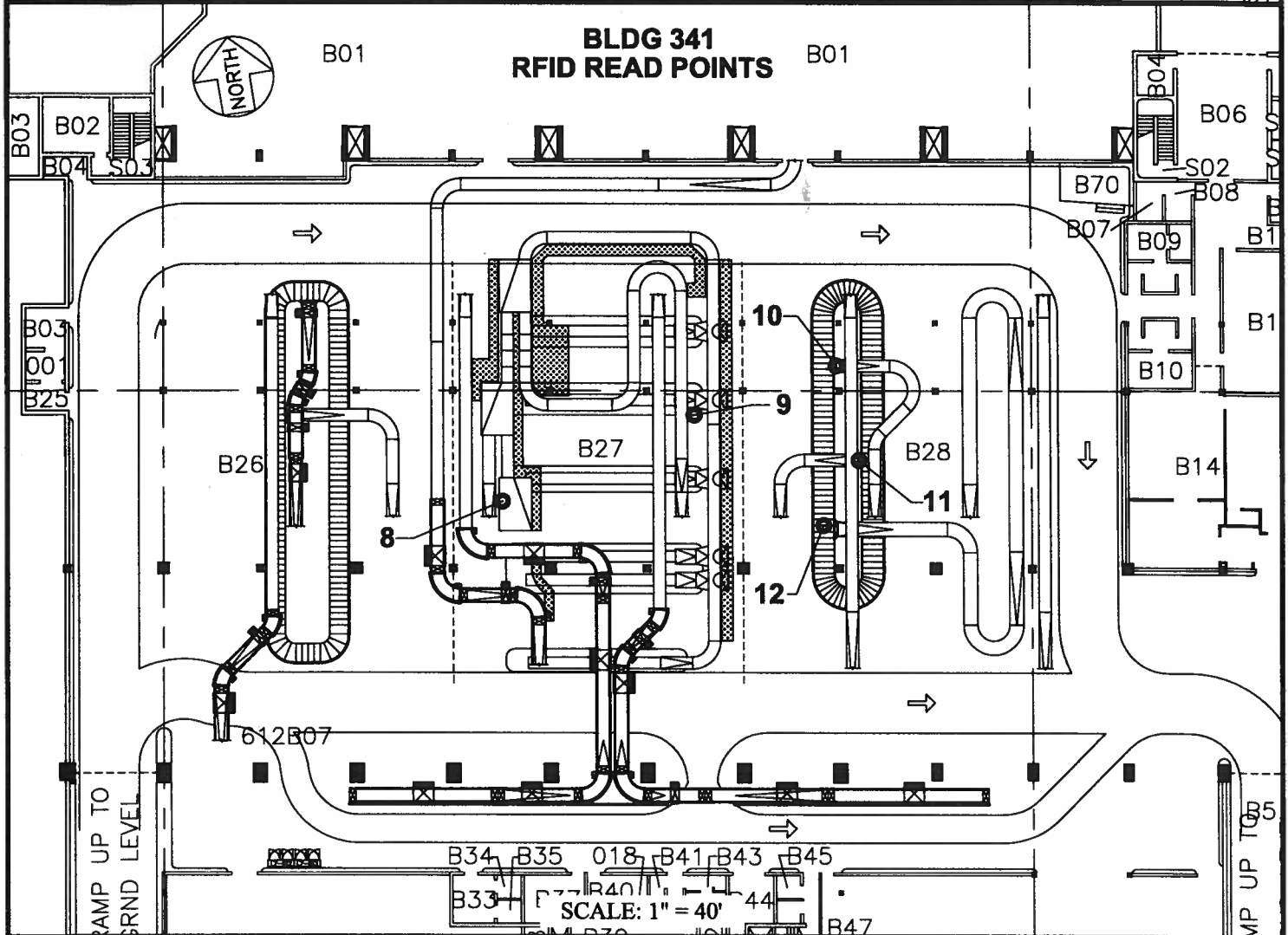
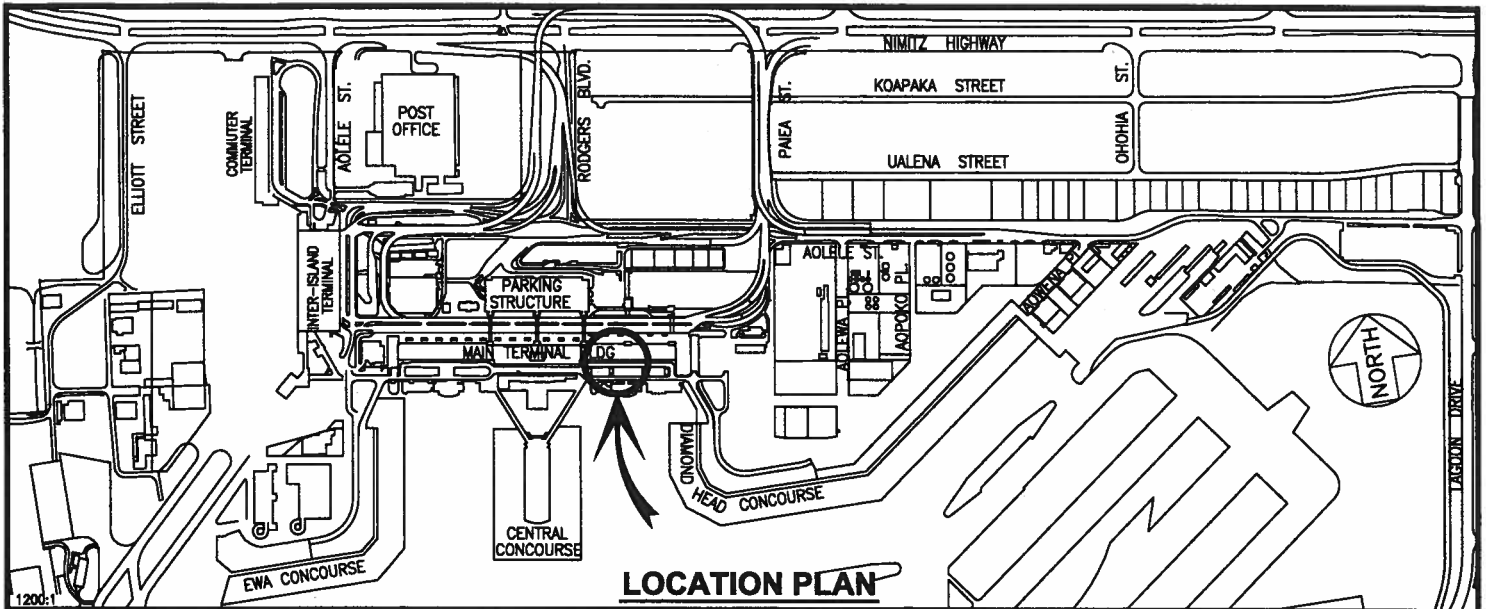

DATE : MARCH 2016

EXHIBIT: **H-2**



DELTA AIR LINES, INC.

BUILDING 341  
DIAMOND HEAD DOMESTIC  
BASEMENT LEVEL

READ POINTS  
8-12  
PLAT AB



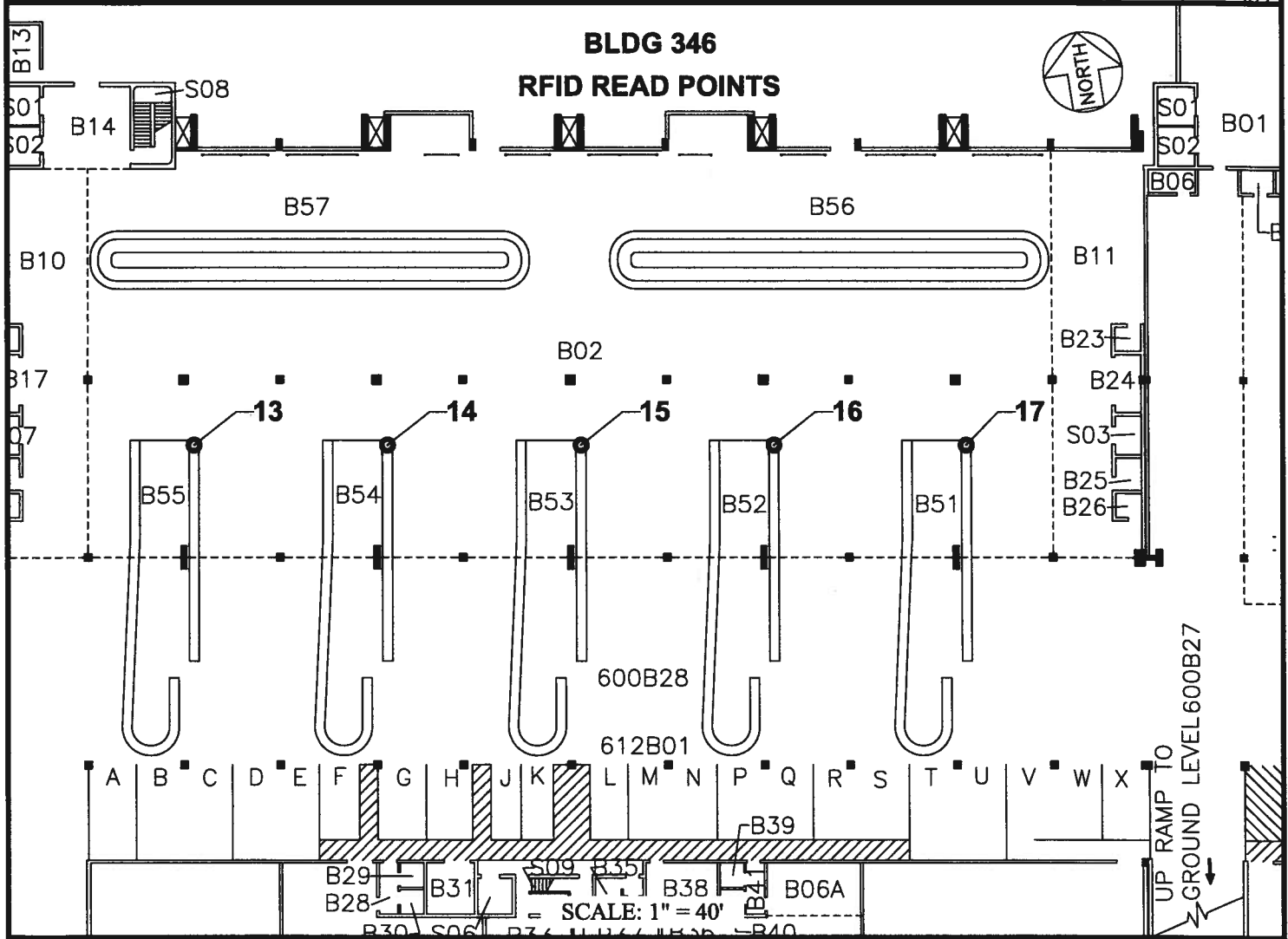
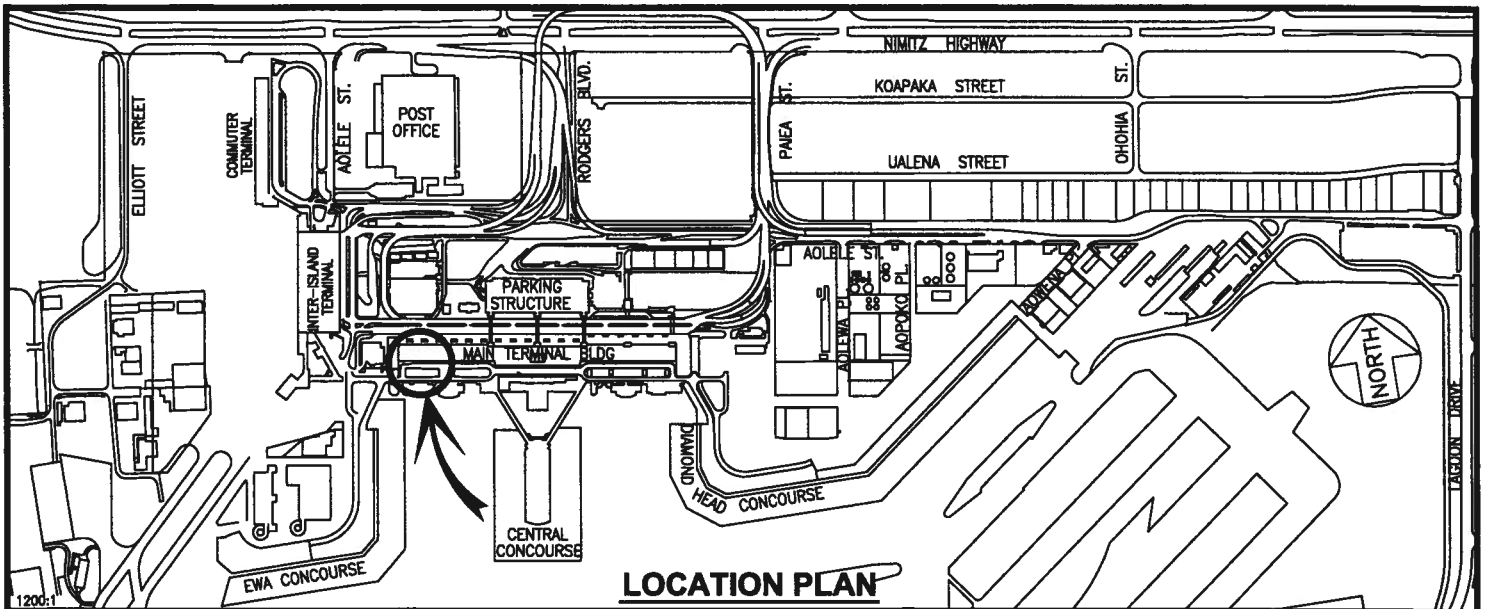

DATE : MARCH 2016

EXHIBIT: **H-3**



Airports Division

DELTA AIR LINES, INC.

**BUILDING 346  
INT'L ARRIVAL BUILDING  
BASEMENT LEVEL**

**READ  
POINTS  
13-17  
PLAT AB**