

DAVID Y. IGE
GOVERNOR



STATE OF HAWAII
DEPARTMENT OF TRANSPORTATION
869 PUNCHBOWL STREET
HONOLULU, HAWAII 96813-5097

FORD N. FUCHIGAMI
DIRECTOR

Deputy Directors
JADE T. BUTAY
ROSS M. HIGASHI
EDWIN H. SNIFFEN
DARRELL T. YOUNG

IN REPLY REFER TO:

Board of Land and
Natural Resources
State of Hawaii
Honolulu, Hawaii

ISSUANCE OF A REVOCABLE PERMIT FOR SPACES
IN THE MAIN TERMINAL FOR AIRLINE OPERATIONS
WESTJET
LĪHU'E AIRPORT
TAX MAP KEY: (4) 3-5-01: PORTION OF 8

KAUA'I

REQUEST:

Issuance of a revocable permit to WestJet (WJ), for spaces in the Main Terminal to support its airline operations at Līhu'e Airport.

LEGAL REFERENCE:

Sections 171-11 and 171-55, Hawai'i Revised Statutes

APPLICANT:

WJ, whose business address is 22 Aerial Place NE, Calgary, Canada Alberta T2E 3J1

LOCATION AND TAX MAP KEY:

Portion of Līhu'e Airport, Līhu'e, Island of Kaua'i, identified by
Tax Map Key: 4th Division, 3-5-01: Portion of 8

AREA:

Bldg/Room Nos. 306-129, 306-130, 306-224B & 306-224F, containing a total area of approximately 945 square feet, as shown on the attached Exhibits A-1 and A-2.

ITEM M-9

BLNR – ISSUANCE OF A REVOCABLE PERMIT FOR MAIN TERMINAL SPACES FOR AIRLINE OPERATIONS – WESTJET

Page 2

ZONING:

State Land Use District: Urban
County of Kaua'i: Industrial (IG-STP)

LAND TITLE STATUS:

Section 5(a) lands of the Hawai'i Admission Act: Non-Ceded
DHHL 30% entitlement lands pursuant to Hawai'i Admission Act YES _____ NO X

CURRENT USE STATUS:

Airport and aeronautical purposes

CHARACTER OF USE:

Baggage make-up, ticket counter, and office spaces

COMMENCEMENT DATE:

To be determined by the Director upon complete execution of the revocable permit.

MONTHLY RENTAL:

\$ 6,142.50 (as determined from the DOTA schedule of rates and charges established by appraisal of Airports property statewide)

SECURITY DEPOSIT:

\$ 18,427.50 (three times the monthly rental)

HOLDOVER TENANCY:

\$ 204.75

DCCA VERIFICATION:

Place of business registration confirmed: YES X NO _____
Registered business name confirmed: YES X NO _____
Good standing confirmed: YES X NO _____

BLNR – ISSUANCE OF A REVOCABLE PERMIT FOR MAIN TERMINAL SPACES FOR AIRLINE OPERATIONS – WESTJET

Page 3

REMARKS:

The Department of Transportation (DOT) has no objections to WJ's request and therefore, in accordance with Sections 171-11 and 171-55, HRS, relating to Public Purposes and Permits, respectively, and therefore, the DOT proposes to issue a month-to-month revocable permit to WJ for spaces in the Main Terminal for its airline operations.

RECOMMENDATION:

That the Board authorize the Department of Transportation to issue a month-to-month revocable permit to WJ, subject to: (1) terms and conditions herein outlined, which are by reference incorporated herein; and (2) such additional terms and conditions as may be prescribed by the Director of Transportation to best serve the interests of the State.

Respectfully submitted,



FORD N. FUCHIGAMI
Director of Transportation

APPROVED FOR SUBMITTAL:

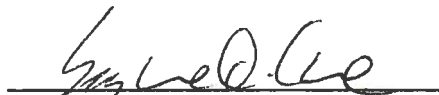

SUZANNE D. CASE
Chairperson and Member

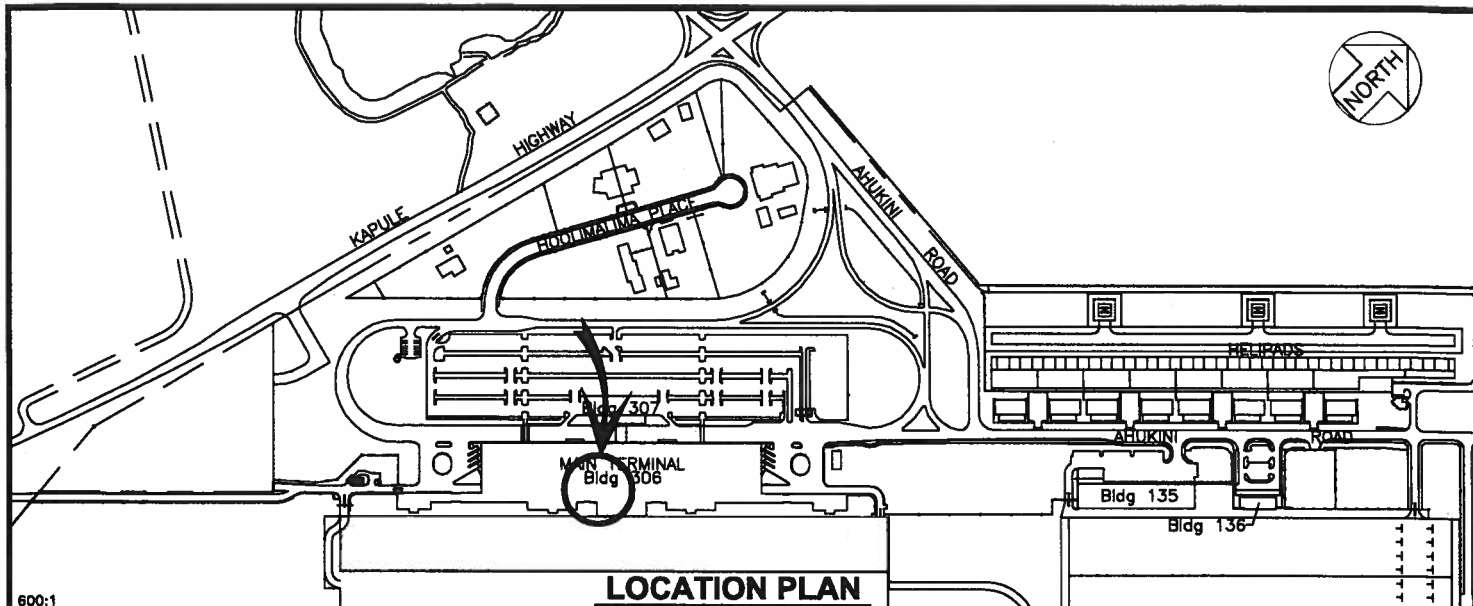

600:1

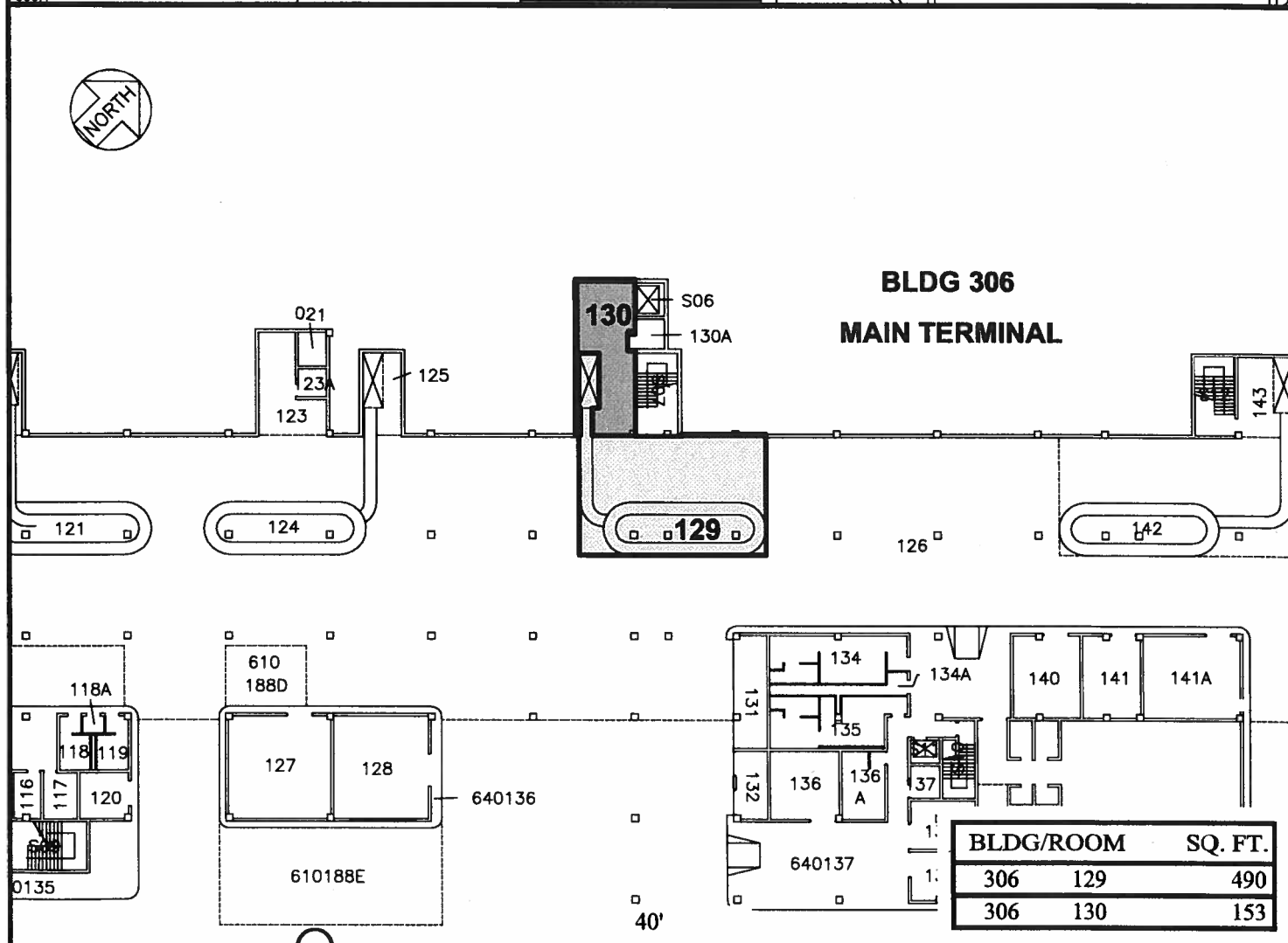

RP-8513

DATE : MARCH 2016

EXHIBIT: **A-1**



WESTJET

**BUILDING 306
MAIN TERMINAL
APRON LEVEL**

306129-130

PLATS C1, 45

LIHUE AIRPORT

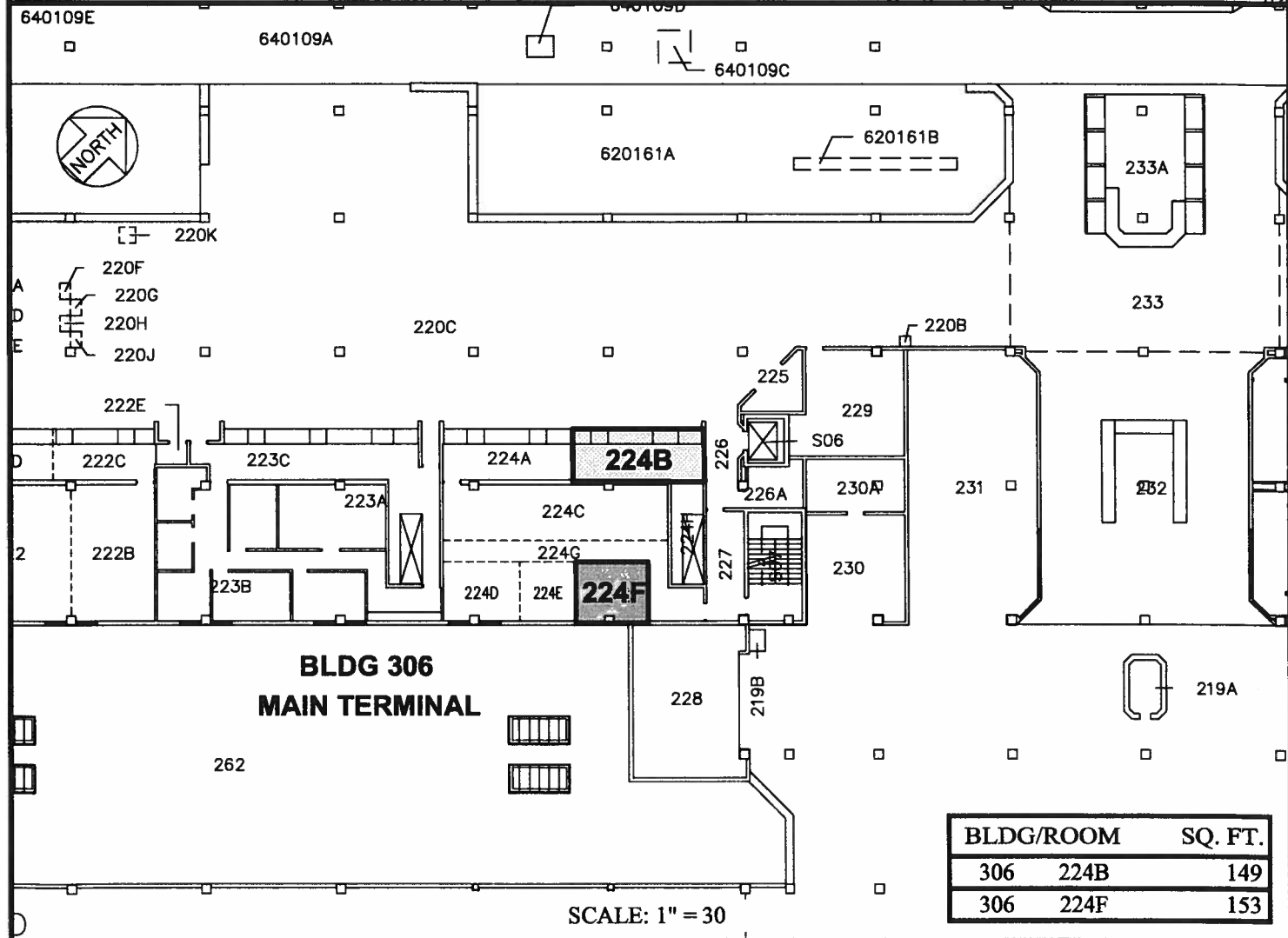
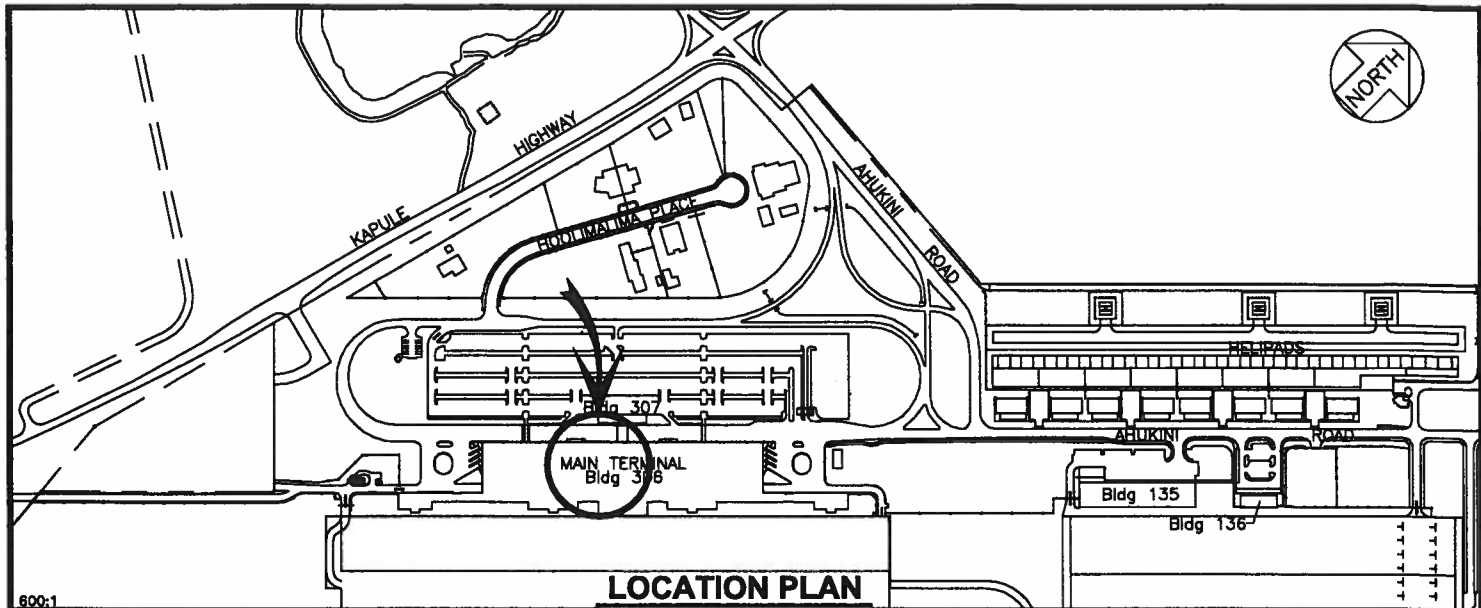

BLDG/ROOM	SQ. FT.
306 224B	149
306 224F	153

RP-8513	DATE : MARCH 2016	EXHIBIT: A-2	
 Airports Division	WESTJET	BUILDING 306 MAIN TERMINAL SECOND LEVEL	306224B&F PLATS C2, 45

LIHUE AIRPORT

N:\AIRPORTS\LIH_Lihue\CAD\PM\lth_306224B-01.dwg