

DAVID Y. IGE
GOVERNOR



STATE OF HAWAII
DEPARTMENT OF TRANSPORTATION
869 PUNCHBOWL STREET
HONOLULU, HAWAII 96813-5097

FORD N. FUCHIGAMI
DIRECTOR

Deputy Directors
JADE T. BUTAY
EDWIN H. SNIFFEN
ROSS M. HIGASHI
DARRELL T. YOUNG

IN REPLY REFER TO:

Board of Land and
Natural Resources
State of Hawaii
Honolulu, Hawaii

ISSUANCE OF A REVOCABLE PERMIT FOR SECURITY OFFICES
SPACE NOS. 330-108 TO 330-111, 330-113 TO 330-115
SECURITAS SECURITY SERVICES USA, INC.
KAHULUI AIRPORT
TAX MAP KEY: (2) 3-8-01: PORTION OF 19

MAUI

REQUEST:

Issuance of a revocable permit to Securitas Security Services USA, Inc. (SSS), for a security office at Kahului Airport (OGG)

LEGAL REFERENCE:

Sections 171-11 and 171-55, Hawai'i Revised Statutes

APPLICANT:

SSS, whose business address is 888 N. Nimitz Highway #105, Honoulu, Hawai'i 96817

LOCATION AND TAX MAP KEY:

Portion of Kahului Airport (OGG), Kahului, Island of Maui, identified by
Tax Map Key: 2nd Division, 3-8-01: Portion of 19

AREA:

Building/Room No. 330-108, containing an area of approximately 136 square feet,
Building/Room No. 330-109, containing an area of approximately 79 square feet,
Building/Room No. 330-110, containing an area of approximately 264 square feet,
Building/Room No. 330-111, containing an area of approximately 89 square feet,
Building/Room No. 330-113, containing an area of approximately 61 square feet,
Building/Room No. 330-114, containing an area of approximately 64 square feet,
Building/Room No. 330-115, containing an area of approximately 275 square feet,
as shown on the attached map labeled Exhibit "A".

ITEM M-12

BLNR – ISSUANCE OF A REVOCABLE PERMIT FOR SECURITY OFFICES
SECURITAS SECURITY SERVICES USA, INC.

Page 2

ZONING:

State Land Use District: Urban
County of Maui: Airport

LAND TITLE STATUS:

Section 5(a) lands of the Hawaii Admission Act: Non-Ceded
DHHL 30% entitlement lands pursuant to Hawaii Admission Act YES ___ NO X

CURRENT USE STATUS:

Airport and aeronautical purposes

CHARACTER OF USE:

Office spaces for security

COMMENCEMENT DATE:

To be determined by the Director upon complete execution of the revocable permit.

MONTHLY RENTAL:

\$ 2,942.72 (as determined from the DOTA schedule of rates and charges established by appraisal of Airports property statewide)

SECURITY DEPOSIT:

\$ 8,828.16 (three times the monthly rental)

HOLDOVER TENANCY:

\$ 98.09

DCCA VERIFICATION:

Place of business registration confirmed: YES X NO ___
Registered business name confirmed: YES X NO ___
Good standing confirmed: YES X NO ___

BLNR – ISSUANCE OF A REVOCABLE PERMIT FOR SECURITY OFFICES
SECURITAS SECURITY SERVICES USA, INC.

Page 3

CHAPTER 343, HRS - ENVIRONMENTAL ASSESSMENT:

Pursuant to Section 11-200-8(a), Environmental Impact Statement Rules of the Department of Health, State of Hawaii, this disposition is exempt from requirements regarding preparation of an environmental assessment, negative declaration, or environmental impact statement as required by Chapter 343, Hawaii Revised Statutes, as amended, relating to Environmental Impact Statements, because the proposed action falls within Exemption Class #1, Comprehensive Exemption List for the State of Hawaii, Department of Transportation, dated November 15, 2000, as approved by the Environmental Quality Council. Exemption Class #1 covers operations, repairs, or maintenance of existing structures, facilities, equipment, or topographical features involving negligible or no expansion or change of use beyond that previously existing.

REMARKS:

The DOT has no objections to the issuance of a revocable permit to SSS's request, in accordance with Sections 171-11 and 171-55, HRS, relating to Public Purposes and Permits, respectively, and therefore, the DOT proposes to issue a month-to-month revocable permit to SSS, Building/Room No. 330-108, -109, -110, -111, -113, -114, and -115, for office spaces located in the Main Terminal at OGG.

RECOMMENDATION:

That the Board authorize the Department of Transportation to issue a month-to-month revocable permit to SSS, subject to: (1) terms and conditions herein outlined, which are by reference incorporated herein; and (2) such additional terms and conditions as may be prescribed by the Director of Transportation to best serve the interests of the State.

Respectfully submitted,



FORD N. FUCHIGAMI
Director of Transportation

APPROVED FOR SUBMITTAL:



SUZANNE D. CASE
Chairperson and Member

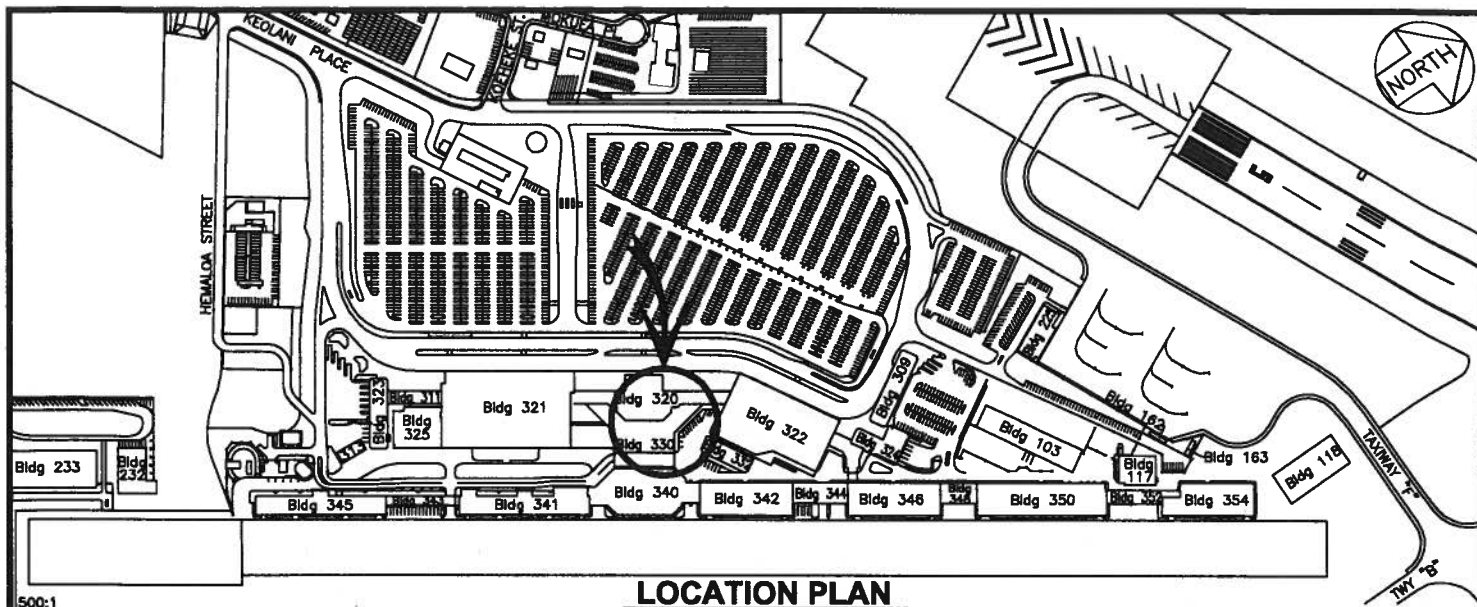

LOCATION PLAN

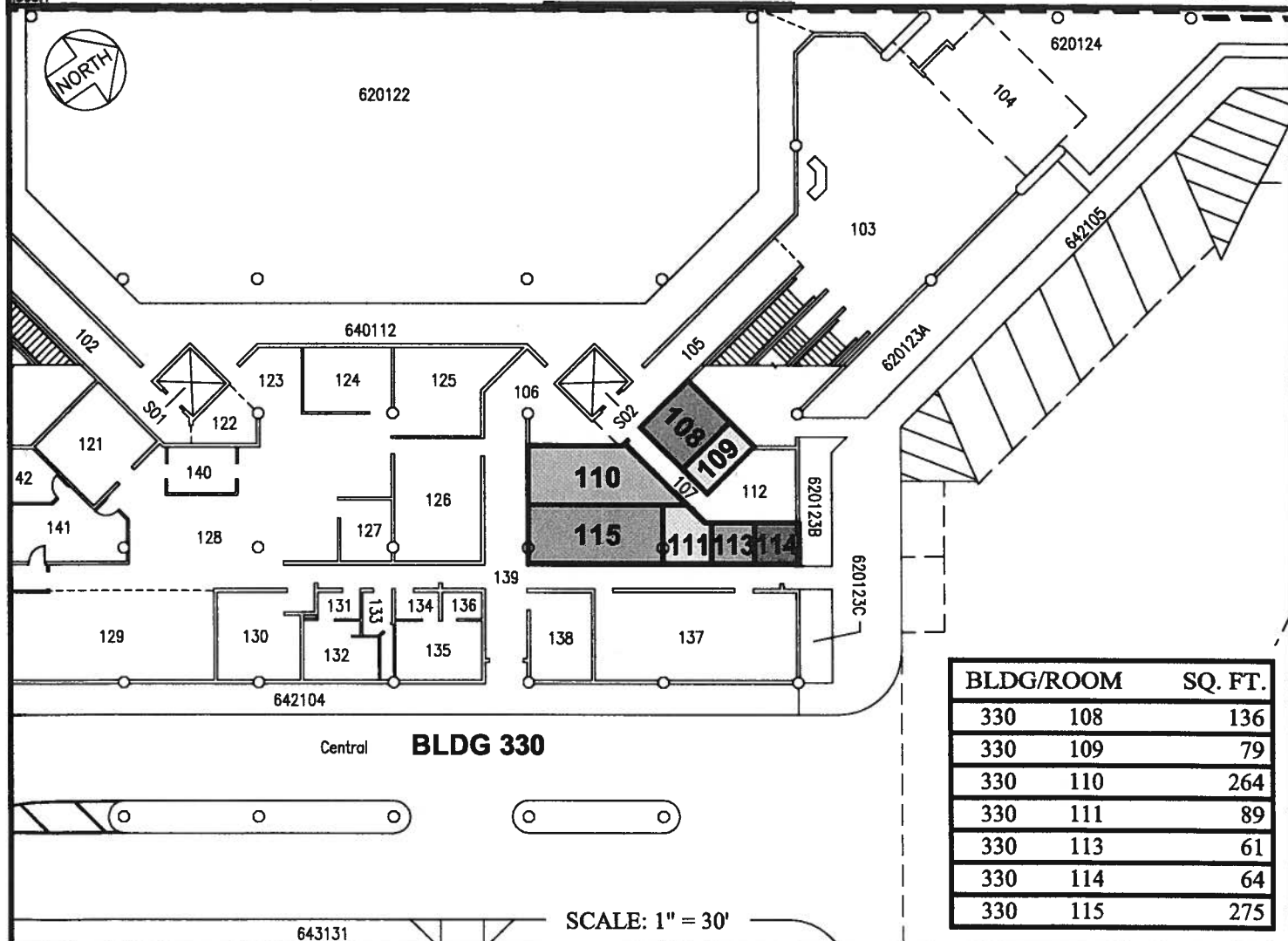

Central **BLDG 330**

BLDG/ROOM	SQ. FT.
330 108	136
330 109	79
330 110	264
330 111	89
330 113	61
330 114	64
330 115	275

SCALE: 1" = 30'

RP-8517

DATE : MARCH 2016

EXHIBIT: **A**



Airports Division

SECURITAS SECURITY SERVICES, INC.

**BUILDING 330
TERMINAL BLDG
GROUND LEVEL**

**330108-111
330113-115**

PLAT A1

KAHULUI AIRPORT

N:\AIRPORTS\OGG_Kahului\CAD\PM\ogg_330108-01.dwg