



STATE OF HAWAII
DEPARTMENT OF TRANSPORTATION
869 PUNCHBOWL STREET
HONOLULU, HAWAII 96813-5097

IN REPLY REFER TO:

Board of Land and
Natural Resources
State of Hawaii
Honolulu, Hawaii

AMENDMENT TO PRIOR BOARD ACTION OF APRIL 22, 2016, ITEM M-3,
ADDITIONAL SPACE (SPACE NO. 373-120)
ISSUANCE OF A REVOCABLE PERMIT FOR AIRLINE OPERATIONS
DELTA AIR LINES, INC.
HONOLULU INTERNATIONAL AIRPORT
TAX MAP KEY: (1) 1-1-003: 001 (PORTION)

OAHU

On April 22, 2016, under agenda Item M-3, the Land Board authorized the Department of Transportation (DOT) to consolidate all airport terminal spaces under existing revocable permits and parking permits into one month-to-month revocable permit, to Delta Air Lines, Inc. for their airport operations at Honolulu International Airport.

PURPOSE:

DOT requests the addition of Space No. 373-120 to said submittal which was previously approved by the Land Board on April 22, 2016, Item M-3 (copy attached).

The changes should read as follows:

AREA:

Original:

BLDG/ROOM	SQ.FT.	PURPOSE	EXHIBIT	RENT
341-227	4,989	AIRLINE LOUNGE	A	\$25,764.03
341-134A	114	BAGGAGE MAKE-UP	B-1	\$ 588.71
341-134B	869	BAGGAGE MAKE-UP	B-1	\$ 4,487.66
341-134F	64	BAGGAGE MAKE-UP	B-1	\$ 330.51
341-216A	900	CHECK-IN COUNTER	B-2	\$ 4,647.75

ITEM M-2

BLNR – AMENDMENT TO PRIOR BOARD ACTION OF APRIL 22, 2016, ITEM M-3,
 ADDITIONAL SPACE (SPACE NO. 373-120)
 DELTA AIR LINES, INC.

Page 2

BLDG/ROOM	SQ.FT.	PURPOSE	EXHIBIT	RENT
341-216B	3,351	AIRPORT TICKET OFFICE	B-2	\$17,305.12
341-216C	167	STORAGE	B-2	\$ 862.41
341-216E	158	STORAGE	B-2	\$ 815.94
341-217A	751	CHECK-IN COUNTER	B-2	\$ 3,878.29
341-217B	4,365	FA OFFICE	B-2	\$22,541.59
341-217C	126	STORAGE	B-2	\$ 650.68
341-217D	165	STORAGE	B-2	\$ 852.09
341-240C	58	CS HELP DESK	B-2	\$ 299.52
341-278	45	CURBSIDE CHECK-IN	B-2	\$ 232.39
341-259A	7	SELF-SERVICE KIOSKS	B-2	\$ 36.15
341-259B	19	SELF-SERVICE KIOSKS	B-2	\$ 98.12
341-259C	7	SELF-SERVICE KIOSKS	B-2	\$ 36.15
341-259D	23	SELF-SERVICE KIOSKS	B-2	\$ 118.77
341-B37	205	COMMUNICATION ROOM	B-3	\$ 1,058.65
346-107F	45	AIRLINES FIS COUNTER	C	\$ 232.39
350-136A	2,995	OFFICE	D-1	\$15,466.68
350-136C	1,371	MAINTENANCE DEPT	D-1	\$ 7,080.07
350-143A	5,277	OFFICE	D-1	\$27,251.31
350-143B	1,254	OFFICE	D-1	\$ 6,475.86
350-240	195	OFFICE	D-2	\$ 1,007.01
373-117A	1,908	CABIN CLEANERS OFFICE	E	\$ 9,853.23
373-118A	1,099	STORES	E	\$ 5,675.42
373-118D	2,038	STORES	E	\$10,524.57
612-115A-H, 612-115J, 612-115K-N, and 612-115R	2,621	EQUIPMENT PARKING	F	\$13,535.28
613-102A-H, 613-102J-M	4,246	COVERED PARKING	G	\$21,927.05

BLNR – AMENDMENT TO PRIOR BOARD ACTION OF APRIL 22, 2016, ITEM M-3,
 ADDITIONAL SPACE (SPACE NO. 373-120)
 DELTA AIR LINES, INC.

Page 3

READ POINTS		RADIO FREQUENCY IDENTIFICATION DEVICES (RFID's)		
1-7			H-1	\$ 125.00
8-12			H-2	\$ 125.00
13-17			H-3	\$ 125.00

As Amended:

In addition to the above, the Amended Area will include the following space:

Area/Space No. 373-120, consisting of approximately 561 square feet, as shown on Exhibit E-2 (attached).

MONTHLY RENTAL:

Original:

\$204,058.40 (based upon a rate of \$61.97 per square foot, per annum, as published in the DOTA Signatory Carrier Rates and Charges, Hawaii Airports System, Effective July 1, 2015).

Amended:

\$206,955.50 (based upon a rate of \$61.97 per square foot, per annum, as published in the DOTA Signatory Carrier Rates and Charges, Hawaii Airports System, Effective July 1, 2015).

HOLDOVER TENANCY:

Original:

\$6,801.95

Amended:

\$6,898.52

REMARKS:

All other terms as outlined in the submittal previously approved by the Land Board remain unchanged.

BLNR – AMENDMENT TO PRIOR BOARD ACTION OF APRIL 22, 2016, ITEM M-3,
ADDITIONAL SPACE (SPACE NO. 373-120)
DELTA AIR LINES, INC.

Page 4

RECOMMENDATION:

The Land Board amends its prior action of April 22, 2016, under agenda Item M-3, by approving the additional space for the issuance of a revocable permit to Delta Air Lines, Inc., as herein outlined, which are by reference incorporated herein and subject to such other terms and conditions as may be prescribed by the Director of Transportation to best serve the interests of the State.

Respectfully submitted,



FORD N. FUCHIGAMI
Director of Transportation

APPROVED FOR SUBMITTAL:

SUZANNE D. CASE
Chairperson and Member

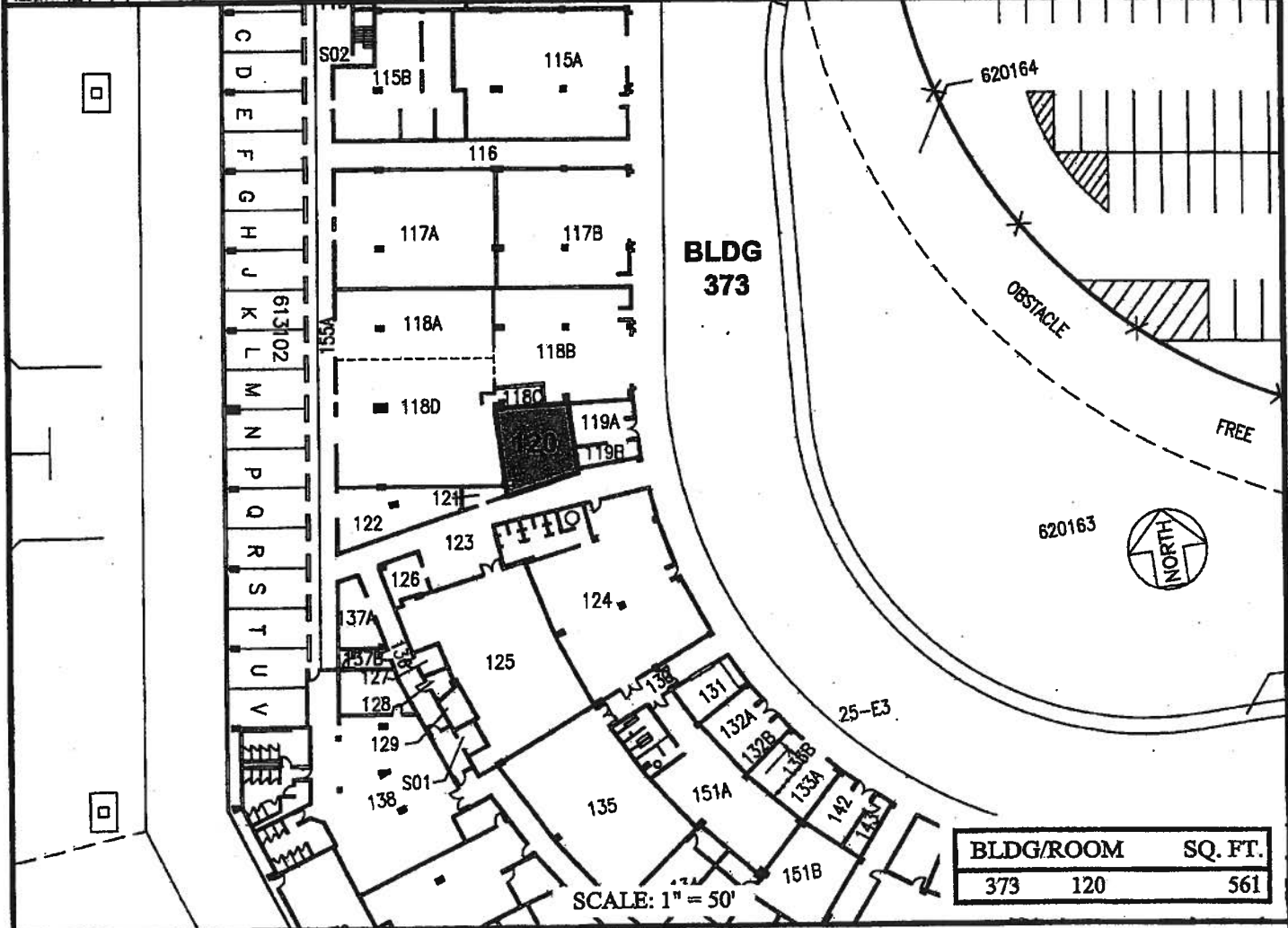
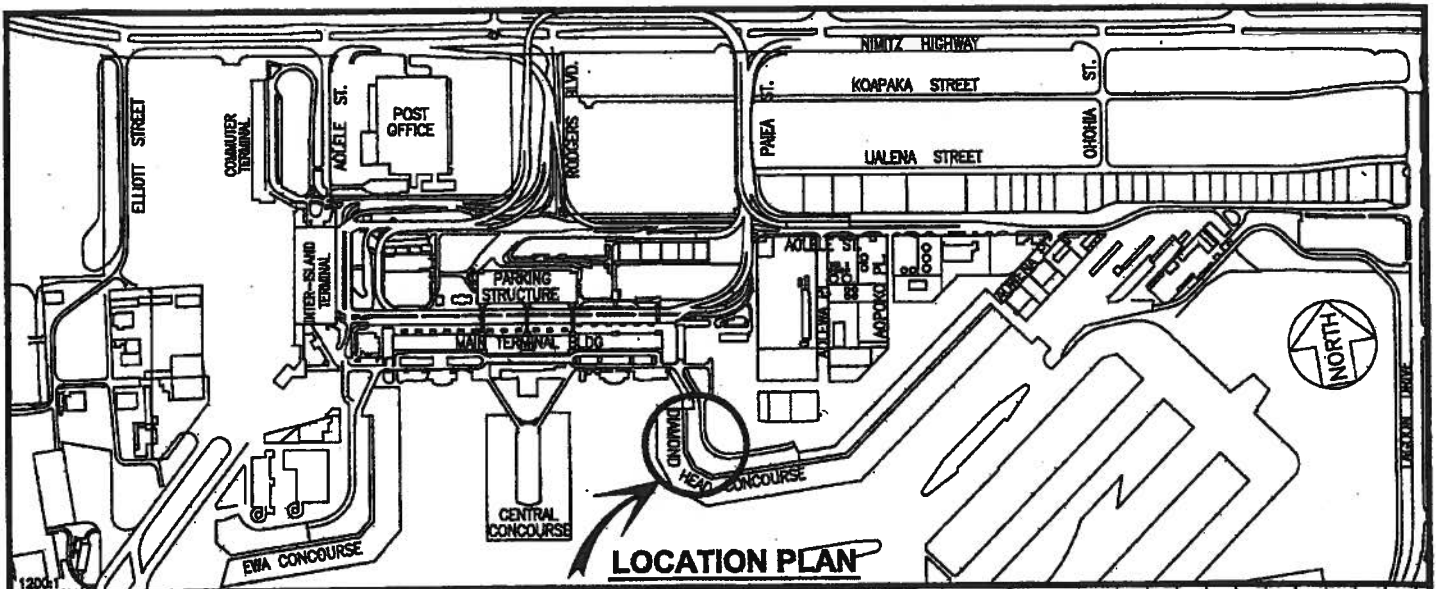

BLDG/ROOM	SQ. FT.
373 120	561

RP-8537

DATE : MAY 2016

EXHIBIT: E-2



Airports Division

DELTA AIR LINES, INC.

**BUILDING 373
DIAMOND HEAD CONCOURSE
GROUND LEVEL**

373120

PLAT MI

N:\AIRPORTS\HNL_HONOLULU\CAD\PM\HNL_373120-01.DWG

HONOLULU INTERNATIONAL AIRPORT

DAVID Y. IGE
GOVERNOR

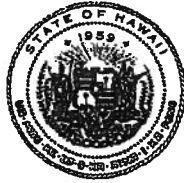

STATE OF HAWAII
DEPARTMENT OF TRANSPORTATION
869 PUNCHBOWL STREET
HONOLULU, HAWAII 96813-5097

APR 22 2016

FORD N. FUCHIGAMI
DIRECTOR

Deputy Directors
JADE T. BUTAY
ROSS M. HIGASHI
EDWIN H. SNIFFEN
DARRELL T. YOUNG

IN REPLY REFER TO:

Board of Land and
Natural Resources
State of Hawaii
Honolulu, Hawaii

ISSUANCE OF A REVOCABLE PERMIT
FOR THE PURPOSE OF AIRLINE OPERATIONS
DELTA AIR LINES, INC.
HONOLULU INTERNATIONAL AIRPORT
TAX MAP KEY: (1) 1-1-003: 001 (PORTION)

OAHU

LEGAL REFERENCE:

Section 171-55, Hawaii Revised Statutes

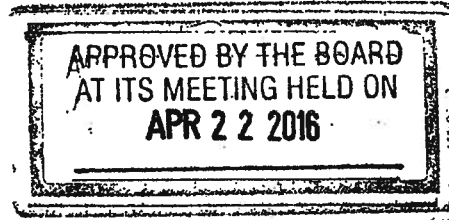

APPLICANT:

Delta Air Lines, Inc. (Delta), whose business address is 300 Rodgers Boulevard #68,
Honolulu, Hawaii 96819.

LOCATION:

Portion of Honolulu International Airport, Island of Oahu, State of Hawaii, identified by
Tax Map Key: 1st Division, 1-1-003: 001 (Portion).

AREA:

BLDG/ROOM	SQ.FT.	PURPOSE	EXHIBIT	RENT
341-227	4,989	AIRLINE LOUNGE	A	\$25,764.03
341-134A	114	BAGGAGE MAKE-UP	B-1	\$ 588.71
341-134B	869	BAGGAGE MAKE-UP	B-1	\$ 4,487.66
341-134F	64	BAGGAGE MAKE-UP	B-1	\$ 330.51
341-216A	900	CHECK-IN COUNTER	B-2	\$ 4,647.75
341-216B	3,351	AIRPORT TICKET OFFICE	B-2	\$17,305.12
341-216C	167	STORAGE	B-2	\$ 862.41
341-216E	158	STORAGE	B-2	\$ 815.94
341-217A	751	CHECK-IN COUNTER	B-2	\$ 3,878.29

ITEM M-3

BLNR – ISSUANCE OF A REVOCABLE PERMIT FOR AIRLINE OPERATIONS
 DELTA AIR LINES, INC.

Page 2

BLDG/ROOM	SQ.FT.	PURPOSE	EXHIBIT	RENT
341-217B	4,365	FA OFFICE	B-2	\$22,541.59
341-217C	126	STORAGE	B-2	\$ 650.68
341-217D	165	STORAGE	B-2	\$ 852.09
341-240C	58	CS HELP DESK	B-2	\$ 299.52
341-278	45	CURBSIDE CHECK-IN	B-2	\$ 232.39
341-259A	7	SELF-SERVICE KIOSKS	B-2	\$ 36.15
341-259B	19	SELF-SERVICE KIOSKS	B-2	\$ 98.12
341-259C	7	SELF-SERVICE KIOSKS	B-2	\$ 36.15
341-259D	23	SELF-SERVICE KIOSKS	B-2	\$ 118.77
341-B37	205	COMMUNICATION ROOM	B-3	\$ 1,058.65
346-107F	45	AIRLINES FIS COUNTER	C	\$ 232.39
350-136A	2,995	OFFICE	D-1	\$15,466.68
350-136C	1,371	MAINTENANCE DEPT	D-1	\$ 7,080.07
350-143A	5,277	OFFICE	D-1	\$27,251.31
350-143B	1,254	OFFICE	D-1	\$ 6,475.86
350-240	195	OFFICE	D-2	\$ 1,007.01
373-117A	1,908	CABIN CLEANERS OFFICE	E	\$ 9,853.23
373-118A	1,099	STORES	E	\$ 5,675.42
373-118D	2,038	STORES	E	\$10,524.57
612-115A-H, 612-115J, 612-115K-N, and 612-115R	2,621	EQUIPMENT PARKING	F	\$13,535.28
613-102A-H, 613-102J-M	4,246	COVERED PARKING	G	\$21,927.05
READ POINTS		RADIO FREQUENCY IDENTIFICATION DEVICES (RFID's)		
1-7			H-1	\$ 175.00
8-12			H-2	\$ 125.00
13-17			H-3	\$ 125.00

ZONING:

State Land Use District: Urban
 City and County of Honolulu LUO: Industrial (I-2)

BLNR – ISSUANCE OF A REVOCABLE PERMIT FOR AIRLINE OPERATIONS
DELTA AIR LINES, INC.
Page 3

LAND TITLE STATUS:

Non-ceded - Section 5(a) lands of the Hawaii Admission Act
DHHL 30% entitlement lands pursuant to Hawaii Admission Act YES ___ NO X

CURRENT USE STATUS:

Land presently encumbered by Governor's Executive Order No. 3201, dated June 8, 1983, setting aside 3,152.177 acres designated as Honolulu International Airport under the control and management of the State of Hawaii, Department of Transportation, Airports Division (DOTA) for Airport Purposes.

CHARACTER OF USE:

Delta will use various terminal spaces, for the use and maintenance of: (1) an airline lounge; (2) baggage service operations (office, storage); (3) lobby operations (check-in counters, kiosks, and offices); (4) maintenance offices (cabin cleaners, stores); (5) equipment and automobile parking; and, (6) RFID's, hereinafter referred to as airline operations at Honolulu International Airport.

COMMENCEMENT DATE:

Upon execution of the revocable permit

MONTHLY RENTAL:

\$204,058.40 (based upon a rate of \$61.97 per square foot, per annum, as published in the DOTA Signatory Carrier Rates and Charges, Hawaii Airports System, Effective July 1, 2015).

SECURITY DEPOSIT:

Three (3) times the monthly rental in effect.

HOLDOVER TENANCY:

\$6,801.95

DCCA VERIFICATION:

Place of business registration confirmed:	YES <u>X</u>	NO ___
Registered business name confirmed:	YES <u>X</u>	NO ___
Good standing confirmed:	YES <u>X</u>	NO ___

CHAPTER 343, HRS - ENVIRONMENTAL ASSESSMENT:

Pursuant to Section 11-200-8(a), Environmental Impact Statement Rules of the Department of Health, State of Hawaii, this disposition is exempt from requirements regarding preparation of an environmental assessment, negative declaration, or environmental impact statement as required by Chapter 343, Hawaii Revised Statutes, as amended, relating to Environmental Impact Statements, because the proposed action falls within Exemption Class #1, Comprehensive Exemption List for the State of Hawaii, Department of Transportation, dated November 15, 2000, as approved by the Environmental Quality Council. Exemption Class #1 covers operations, repairs, or maintenance of existing structures, facilities, equipment, or topographical features involving negligible or no expansion or change of use beyond that previously existing.

REMARKS:

Delta has requested to consolidate all airport terminal spaces under existing revocable permits and parking permits into one month-to-month revocable permit, for their airline operations at Honolulu International Airport. The Department of Transportation (DOT) has no objection to Delta's request.

In accordance with Sections 171-55, relating to Permits, the DOT proposes to issue a month-to-month revocable permit to Delta for their Airline Operations.

RECOMMENDATION:

That the Board authorize the Department of Transportation to issue a month-to-month revocable permit to Delta Air Lines, Inc. subject to: (1) terms and conditions herein outlined, which are by reference incorporated herein; and (2) such additional terms and conditions as may be prescribed by the Director of Transportation to best serve the interests of the State.

Respectfully submitted,



FORD N. FUCHIGAMI
Director of Transportation

APPROVED FOR SUBMITTAL:



SUZANNE D. CASE
Chairperson and Member

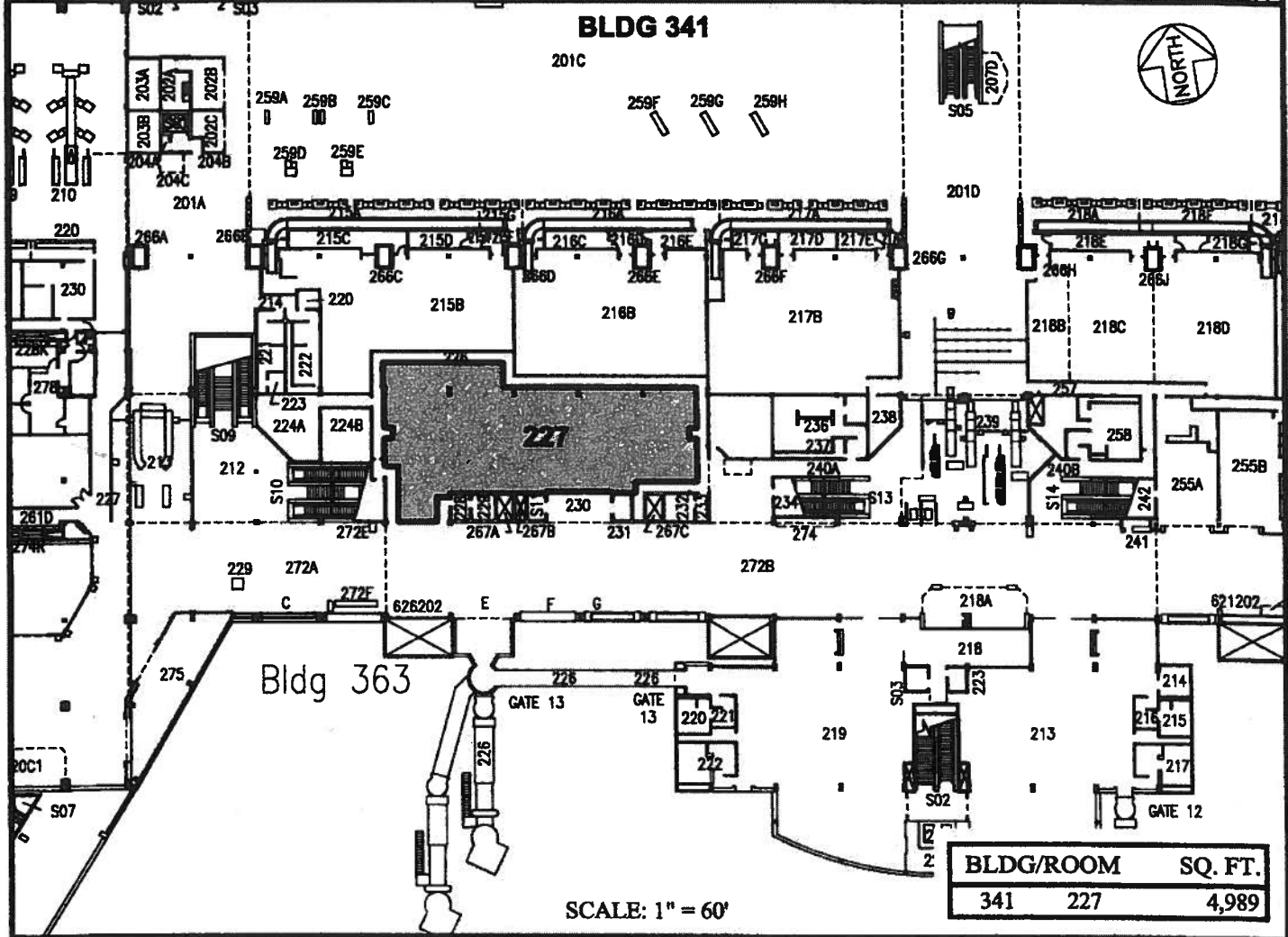
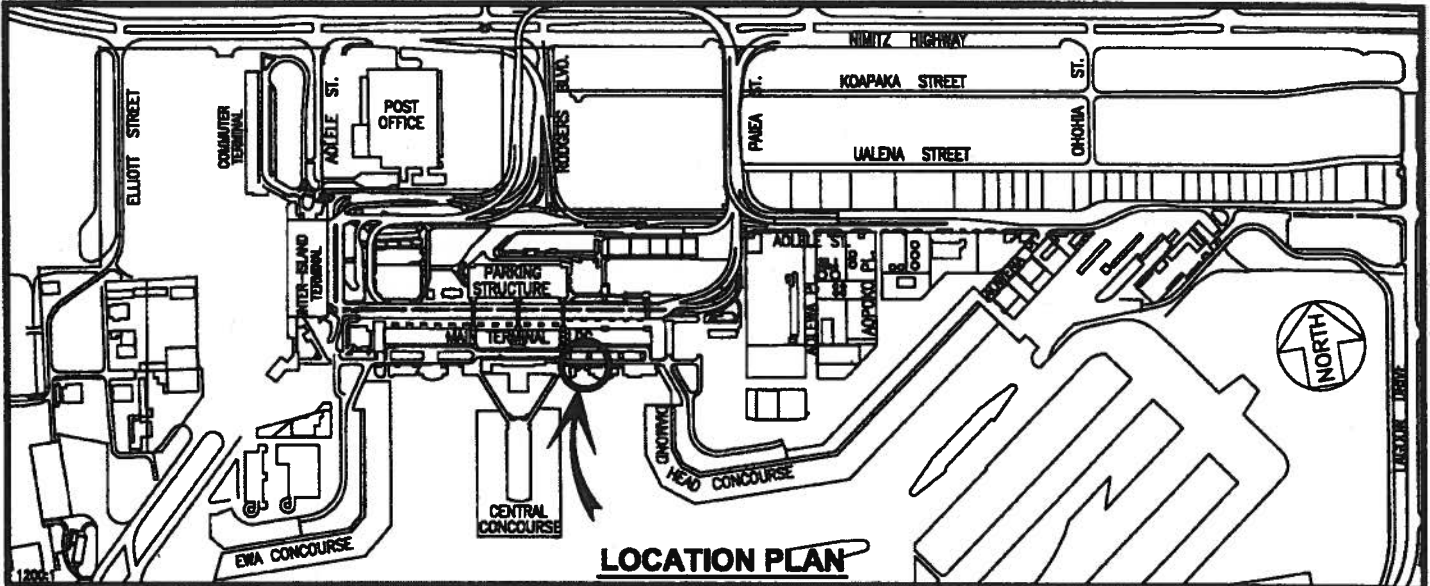

BLDG/ROOM	SQ. FT.
341 227	4,989

SCALE: 1" = 60'

DATE : MARCH 2016

EXHIBIT: **A**



DELTA AIR LINES, INC.

**BUILDING 341
DIAMOND HEAD EXTN.
SECOND LEVEL**

**341227
PLAT A2**

N:\AIRPORTS\HNL_HONOLULU\CAD\PIA\HNL_341227-01.DWG

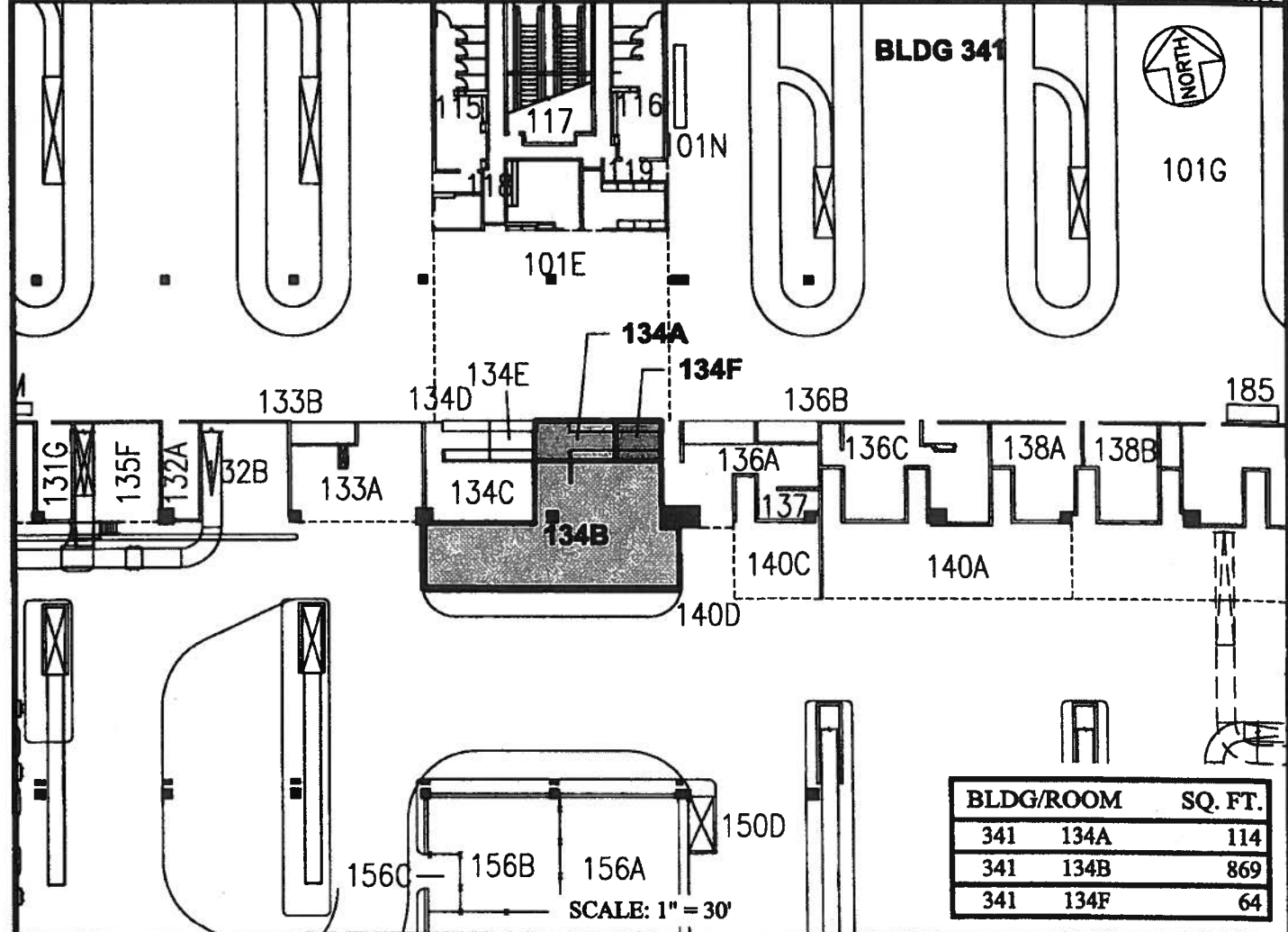
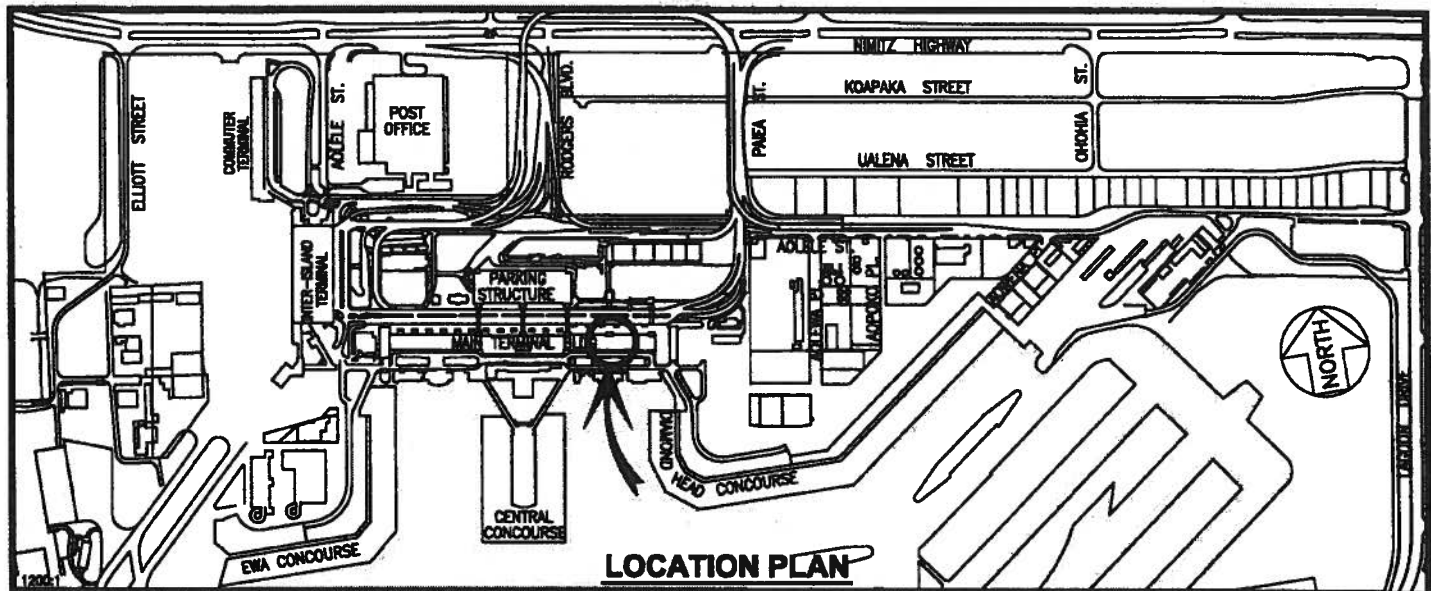

DATE : MARCH 2016

EXHIBIT: **B-1**



Airports Division

DELTA AIR LINES, INC.

**BUILDING 341
DIAMOND HEAD EXTN.
GROUND LEVEL**

341134A
341134B
341134F
PLAT A1

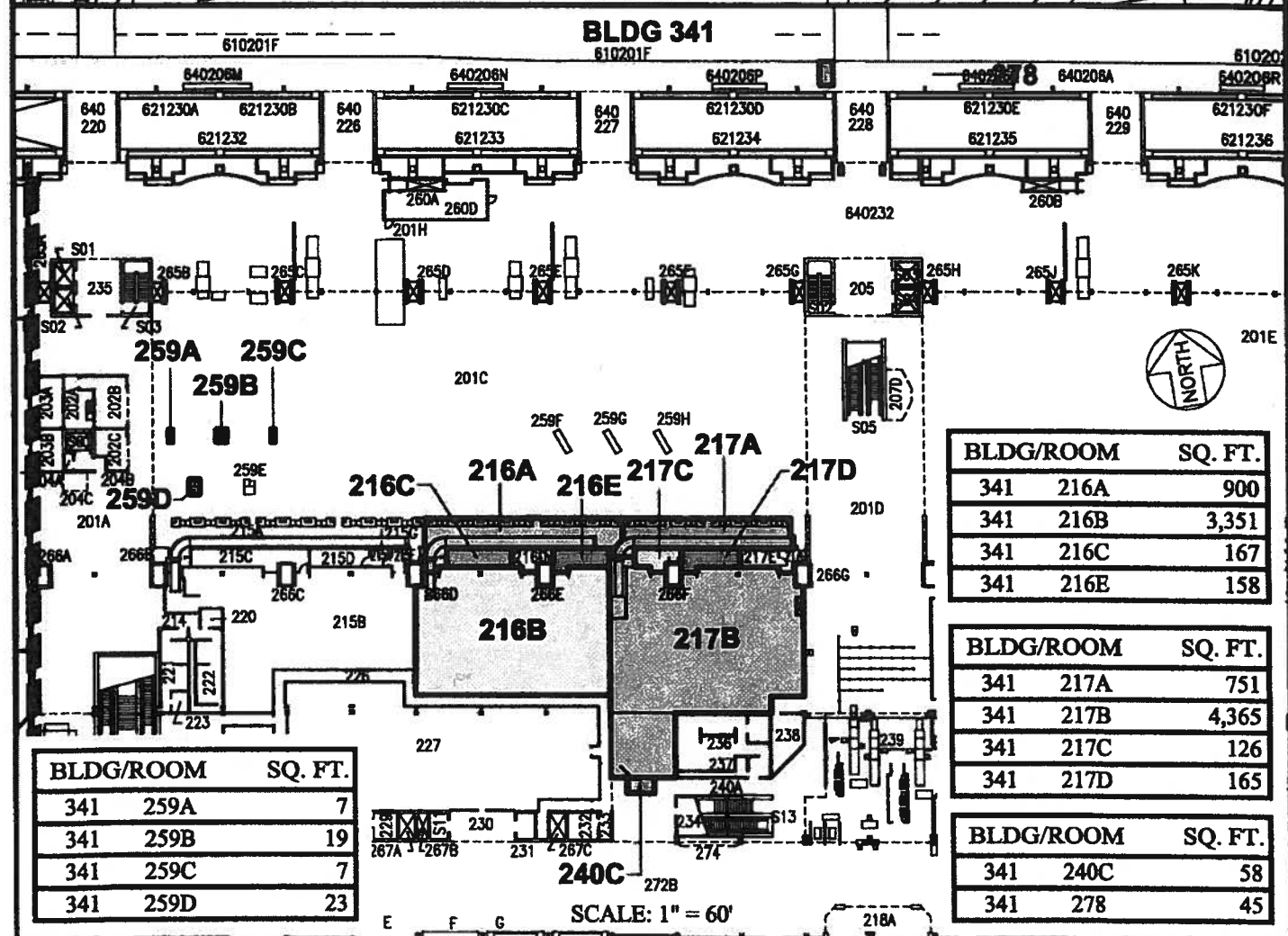
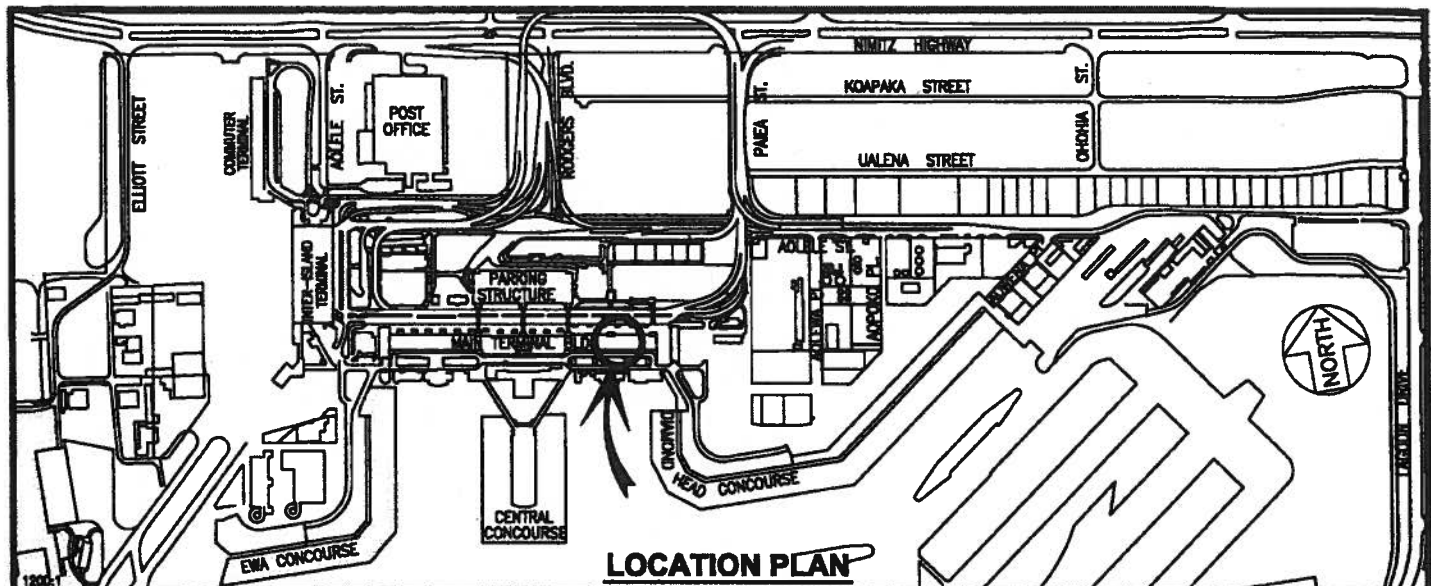

BLDG/ROOM	SQ. FT.
341 216A	900
341 216B	3,351
341 216C	167
341 216E	158

BLDG/ROOM	SQ. FT.
341 217A	751
341 217B	4,365
341 217C	126
341 217D	165

BLDG/ROOM	SQ. FT.
341 259A	7
341 259B	19
341 259C	7
341 259D	23

BLDG/ROOM	SQ. FT.
341 240C	58
341 278	45

SCALE: 1" = 60'

DATE : MARCH 2016

EXHIBIT: B-2



DELTA AIR LINES, INC.

BUILDING 341
DIAMOND HEAD EXTN.
SECOND LEVEL

341216A-341278
PLAT A2

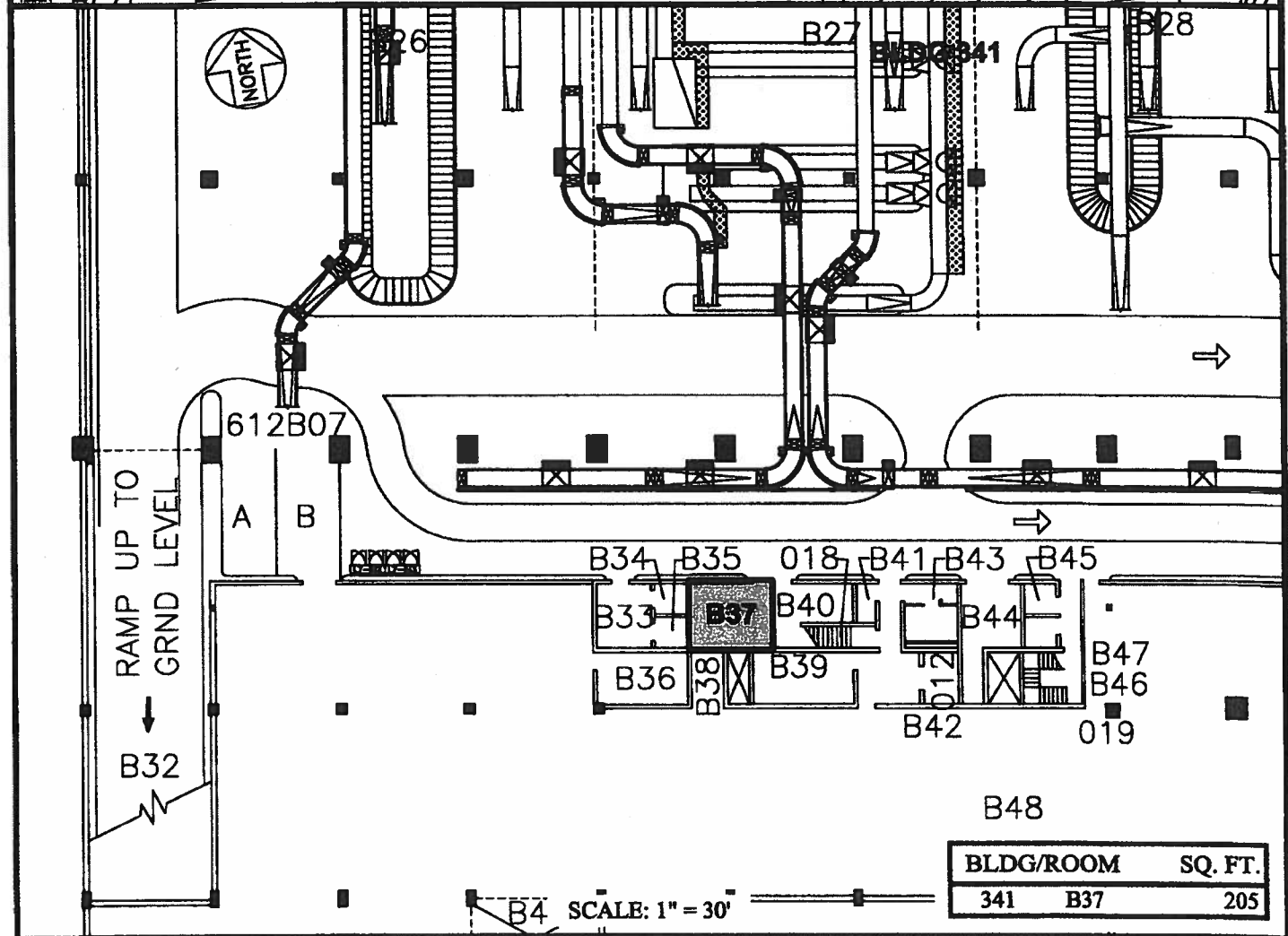
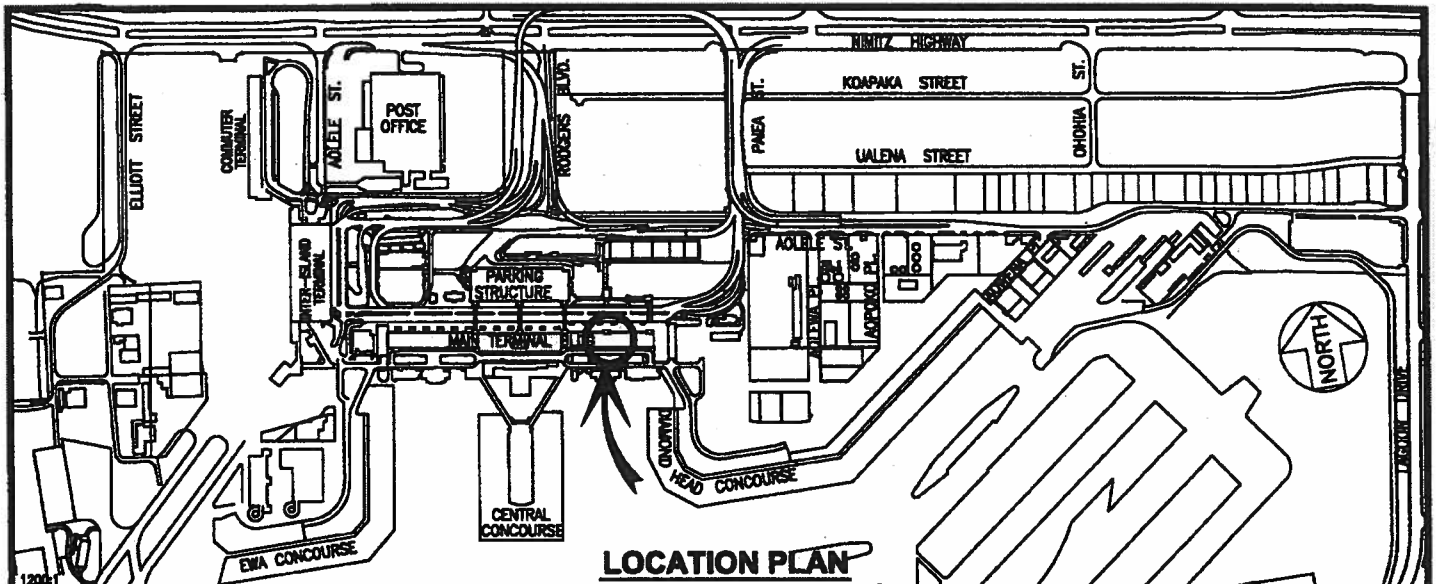

DATE : MARCH 2016

EXHIBIT: **B-3**



Airports Division

DELTA AIR LINES, INC.

**BUILDING 341
DIAMOND HEAD EXTN.
BASEMENT LEVEL**

341B37

PLAT AB

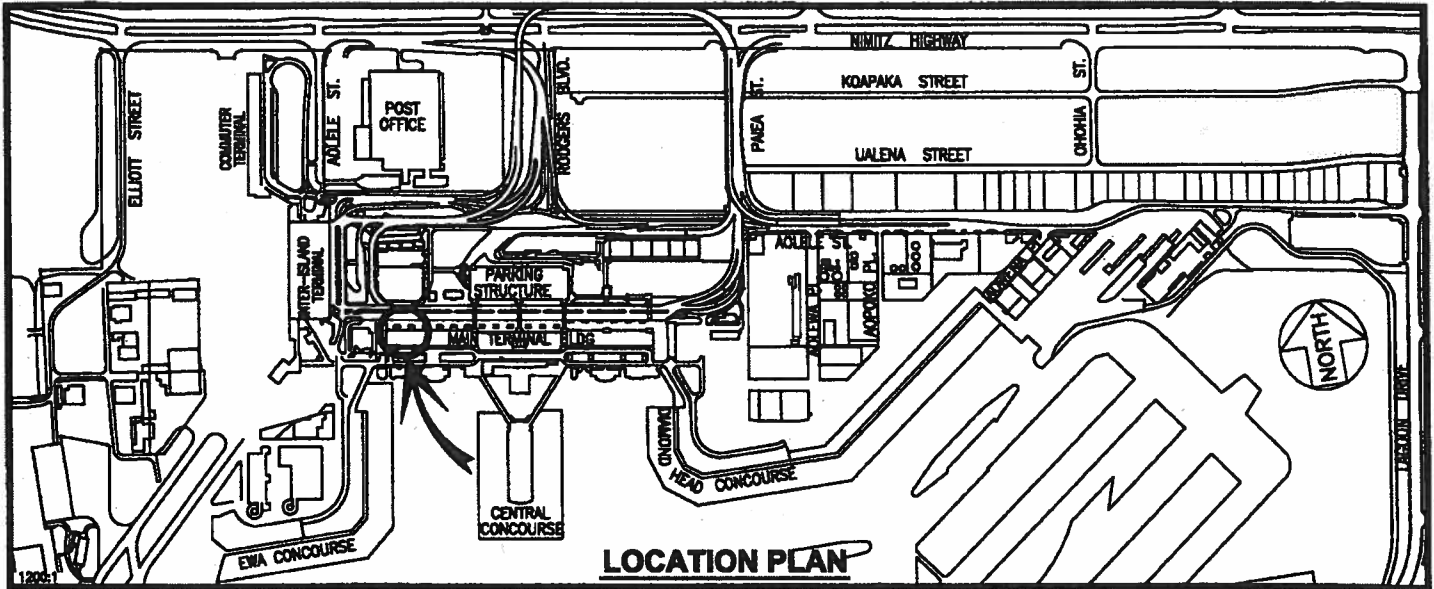

BLDG 346

0193A

610193B

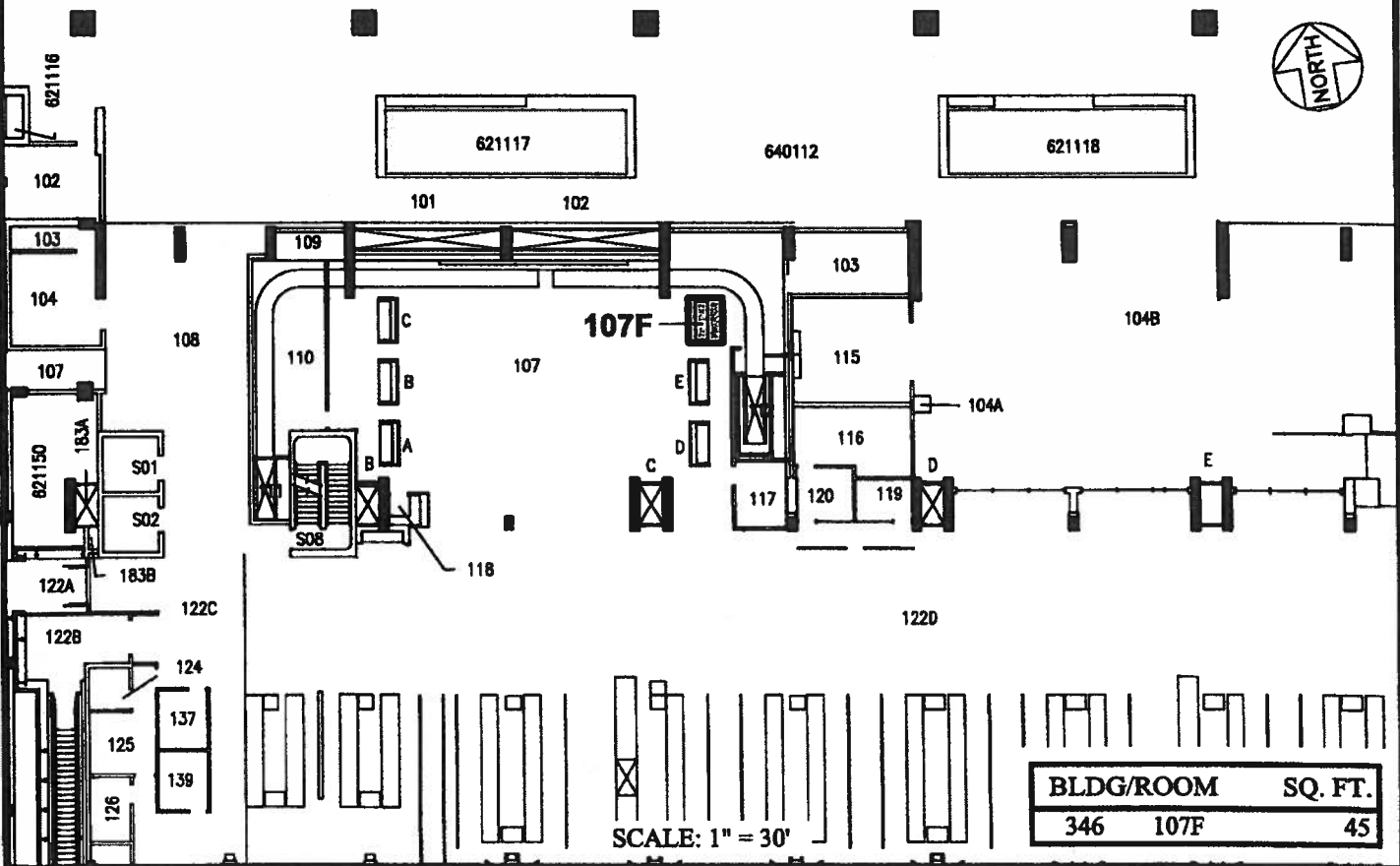

DATE : MARCH 2016

EXHIBIT: **C**



Airports Division

DELTA AIR LINES, INC.

**BUILDING 346
INT'L ARRIVAL BUILDING
GROUND LEVEL**

346107F

PLAT A1

HONOLULU INTERNATIONAL AIRPORT

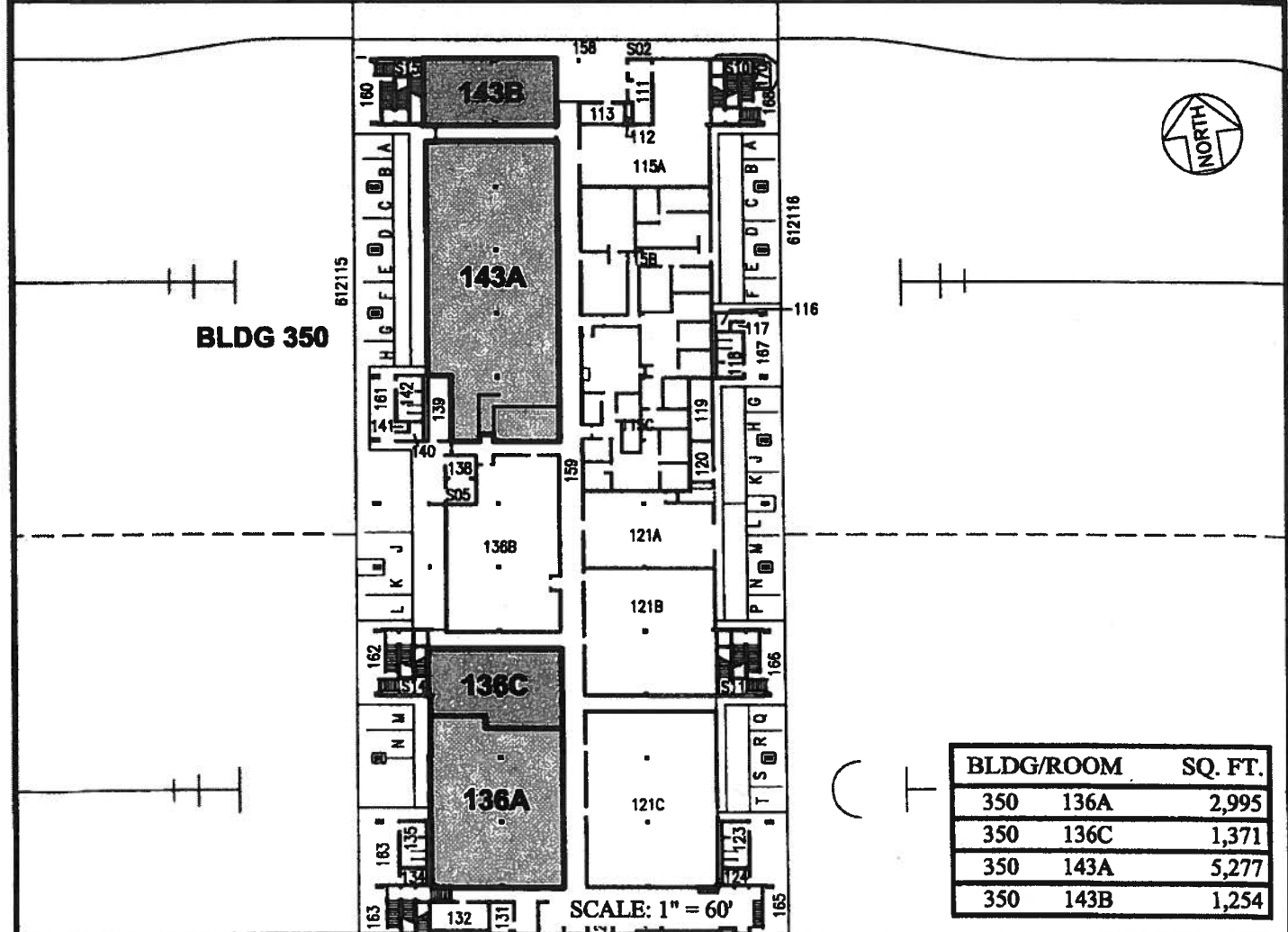
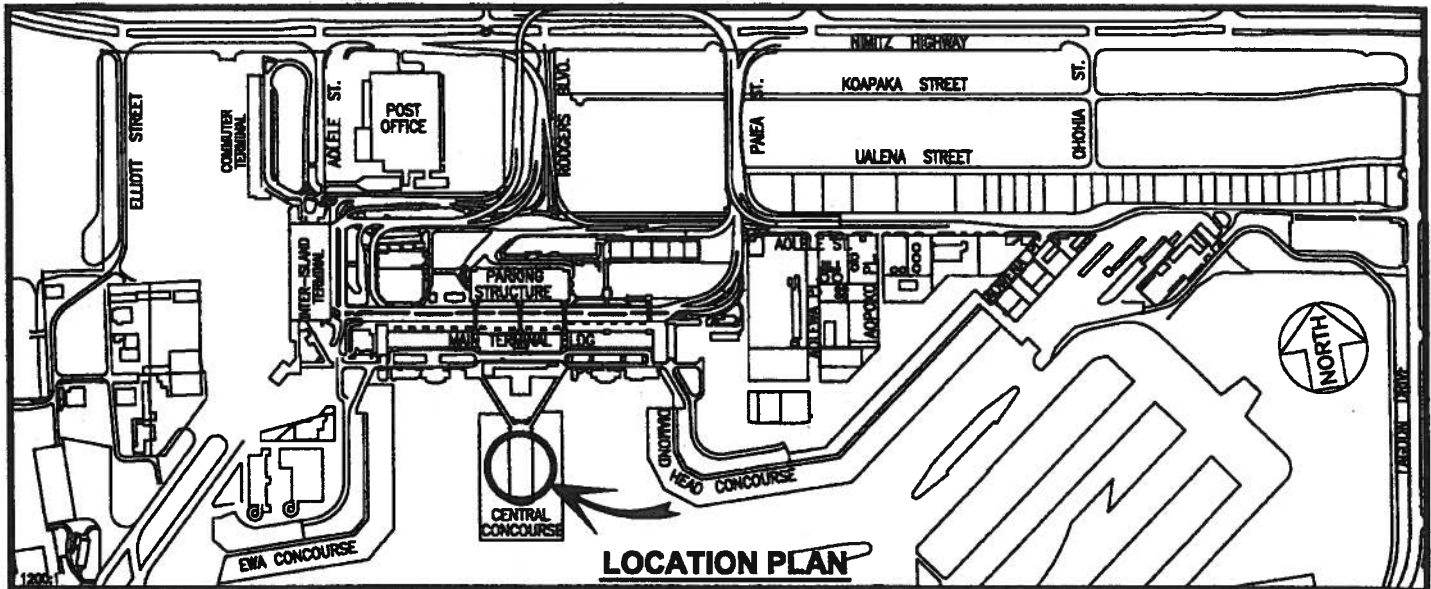

BLDG/ROOM	SQ. FT.
350 136A	2,995
350 136C	1,371
350 143A	5,277
350 143B	1,254

DATE : MARCH 2016

EXHIBIT: **D-1**



Airports Division

DELTA AIR LINES, INC.

**BUILDING 350
CENTRAL CONCOURSE
GROUND LEVEL**

**350136A,C
350143A,B**

PLAT A1

HONOLULU INTERNATIONAL AIRPORT

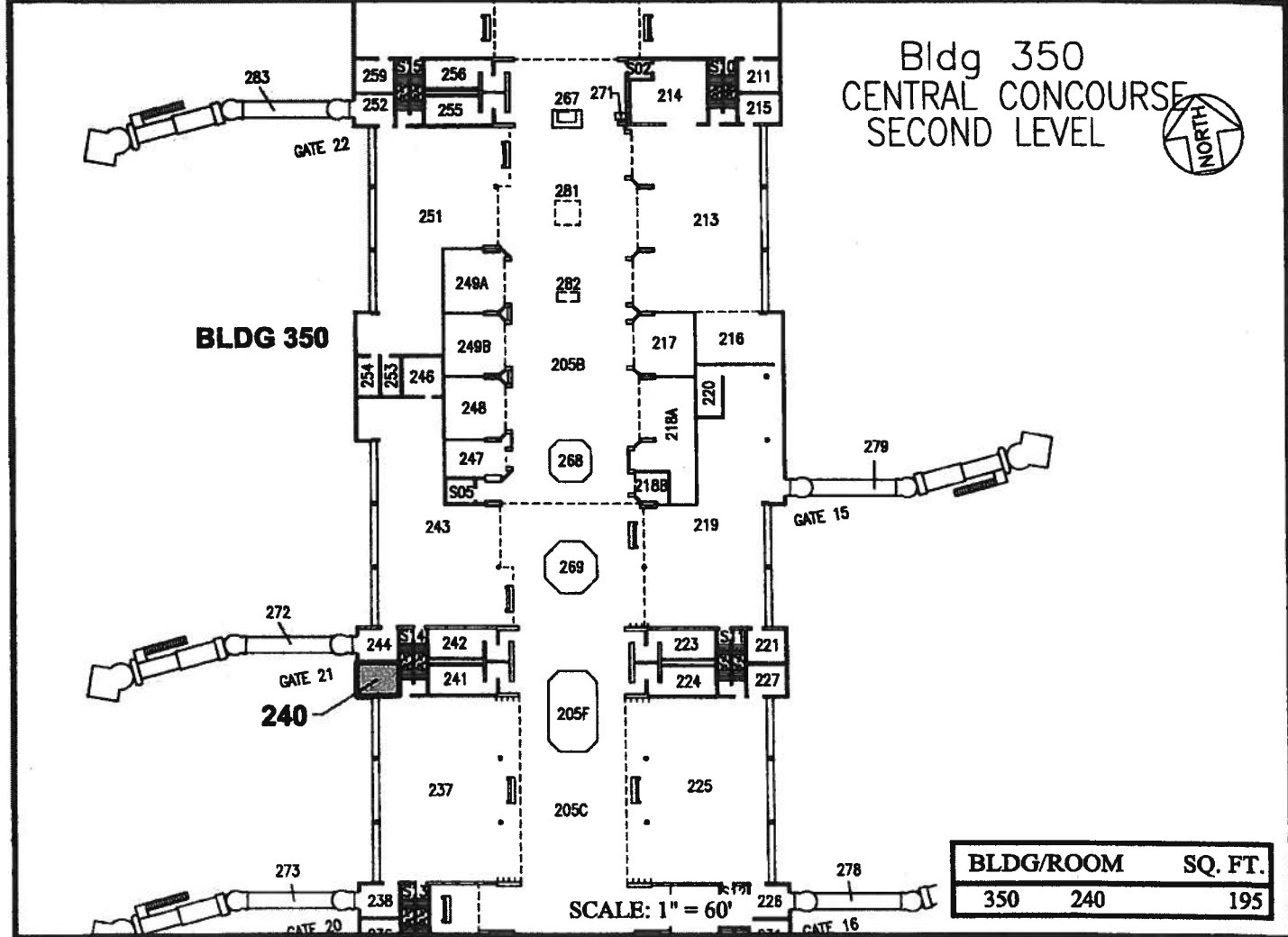
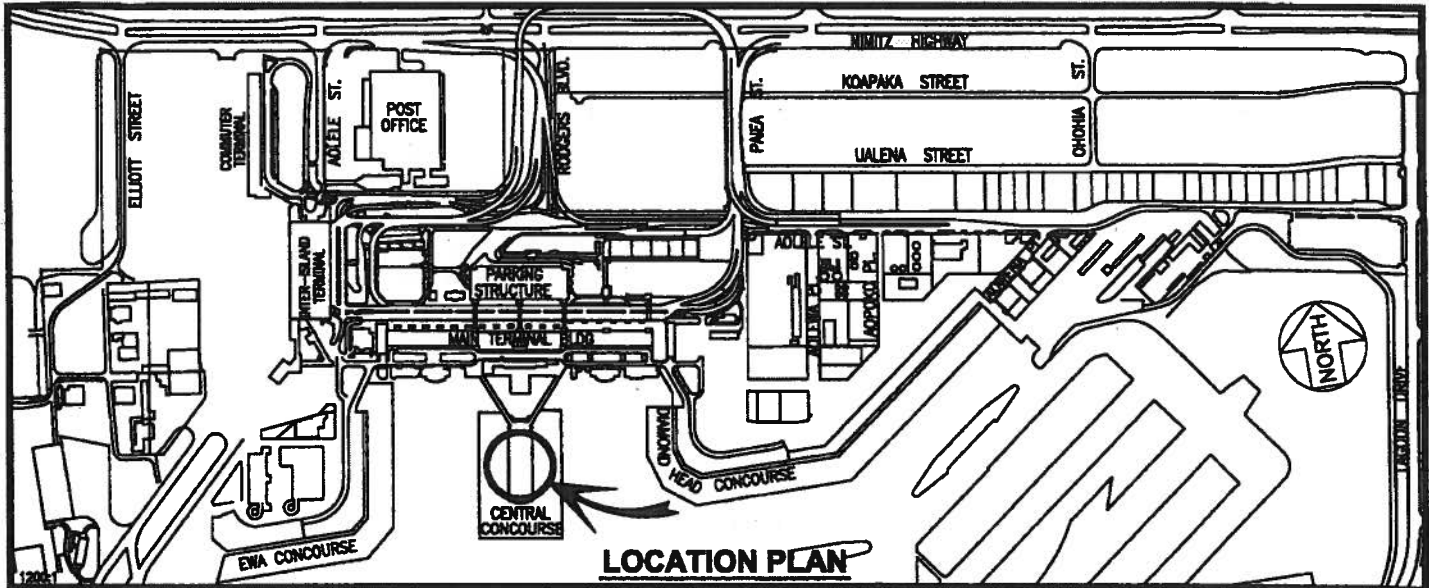

DATE : MARCH 2016

EXHIBIT: D-2



Airports Division

DELTA AIR LINES, INC.

BUILDING 350
CENTRAL CONCOURSE
SECOND LEVEL

350240

PLAT A2

HONOLULU INTERNATIONAL AIRPORT

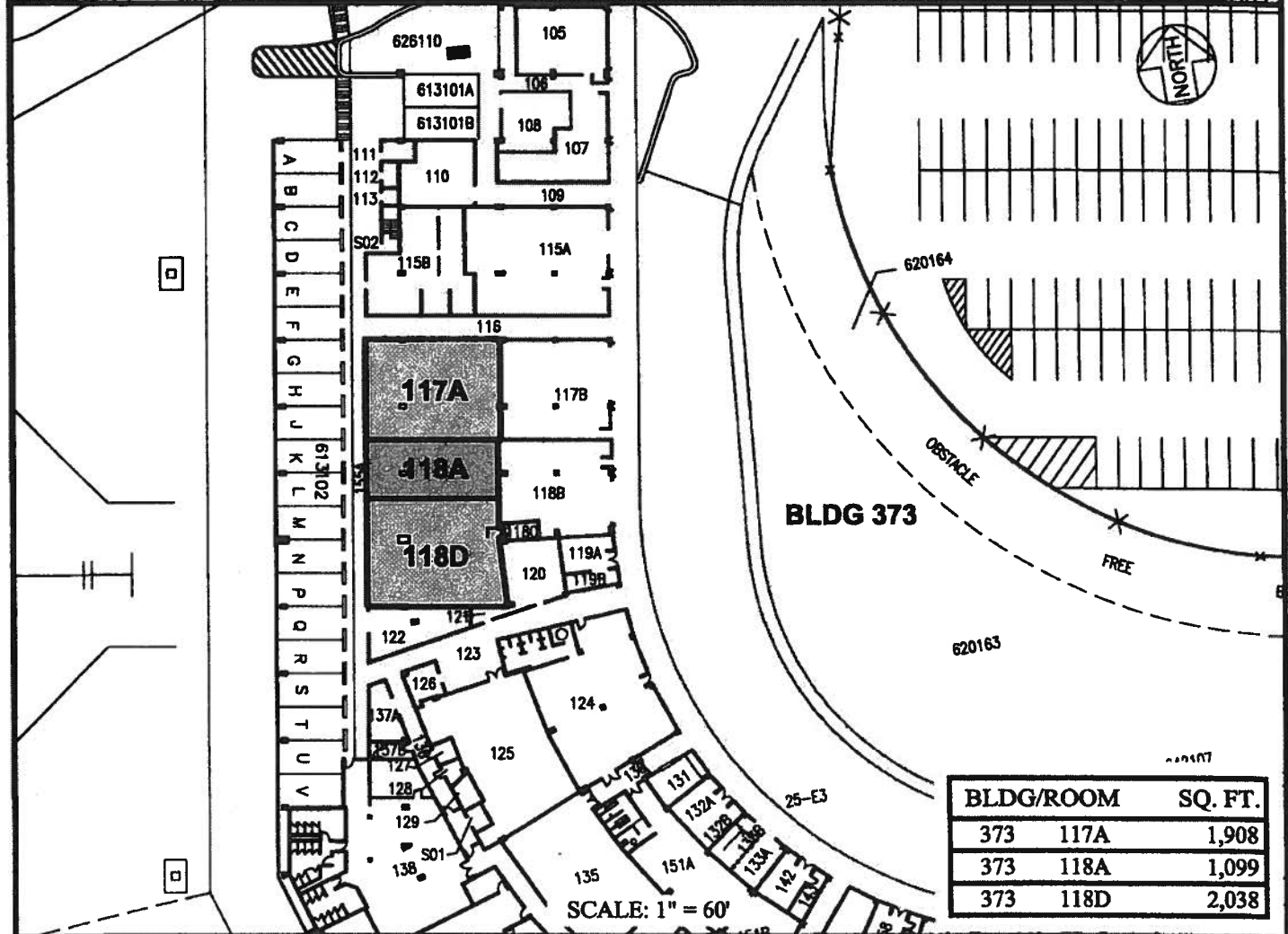
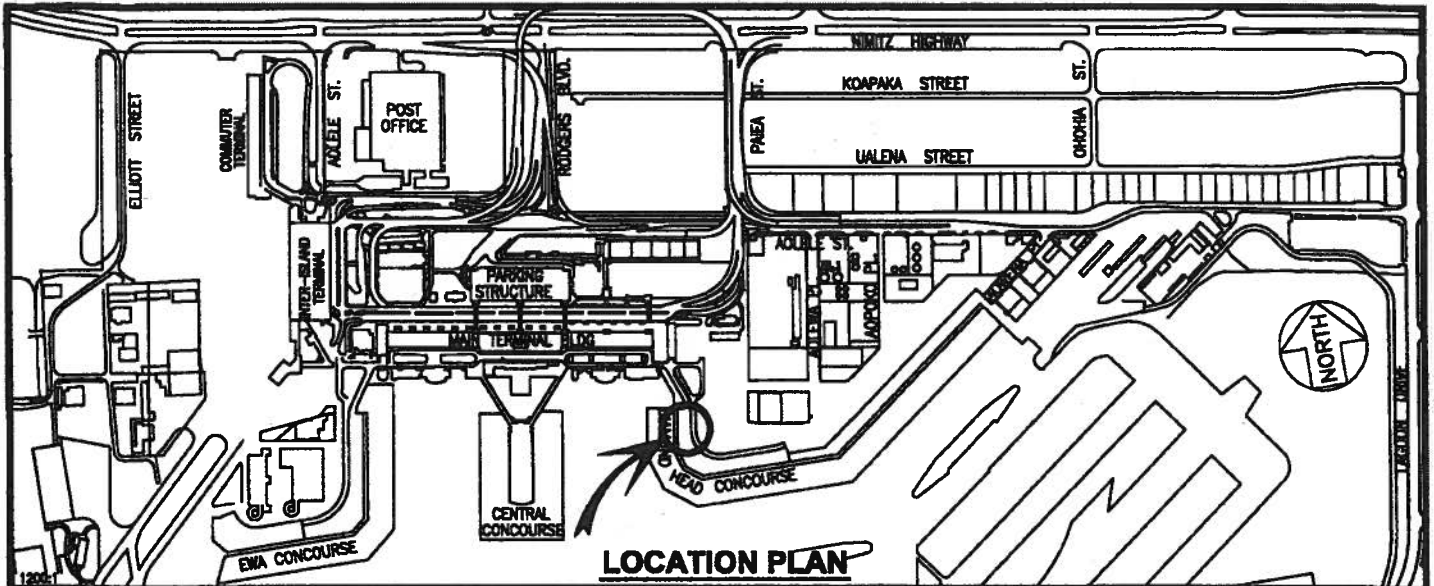

DATE : MARCH 2016

EXHIBIT: **E**



Airports Division

DELTA AIR LINES, INC.

**BUILDING 373
DIAMOND HEAD CONCOURSE
GROUND LEVEL**

341117A
341118A,D

PLAT A1

HONOLULU INTERNATIONAL AIRPORT

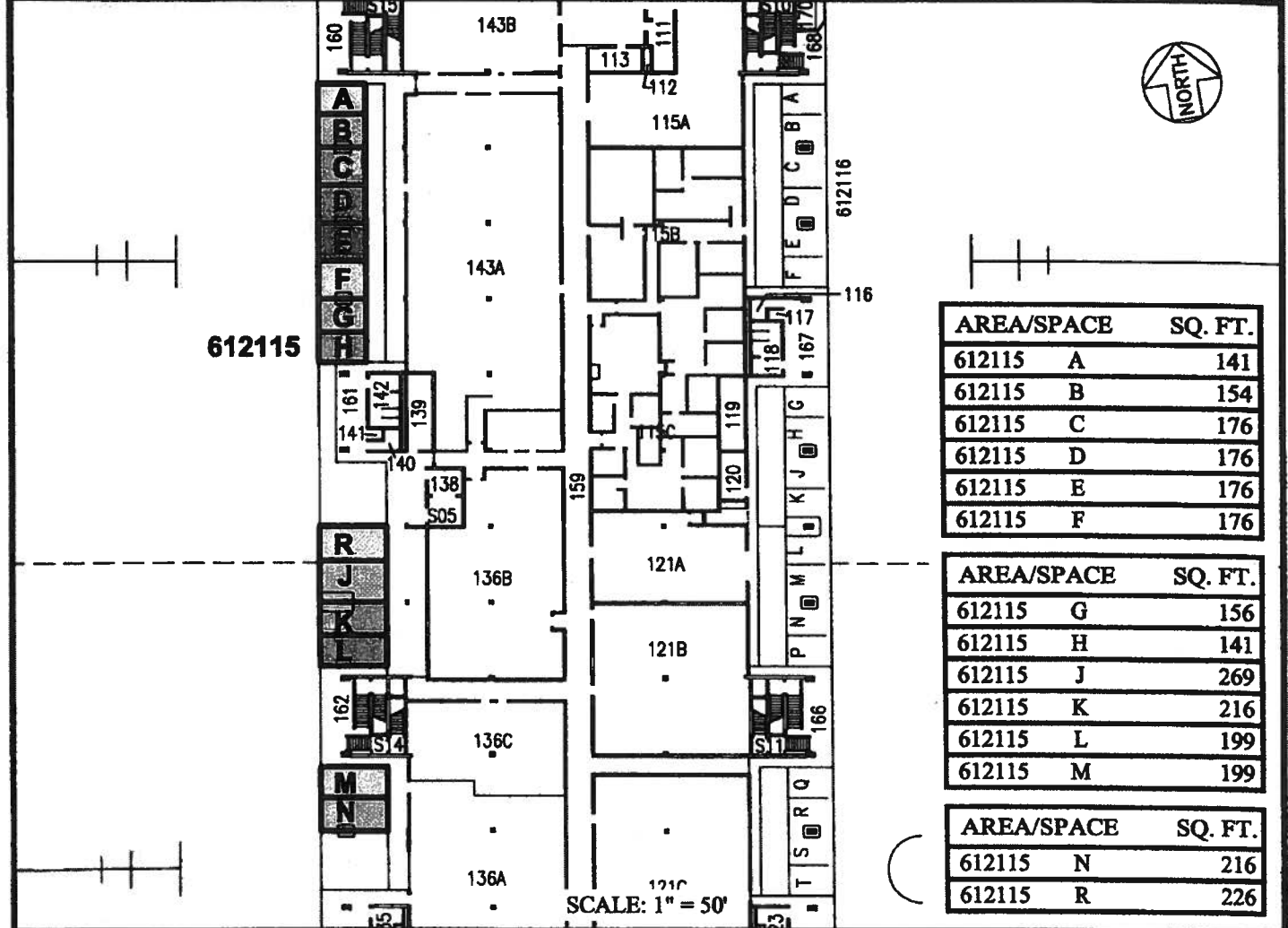
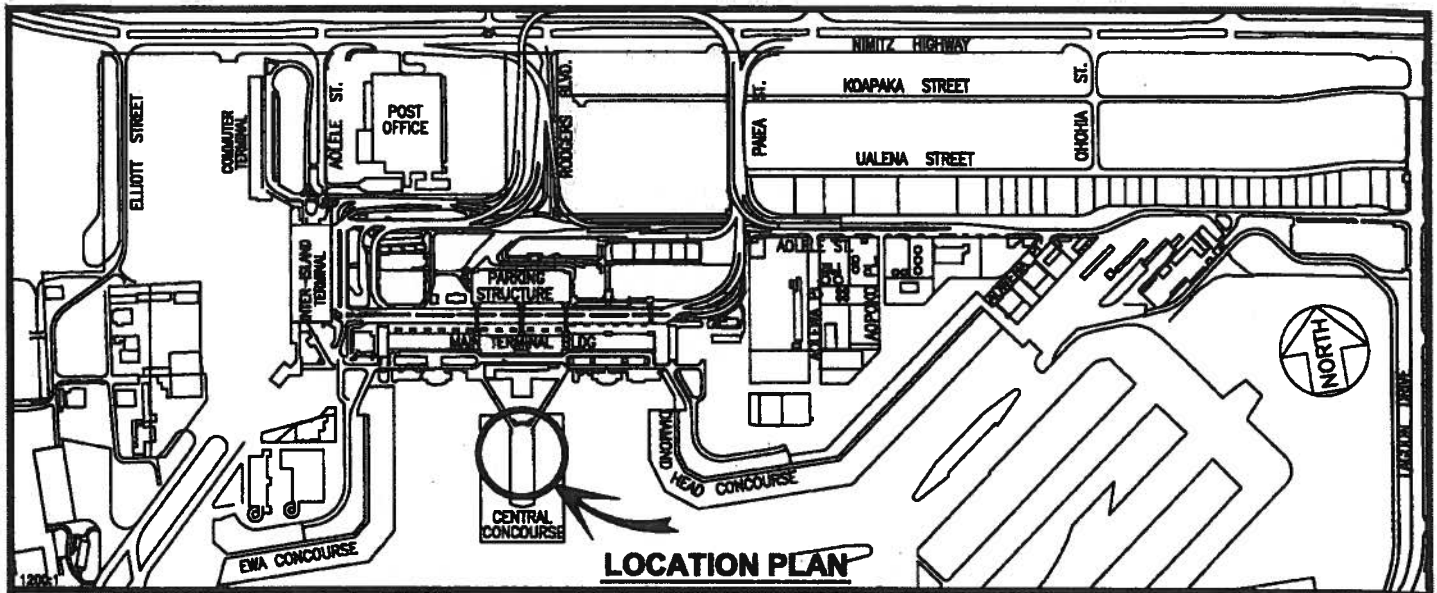

AREA/SPACE	SQ. FT.
612115 A	141
612115 B	154
612115 C	176
612115 D	176
612115 E	176
612115 F	176

AREA/SPACE	SQ. FT.
612115 G	156
612115 H	141
612115 J	269
612115 K	216
612115 L	199
612115 M	199

AREA/SPACE	SQ. FT.
612115 N	216
612115 R	226

DATE : MARCH 2016 EXHIBIT: F



DELTA AIR LINES, INC.

PARKING FACILITIES
OPERATIONAL RAMP AREAS
GROUND LEVEL

612115A-F
612115G-M
612115N,R
PLAT A1

HONOLULU INTERNATIONAL AIRPORT

N:\AIRPORTS\HNL_HONOLULU\CAD\PM\HNL_612115A-01.DWG

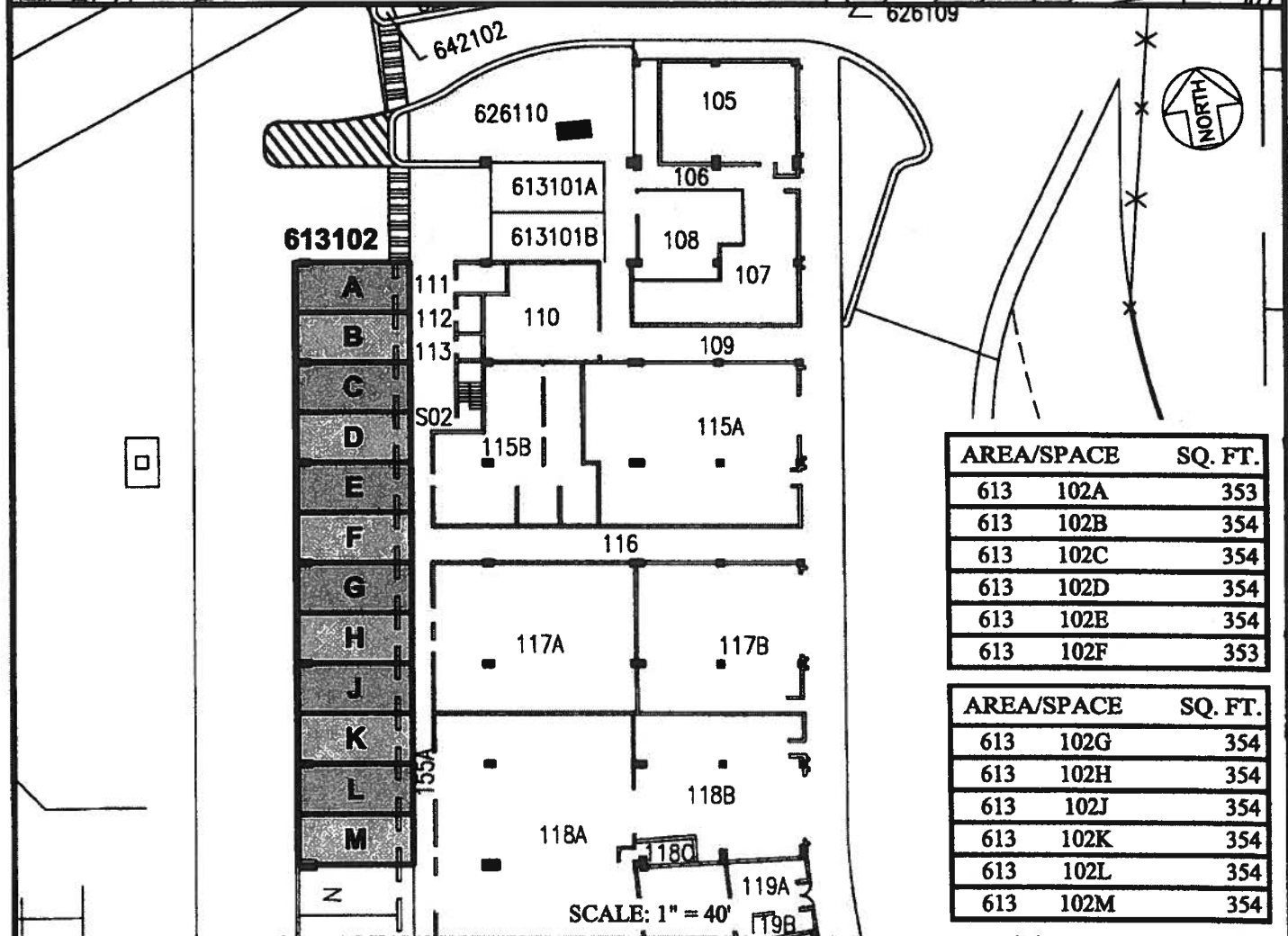
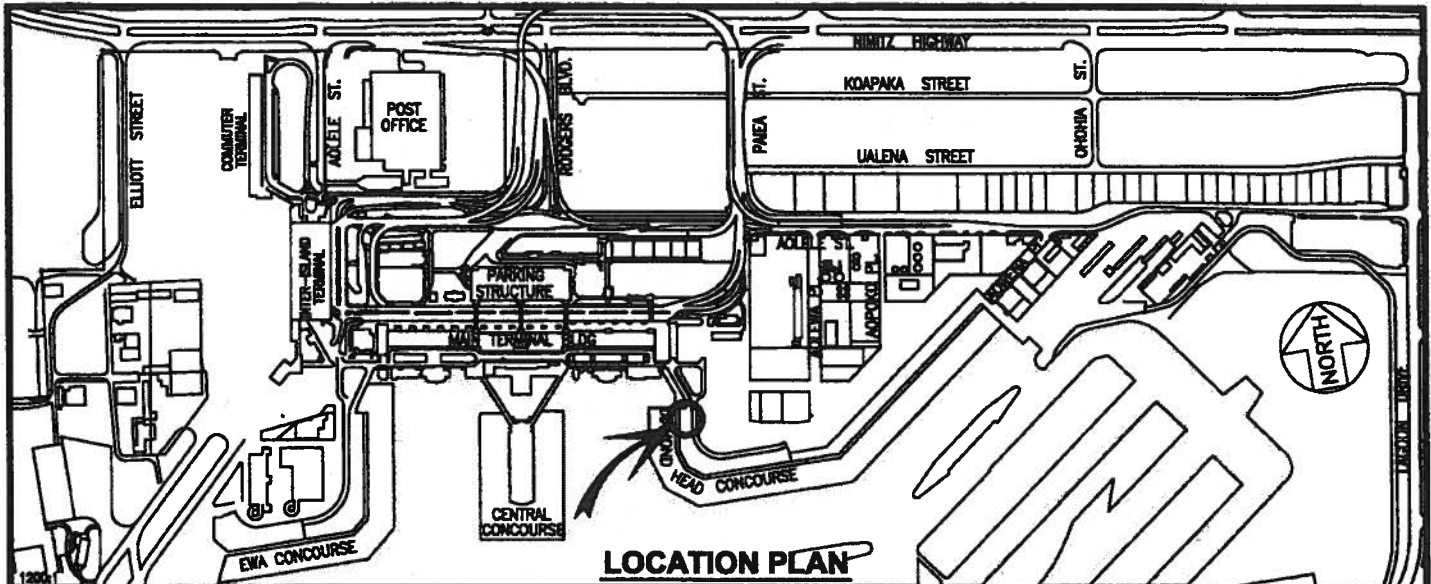

AREA/SPACE	SQ. FT.
613 102A	353
613 102B	354
613 102C	354
613 102D	354
613 102E	354
613 102F	353

AREA/SPACE	SQ. FT.
613 102G	354
613 102H	354
613 102J	354
613 102K	354
613 102L	354
613 102M	354

DATE : MARCH 2016

EXHIBIT: **G**



DELTA AIR LINES, INC.

**PARKING FACILITIES
DIAMOND HEAD CONCOURSE
GROUND LEVEL**

**613102A-H
613102J
613102K-M
PLAT M1**

HONOLULU INTERNATIONAL AIRPORT

N:\AIRPORTS\HNL_HONOLULU\CAD\PM\HNL_613102A-01.DWG

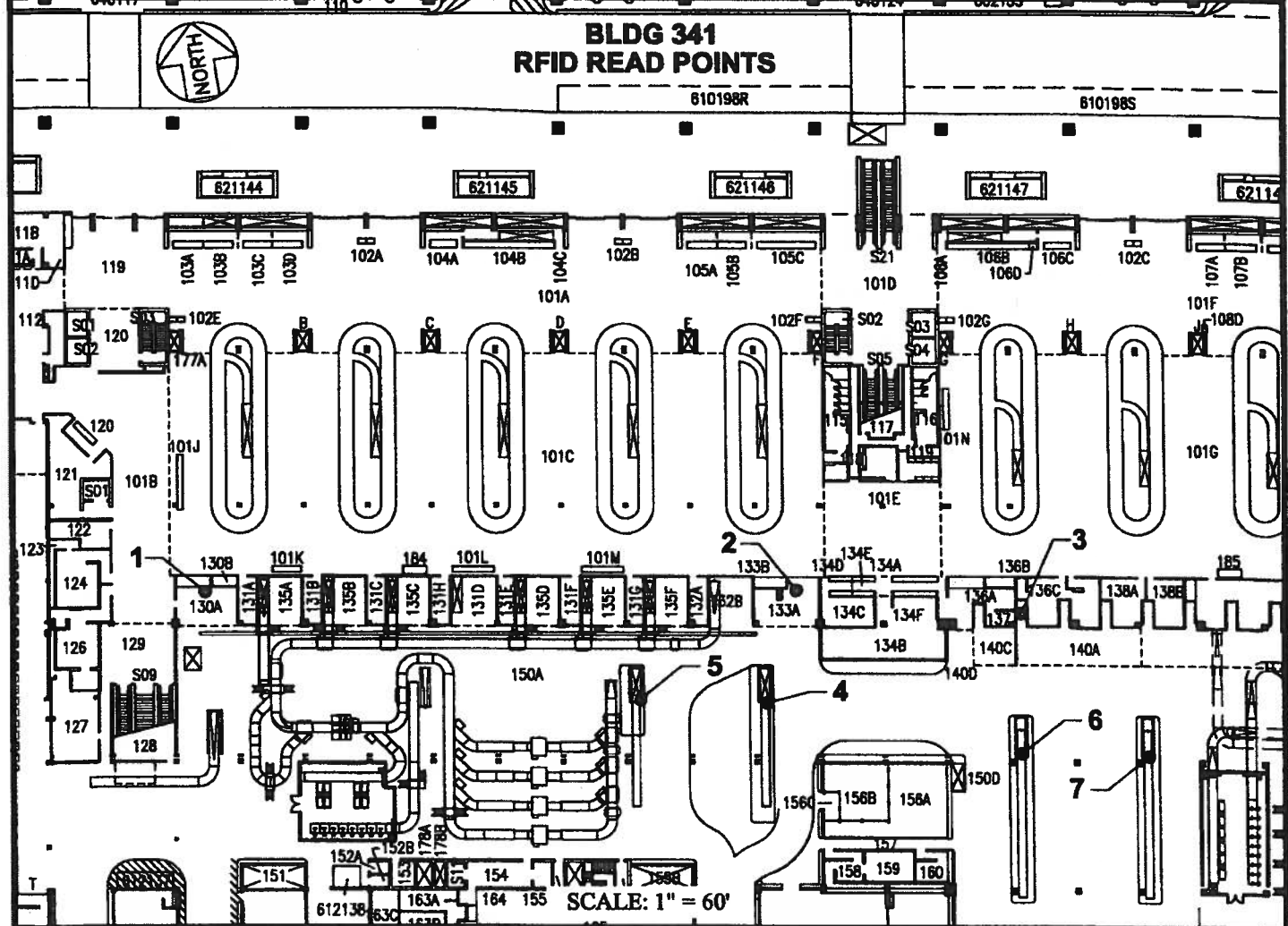
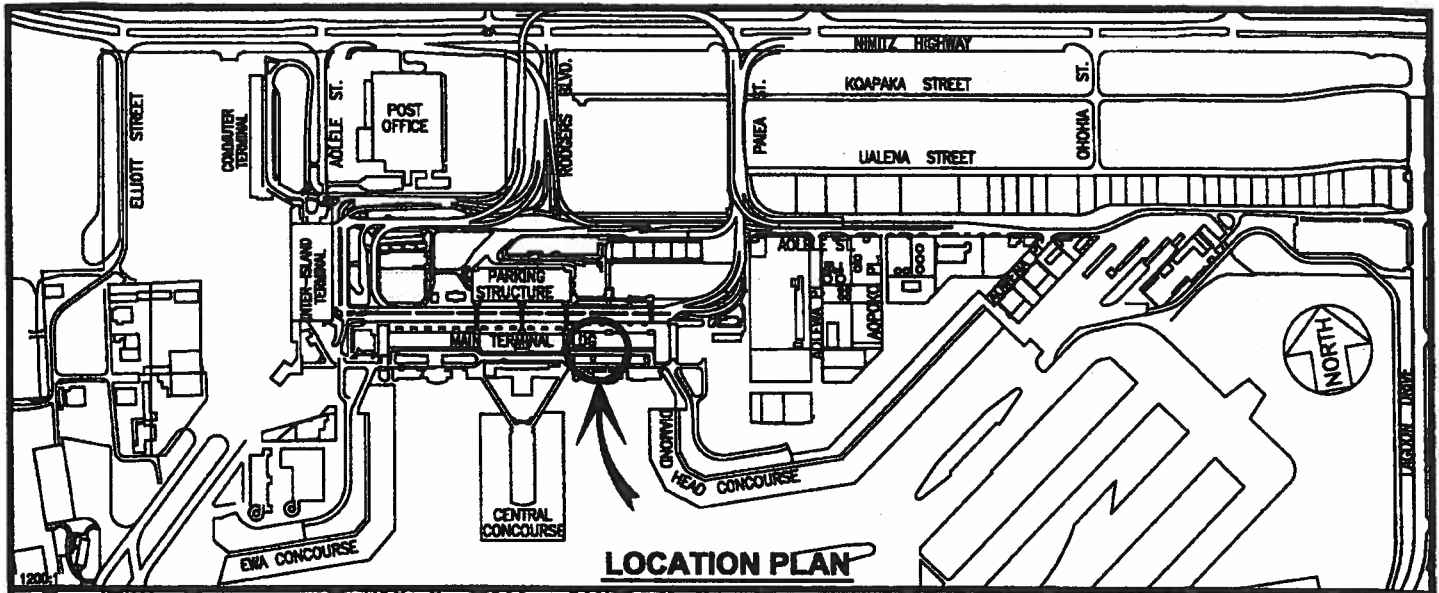

DATE : MARCH 2016

EXHIBIT: H-1



Airports Division

DELTA AIR LINES, INC.

**BUILDING 341
DIAMOND HEAD DOMESTIC
GROUND LEVEL**

**READ
POINTS
1-7
PLAT A1**

HONOLULU INTERNATIONAL AIRPORT

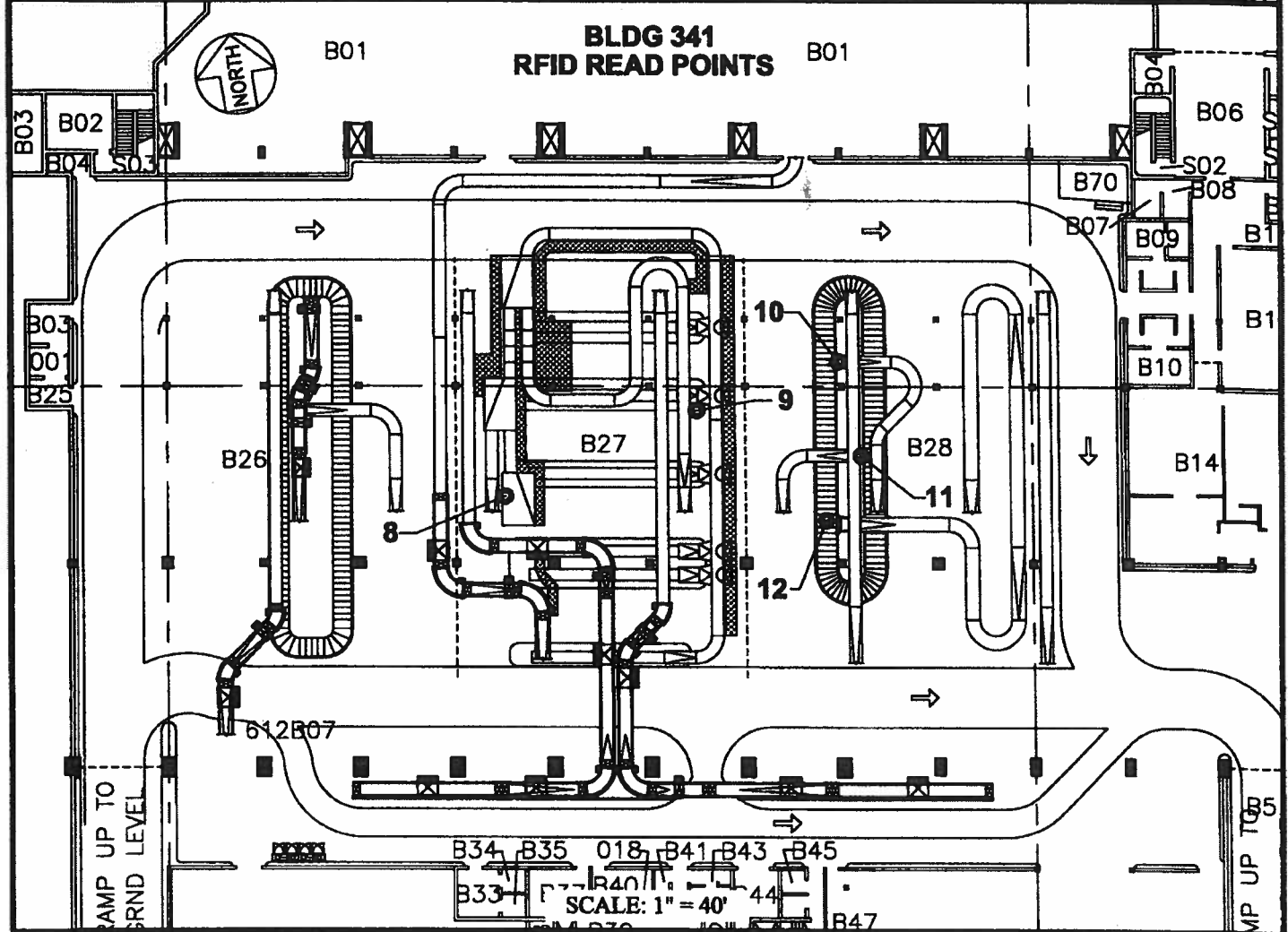
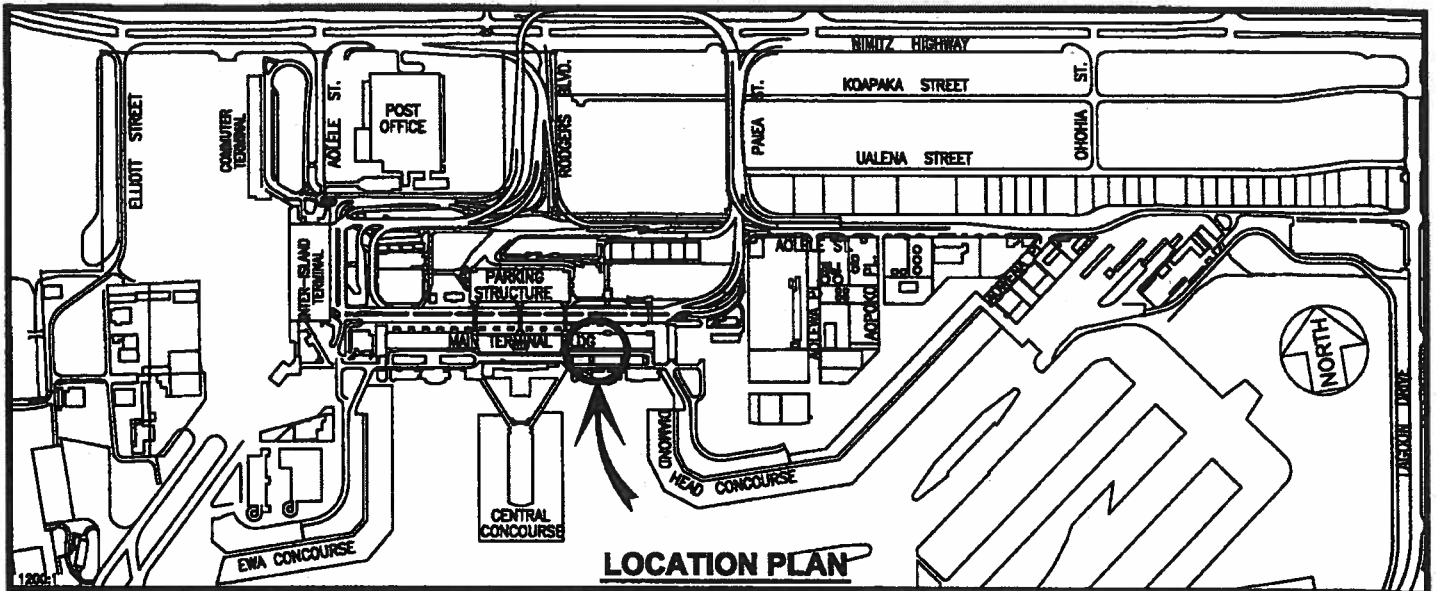

DATE : MARCH 2016

EXHIBIT: **H-2**



DELTA AIR LINES, INC.

**BUILDING 341
DIAMOND HEAD DOMESTIC
BASEMENT LEVEL**

**READ
POINTS
8-12
PLAT AB**

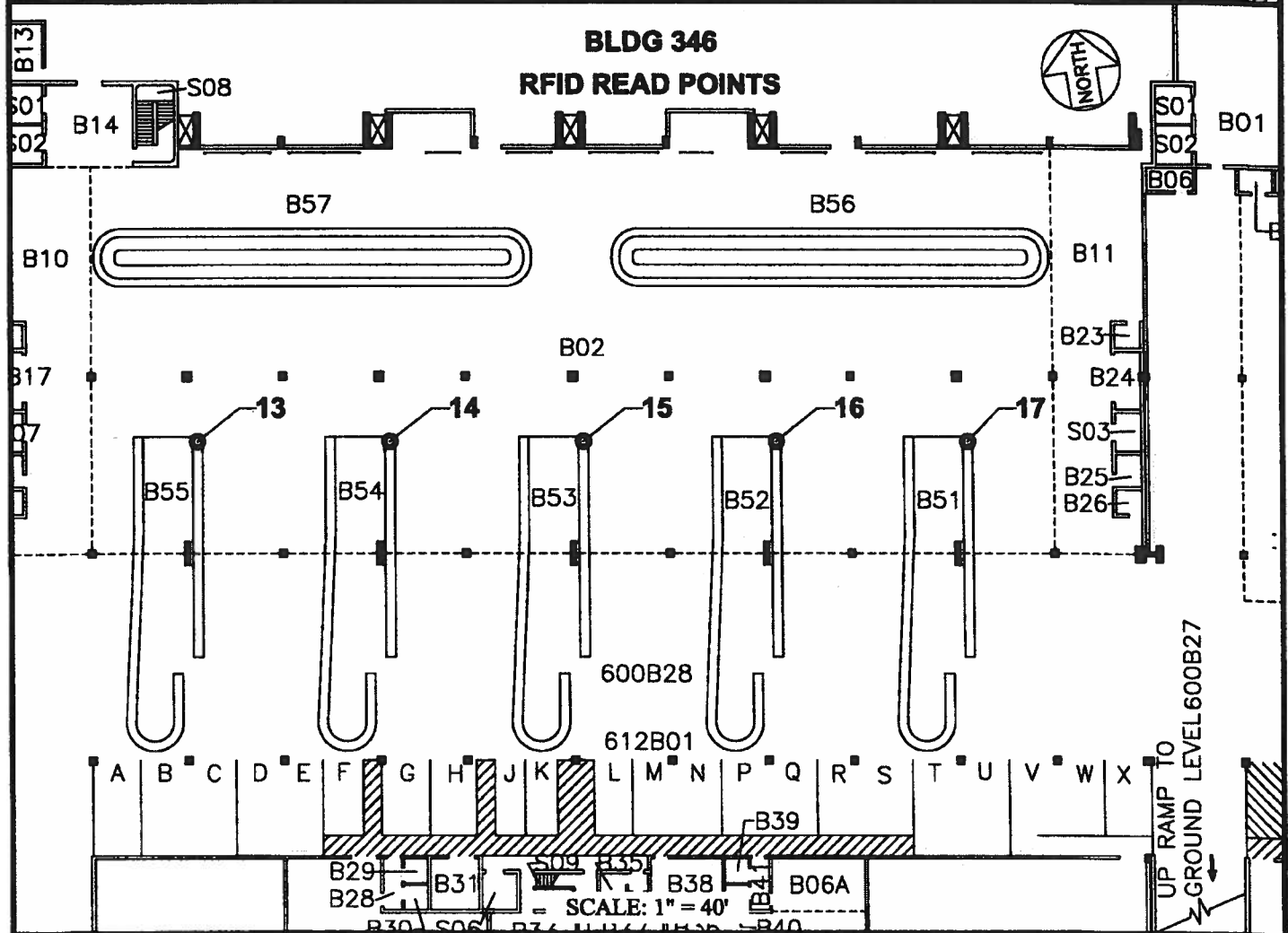
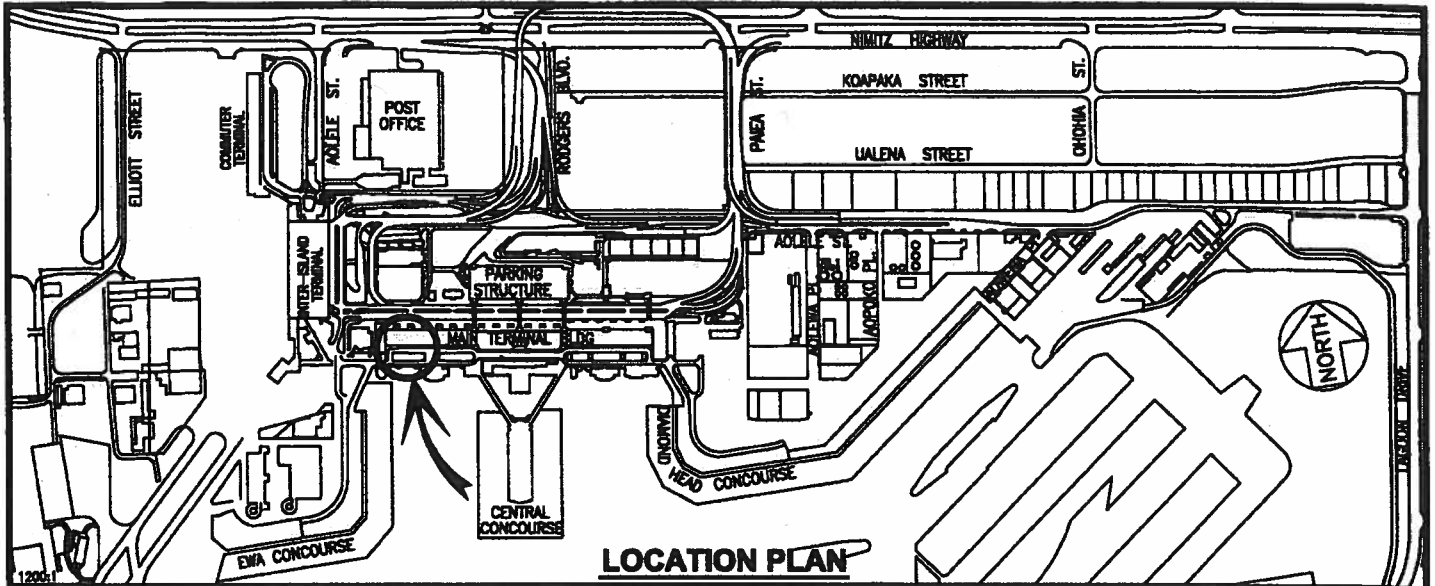

DATE : MARCH 2016

EXHIBIT: H-3



DELTA AIR LINES, INC.

BUILDING 346
INT'L ARRIVAL BUILDING
BASEMENT LEVEL

READ
POINTS
13-17
PLAT AB