

March 1, 1971

Mr. Rikio Nishioka
State Public Works Engineer
Department of Accounting &
General Services
P. O. Box 119
Honolulu, Hawaii 96810

Dear Mr. Nishioka:

The petition by the Department of Accounting & General Services (A70-265) to amend the Land Use District Boundaries from a Conservation District into an Urban District, at Halawa, Oahu, identifiable by Tax Map Key 9-9-02: parcels 23 and 4, was approved by the Land Use Commission at its meeting on February 26, 1971.

Prior to taking action on this petition, the enclosed memorandum was presented to the Commission.

For your information, we are enclosing herewith a copy of Section 2.33, "Performance Time," of the Rules and Regulations of the Commission.

Very truly yours,

RAMON DURAN
Executive Officer

Enclosures 3

cc: City Planning Dept.
Property Assessment, Dept. of Tax.
Planning Office, DLNR
Facilities & Auxiliary Svcs. Br., DOE
Board of Land & Natural Resources
Dept. of Transportation
Ellwood Bartz, Board of Water Supply
Water Sales Division, Board of Water Supply
Planning Division, DPED
State Forester, DLNR
District " " "
Division of Public Works, DAGS
Property Technical Services, Dept. of Tax.
Tax Maps Recorder, Dept. of Tax.
Land Use Commission

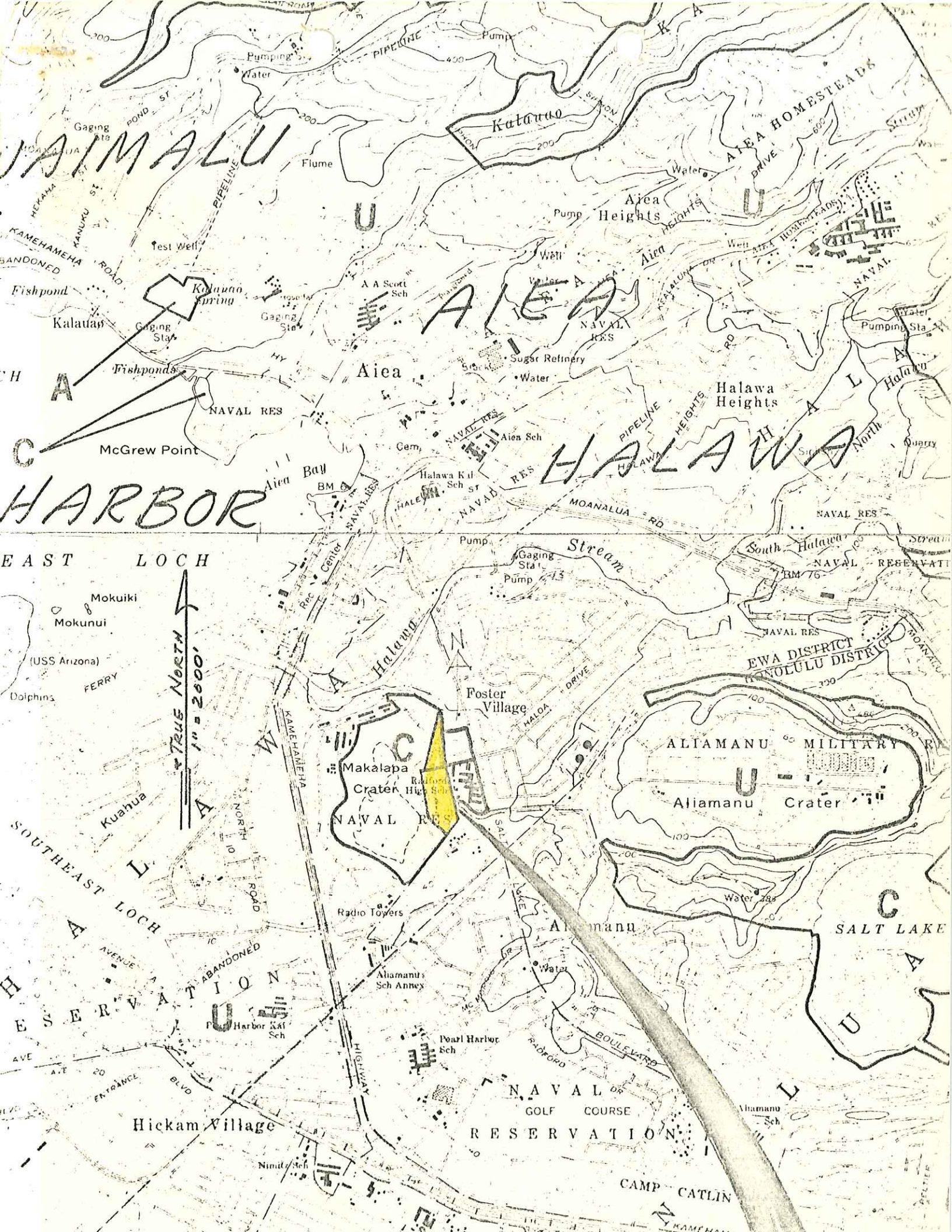

WAIMALU

AIEA

HALAWA

HARBOR

EAST LOCH

TRUE NORTH
1" = 2000'

SOUTHEAST LOCH

RESERVATION

Hickam Village

NAVAL GOLF COURSE
RESERVATION

CAMP CATLIN

SALT LAKE

ALIAMANU MILITARY
ALIAMANU Crater

Makalapa
Crater High Sch

Foster Village

NAVAL RES

EWA DISTRICT
KONOLULU DISTRICT

South Halawa
NAVAL RESERVATION

Halawa Heights

Aiea Heights

Aiea

McGrew Point

Kolanua Spring

Sugar Refinery

NAVAL RES

NAVAL RES

NAVAL RES

NAVAL RES

NAVAL RES

NAVAL RES

NAVAL RES

NAVAL RES

NAVAL RES

NAVAL RES

NAVAL RES

NAVAL RES

NAVAL RES

NAVAL RES

NAVAL RES

NAVAL RES

NAVAL RES

NAVAL RES

NAVAL RES

NAVAL RES

NAVAL RES

NAVAL RES

NAVAL RES

NAVAL RES

NAVAL RES

NAVAL RES

NAVAL RES

NAVAL RES

NAVAL RES

NAVAL RES

NAVAL RES

NAVAL RES

NAVAL RES

NAVAL RES

NAVAL RES

NAVAL RES

NAVAL RES

NAVAL RES

NAVAL RES

NAVAL RES

NAVAL RES

NAVAL RES

NAVAL RES

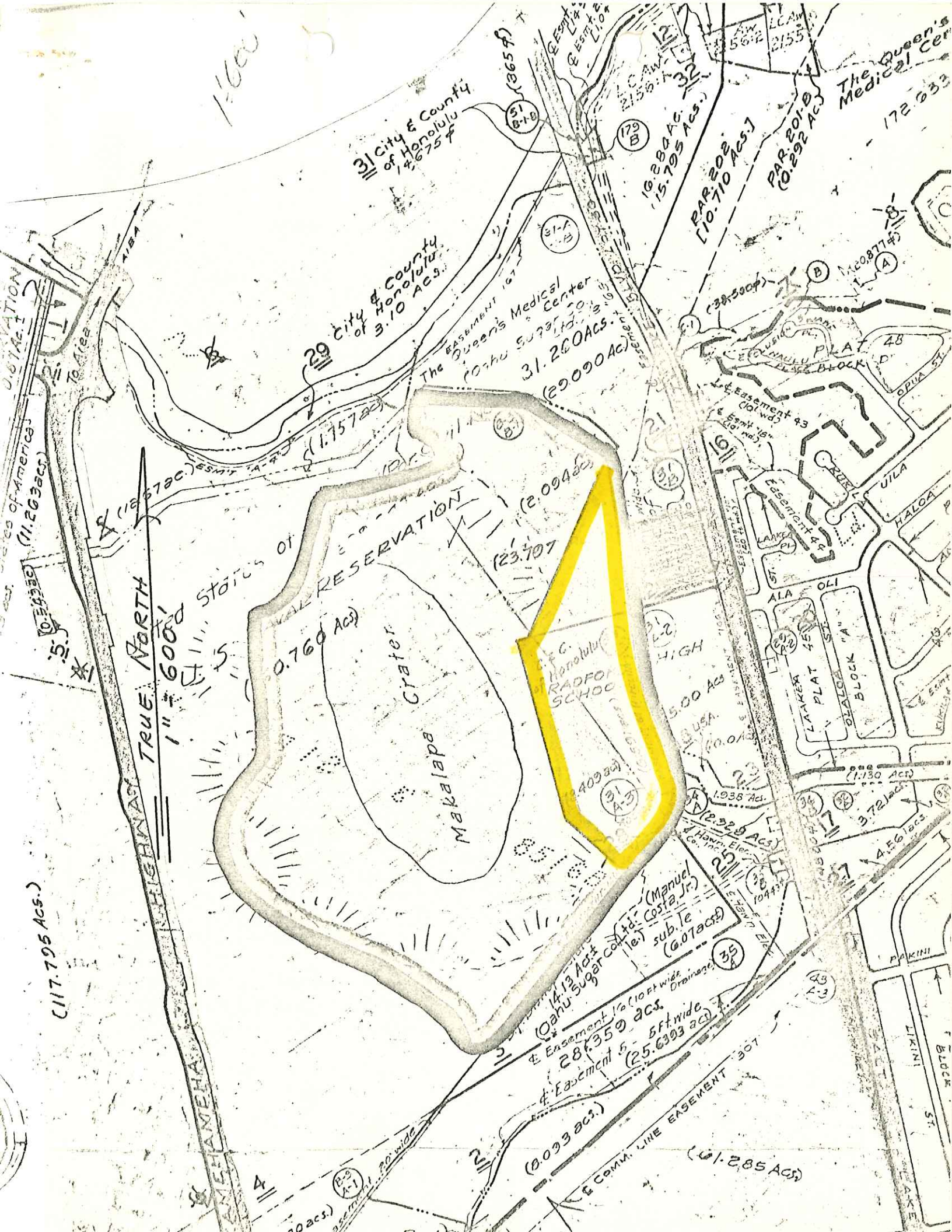

1600

3 City & County of Honolulu 4.675 acs

29 City & County of Honolulu 3.10 acs

The Queen's Medical Center (Oahu Super. H.S.) 31.260 acs (29090 acs)

10280 AC 15.795 acs

PAR 202 (10.710 acs)

PAR 201 (0.292 acs)

The Queen's Medical Center 172.633

0.671 acs
11.263 acs

TRUE NORTH
1" = 600'

Stations of

0.760 acs

RESERVATION
Makalapa Crater

23.707
2.094 acs

G. Honolulu RADFOY SCHOOL

31-A

31-B

31-C

31-D

31-E

31-F

31-G

31-H

31-I

31-J

31-K

31-L

31-M

31-N

31-O

31-P

117.795 acs

LAKEA PLAT 45

LAKEA PLAT 46

LAKEA PLAT 47

LAKEA PLAT 48

LAKEA PLAT 49

LAKEA PLAT 50

LAKEA PLAT 51

LAKEA PLAT 52

LAKEA PLAT 53

LAKEA PLAT 54

(Manual Sugar Co. sub. te) (6.07 acs)

E. Easement 1/2 (10 ft wide) 28.359 acs

F. Easement 5 - 5 ft wide (25.639 acs)

G. COMM. LINE EASEMENT 307 (61.285 acs)

1.938 acs

2.329 acs

3.72 acs

4.56 acs

5.40 acs

6.24 acs

7.08 acs

7.92 acs

8.76 acs

9.60 acs

10.44 acs

11.28 acs

12.12 acs

12.96 acs

13.80 acs

14.64 acs

15.48 acs

16.32 acs