

AT1-286 LUC #1 LAHILAH I PT.

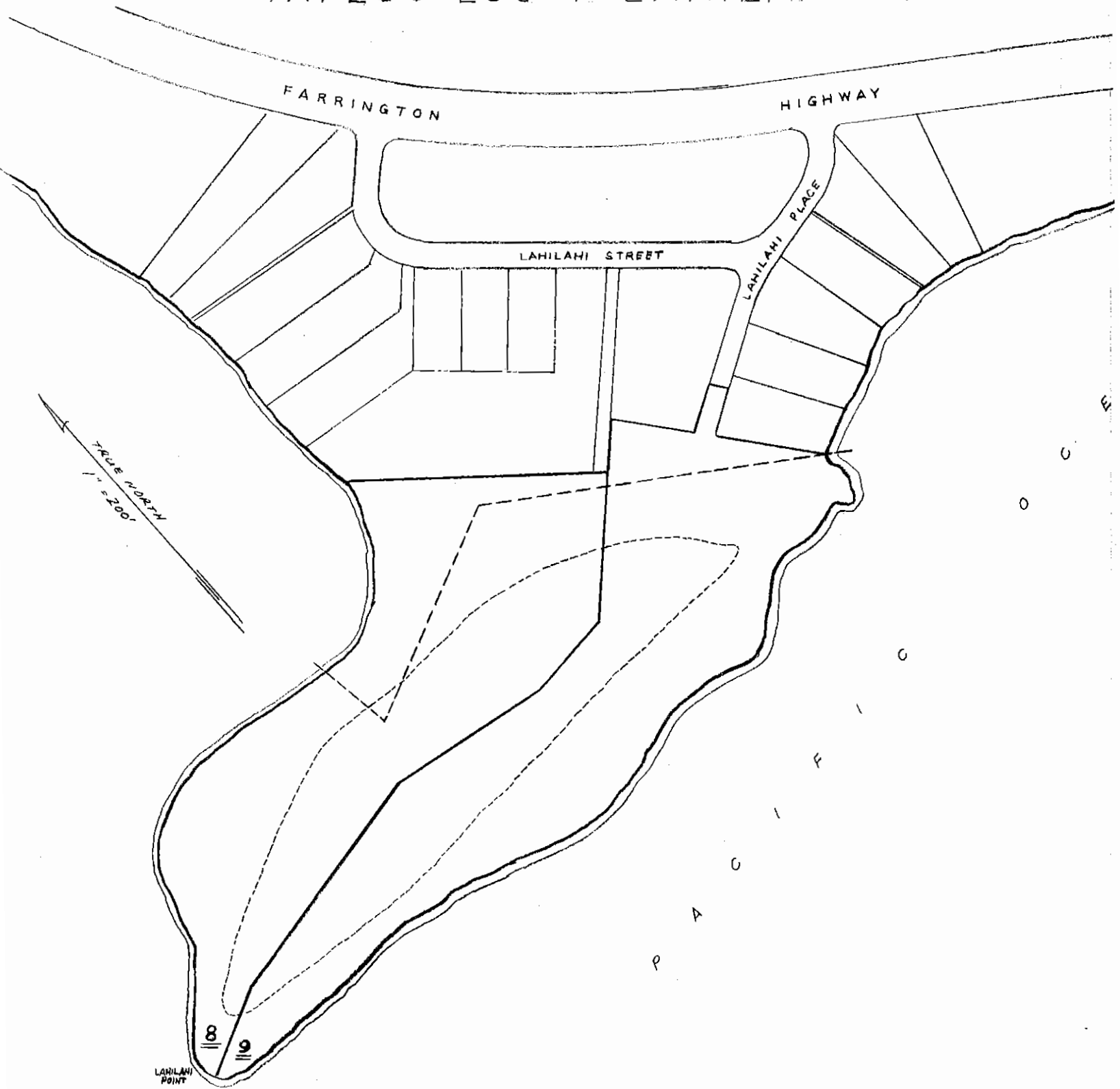

AMMENDED TO URBAN DISTRICT

RETAINED IN CONSERVATION DISTRICT - APPROX. 4.3 ACS.

STATE OF HAWAII
LAND USE COMMISSION

VOTE RECORD

ITEM A71-286 - LAND USE COMMISSION DATE September 17, 1971
C & C OF HONOLULU
 PLACE HONOLULU, HAWAII TIME 9:30 a.m.

9.7 acres at Lahilahi Point, Waianae, Oahu

NAME	YES	NO	ABSTAIN	ABSENT
M TANGEN, EDDIE	✓			
NAPIER, ALEXANDER	✓			
YAMAMURA, TANJI	✓			
KIDO, SUNAO	✓			
MARK, SHELLEY		✓		
S SAKAHASHI, STAN	✓			
WUNG, LESLIE	✓			
INABA, GORO	✓			

Comments:

land above
 Move that the 40' Contour

I move that the area above the dotted brown line be put in the Conservation District, and the area below, definable by the 40 foot contour line, be put into the Urban District.

STATE OF HAWAII
LAND USE COMMISSION

VOTE RECORD

ITEM A71-286 - LAND USE COMMISSION DATE September 17, 1971
C & C OF HONOLULU
 PLACE Legislative Auditorium TIME 9:30 a.m.
Honolulu, Hawaii

130 acres at Kahuku, Oahu

S
M

NAME	YES	NO	ABSTAIN	ABSENT
YAMAMURA, TANJI	✓			
NAPIER, ALEXANDER	✓			
TANGEN, EDDIE	✓			
MARK, SHELLEY		✓		
KIDO, SUNAO	✓			
SAKAHASHI, STAN	✓			
WUNG, LESLIE		✓		
INABA, GORO	✓			

Comments:

Set at 150 ft. from upper reaches of the wave. I move that the Conservation line be set 150' from the upper reaches of the waves.

STATE OF HAWAII
LAND USE COMMISSION

VOTE RECORD

ITEM A71-286 - LAND USE COMMISSION DATE September 17, 1971
 CITY & COUNTY OF HONOLULU
 PLACE Legislative Auditorium TIME 9:30 a.m.
Honolulu, Hawaii
3.7 acres at Hauula, Oahu

NAME	YES	NO	ABSTAIN	ABSENT
KIDO, SUNAO	✓			
SAKAHASHI, STAN	✓			
WUNG, LESLIE	✓			
YAMAMURA, TANJI	✓			
M S NAPIER, ALEXANDER	✓			
TANGEN, EDDIE	✓			
MARK, SHELLEY	✓			
INABA, GORO	✓			

Comments:

Motion to approve staff.

I move to accept staff recommendation.

STATE OF HAWAII
LAND USE COMMISSION

VOTE RECORD

ITEM A71-286 - LAND USE COMMISSION DATE September 17, 1971

CITY & COUNTY OF HONOLULU

PLACE Legislative Auditorium TIME 9:30 a.m.

Honolulu, Hawaii

18,000 sq. ft. at Makiki Heights, Oahu

NAME	YES	NO	ABSTAIN	ABSENT
WUNG, LESLIE	✓			
S SAKAHASHI, STAN	✓			
YAMAMURA, TANJI	✓			
KIDO, SUNAO	✓			
M MARK, SHELLEY	✓			
NAPIER, ALEXANDER	✓			
TANGEN, EDDIE	✓			
INABA, GORO	✓			

Comments:

Motion to approve staff recommendations
for both this & the 39-1 bc.
Ayes 4+5.

STATE OF HAWAII
LAND USE COMMISSION

VOTE RECORD

ITEM A71-286 - LAND USE COMMISSION DATE September 17, 1971
C & C OF HONOLULU
PLACE Legislative Auditorium TIME 9:30 a.m.
Honolulu, Hawaii

29.1 acres at Makiki Heights, Honolulu

NAME	YES	NO	ABSTAIN	ABSENT
SAKAHASHI, STAN				
WUNG, LESLIE				
YAMAMURA, TANJI				
TANGEN, EDDIE				
NAPIER, ALEXANDER				
MARK, SHELLEY				
KIDO, SUNAO				
INABA, GORO				

Comments:

STATE OF HAWAII
LAND USE COMMISSION

VOTE RECORD

ITEM A71-286 - LAND USE COMMISSION DATE September 17, 1971

C & C OF HONOLULU

PLACE Legislative Auditorium TIME 9:30 a.m.

Honolulu, Hawaii

4.4 acres, Lagoon at Kalia, Waikiki, Honolulu, Hawaii

NAME	YES	NO	ABSTAIN	ABSENT
MARK, SHELLEY	✓			
M NAPIER, ALEXANDER	✓			
KIDO, SUNAO	✓			
S, YAMAMURA, TANJI	✓			
TANGEN, EDDIE	✓			
SAKAHASHI, STAN	✓			
WUNG, LESLIE	✓			
INABA, GORO	✓			

Comments:

I move to accept staff recommendation.