

7-2-62

CANCELLATION IN PROCESS

STATE OF HAWAII
LAND USE COMMISSION

426 Queen Street
Honolulu, Hawaii

This space for official use

Date Application and Fee
received by LUC _____

APPLICATION FOR SPECIAL PERMIT

(I) (We) hereby request approval of a special permit to use certain property located in the County of Oahu, Island of Oahu, Land Use Commission Temporary District Boundary map number and/or name 0-15, for the following-described purpose:

Description of property: TMK: 4-1-08:5; that portion between Waikupanaha Street and the forest reserve boundary from Kumuhau Street to TMK 4-1-26:15.

Petitioner's interest in subject property: Fee

Petitioner's reason(s) for requesting special permit: To provide fifteen (15) agricultural lots of less area than five (5) acres as required under 2.1.(b), Part II, Interim Regulations for the following reasons: (a) Certain economic activities (kennels, breeding of rabbits, pigeons, etc.) do not require a minimum of five acres to maintain an economic unit. (b) Certain diversified agricultural activities (family operated vegetable farms) do not require a minimum of five (5) acres to maintain an economic unit. In addition, a surplus of land under this category could not be effectively and efficiently cultivated to realize the maximum benefit under a minimum five (5) acre requirement.

Signature(s) E. I. Kook

Address: Dept. of Land & Natural Resources

Telephone: 50511 - 133

This space for official use

The property is situated in a(n) Agricultural district, whose regulations adopted by the Land Use Commission prohibit the desired use.

Signature(s) [Signature]

For (agency) Land Use Commission

STATE OF HAWAII
LAND USE COMMISSION

426 Queen Street
Honolulu, Hawaii

This space for official use

Date Application and Fee
received by LUC _____

APPLICATION FOR SPECIAL PERMIT

(I) (We) hereby request approval of a special permit to use certain property located in the County of Oahu, Island of Oahu, Land Use Commission Temporary District Boundary map number and/or name 0-15, for the following-described purpose:

Description of property: TMK: 4-1-08:5; that portion between Waikupanaha Street and the forest reserve boundary from Kumuhau Street to TMK 4-1-26:15.

Petitioner's interest in subject property: Fee

Petitioner's reason(s) for requesting special permit: To provide fifteen (15) agricultural lots of less area than five (5) acres as required under 2.1.(b), Part II, Interim Regulations for the following reasons: (a) Certain economic activities (kennels, breeding of rabbits, pigeons, etc.) do not require a minimum of five acres to maintain an economic unit. (b) Certain diversified agricultural activities (family operated vegetable farms) do not require a minimum of five (5) acres to maintain an economic unit. In addition, a surplus of land under this category could not be effectively and efficiently cultivated to realize the maximum benefit under a minimum five (5) acre requirement.

Signature(s) E. J. [Signature]

Address: Dept. of Land & Natural Resources

Telephone: 50511 - 133

This space for official use

The property is situated in a(n) Agricultural district, whose regulations adopted by the Land Use Commission prohibit the desired use.

Signature(s) [Signature]

For (agency) Land Use Commission

NEAL S. BLAISDELL
MAYOR



CITY AND COUNTY OF HONOLULU

PLANNING DEPARTMENT
HONOLULU HALE ANNEX
HONOLULU 13, HAWAII

May 21, 1962

PLANNING COMMISSION

GEORGE F. CENTEIO, CHAIRMAN
THOMAS N. YAMABE, II, VICE-CHAIRMAN
FRANK W. HUSTACE
WILLIAM R. NORWOOD
CYRIL W. LEMMON

BUDGET DIRECTOR, EX-OFFICIO
MANAGING DIRECTOR, EX-OFFICIO

ZONING BOARD OF APPEALS

R. GIBSON RIETOW, CHAIRMAN
HENRY C. H. CHUN-HOON, VICE-CHAIRMAN
HAROLD K. KOMETANI

PLANNING DIRECTOR
FREDERICK K. F. LEE

1962(254)

RECEIVED

MAY 23 1962

State of Hawaii
LAND USE COMMISSION

State Land Use Commission
426 South Queen Street
Honolulu 13, Hawaii

Gentlemen:

Proposed Subdivision: Waimanalo - off Waikupanaha St.
Tax Key: 4-1-08: 5 and 4-1-10: 22
Owner: State of Hawaii
Surveyor: Dept. of Land and Natural Resources

Transmitted herewith is a map of the subject subdivision.

Your comments and recommendations are respectfully requested.

Very truly yours,

PLANNING DEPARTMENT

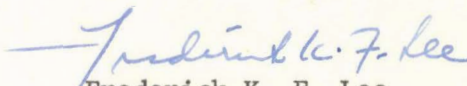
Frederick K. F. Lee
Planning Director

EY:ef
Enc. Map

NEAL S. BLAISDELL
MAYOR

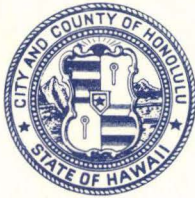

CITY AND COUNTY OF HONOLULU

PLANNING DEPARTMENT
HONOLULU HALE ANNEX
HONOLULU 13, HAWAII

June 25, 1962

PLANNING COMMISSION
GEORGE F. CENTEIO, CHAIRMAN
THOMAS N. YAMABE, II, VICE-CHAIRMAN
FRANK W. HUSTACE
WILLIAM R. NORWOOD
CYRIL W. LEMMON
BUDGET DIRECTOR, EX-OFFICIO
MANAGING DIRECTOR, EX-OFFICIO
ZONING BOARD OF APPEALS.
R. GIBSON RIETOW, CHAIRMAN
HENRY C. H. CHUN-HOON, VICE-CHAIRMAN
HAROLD K. KOMETANI
PLANNING DIRECTOR
FREDERICK K. F. LEE

State Land Use Commission
426 South Queen Street
Honolulu 13, Hawaii

Gentlemen:

Proposed Subdivision: Waimanalo - off Waikupanaha Street
Tax Key: 4-1-08: 5 and 4-1-10: 22
Owner: State of Hawaii
Surveyor: State Department of Land and Natural Resources

Transmitted herewith a map of the subject subdivision into 48
lots. Your comments and recommendations are respectfully requested.

Very truly yours,

PLANNING DEPARTMENT

A handwritten signature in blue ink, which appears to read "Frederick K. F. Lee", is written over the typed name.

Frederick K. F. Lee
Planning Director

EY:ef
Enc.

STATE OF HAWAII
LAND USE COMMISSION

426 Queen Street
Honolulu, Hawaii

This space for official use

Date Application and Fee
received by LUC _____

APPLICATION FOR SPECIAL PERMIT

(I) (We) hereby request approval of a special permit to use certain property located in the County of Oahu, Island of Oahu, Land Use Commission Temporary District Boundary map number and/or name 0-15, for the following-described purpose:

Description of property: TMK: 4-1-08:5; that portion between Waikupanaha Street and the forest reserve boundary from Kumuhau Street to TMK 4-1-26:15.

Petitioner's interest in subject property: Fee

Petitioner's reason(s) for requesting special permit: To provide fifteen (15) agricultural lots of less area than five (5) acres as required under 2.1.(b), Part II, Interim Regulations for the following reasons: (a) Certain economic activities (kennels, breeding of rabbits, pigeons, etc.) do not require a minimum of five acres to maintain an economic unit. (b) Certain diversified agricultural activities (family operated vegetable farms) do not require a minimum of five (5) acres to maintain an economic unit. In addition, a surplus of land under this category could not be effectively and efficiently cultivated to realize the maximum benefit under a minimum five (5) acre requirement.

Signature(s) E. I. K. K.

Address: Dept. of Land & Natural Resources

Telephone: 50511 - 133

This space for official use

The property is situated in a(n) Agricultural district, whose regulations adopted by the Land Use Commission prohibit the desired use.

Signature(s) [Signature]

For (agency) Land Use Commission



PRELIMINARY PLAT OF
WAIMANALO AGRICULTURAL SUBDIVISION
LOTS 1 TO 48 (INCLUSIVE)
AT WAIMANALO, OAHU, STATE OF HAWAII
FEBRUARY 15, 1962

OWNER: DEPARTMENT OF LAND AND NATURAL RESOURCES, STATE OF HAWAII
TAX MAP KEY: FIRST DIVISION, 4-1-08

APPROVED: [Signature] DATE: Feb 9, 1962
PLANNING DIVISION
LAND MANAGEMENT DIVISION
DIRECTOR, DLNR DATE: Feb 9, 1962

TRUE NORTH
SCALE 1" = 200'

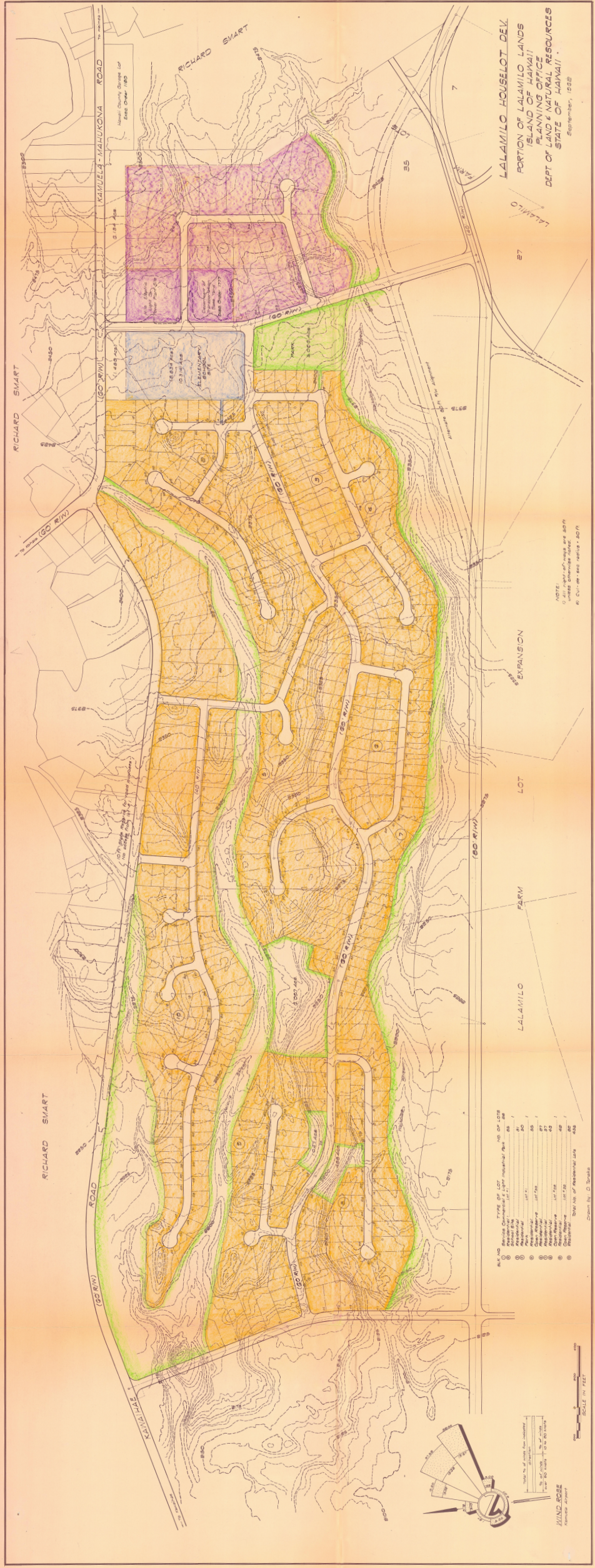

LEGEND

Symbol	Description	Notes
—	Public Road	
- - -	Private Road	
1	Lot 1	
2	Lot 2	
3	Lot 3	
4	Lot 4	
5	Lot 5	
6	Lot 6	
7	Lot 7	
8	Lot 8	
9	Lot 9	
10	Lot 10	
11	Lot 11	
12	Lot 12	
13	Lot 13	
14	Lot 14	
15	Lot 15	
16	Lot 16	
17	Lot 17	
18	Lot 18	
19	Lot 19	
20	Lot 20	
21	Lot 21	
22	Lot 22	
23	Lot 23	
24	Lot 24	
25	Lot 25	
26	Lot 26	
27	Lot 27	
28	Lot 28	
29	Lot 29	
30	Lot 30	
31	Lot 31	
32	Lot 32	
33	Lot 33	
34	Lot 34	
35	Lot 35	
36	Lot 36	
37	Lot 37	
38	Lot 38	
39	Lot 39	
40	Lot 40	
41	Lot 41	
42	Lot 42	
43	Lot 43	
44	Lot 44	
45	Lot 45	
46	Lot 46	
47	Lot 47	
48	Lot 48	
49	Lot 49	
50	Lot 50	
51	Lot 51	
52	Lot 52	
53	Lot 53	
54	Lot 54	
55	Lot 55	
56	Lot 56	
57	Lot 57	
58	Lot 58	
59	Lot 59	
60	Lot 60	
61	Lot 61	
62	Lot 62	
63	Lot 63	
64	Lot 64	
65	Lot 65	
66	Lot 66	
67	Lot 67	
68	Lot 68	
69	Lot 69	
70	Lot 70	
71	Lot 71	
72	Lot 72	
73	Lot 73	
74	Lot 74	
75	Lot 75	
76	Lot 76	
77	Lot 77	
78	Lot 78	
79	Lot 79	
80	Lot 80	
81	Lot 81	
82	Lot 82	
83	Lot 83	
84	Lot 84	
85	Lot 85	
86	Lot 86	
87	Lot 87	
88	Lot 88	
89	Lot 89	
90	Lot 90	
91	Lot 91	
92	Lot 92	
93	Lot 93	
94	Lot 94	
95	Lot 95	
96	Lot 96	
97	Lot 97	
98	Lot 98	
99	Lot 99	
100	Lot 100	

HA - LALAMILO