

WILSON JONES ©

YAMAWOJU, HIYOCOSHI

SP(T) 63-

STATE OF HAWAII
LAND USE COMMISSION

426 Queen Street
Honolulu, Hawaii

This space for official use

Date Application and Fee
received by LUC 3-27-63

APPLICATION FOR SPECIAL PERMIT

(I) (We) hereby request approval of a special permit to use certain property located in the County of Maui, Island of Molokai, Land Use Commission Temporary District Boundary map number and/or name _____, for the following-described purpose:

To re-classify from AGRICULTURAL to URBAN.DISTRICT.

Description of property:

All of that certain parcel of land (portion of Land Patent Grant 8814 to Joel K. Kahinu), situate at Kahanui, District of Kahanui, Island of Molokai, Tax Map Key: 5-2-11:11 (2nd Div), area 45 Acres, Petitioner's interest in subject property: referred to as "Punalau Pond"

Petitioner owns 45 Acres of above described 50 Acres.

Petitioner's reason(s) for requesting special permit:

Petitioner plans to dredge this pond and develop it into a small boat harbor.

Signature(s) *Hirotoshi Yamamoto*

Attached Tax Map: 5-2-11

Address: 2733 East Manoa Road, Hon 14, Haw

Telephone: 982-121 - Bob Teamoto

This space for official use

The property is situated in a(n) AGRICULTURAL district, whose regulations adopted by the Land Use Commission prohibit the desired use.

Signature(s) *W.M. Mullaley*

For (agency) L.U.C.

STATE OF HAWAII
LAND USE COMMISSION

426 Queen Street
Honolulu, Hawaii

This space for official use

Date Application and Fee
received by LUC _____

APPLICATION FOR SPECIAL PERMIT

(I) (We) hereby request approval of a special permit to use certain property located in the County of Maui, Island of Molokai, Land Use Commission Temporary District Boundary map number and/or name _____, for the following-described purpose:

To re-classify from AGRICULTURAL to URBAN.DISTRICT.

Description of property:

All of that certain parcel of land (portion of Land Patent Grant 8814 to Joel K. Kahinu), situate at Kahanui, District of Kahanui, Island of Molokai, Tax Map Key: 5-2-11:11 (2nd Div), area 45 Acres, Petitioner's interest in subject property: referred to as "Punalau Pond"

Petitioner owns 45 Acres of above described 50 Acres.

Petitioner's reason(s) for requesting special permit:

Petitioner plans to dredge this pond and develop it into a small boat harbor.

Signature(s) *Hirotoshi Yamamoto*

Attached Tax Map: 5-2-11

Address: 2733 East Manoa Road, Hon 14, Haw

Telephone: 982-121 - Bob Teramoto

This space for official use

The property is situated in a(n) _____ district, whose regulations adopted by the Land Use Commission prohibit the desired use.

Signature(s) _____

For (agency) _____

STATE OF HAWAII
LAND USE COMMISSION

426 Queen Street
Honolulu, Hawaii

This space for official use

Date Application and Fee
received by LUC _____

APPLICATION FOR SPECIAL PERMIT

(I) (We) hereby request approval of a special permit to use certain property located in the County of Maui, Island of Molokai, Land Use Commission Temporary District Boundary map number and/or name _____, for the following-described purpose:

To re-classify from AGRICULTURAL to URBAN.DISTRICT.

Description of property:

All of that certain parcel of land (portion of Land Patent Grant 8814 to Joel K. Kahimu), situate at Kahanui, District of Kahanui, Island of Molokai, Tax Map Key: 5-2-11:11 (2nd Div), area 45 Acres, Petitioner's interest in subject property: referred to as "Punalau Pond"

Petitioner owns 45 Acres of above described 50 Acres.

Petitioner's reason(s) for requesting special permit:

Petitioner plans to dredge this pond and develop it into a small boat harbor.

Signature(s) Hirotochi Yamamoto

Attached Tax Map: 5-2-11

Address: 2733 East Manoa Road, Hon 14, Haw

Telephone: 982-121 - Bob Teramoto

This space for official use

The property is situated in a(n) _____ district, whose regulations adopted by the Land Use Commission prohibit the desired use.

Signature(s) _____

For (agency) _____

STATE OF HAWAII

OFFICIAL RECEIPT No. 49

LAND USE Commission
425 Commercial St., Honolulu, Hawaii

Department, Bureau or Commission

March 27 1943

RECEIVED from Bot Transacts for Hirotsuki Yamamoto
Fifty + 00/100 _____ DOLLARS

for public hearing by the Land Use Commission for a
Special Permit for property on Moloai

\$ 50.00

Quentin P. Kai

Public Accountant

Ch# 284, Central Pacific Bank

Ref. No. LUC 684

October 16, 1963

Mr. Hirotoshi Yamamoto
2733 East Manoa Road
Honolulu, Hawaii

Dear Mr. Yamamoto:

Your request for withdrawal of your application for special permit is acknowledged.

A warrant issued by the Comptroller of the State of Hawaii is being processed to refund the fee deposited with your application.

Sincerely,

GORDON SOH
Associate Planner
Department of Planning and
Economic Development

WILLIAM F. QUINN
GOVERNOR



426 QUEEN STREET
HONOLULU 13, HAWAII

October 7, 1963
Date

ROWLAND J. DARNELL
EXECUTIVE OFFICER

CHAIRMAN
EDWARD C. BRYAN
VICE CHAIRMAN
EDWARD KANEMOTO
SECRETARY
YUICHI TOE

STANLEY C. FRIEL
WAYNE D. GREGG
FRANKLIN T. K. SUNN
ROGER T. WILLIAMS

ETH COOK, EX OFFICIO
LAND AND NATURAL RESOURCES
FRANK LOMBARDI, EX OFFICIO
PLANNING AND RESEARCH

OCT 8 1963

REC
OCT 8
State of
LAND USE COM.

State of Hawaii
Land Use Commission
426 Queen Street
Honolulu, Hawaii

Gentlemen:

It is my desire to withdraw my application for special permit dated March 27, 1963 (date received by LUC) and with it my deposit fee of fifty dollars (\$50.00) to cover hearing expenses.

The refund of the deposit fee should be made to:

NAME HIROTOSHI YAMAMOTO
ADDRESS 2733 East Manoa Rd
Honolulu 96822

Yours very truly,

Hirotoshi Yamamoto
HIROTOSHI YAMAMOTO

CORRECTED
FEB 14 1934
MAY 9
NOV 1934

Reduced and Copy by
THE BLUE PRINT CO
88 S. QUEEN STREET, Phone 62148
APR 1 - 1960

Dwg No. 335A
Source: T.M.B. Survey Dept. (C. U. P.H. 74)
By P.K. & H.N. Aug. 1938

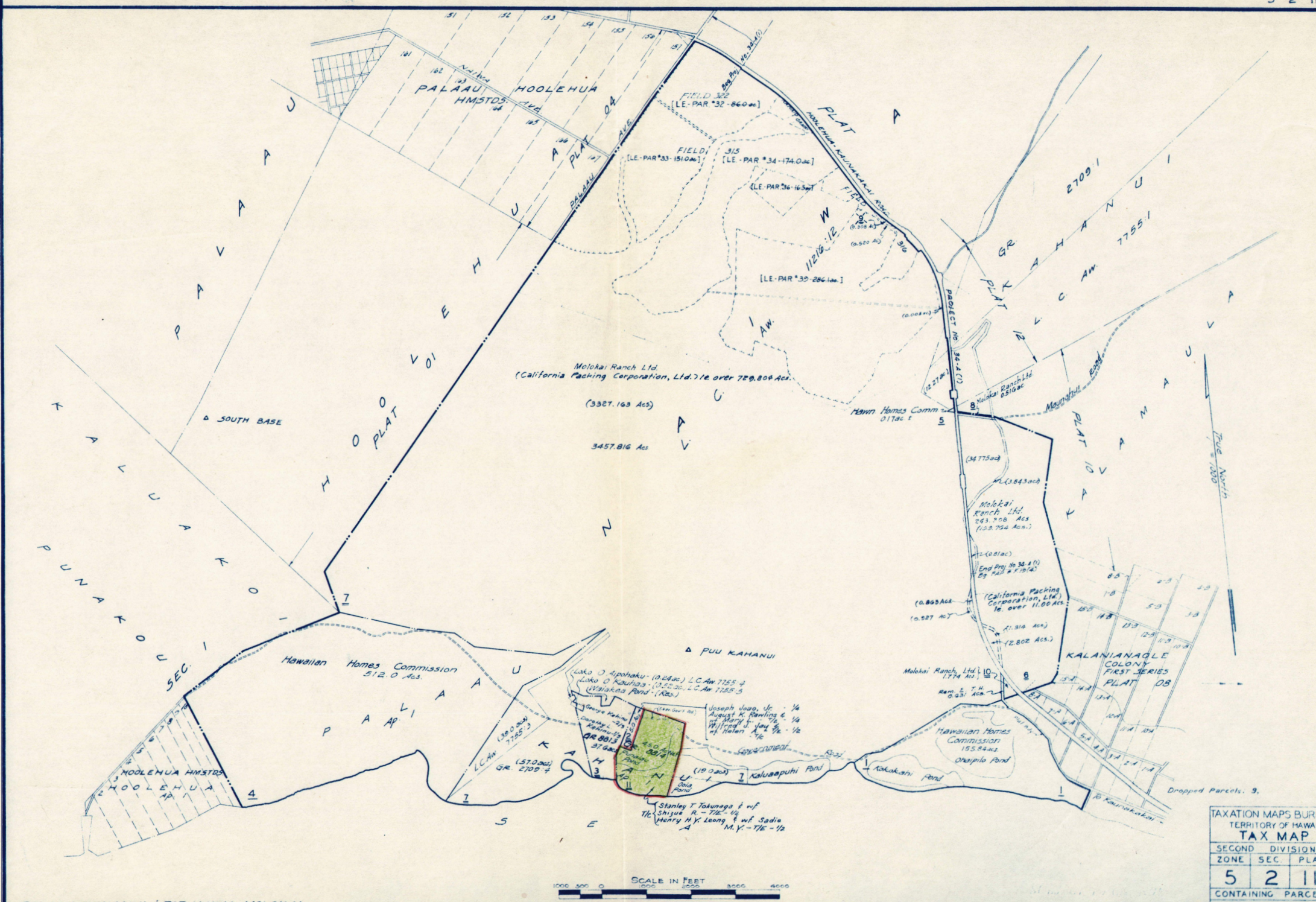

PALAAUI, KAHANUI, & POR NAIWA, MOLOKAI

TAXATION MAPS BUREAU		
TERRITORY OF HAWAII		
TAX MAP		
SECOND DIVISION		
ZONE	SEC.	PLAT
5	2	11
CONTAINING PARCELS		
SCALE 1 in = 1000 ft.		
PRINTED		

DATE: FEB. 14 1954

Reduced and Copied by
THE BLUE PRINT CO
110 S. GLENN STREET
HONOLULU, HAWAII
APR. 1, 1950

Dwg No. 374
Source: T.M.B. Survey Dept. (C.5. P.H.74)
By: F.K. & H.N. Aug. 1938

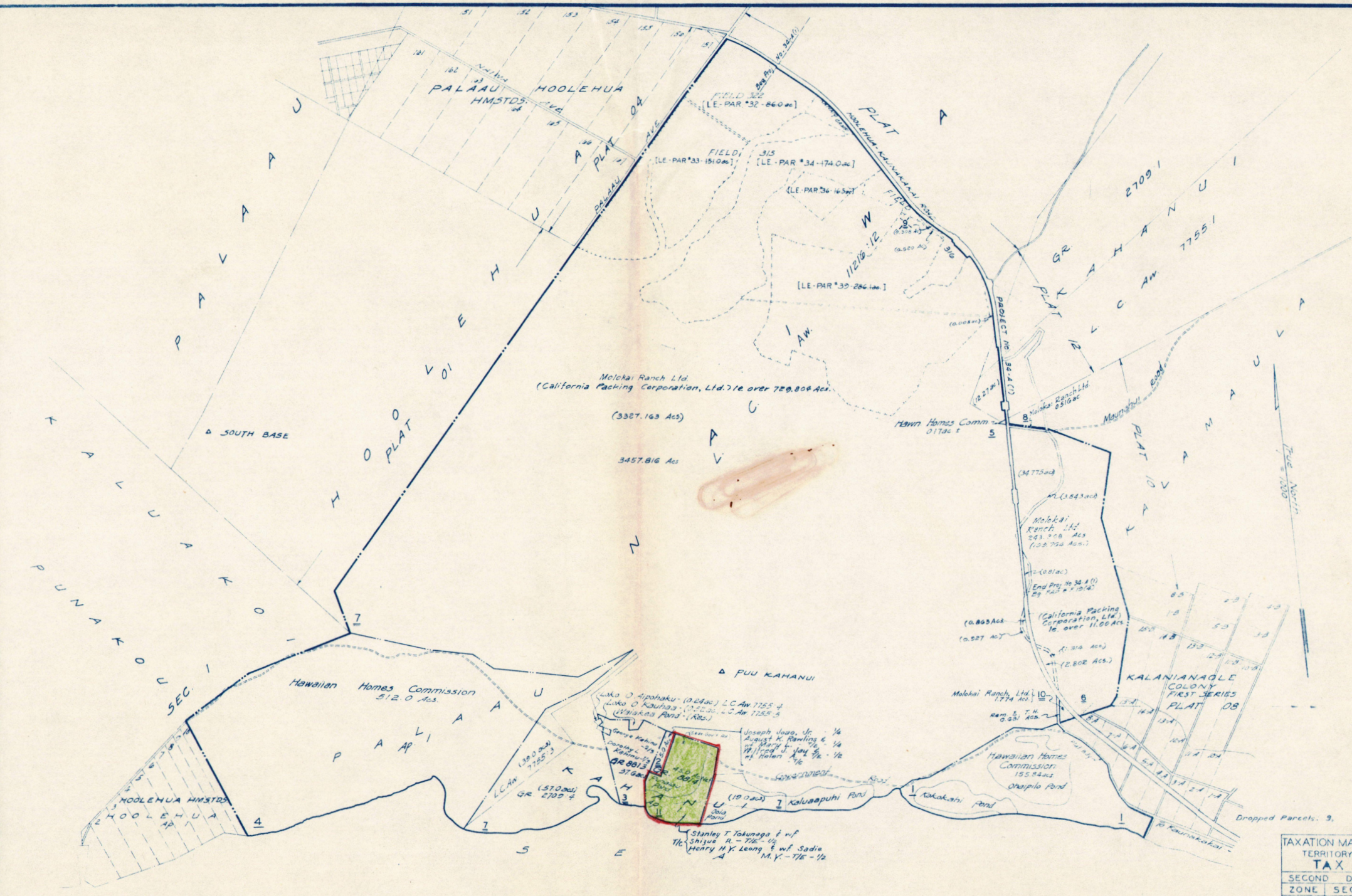

PALAAUI, KAHANUI, & POR NAIWA, MOLOKAI

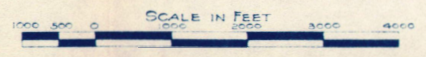

TAXATION MAPS BUREAU		
TERRITORY OF HAWAII		
TAX MAP		
SECOND	DIVISION	
ZONE	SEC	PLAT
5	2	11
CONTAINING PARCELS		
SCALE 1 in = 1000 ft.		
PRINTED		

WILLIAM F. QUINN
GOVERNOR

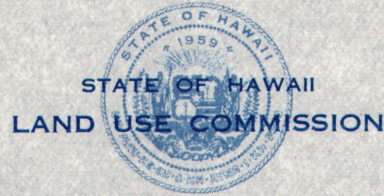

STATE OF HAWAII
LAND USE COMMISSION

426 QUEEN STREET

HONOLULU 13, HAWAII

October 7, 1963
Date

ROWLAND J. BARNELL
EXECUTIVE OFFICER

CHAIRMAN
EDWARD C. BRYAN
VICE CHAIRMAN
EDWARD KANEMOTO
SECRETARY
YUICHI IGE

STANLEY C. FRIEL
WAYNE D. GREGG
FRANKLIN Y. K. SUNN
ROGER T. WILLIAMS

E. H. COOK, EX-OFFICIO
LAND AND NATURAL RESOURCES
FRANK LOMBARDI, EX-OFFICIO
PLANNING AND RESEARCH

State of Hawaii
Land Use Commission
426 Queen Street
Honolulu, Hawaii

Gentlemen:

It is my desire to withdraw my application for special permit dated March 27, 1963 (date received by LUC) and with it my deposit fee of fifty dollars (\$50.00) to cover hearing expenses.

The refund of the deposit fee should be made to:

NAME Hirotoshi Yamamoto
ADDRESS 733 East Manoa Rd
Honolulu Hawaii 96822

Yours very truly,

Hirotoshi Yamamoto
HIROTOSHI YAMAMOTO

RECEIVED

OCT 8 1963

State of Hawaii
LAND USE COMMISSION

October 4, 1963

Ref. No. LUC 661

Mr. Hirotoshi Yamamoto
2733 East Manoa Road
Honolulu 14, Hawaii

Dear Mr. Yamamoto:

Dr. Shelley M. Mark, who is the director of this department and an ex-officio member of the Land Use Commission, has authorized me to write you concerning the status of your application to the Commission for a special permit.

You are advised that the term of the last Commission expired on May 3, 1963 and that no action on your application was taken prior to that date. On June 17, 1963 Governor Burns signed into law Act 205, SLH 1963, which provides that applications for special permits be submitted to the county planning commissions or zoning board of appeals.

A new State Land Use Commission has not yet been appointed, but even after appointment it would be powerless to act on your application. Therefore, you are advised to withdraw your application and with it your deposit of \$50.00. Withdrawal should be made by letter, the form of which is enclosed for your convenience.

Sincerely,

CLARENCE L. HODGE
Acting Director

Enclosure

cc: Maui Planning & Traffic Commission

Roy Takeyama

Date

State of Hawaii
Land Use Commission
426 Queen Street
Honolulu, Hawaii

Gentlemen:

Eagle A

It is my desire to withdraw my application for special permit dated March 27, 1963 (date received by LUC) and with it my deposit fee of fifty dollars (\$50.00) to cover hearing expenses.

The refund of the deposit fee should be made to:

NAME _____

ADDRESS _____

Yours very truly,

HIROTOSHI YAMAMOTO

Hiro Yamamoto .

Sent to Board of County
Real Estate
Appraisals



SALES - RENTALS - APPRAISALS - BUILDING - LAND DEVELOPMENT

2773 EAST MANOA ROAD, HONOLULU, HAWAII - TELEPHONE 9~~96~~^{***}-15-5
982-121

April 15, 1963

RECEIVED

APR 16 1963

666

State of Hawaii
LAND USE COMMISSION

Land Use Commission
426 Queen Street
Honolulu, Hawaii

Gentlemen:

This letter is in response to your request for further information about the property located in Molokai, and other background information.

1. I and my associates purchased the Keehi Drydock Corporation of which I am at present the president. Keehi Drydock Corporation maintains facilities to build, repair and maintain small boats.
2. I am also Vice President of Asahi Fishing Inc. which operates 2 fishing boats, the Asahi Maru a 40 foot deep sea bottom fishing boat and the Holokohana which is a 46 foot Aku boat.
3. Most of our fishing is done within sight of the Hawaiian Islands and particularly around Penguin Bank.
4. The property which I have purchased is ideally suited to provide a safe Haven for small boats, and also for a private marina operations. During Kona weather, boats and fisherman take a beating because most of our facilities are exposed.
5. This particular pond has fresh water seepage so that "Toledo" which eat into the plank is reduced to a minimum. In Florida, boats are stored upstream in fresh water and do not have this problem.
6. I believe that the U.S. Army Engineers will look with favor upon such a program, but we cannot begin to plan or start anything until the land is properly zoned. I agree that there are more suitable land available but nobody wants to do anything.

7. The completion of our Marina will provide a "Safe Haven" for commercial fisherman and sports enthusiasts in case of sudden storms or change in weather.
8. Please bear in mind that our plans and projections are preliminary in nature as we cannot proceed without your approval.

Most Sincerely,

Hirotoshi Yamamoto

HIROTOSHI YAMAMOTO