

Jan 11, 1973
Feb. 25, 1973

SP73-141 - AVIS RENT A CAR SYSTEM, INC. (MOI.)

February 8, 1973

Maui Planning Commission
200 South High Street
Wailuku, Maui 96793

Attention: Mr. Howard Nakamura
Planning Director

Gentlemen:

At its meeting on February 2, 1973, the Land Use Commission voted to approve a special permit to Avis Rent A Car System, Inc. (SP73-141) to construct and operate a U-drive business on approximately 3.9 acres of land identified as Tax Map Key 5-2-04: parcel 51, situated at Hoolehua, Molokai, subject to the conditions set forth by the Maui Planning Commission.

A copy of the staff report is enclosed for your information.

Very truly yours,

TATSUO FUJIMOTO
Executive Officer

Encls.

cc: Avis Rent A Car
System, Inc.
Dept. of Taxation, Maui
Property Technical Office, Dept. of Taxation
Tax Maps Recorder, Dept. of Taxation
Real Property Tax Assessor, Dept. of Taxation

6/14/73

J. Detor, Land Mgmt Div, DLNR

February 8, 1973

Mr. Clark Seidel
Vice President and Regional Manager
Avis Rent A Car System, Inc.
3001 N. Nimitz Highway
Honolulu, Hawaii 96819

Dear Mr. Seidel:

The original of the attached letter approving your special permit request (SP73-141) to establish and operate a U-drive car rental business, including storage and servicing facilities, on approximately 3.9 acres of land identified as Tax Map Key 5-2-04: parcel 51, situated at Hoolehua, Molokai, subject to the conditions set forth by the Maui Planning Commission, is on file in the office of the Planning Department, County of Maui, 200 South High Street, Wailuku, Maui.

Very truly yours,

TATSUO FUJIMOTO
Executive Officer

Encls.

STATE OF HAWAII
LAND USE COMMISSION

Minutes of Meeting

February 2, 1973 - 1:30 p.m.

Board Room
Queen Liliuokalani Building
Honolulu, Hawaii

COMMISSIONERS PRESENT: Goro Inaba, Chairman
Eddie Tangen, Vice Chairman
Alexander Napier
Sunao Kido
Shelley M. Mark
Leslie Wung
Tanji Yamamura
Stanley Sakahashi

Approved
AUG 30 1973

STAFF PRESENT: Tatsuo Fujimoto, Executive Officer
Ah Sung Leong, Planner
Gordan Furutani, Planner
Benjamin Matsubara, Deputy Attorney General
Dora Horikawa, Clerk Reporter

Chairman Inaba swore in persons testifying during today's proceedings.

ACTION

PETITION BY INTERNATIONAL DEVELOPMENT CO. (A72-330) TO RECLASSIFY 30 ACRES FROM CONSERVATION TO URBAN AT MOANALUA, OAHU

Mr. Tatsuo Fujimoto, Executive Officer, presented the staff memorandum recommending that the petition be disapproved based on staff's analysis and discussion (see copy of memorandum on file).

Vice Chairman Tangen prefaced his motion with comments he wished to share with the Commissioners regarding the subject petition. He recounted that during the two public hearings that were held on this request, many concerns were expressed regarding the physical and social environment, the community's need for park and recreational areas, and the housing needs on Oahu. In reaching a conclusion, all of these points and the relevant testimony opposing the petition had to be weighed.

Mr. Walt Southward, Manager of Special Affairs, Boise Cascade Recreation Communities, submitted that work had commenced in the makai area but was terminated due to litigation pending in the Supreme Court against Mr. Richard Smart by a Mr. McCulloch over the ownership of the property, making it impossible for Mr. Smart to pass title to the petitioner. Therefore, the condition that construction of subject use begin within one year of date of final approval may present a problem.

Both Commissioner Napier and Vice Chairman Tangen suggested that the approval be subject to the condition that construction commence within 1 year of the Court's decision, if in favor of Mr. Smart.

Another alternative offered by Mr. Fujimoto entailed the approval of the special permit as conditioned by the County, and depending on the disposition of the pending litigation, the permit may either be terminated or the petitioner could request an extension at the end of a year.

Commissioner Kido moved to approve the special permit subject to the conditions set forth by the Hawaii Planning Commission, which was seconded by Commissioner Yamamura. The Commissioners were polled as follows:

Ayes: Vice Chairman Tangen, Commissioners Mark, Kido, Sakahashi, Yamamura, Chairman Inaba

Nays: Commissioners Napier and Wung

The motion to approve the special permit was passed.

SPECIAL PERMIT APPLICATION BY AVIS RENT A CAR (SP73-141) TO CONSTRUCT AND OPERATE A U-DRIVE BUSINESS IN HOOLEHUA, MOLOKAI

Mr. Leong, staff planner, presented the staff memorandum recommending that the request be approved, subject to the conditions imposed by the County (see copy of report on file).

Commissioner Yamamura moved to approve the special permit as recommended by staff, which was seconded by Vice Chairman Tangen.

Commissioner Sakahashi felt that the addition of another U-drive business in the area may affect the profit factor of the other two existing U-drive establishments.

Vice Chairman Tangen argued that petitioner was already operating the business from Kaunakakai and ferrying the cars to the airport so that this was not the case. It would merely make it more convenient for the petitioner to conduct his business from a location closer to the airport. Commissioner Kido added that this could also stimulate competition and result in better service to the consumer.

Chairman Inaba called upon the Executive Officer to poll the Commissioners on the foregoing motion. The votes are recorded as follows:

Ayes: Commissioners Wung, Napier, Yamamura, Kido,
Vice Chairman Tangen, Chairman Inaba

Nays: Commissioners Sakahashi and Mark

The motion to approve the special permit was carried.

SPECIAL PERMIT APPLICATION BY ROBERT GOUEYTES (SP73-142) FOR MINOR IMPROVEMENTS AND OPERATION OF A RESTAURANT AT KIHEI, MAUI

It was the staff's recommendation that this request be approved subject to the conditions imposed by the Maui Planning Commission, and with the added stipulation (under condition #6) that any extensions of the special permit also be reviewed by the Land Use Commission (see copy of report on file).

Upon motion by Commissioner Yamamura, seconded by Vice Chairman Tangen, the special permit was unanimously approved as recommended by staff.

APPLICATION BY LIHUE PLANTATION CO., LTD. (A72-335) TO RECLASSIFY 26.4 ACRES FROM URBAN TO AGRICULTURAL AT KAWAIHAU, KAUAI

Mr. Fujimoto presented the staff memorandum recommending approval of the subject petition (see copy of report on file).

Commissioner Napier moved to approve the petition, which was seconded by Commissioner Wung and unanimously passed.

NEXT MEETING DATE

Mr. Fujimoto advised that the next meetings of the Land Use Commission will be held on February 16 on Maui and Lanai.

Since there was no further business, the meeting was adjourned.

STATE OF HAWAII
LAND USE COMMISSION

VOTE RECORD

ITEM SP73-141 - AVIS RENT A CAR

DATE February 2, 1973

PLACE Liliuokalani Building
Honolulu, Hawaii

TIME 1:30 p.m.

NAME	YES	NO	ABSTAIN	ABSENT
WUNG, LESLIE	✓			
SAKAHASHI, STAN		✓		
YAMAMURA, TANJI	✓			
KIDO, SUNAO	✓			
MARK, SHELLEY		✓		
NAPIER, ALEXANDER	✓			
TANGEN, EDDIE	✓			
INABA, GORO	✓			

W

S

Comments:

Approval

I move that the special permit be approved subject to the conditions imposed by the County.

STATE OF HAWAII
LAND USE COMMISSION

February 2, 1973
1:30 p.m.

MEMORANDUM

TO: Land Use Commission

FROM: Staff

SUBJECT: SP73-141 - AVIS RENT A CAR SYSTEM, INC. (MOL)

A special permit to establish and operate a U-drive car rental business, including storage and servicing facilities, on approximately 3.9 acres of land situated within the Agricultural District at Hoolehua, Molokai, has been requested by Avis Rent A Car System, Inc. The area in question is situated near the Molokai airport at the intersection of Keonelele and Mauna Loa Roads.

The subject property, identified as Tax Map Key 5-2-04: parcel 51, is owned in fee by the State of Hawaii and is presently leased to Avis Rent A Car System, Inc. *on a month to month basis.*

The Molokai Airport Terminal presently contains spaces for two U-Drive rental services which are presently occupied by Molokai Island U-Drive and Friendly Island We-Drive.

The petitioner does not have office space to do business at the airport terminal and therefore has initiated this permit request to establish this U-Drive business close to the airport. Presently, Avis Rent A Car operates its business from Kaunakakai, approximately 8 miles from the airport. Currently the petitioner has approximately 20 cars in its fleet and anticipates approximately 12 to 13 U-Drive cars to be operating from the subject site. Additionally, Avis proposes to hire 2 more employees if this request is approved.

The subject property is vacant, unimproved and covered with weeds and low brush. Soil classification by the Land Study Bureau indicates that the soil in the area is nonstony, deep, moderately-fine, well-drained, and poorly suited for overall crop productivity. The median annual rainfall ranges from 10 to 25 inches and the elevation is approximately 500 feet above sea level. Electricity and water are available to the site. However, there is no public sewer system.

COUNTY RECOMMENDATION

The Molokai Advisory Committee at its November 29, 1972 meeting and the Maui Planning Commission at its December 19, 1972 meeting,

both voted to recommend that the subject request be approved. The recommendation for approval was contingent upon the following conditions:

1. That the area to be used for the rental car business be properly landscaped and maintained.
2. That vehicular access to the subject property be confined to the Molokai Airport Road.
3. That all State and County requirements be met.
4. That the proposed use of the subject property be initiated within one year from date of approval by the Land Use Commission.
5. That the landscape and site plans be submitted to the Maui County Planning Department for final approval.

At the public hearing held by the Molokai Advisory Committee, Mrs. Mary Kanno of Friendly Island We-Drive testified against the subject request. Mrs. Kanno stated that between Friendly Island We-Drive's 27 rental cars and Molokai U-Drive's 50 cars, the demand for car rental on Molokai are being met. She further stated that perhaps in 2 or 3 years, the need for another U-Drive rental agency would exist.

Upon evaluation of this request, staff finds that:

1. Avis Rent A Car System, Inc. has already established its car rental operation on the Island of Molokai and is seeking to relocate this business closer to the airport.
2. The proposed site is poorly suited for overall agricultural use and is not currently used for active agricultural production.
3. The proposed use is a compatible one relative to the airport activities and the car rental operation will not adversely affect the surrounding unimproved lands.
4. Approval of the request under the County's conditions would not unreasonably burden public agencies to provide services and facilities and also control the development and operation of the proposed use.

Based on the above, staff concurs with the recommendation of the Molokai Advisory Committee and Maui County Planning Commission and also recommends approval of this petition, subject to the conditions imposed by the County.

STATE OF HAWAII
LAND USE COMMISSION
P. O. Box 2359
HONOLULU, HAWAII 96804

January 22, 1973

NOTIFICATION OF SPECIAL PERMIT APPLICATIONS

Please be advised that the following special permit applications have been filed with the Land Use Commission:

SP72-139 - MOANA DEVELOPMENT CORPORATION

To develop a tennis club consisting of tennis courts and related improvements at Koloa, Kauai, Tax Map Key 2-8-14: 01, situated within the Agricultural District.

SP72-140 - BOISE CASCADE

To construct and operate a golf course at Waikoloa, South Kohala, Hawaii, Tax Map Key 6-8-01: portion of 5, partially situated within the Agricultural District.

✓ SP73-141 - AVIS RENT A CAR

To construct and operate a U-Drive business at Hoolehua, Molokai, Tax Map Key 5-2-04: 51, situated within the Agricultural District.

SP73-142 - ROBERT GOUEYTES

For minor improvements and operation of a restaurant at Kihei, Maui, Tax Map Key 3-8-4: 21, situated within the Agricultural District.

An action meeting on these applications is scheduled for February 2, 1973*.

We would appreciate any written comments for or against these requests, or you or your agent may appear at the meeting. Please do not hesitate to call this matter to the attention of other interested parties.

Should you desire additional information, feel free to contact this office.

Very truly yours,



TATSUO FUJIMOTO
Executive Officer

*See enclosed agenda

January 22, 1973

Mr. Clark Seidel
Vice President & Regional Manager
Avis Rent A Car System, Inc.
3001 N. Nimitz Highway
Honolulu, Hawaii 96819

Dear Mr. Seidel:

The Land Use Commission next meets on February 2, 1973, at 1:30 p.m., in the Department of Education's Board Room #404, Queen Liliuokalani Building, Honolulu, Hawaii.

At that time, the application by Avis Rent A Car System, Inc. (SP73-141) to construct and operate a U-drive business in Hoolehua, Molokai, will be considered.

Should you have any questions regarding this matter, please feel free to contact us.

Very truly yours,

TATSUO FUJIMOTO
Executive Officer

Encl. - Agenda

3467

PLANNING COMMISSION
Yoshikazu Matsui, Chairman
G. Alan Freeland, Vice-Chairman
Joseph Franco
Kazuo Kage
Michael Kimura
Richard Mayer
George Murashige
Stanley Goshi, Ex-Officio
Carl Kaiama, Ex-Officio

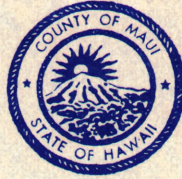

Elmer F. Cravalho
Mayor

BOARD OF ADJUSTMENT
& APPEALS
Joseph S. Medeiros, Jr., Chairman
Young Whee Chun, Vice-Chairman
William Hong
George Tamura
Thomas Yagi

Howard Nakamura
Planning Director

COUNTY OF MAUI
PLANNING DEPARTMENT

200 S. HIGH STREET
WAILUKU, MAUI, HAWAII 96793

December 29, 1972

RECEIVED

JAN 11 1973

State of Hawaii
LAND USE COMMISSION

Mr. Tatsuo Fujimoto
Executive Officer
Land Use Commission
P. O. Box 2359
Honolulu, Hawaii 96804

Dear Mr. Fujimoto:

RE: Request by Mr. Clark Seidel of Avis Rent-A-Car System, Inc. for a Special Permit to construct and operate a U-Drive business in Hoolehua, Molokai.

The Maui Planning Commission, at its meeting of December 19, 1972, voted unanimously to recommend approval of the above request for Special Permit.

A public hearing on the request was held on November 29, 1972 by the Molokai Advisory Committee in Kaunakakai, Molokai. In addition to a representative of the applicant, the Molokai Advisory Committee received testimony from the Molokai manager of Avis supporting the application and testimony from a representative of Friendly Island We-Drive opposing the request.

The Maui Planning Commission concurred with the recommendation of the Molokai Advisory Committee and recommends approval of the Special Permit with the following conditions:

1. That the area to be used for the rental car business be properly landscaped and maintained.
2. That vehicular access to the subject property be confined to the Molokai Airport Road.
3. That all State and County requirements be met.
4. That the proposed use of the subject property be initiated within one year from date of approval by the Land Use Commission.

Mr. Tatsuo Fujimoto
Page 2
December 29, 1972

5. That the landscape and site plans be submitted to the Maui County Planning Department for final approval.

Enclosed for your information and review are the following:

1. Copy of application
2. Notice of public hearing
3. Transcript of the public hearing
4. Staff Report
5. Copy of Molokai Advisory Committee letter

Please contact our office should you have any questions.

Very truly yours,

Howard K. Nakamura

HOWARD K. NAKAMURA
Planning Director

/ti/jw/

Encls.

cc Clark Seidel
E. Loy Cluney

INSTRUCTIONS:

- 1. To be filed in triplicate.
- 2. Use black ink or typewriter with black ribbon.
- 3. Use additional sheets if necessary.

MAUI PLANNING COMMISSION
 P.O. BOX 1487, KAHULUI, HAWAII

APPLICATION FOR SPECIAL PERMIT
 Special Permit is hereby requested:

DO NOT WRITE IN THIS SPACE

Appl. & fee received _____
 Notice published _____
 Public hearing _____
 Recommendation to LUC _____
 Action by State LUC _____
 County & Appl. notified _____

- A. Description of Property: (1) Tax Map Key No. 5-2-04:51
 (2) Lot Area 3.91 ac. (3) Location Hoolehua, Molokai
State of Hawaii,
- B. Ownership: (1) Owner's name (Department of Land and Natural Resources)
month to month basis
 (2) Lessee's name Avis Rent A Car System, Inc. (3) ~~Unexpired term xxx years~~
- C. Request: (1) State request briefly and exactly: Avis wishes to use
the area for U-drive storage and servicing. Customers will pick
up and drop the vehicles at the airport itself.

(2) Reasons justifying granting of request: No space for storage and
servicing of U-drive vehicles is available at the airport.

- D. Applicant: (1) Name Avis Rent A Car System, Inc.
3001 N. Nimitz Highway,
 (2) Address Honolulu, Hi. 96819 (3) Telephone 923-9865
 (4) Signature *Clark Seidel*
CLARK SEIDEL
Vice President and Regional Manager

E. Planning Commission action: _____ Date _____ Vote: ayes noes

Reasons: _____

F. State Land Use Commission's action: _____ Date: _____

G. Copies to: State LUC ___ Supervisors ___ Applicant ___ Owner & Lessee ___

NOTICE OF PUBLIC HEARING
SPECIAL USE PERMIT
Maui Planning Commission

NOTICE IS HEREBY GIVEN of a public hearing to be held by the Molokai Advisory Committee on Wednesday, November 29, 1972, at 7:30 p.m. in the Conference Room of the Molokai Community Center, Kaunakakai, Molokai, or as soon thereafter as those interested may be heard to consider the following request for SPECIAL USE PERMIT under provisions of SECTION 98H-6, REVISED LAWS OF HAWAII 1955, 1961 SUPPLEMENT, AS AMENDED BY ACT 205, SESSION LAWS OF HAWAII 1963:

HOOLEHUA, MOLOKAI

AVIS RENT A CAR SYSTEM INC., by Clark Seidel, Vice President and Regional Manager, requesting approval to operate U-drive storage and service area within the State Agricultural District. Said parcel is located at the intersection of Maunaloa Highway and the Molokai Airport Road, TMK 5-2-04:51
Lot Area: 3.91 acres

Information regarding this application is on file in the office of the County of Maui Planning Department at Wailuku, Maui, Hawaii, and at the office of the County Agent, Kaunakakai, Molokai, and is open to the public for inspection during office hours.

All testimony regarding said request should be filed in writing to said Commission, 200 S. High Street, Wailuku, Maui, Hawaii, before the date of the public hearing or presented in person at the time of the public hearing.

MAUI PLANNING DEPARTMENT
By Howard K. Nakamura
County Planning Director

(MN--November 7, 1972)

cc Public Works
cc Water Supply
cc Fire Department
cc State Highways
cc Dept. of Health
cc DOT - Airports (Honolulu, Maui)
cc DLNR (Honolulu, Maui)
cc LUC
cc Molokai Advisory Committee (all members)
cc Mayor
cc Molokai Chamber of Commerce
cc Molokai CAC
cc Ka Molokai (Sid Kent)
cc Applicant
cc State Dept. of Ag.
cc Others (Molokai)
cc County Agent, Molokai

PUBLIC HEARING
MOLOKAI ADVISORY COMMITTEE
November 29, 1972 - 7:30 p.m.
Kaunakakai Community Center

ATTENDANCE:

Present: Richard Sakata, Acting Chairman
Wilfred Imamura, Member

Excused: Chairman E. Loy Cluney
Tony Abrahamo

Others: Toshio Ishikawa, Deputy Planning Director
Harold Mizomi
T. Imai
Paul D'Amico
Mary Kanno
Sid Kent
Others: approx. 5

Acting Chairman Sakata called the meeting to order and introduced members of the Advisory Committee and County staff. Mr. Sakata explained that Chairman Cluney was excused from the meeting due to illness, and that Mr. Abrahamo was excused due to recent surgery.

The Chairman stated that no action would be taken on any of the items on the agenda due to the lack of a quorum. However, the public hearing on the Special Use Permit will be conducted in accordance with the published notice.

Chairman Sakata opened the public hearing on the request by Avis Rent-A-Car, Inc., for a State Land Use Commission Special Use Permit.

Deputy Director Ishikawa read the Notice of Public Hearing, and explained the subject request by Avis Rent-A-Car.

No letters of approval or protest were received on the subject request.

Chairman Sakata opened the hearing to the public.

Mr. Paul D'Amico, representing the applicant, testified that the subject request could mean additional employment (about 2 persons) by Avis, and that the company anticipates 12-13 U-drive cars at the proposed site.

Mr. Ben Abino, local manager of Avis, testified that the company presently is in operation (not at the proposed site), and has about 20 cars in its fleet.

Mrs. Mary Kanno of Friendly Island We-Drive spoke against the subject request by testifying that Avis is premature in its request. She stated that they (Friendly Island We-Drive) have 27 rental cars available, and that Molokai U-Drive has 50 cars to rent. Between the two rental agencies, the demands for rentals are being met. She went on to state that in 2 or 3 years, perhaps a need would exist for Avis.

Mr. Ishikawa explained that Avis presently does have a rental car business in operation, and that the subject request is a matter of relocating the business to the proposed site.

As there was no other testimony, Chairman Sakata closed the public hearing, and stated that the matter would be taken under advisement. The recommendation of the Committee will be forwarded to the Maui Planning Commission, with final action by the State Land Use Commission required for approval.

Respectfully submitted,

TOSHIO ISHIKAWA

STAFF REPORT

November 29, 1972

TO: Molokai Advisory Committee and
Maui Planning Commission

FROM: Planning Staff

SUBJECT: Request for LUC Special Permit to construct and operate a
car rental business at Molokai Airport, Molokai.

Applicant -Avis Rent A Car System by Clark Seidel
Location -Molokai Airport Area
TMK -5-2-04:51
Area -3.91 acres
Zoning -State Agriculture
Request -The applicant requests a Special Permit approval
in order to construct and operate a U-Rental Car
Business.

EXISTING CONDITIONS

1. The subject property is unimproved and uncultivated at this time. Much of the property is covered with weeds and low brush.
2. The subject property is located at the intersection of Keonelele and Mauna Loa Roads. Access to the subject property is provided the Keonelele and Mauna Loa Roads.

ANALYSIS

1. The applicant proposes to utilize the subject property as a storage and servicing area in conjunction with the proposed U-Drive car rental business. While it would be desirable to provide vehicle storage and maintenance area away from the immediate vicinity of the airport terminal, it would seem that the location for storage and maintenance service be best in an area other than at a highway intersection as in this case. Presently, the U-Drive car rental businesses have storage and servicing facility on the fringe area of the airport parking lot.
2. The proposed use of property for car rental storage, service and business is compatible as related Land Use in an airport area. A similar exists in and around the Kahului Airport.
3. The Molokai Airport Terminal area is limited spatially for storage and maintenance vehicles. Hence, U-Drive rental businesses have little alternative but to locate the said facilities on the fringe areas of the airport
4. The Molokai Airport is the major feature in the area with the subject property located at the northeasterly side of the airport.
5. The present terminal contains spaces for two offices for U-Drive rental service and there are presently utilized by Molokai Island U-Drive and Friendly Island We-Drive.
6. Utilities:
 - a) No public sewer system is available at this time;
 - b) Water Supply is provided by the State;
 - c) Power is available by Molokai Electric Co.

Staff Report - 2
November 29, 1972

7. The proposed location of the storage and maintenance area at the intersection of Keonelele and Mauna Loa Roads could result in a certain amount of traffic hazard - especially at times when air passenger auto traffic and demands for U-Drive rentals reach a high level during the peak tourist periods.

December 15, 1972

Maui Planning Commission
County of Maui
200 S. High Street
Wailuku, Hawaii 96793

Dear Chairman and Members of the Maui Planning Commission:

Re: Request for Special Use Permit
by Avis Rent-A-Car, Inc.

The Molokai Advisory Committee, on November 29, 1972, held a public hearing at the Kaurakakai Community Center on the above request. At the hearing, testimonies were received by the Committee presented by the applicant and the Molokai manager of Avis supporting the subject request; and a representative of Friendly Island We-Drive opposing the request.

The Committee, in considering this matter, acknowledged that Avis Rent-A-Car, Inc., is presently doing business in Molokai, and that the subject request is not a new rental car business. The Committee also noted that the request would be in an area that is surrounded by unimproved lands, and thus would not be detrimental to the area.

The Molokai Advisory Committee therefore recommends approval of the request with the following conditions:

1. That the area to be used for the rental car business be properly landscaped and maintained.
2. That vehicular access to the subject property be confined to the Molokai Airport road.
3. That all State and County requirements be met.
4. That the proposed use of the subject property be initiated within 1 year from date of approval by the Land Use Commission.

Very truly yours,

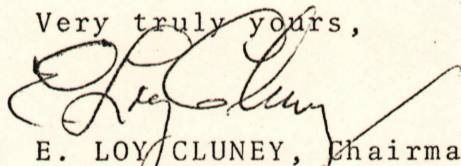

E. LOY CLUNEY, Chairman
Molokai Advisory Committee

RECEIVED

NOV 13 1972

State of Hawaii
LAND USE COMMISSION

NOTICE OF PUBLIC HEARING
SPECIAL USE PERMIT
Maui Planning Commission

NOTICE IS HEREBY GIVEN of a public hearing to be held by the Molokai Advisory Committee on Wednesday, November 29, 1972, at 7:30 p.m. in the Conference Room of the Molokai Community Center, Kaunakakai, Molokai, or as soon thereafter as those interested may be heard to consider the following request for SPECIAL USE PERMIT under provisions of SECTION 98H-6, REVISED LAWS OF HAWAII 1955, 1961 SUPPLEMENT, AS AMENDED BY ACT 205, SESSION LAWS OF HAWAII 1963:

HOOLEHUA, MOLOKAI

AVIS RENT A CAR SYSTEM INC., by Clark Seidel, Vice President and Regional Manager, requesting approval to operate U-drive storage and service area within the State Agricultural District. Said parcel is located at the intersection of Maunaloa Highway and the Molokai Airport Road, TMK 5-2-04:51

Lot Area: 3.91 acres

Information regarding this application is on file in the office of the County of Maui Planning Department at Wailuku, Maui, Hawaii, and at the office of the County Agent, Kaunakakai, Molokai, and is open to the public for inspection during office hours.

All testimony regarding said request should be filed in writing to said Commission, 200 S. High Street, Wailuku, Maui, Hawaii, before the date of the public hearing or presented in person at the time of the public hearing.

MAUI PLANNING DEPARTMENT
By Howard K. Nakamura
County Planning Director

(MN--November 7, 1972)

- cc Public Works
- cc Water Supply
- cc Fire Department
- cc State Highways
- cc Dept. of Health
- cc DOT - Airports (Honolulu, Maui)
- cc DLNR (Honolulu, Maui)
- cc LUC
- cc Molokai Advisory Committee (all members)
- cc Mayor
- cc Molokai Chamber of Commerce
- cc Molokai CAC
- cc Ka Molokai (Sid Kent)
- cc Applicant
- cc State Dept. of Ag.
- cc Others (Molokai)
- cc County Agent, Molokai

PACIFIC SP73-141 AVIS RENT A CAR SYSTEMS, INC.

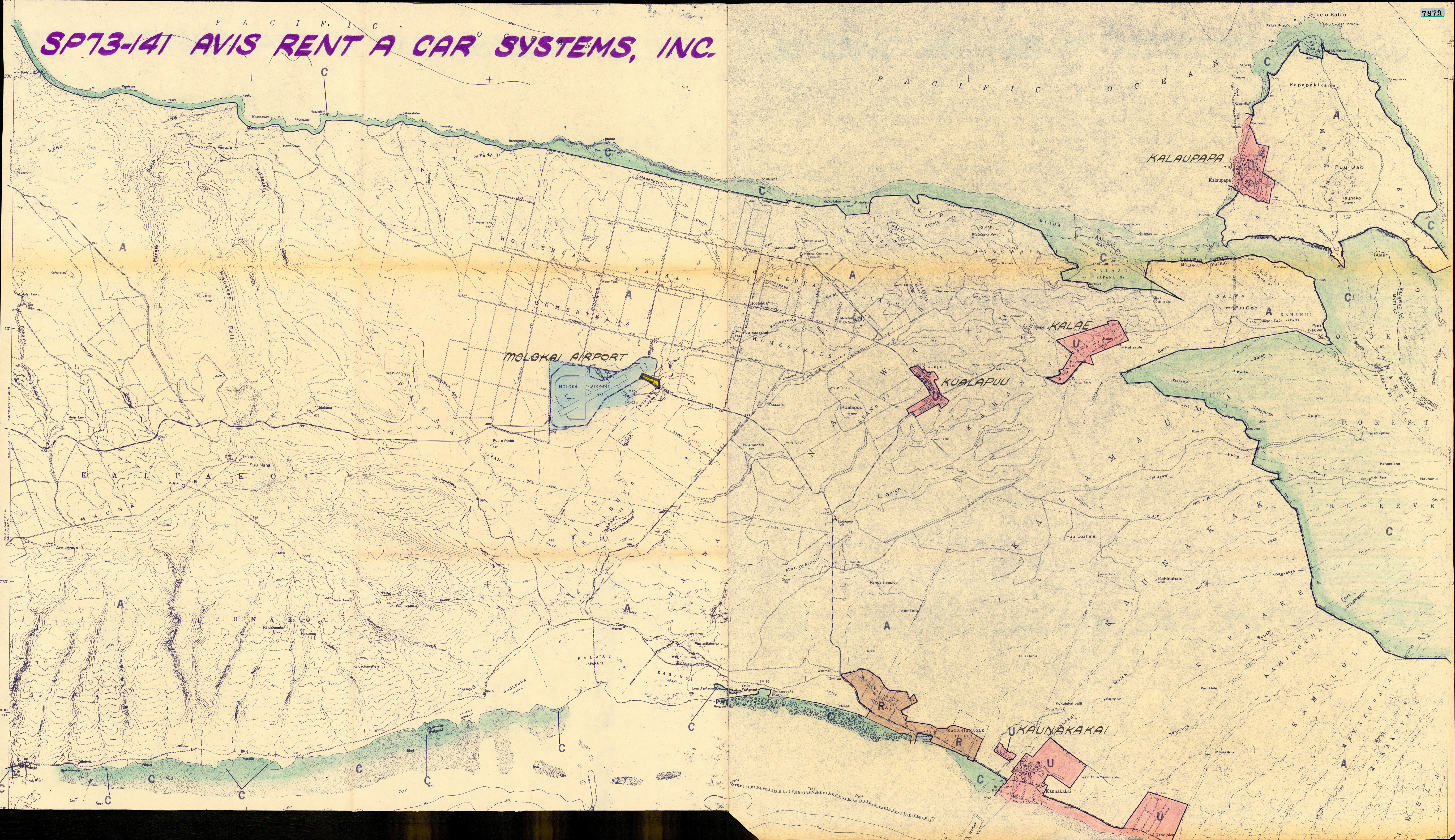

SP73-142 ROBERT GOUEYTES

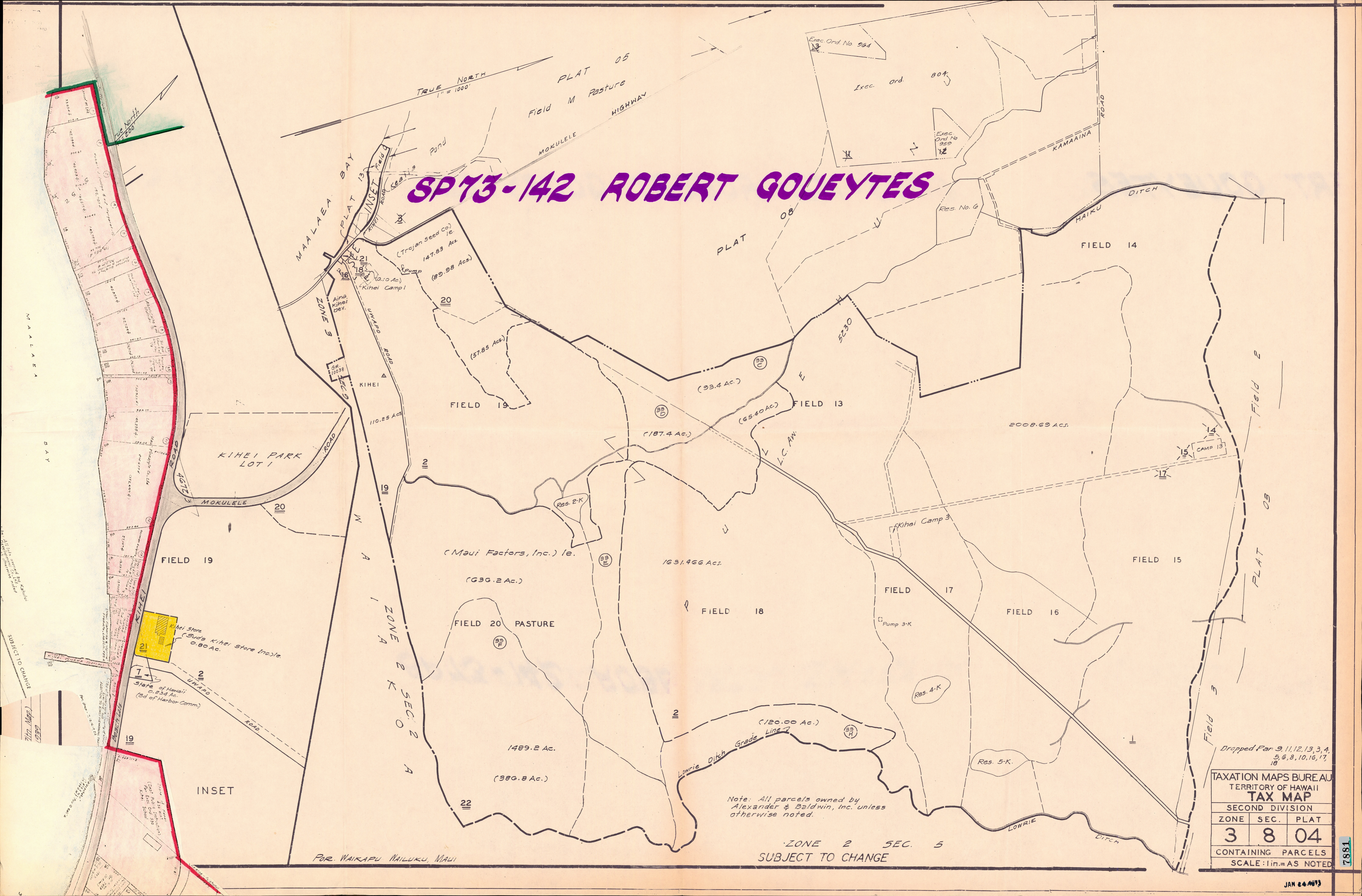

TRUE NORTH
1" = 1000'
PLAT 05
Field M Pasture
MOKULELE HIGHWAY

Exec. Ord. No. 964
Exec. Ord. 804
Exec. Ord. No. 959
Res. No. G

FIELD 19
MOKULELE ROAD
KIHEI PARK LOT 1
KIHEI ROAD
KIHEI STORE
(Suda Kihai Store Inc.)
0.80 Ac.
State of Hawaii
0.234 Ac.
(Ed of Harbor Comm.)
UNWADO ROAD

(Trojan Seed Co.)
147.83 Ac.
Pump
(10.10 Ac.)
Kihai Camp 1
57.85 Ac.

FIELD 19
110.25 Ac.
KIHEI
110.25 Ac.
FIELD 19
(187.4 Ac.)
FIELD 13
(65.40 Ac.)
FIELD 17
Kihai Camp 3
Pump 3-K

(Maui Factors, Inc.)
1631.966 Ac.
FIELD 18
FIELD 20 PASTURE
(630.2 Ac.)
1489.2 Ac.
(380.8 Ac.)
Lowrie Ditch Grade Line 7
(120.00 Ac.)
Res. 2-K
Res. 4-K
Res. 5-K

Note: All parcels owned by Alexander & Baldwin, Inc. unless otherwise noted.

ZONE 2 SEC. 5
SUBJECT TO CHANGE

Dropped Par 9, 11, 12, 13, 3, 4, 5, 6, 8, 10, 16, 17, 18

TAXATION MAPS BUREAU		
TERRITORY OF HAWAII		
TAX MAP		
SECOND DIVISION		
ZONE	SEC.	PLAT
3	8	04
CONTAINING PARCELS		
SCALE: 1 in. = AS NOTED		

FOR WAIKAPU MAILUKU, MAUI

