

UNLOCATED KULEANAI IN PALAHEU

L. C. AW. 2435 AP. 1
L. C. AW. 2435 AP. 2
L. C. AW. 2435 AP. 1
L. C. AW. 2435 AP. 2
L. C. AW. 2435-B AP. 1
L. C. AW. 2435 AP. 1
AP. 2
AP. 3
L. C. AW. 2435 AP. 1
AP. 2
L. C. AW. 2435 AP. 1
AP. 2
AP. 3
L. C. AW. 2435

UNLOCATED KULEANAI IN PALAUEA

L. C. AW. 2333 AP. 1
L. C. AW. 2333 AP. 1
L. C. AW. 2333 AP. 2
L. C. AW. 2333 AP. 3
L. C. AW. 2502
L. C. AW. 2525 AP. 1
AP. 2
L. C. AW. 2541
L. C. AW. 2565
L. C. AW. 2570 AP. 1
AP. 3
L. C. AW. 2500-B
L. C. AW. 2565 AP. 1
L. C. AW. 2569 AP. 1
L. C. AW. 2423 AP. 2

15. *W. K. Kanani, Jr. et al.*
100 Ac.
L. C. AW. 5362 AP. 2
(Unlocated)

26. *W. K. Kanani, Jr. et al.*
10.13 Ac.
L. C. AW. 2415 AP. 3
(Unlocated)

57. *County of Maui*
MAUI MEADOWS III
TAX SITE
(10.523 Ac.)

34 FT. RO. UTILITY ESMT
(1.420 Ac.)

44. *Herman Saito Engineering Consultants, Inc.*
1.170 Ac.

45. *Board of Water Supply*
County of Maui
06.820 Ac. or 27,000 sq ft
(E. 2000' RESERVE 'S' (10.171 Ac.))

46. *Board of Water Supply*
County of Maui
06.820 Ac. or 27,000 sq ft
(E. 2000' RESERVE 'S' (10.171 Ac.))

47. *County of Maui*
0.751 Ac.

48. *County of Maui*
0.751 Ac.

49. *County of Maui*
0.751 Ac.

50. *County of Maui*
0.751 Ac.

51. *County of Maui*
0.751 Ac.

52. *County of Maui*
0.751 Ac.

53. *County of Maui*
0.751 Ac.

54. *County of Maui*
0.751 Ac.

55. *County of Maui*
0.751 Ac.

56. *County of Maui*
0.751 Ac.

57. *County of Maui*
0.751 Ac.

58. *County of Maui*
0.751 Ac.

59. *County of Maui*
0.751 Ac.

60. *County of Maui*
0.751 Ac.

61. *County of Maui*
0.751 Ac.

62. *County of Maui*
0.751 Ac.

DWG. NO. 2008 REVISED
SOURCE: THE B. & M. TOWELL
BY: HAN-LB DATE: FEB. 7, 1988

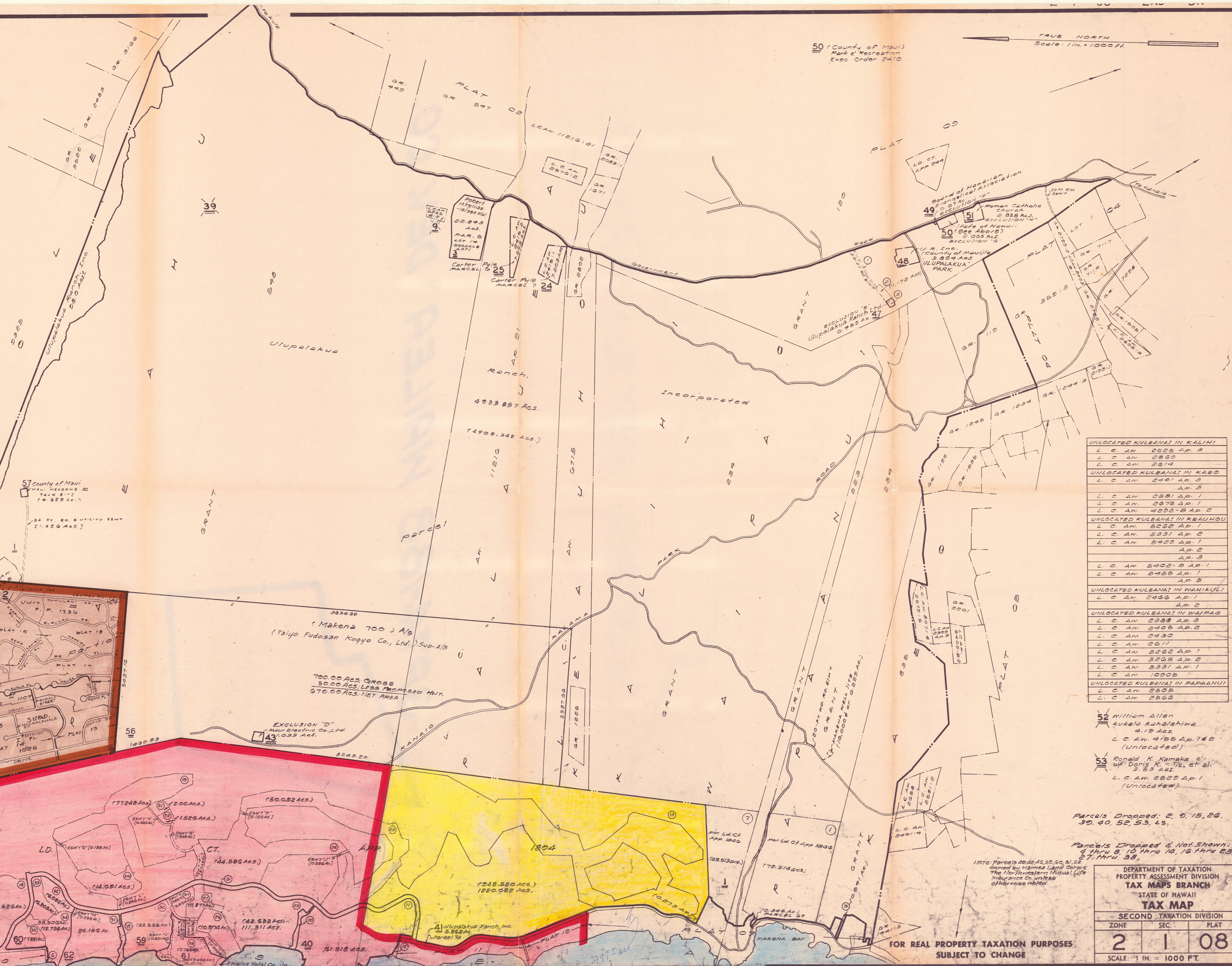

50 (County of Maui)
Park & Recreation
Exec Order 2410

TRUE NORTH
Scale: 1 in. = 1000 ft.

UNLOCATED KULEANAI IN KAHALI

L. C. AW. 2525 AP. 3
L. C. AW. 2569
L. C. AW. 2674

UNLOCATED KULEANAI IN KAEO

L. C. AW. 2401 AP. 3
AP. 5
L. C. AW. 2581 AP. 1
L. C. AW. 2676 AP. 1
L. C. AW. 4202-B AP. 2

UNLOCATED KULEANAI IN KEAHOHU

L. C. AW. 2622 AP. 1
L. C. AW. 2331 AP. 2
L. C. AW. 2423 AP. 1
AP. 2
AP. 3
L. C. AW. 2402-B AP. 1
L. C. AW. 2455 AP. 1
AP. 5

UNLOCATED KULEANAI IN WAHIKULI

L. C. AW. 2466 AP. 1
AP. 2

UNLOCATED KULEANAI IN WAIPAO

L. C. AW. 2328 AP. 3
L. C. AW. 2405 AP. 2
L. C. AW. 2430
L. C. AW. 2611
L. C. AW. 2622 AP. 1
L. C. AW. 2625 AP. 2
L. C. AW. 2331 AP. 1
L. C. AW. 1000B

UNLOCATED KULEANAI IN PAPAHAU

L. C. AW. 2505
L. C. AW. 2566

52. *William Allen*
Kukela Kahaehiwa
4.13 Ac.
L. C. AW. 4155 AP. 1 & 2
(Unlocated)

53. *Ronald K. Kamaka & wife Doris K. Kamaka, et al.*
3.53 Ac.
L. C. AW. 2529 AP. 1
(Unlocated)

Parcels Dropped: 2, 9, 15, 26, 39, 40, 52, 53, 45.

Parcels Dropped & Not Shown: 3 thru 8, 10 thru 14, 16 thru 23, 27 thru 38.

NOTE: Parcels 40, 42, 45, 50, 51, 52 owned by Waimea Land Corp. The Northwestern Mutual Life Insurance Co. unless otherwise noted.

DEPARTMENT OF TAXATION PROPERTY ASSESSMENT DIVISION TAX MAPS BRANCH STATE OF HAWAII TAX MAP		
SECOND TAXATION DIVISION		
ZONE	SEC.	PLAT
2	1	08
SCALE: 1 IN. = 1000 FT.		

FOR REAL PROPERTY TAXATION PURPOSES
SUBJECT TO CHANGE